

Einhell

TE-MT 7,2 Li

D	Originalbetriebsanleitung Akku-Schleif- und Gravurwerkzeug	NL	Originele handleiding Accu slijp- en graveergereedschap
GB	Original operating instructions Cordless grinding and engraving tool	E	Manual de instrucciones original Herramienta inalámbrica desbar- badora y grabadora
F	Instructions d'origine Outil de ponçage et de gravure sans fil	FIN	Alkuperäiskäyttöohje Akkukäyttöinen hioma- ja kaiverrustyökalu
I	Istruzioni per l'uso originali Smerigliatrice a stelo a batteria	SLO	Originalna navodila za uporabo Akumulatorsko brusilno in gravir- no orodje
DK/ N	Original betjeningsvejledning Akku-slibe- og gravørværktøj	H	Eredeti használati utasítás Akkus - csiszoló és gravírozó szerszám
S	Original-bruksanvisning Batteridrivet slip- och gravyrverk- tyg	GR	Πρωτότυπες Οδηγίες χρήσης Εργαλείο λείανσης και χάραξης, με μπαταρία
CZ	Originální návod k obsluze Akumulátorová bruska a gravíro- vací nástroj		
SK	Originálny návod na obsluhu Akumulátorová brúska a gravírovačka		



Art.-Nr.: 44.193.30

I.-Nr.: 11018

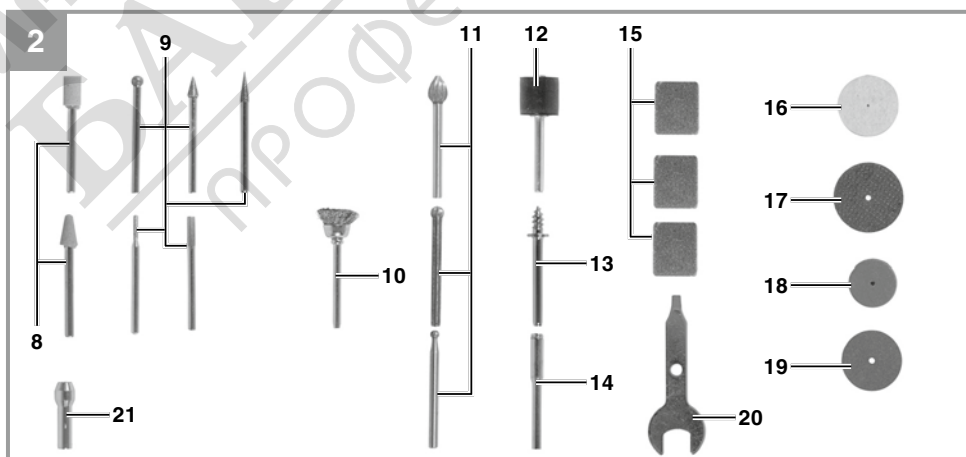

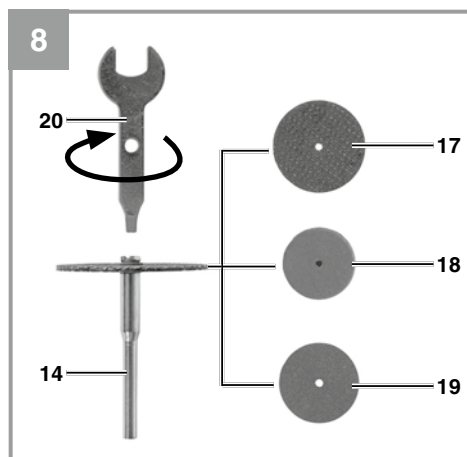
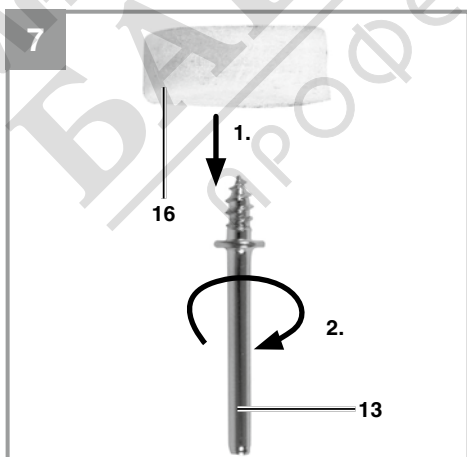
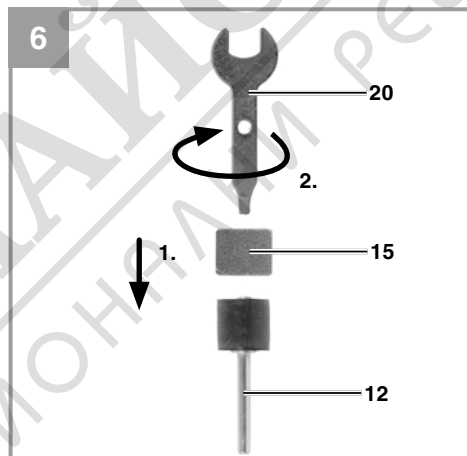
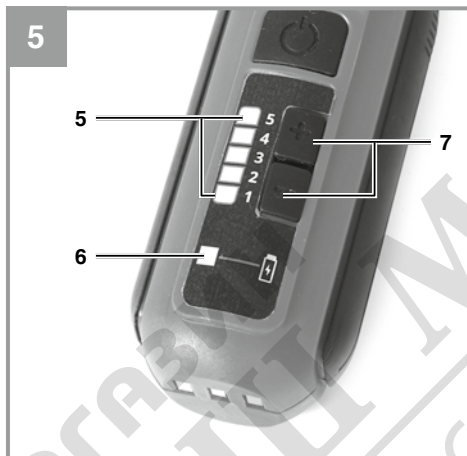
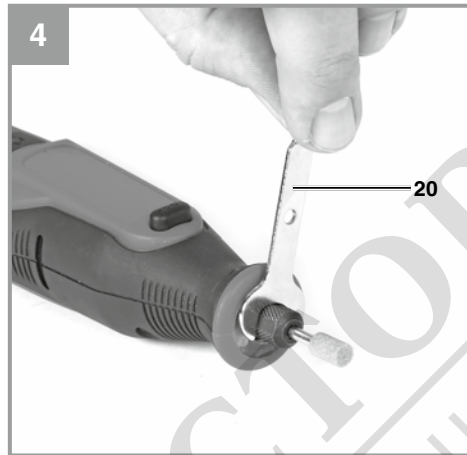
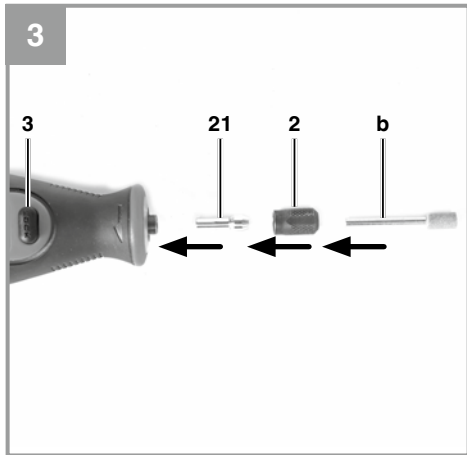



Danger! - Read the operating instructions to reduce the risk of injury



Caution! Wear ear-muffs. The impact of noise can cause damage to hearing.



Caution! Wear a breathing mask. Dust which is injurious to health can be generated when working on wood and other materials. Never use the device to work on any materials containing asbestos!



Caution! Wear safety goggles. Sparks generated during working or splinters, chips and dust emitted by the device can cause loss of sight.

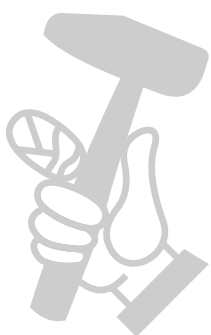

Danger!

When using the equipment, a few safety precautions must be observed to avoid injuries and damage. Please read the complete operating instructions and safety regulations with due care. Keep this manual in a safe place, so that the information is available at all times. If you give the equipment to any other person, hand over these operating instructions and safety regulations as well. We cannot accept any liability for damage or accidents which arise due to a failure to follow these instructions and the safety instructions.

1. Safety regulations

The corresponding safety information can be found in the enclosed booklet.

Read all the safety information, instructions, illustrations and technical data provided on or with this power tool. Failure to adhere to the following instructions may result in electric shock, fire and/or serious injury.

Keep all the safety information and instructions in a safe place for future use.

2. Layout and items supplied**2.1 Layout (Fig. 1)**

1. On/Off switch
2. Clamp nut
3. Locking knob for collet chuck
4. Charging station
5. Multifunction display
6. Battery charge level indicator
7. Speed controller

2.2 Items supplied (Fig. 1-2)

Please check that the article is complete as specified in the scope of delivery. If parts are missing, please contact our service center or the sales outlet where you made your purchase at the latest within 5 working days after purchasing the product and upon presentation of a valid bill of purchase. Also, refer to the warranty table in the service information at the end of the operating instructions.

- Open the packaging and take out the equipment with care.
- Remove the packaging material and any packaging and/or transportation braces (if available).
- Check to see if all items are supplied.

- Inspect the equipment and accessories for transport damage.
- If possible, please keep the packaging until the end of the guarantee period.

Danger!

The equipment and packaging material are not toys. Do not let children play with plastic bags, foils or small parts. There is a danger of swallowing or suffocating!

- Cordless grinding and engraving tool
- 6x grinding pins (8)
- 5x cutting pins (9)
- 1x cup brush (10)
- 3x cutters (11)
- 2x grinding head (12)
- 1x arbor (13)
- 2x clamping spindles (14)
- 12x grinding/sanding belts (15)
- 4x felt polishers (16)
- 5x cutting wheels, large (17)
- 5x grinding wheels (18)
- 5x cutting wheels, small (19)
- 1x chuck key (20)
- 6x sleeves (21)
(2x 3.2 mm; 2x 2.4 mm; 2x 1.6 mm)

3. Proper use

The cordless grinding and engraving tool is designed for the drilling, grinding/sanding, deburring, polishing, engraving, cutting, milling and cleaning of wood, metal and plastic in model-making, in workshops and in the home. Use the tool and its accessories only for the applications described.

The equipment is to be used only for its prescribed purpose. Any other use is deemed to be a case of misuse. The user / operator and not the manufacturer will be liable for any damage or injuries of any kind caused as a result of this.

Please note that our equipment has not been designed for use in commercial, trade or industrial applications. Our warranty will be voided if the machine is used in commercial, trade or industrial businesses or for equivalent purposes.

4. Technical data

Motor power supply:	7.2 V
Idling speed n_0 :	5500-26000 rpm
Clamping range	1.6 - 3.2 mm
Attachments \varnothing max.	32 mm
Attachment length max.	18 mm
Spindle length max.	50 mm
Battery charge voltage:	9.6 V
Battery charge current:	1.6 A
Charging unit supply voltage:	100-240 V ~ 50-60 Hz
Charging time:	1 h
Battery type:	Lithium-ion
Weight	0.3 kg

Danger!

Sound and vibration

Sound and vibration values were measured in accordance with EN 60745.

L_{pA} sound pressure level	60 dB(A)
K_{pA} uncertainty	3 dB
L_{WA} sound power level	71 dB(A)
K_{WA} uncertainty	3 dB

Wear ear-muffs.

The impact of noise can cause damage to hearing.

Total vibration values (vector sum of three directions) determined in accordance with EN 60745.

Vibration emission value $a_h \leq 2.5 \text{ m/s}^2$
K uncertainty = 1.5 m/s^2

The specified vibration value was established in accordance with a standardized testing method. It may change according to how the electric equipment is used and may exceed the specified value in exceptional circumstances.

The specified vibration value can be used to compare the equipment with other electric power tools.

The specified vibration value can be used for initial assessment of a harmful effect.

Keep the noise emissions and vibrations to a minimum.

- Only use appliances which are in perfect working order.
- Service and clean the appliance regularly.
- Adapt your working style to suit the appliance.
- Do not overload the appliance.
- Have the appliance serviced whenever necessary.
- Switch the appliance off when it is not in use.
- Wear protective gloves.

Caution!

Residual risks

Even if you use this electric power tool in accordance with instructions, certain residual risks cannot be ruled out. The following hazards may arise in connection with the equipment's construction and layout:

1. Lung damage if no suitable protective dust mask is used.
2. Damage to hearing if no suitable ear protection is used.
3. Health damage caused by hand-arm vibrations if the equipment is used over a prolonged period or is not properly guided and maintained.

5. Before using the equipment

Charge the battery only with the charging unit supplied.

5.1 Charging the battery (Fig. 1)

The battery is protected from exhaustive discharge. An integrated protective circuit automatically switches off the equipment when the battery is flat.

Warning! Do not actuate the On/Off switch any more if the protective circuit has tripped. This may damage the battery.

1. Check that your mains voltage is the same as that marked on the rating plate.
2. Insert the plug of the charging station (4) into the socket outlet.
3. Now insert the device into the charging station (4).

The multifunction display (5) indicates the charge level during charging as shown by the 5 LEDs.

0-15%: All LEDs flash
 15-35%: LED 1 is lit, LEDs 2-5 flash
 35-55 %: LED 2 is lit, LEDs 3-5 flash
 55-75 %: LED 3 is lit, LEDs 4-5 flash
 75-90 %: LED 4 is lit, LED 5 flashes
 Ready for operation: All the LEDs are lit

Important! The handle may become a little warm during the charging process. This is normal.

If the battery fails to charge, please check

- whether there is voltage at the socket outlet
- whether there is good contact at the charging contacts of the charging unit

If the battery still fails to charge, send

- the charger
- the equipment

to our customer service center.

To ensure that items are properly packaged and delivered when you send them to us, please contact our customer service or the point of sale at which the equipment was purchased.

When shipping or disposing of batteries and cordless tools, always ensure that they are packed individually in plastic bags to prevent short circuits and fires.

5.2 Inserting the various tools (Figs. 3-4)

Danger!

Before inserting a tool (and before each tool change) switch of the drive unit.

1. Press the locking knob (3) and turn the collet chuck until the bolt locks into place.
2. Remove the clamp nut (2) using the chuck key (20), insert the matching clamping sleeve (21) and refit the clamp nut.
3. Insert the required tool (b) into the sleeve as far as the stop and tighten the clamp nut (2) using the chuck key (20).

The projection is not allowed to exceed 25 mm!

6. Starting up

6.1 On/Off switch (Fig. 1)

To switch the device on, press the On/Off switch (1).

To switch the device off, press the On/Off switch (1) again.

6.2 Speed selector (Fig. 5)

The required speed can be set with the speed controller (7).

- Press the + button to increase the speed.
- Press the – button to decrease the speed.

You can choose from 5 speed settings. The current speed during operation is shown on the multifunction display (5).

Important!

The speed that you set beforehand is saved and is retained when the device is started up again. When used for the first time and after charging, the device starts in setting 3.

The correct speed depends on the tool used and the type of material being processed.

6.3 Information on speed settings

- Small cutters/grinding pins: High speed
- Large cutters/grinding pins: Low speed

6.4 Work practice

- Exert only moderate pressure on the workpiece so that it can be machined at constant speed.
- Instead of accelerating your work, high pressure will cause the drive unit to slow down and even stop, thus overloading the motor.
- For your own safety, it is essential to secure small workpieces with a screw clamp or vise.
- Precision work/engraving: Hold the drive unit like a pen (single-handed).
- Rough work: Hold the drive unit like the handle of a hammer (two-handed).

6.5 Battery capacity indicator (Fig. 5 /Item 6)

The battery charge level indicator (6) lets you know when the device needs recharging again during operation.

The LED is lit green: The rechargeable battery is charged to between 20% and 100%.

The LED is lit red: The remaining charge is less than 20%. Recharge the battery.

6.6 Overloading/overheating (Fig. 5/Item 6)

The battery charge level indicator (6) will light up red if the equipment is overloaded. One explanation for this can be that too much pressure is exerted on the workpiece

→ Reduce the pressure.

If the equipment is overloaded for a lengthy period, it switches off automatically. The LED then flashes four times in succession

→ Switch the equipment on again and reduce the pressure on the workpiece.

If the equipment gets too hot, it switches off automatically.

→ Let the equipment cool down to room temperature.

6.7 Description of the accessories:

The accessories which are used the most can be kept on the charging station, as shown in Fig. 1.

Grinding pins (8):

In various grinding head shapes. For grinding and deburring metal and plastic.

Recommended speed setting: 3 – 4

Cutting pins (9):

For cutting + engraving plastic, wood, soft metal and glass.

Recommended speed setting: 2 – 4

Pot brushes (10):

For cleaning stone, metal, aluminium, etc.

Recommended speed setting: 4 – 5

Cutter (11):

For cutting plastic, wood and soft metal.

Recommended speed setting: 2 - 4

Grinding/sanding belts (15):

For grinding/sanding wood and plastic.

See the illustration (6) for fitting.

Recommended speed setting: 4 – 5

Polishing wheels (16):

For polishing brass, tin, copper, etc.

Also for use with polishing pastes.

See Fig. 7 for fitting.

Recommended speed setting: 3 – 4

Cutting wheels (17/19):

For cutting metal and plastic.

Fasten the cutting wheel to the clamping spindle (14). (see Fig. 8)

Recommended speed setting: 3 – 4

Grinding wheel (18):

For cleaning and sharpening blades and tools.

Fasten the grinding wheel to the clamping spindle (14). (see Fig. 8)

Recommended speed setting: 3 – 4

Collet chuck key (20):

For mounting accessory tools.

Sleeves (21):

Various sizes for mounting different accessory tools.

7. Cleaning, maintenance and ordering of spare parts**Danger!**

Always pull out the mains power plug before starting any cleaning work.

7.1 Cleaning

- Keep all safety devices, air vents and the motor housing free of dirt and dust as far as possible. Wipe the equipment with a clean cloth or blow it with compressed air at low pressure.
- We recommend that you clean the device immediately each time you have finished using it.
- Clean the equipment regularly with a moist cloth and some soft soap. Do not use cleaning agents or solvents; these could attack the plastic parts of the equipment. Ensure that no water can seep into the device. The ingress of water into an electric tool increases the risk of an electric shock.

7.2 Maintenance

There are no parts inside the equipment which require additional maintenance.

7.3 Ordering replacement parts:

Please quote the following data when ordering replacement parts:

- Type of machine
- Article number of the machine
- Identification number of the machine
- Replacement part number of the part required

For our latest prices and information please go to www.isc-gmbh.info

8. Disposal and recycling

The equipment is supplied in packaging to prevent it from being damaged in transit. The raw materials in this packaging can be reused or recycled. The equipment and its accessories are made of various types of material, such as metal and plastic. Never place defective equipment in your household refuse. The equipment should be taken to a suitable collection center for proper disposal. If you do not know the whereabouts of such a collection point, you should ask in your local council offices.

9. Storage

Store the equipment and accessories in a dark and dry place at above freezing temperature. The ideal storage temperature is between 5 and 30 °C. Store the electric tool in its original packaging.



For EU countries only

Never place any electric power tools in your household refuse.

To comply with European Directive 2012/19/EC concerning old electric and electronic equipment and its implementation in national laws, old electric power tools have to be separated from other waste and disposed of in an environment-friendly fashion, e.g. by taking to a recycling depot.

Recycling alternative to the return request:
As an alternative to returning the equipment to the manufacturer, the owner of the electrical equipment must make sure that the equipment is properly disposed of if he no longer wants to keep the equipment. The old equipment can be returned to a suitable collection point that will dispose of the equipment in accordance with the national recycling and waste disposal regulations. This does not apply to any accessories or aids without electrical components supplied with the old equipment.

The reprinting or reproduction by any other means, in whole or in part, of documentation and papers accompanying products is permitted only with the express consent of the iSC GmbH.

Subject to technical changes

This consignment contains lithium-ion batteries. In accordance with special provision 188 this consignment is not subject to the ADR regulations. Handle with care. Danger of ignition in case of damage to the consignment package. If the consignment package is damaged: Check and if necessary repackage.
For further information contact: 0049 9951 95920-66. Outside Germany charges will apply instead for a regular call to a landline number in Germany.

Service information

We have competent service partners in all countries named on the guarantee certificate whose contact details can also be found on the guarantee certificate. These partners will help you with all service requests such as repairs, spare and wearing part orders or the purchase of consumables.

Please note that the following parts of this product are subject to normal or natural wear and that the following parts are therefore also required for use as consumables.

Category	Example
Wear parts*	Carbon brushes, clamping spindles, arbors, sleeves, flexible shafts,
Consumables*	grinding wheels, grinding/sanding belts, cutters (routers), felt polishers, drill bits, grinding pins, cutting-off wheels, grinding heads, wire brushes
Missing parts	

* Not necessarily included in the scope of delivery!

In the event of defects or faults, please register the problem on the internet at www.isc-gmbh.info. Please ensure that you provide a precise description of the problem and answer the following questions in all cases:

- Did the equipment work at all or was it defective from the beginning?
- Did you notice anything (symptom or defect) prior to the failure?
- What malfunction does the equipment have in your opinion (main symptom)? Describe this malfunction.

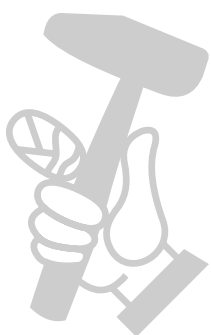

Warranty certificate

Dear Customer,

All of our products undergo strict quality checks to ensure that they reach you in perfect condition. In the unlikely event that your device develops a fault, please contact our service department at the address shown on this guarantee card. You can also contact us by telephone using the service number shown. Please note the following terms under which guarantee claims can be made:

1. These guarantee terms apply to consumers only, i.e. natural persons intending to use this product neither for their commercial activities nor for any other self-employed activities. These warranty terms regulate additional warranty services, which the manufacturer mentioned below promises to buyers of its new products in addition to their statutory rights of guarantee. Your statutory guarantee claims are not affected by this guarantee. Our guarantee is free of charge to you.
2. The warranty services cover only defects due to material or manufacturing faults on a product which you have bought from the manufacturer mentioned below and are limited to either the rectification of said defects on the product or the replacement of the product, whichever we prefer. Please note that our devices are not designed for use in commercial, trade or professional applications. A guarantee contract will not be created if the device has been used by commercial, trade or industrial business or has been exposed to similar stresses during the guarantee period.
3. The following are not covered by our guarantee:
 - Damage to the device caused by a failure to follow the assembly instructions or due to incorrect installation, a failure to follow the operating instructions (for example connecting it to an incorrect mains voltage or current type) or a failure to follow the maintenance and safety instructions or by exposing the device to abnormal environmental conditions or by lack of care and maintenance.
 - Damage to the device caused by abuse or incorrect use (for example overloading the device or the use of unapproved tools or accessories), ingress of foreign bodies into the device (such as sand, stones or dust, transport damage), the use of force or damage caused by external forces (for example by dropping it).
 - Damage to the device or parts of the device caused by normal or natural wear or tear or by normal use of the device.
4. The guarantee is valid for a period of 24 months starting from the purchase date of the device. Guarantee claims should be submitted before the end of the guarantee period within two weeks of the defect being noticed. No guarantee claims will be accepted after the end of the guarantee period. The original guarantee period remains applicable to the device even if repairs are carried out or parts are replaced. In such cases, the work performed or parts fitted will not result in an extension of the guarantee period, and no new guarantee will become active for the work performed or parts fitted. This also applies if an on-site service is used.
5. To make a claim under the guarantee, please register the defective device at: www.isc-gmbh.info. Please keep your bill of purchase or other proof of purchase for the new device. Devices that are returned without proof of purchase or without a rating plate shall not be covered by the guarantee, because appropriate identification will not be possible. If the defect is covered by our guarantee, then the item in question will either be repaired immediately and returned to you or we will send you a new replacement.

Of course, we are also happy offer a chargeable repair service for any defects which are not covered by the scope of this guarantee or for units which are no longer covered. To take advantage of this service, please send the device to our service address.

Also refer to the restrictions of this warranty concerning wear parts, consumables and missing parts as set out in the service information in these operating instructions.