

REA 100.0 PLUS

STIHL



2 - 33 Instruction Manual
33 - 68 Manual de instrucciones

! WARNING

Read Instruction Manual thoroughly before use and follow all safety precautions – improper use can cause serious or fatal injury.

! ADVERTENCIA

Antes de usar la máquina lea y siga todas las precauciones de seguridad dadas en el manual de instrucciones – el uso incorrecto puede causar lesiones graves o mortales.



Contents

1	Introduction.....	2
2	Guide to Using this Manual.....	2
3	Main Parts.....	3
4	Safety Symbols on the Products.....	4
5	IMPORTANT SAFETY INSTRUCTIONS....	4
6	Battery Safety.....	11
7	Maintenance, Repair and Storage.....	12
8	Before Starting Work.....	13
9	Charging the Battery.....	13
10	LED Diagnostics.....	14
11	Bluetooth® Radio Interface.....	15
12	Assembling the Pressure Washer.....	15
13	Connecting the Water Supply.....	17
14	Inserting and Removing the Battery.....	19
15	Switching the Pressure Washer On and Off	20
16	Checking the Controls.....	20
17	During Operation.....	21
18	After Finishing Work.....	23
19	Transporting.....	24
20	Storing.....	25
21	Cleaning.....	26
22	Inspection and Maintenance.....	27
23	Troubleshooting Guide.....	28
24	Specifications.....	29
25	Replacement Parts and Equipment.....	32
26	Disposal.....	32
27	Limited Warranty.....	32
28	Trademarks.....	32
29	Addresses.....	33

1 Introduction

Thank you for your purchase. The information contained in this manual will help you receive maximum performance and satisfaction from your STIHL pressure washer and, if followed, reduce the risk of injury from its use.

SAVE THIS MANUAL!



Because this pressure washer is battery-powered and produces a strong water jet, special safety precautions must be observed to reduce the risk of personal injury.



Read this instruction manual thoroughly before use and periodically thereafter. Follow all safety precautions. Careless or improper use of the pressure washer can cause serious or fatal injury.

Do not lend or rent your pressure washer without this instruction manual. Allow only persons who fully understand the information in this manual to operate the pressure washer.

For further information, or if you do not understand any of the instructions in this manual, please go to www.stihlusa.com or contact your authorized STIHL servicing dealer.

2 Guide to Using this Manual

2.1 Signal Words

This manual contains safety information that requires your special attention. Such information is introduced with the following symbols and signal words:



DANGER

- Indicates a hazardous situation which, if not avoided, will result in death or serious injury.



WARNING

- Indicates a hazardous situation which, if not avoided, could result in death or serious injury.

NOTICE

- Indicates a risk of property damage, including damage to the machine or its individual components.

2.2 Symbols in Text

The following symbol is included to assist you with the use of the manual:



Refers to a designated chapter or sub-chapter in this instruction manual.

3 Main Parts

3.1 Pressure Washer and Battery

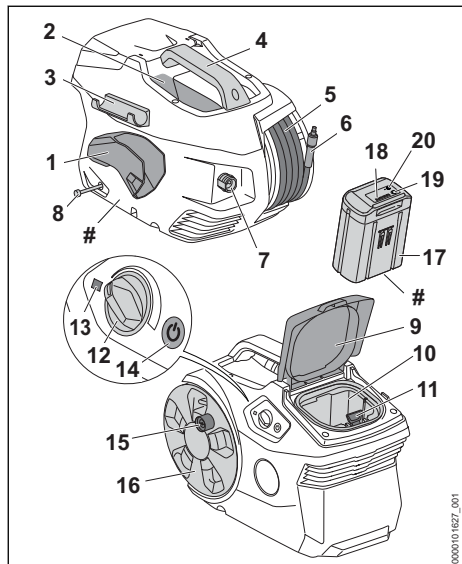

- 1 Holder for Spray Gun**
For storing the spray gun.
- 2 Storage Compartment**
For storing the high-pressure nozzle.
- 3 Holder for Spray Lance**
For storing the spray lance.
- 4 Carrying Handle**
For lifting and transporting the pressure washer.
- 5 High-pressure Hose**
Carries the water from the high-pressure pump to the spray gun.
- 6 Coupling**
For connecting the high-pressure hose to the spray gun.
- 7 Connector for Water Inlet**
For connecting the water hose to the high-pressure pump.
- 8 Detergent Hose**
For drawing in the detergent.
- 9 Battery Compartment Cover**
Covers the battery and battery compartment.
- 10 Battery Compartment**
Holds the battery.

- 11 Locking Lever**
Secures the battery in the battery compartment.
- 12 Rotary Control**
For adjusting the operating pressure and the flow rate of the high-pressure jet.
- 13 Pressure Washer LED**
Indicates the operating status of the pressure washer.
- 14 Power Button**
Switches the motor on and off.
- 15 Crank Handle**
For turning the hose reel.
- 16 Hose Reel**
For rolling up the high-pressure hose.
- 17 Battery**
Supplies electrical power to the motor.
- 18 Battery LEDs**
Indicate the battery's state of charge and display error messages regarding potential malfunctions in the battery or power tool.
- 19 Push Button**
Activates the battery's LEDs. Activates and deactivates the Bluetooth® interface (if applicable).
- 20 "BLUETOOTH®" LED (only for batteries with )**
Indicates whether the Bluetooth® interface is enabled or disabled.
- # Rating Plate**
Contains electrical information and the product's serial number.

3.2 Spray Attachment

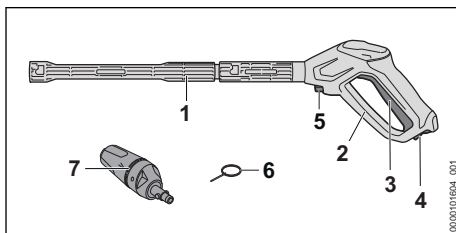

- 1 Spray Lance**
Directs the water from the spray gun to the high-pressure nozzle.
- 2 Spray Gun**
For controlling and directing the water jet.
- 3 Spray Gun Trigger**
Opens and closes the valve in the spray gun.

4 Retaining Latch

Locks/unlocks the spray gun trigger.

5 Coupling for High-Pressure Hose

For connecting the high-pressure hose to the spray gun.

6 Cleaning Needle

For removing dirt and debris from the spray nozzles.

7 3-in-1 Nozzle

The 3-in-1 nozzle consists of a fan-jet nozzle, a rotary nozzle and a detergent nozzle to which cleaning agent can be added.

4 Safety Symbols on the Products

4.1 Pressure Washer

The following safety symbols are found on the pressure washer:



To reduce the risk of injury, follow the specified safety precautions.



Read and follow all safety precautions in the instruction manual. Improper use can lead to serious or fatal personal injury or property damage.



To reduce the risk of eye injury, always wear proper eye protection, [§ 5.4](#).



To reduce the risk of cut injuries, keep hands, feet and other body parts away from the water jet, [§ 5.7.4](#).



To reduce the risk of serious or fatal injury to the operator or bystanders, never direct the high-pressure jet toward the operator, bystanders or animals, not even to clean clothing or shoes, [§ 5.7.4](#).



To reduce the risk of short-circuit, fire or electrocution, never spray near power sources. Do not rely on the pressure washer's insulation against electric shock, [§ 5.7.4](#).



To reduce the risk of short-circuit, fire or electrocution, never direct the spray at electrical appliances and equipment, sockets or power cords, [§ 5.7.4](#).



To reduce the risk of fire/explosion resulting in serious or fatal injury or property damage, never spray flammable or combustible liquids, [§ 5.7.4](#).



To reduce the risk of damage to the pressure washer, do not allow the pressure washer to be used or stored in freezing temperatures. Store the pressure washer indoors in a dry, secure place that cannot be accessed by children or other unauthorized users, [§ 7](#).



To reduce the risk of injury or property damage from unintended activation, remove the battery any time the pressure washer is not in use, [§ 5.5](#).

4.2 Battery

The following safety symbols are found on the AP series battery:



To reduce the risk of injury, follow the specified safety precautions.



Read and follow all safety precautions in the battery's instruction manual and the manual for the STIHL tool powered by this battery. Improper use can lead to serious or fatal personal injury or property damage.



To reduce the risk of personal injury or property damage from fire, explosion or burns, including chemical burns, do not disassemble, crush, drop, damage or heat above 212 °F (100 °C). Never expose to fire or incinerate, [§ 6.1](#).



To reduce the risk of personal injury or property damage from a short circuit, fire or explosion, keep dry. Never immerse in water or other liquids, [§ 6.1](#).

Batteries sold separately.

5 IMPORTANT SAFETY INSTRUCTIONS

5.1 General Safety Warnings and Instructions

This section contains the prescribed general safety warnings and instructions for electric high-pressure cleaners / pressure washers. Additional

important warnings and instructions are provided in subsequent sections of this manual.

▲ WARNING

When using electric pressure washers, basic safety precautions should always be followed to reduce the risk of fire, electric shock and personal injury, including the following:

- 1) Read all the instructions before using the product.
- 2) To reduce the risk of injury, close supervision is necessary when a product is used near children.
- 3) Know how to stop the product and bleed pressures quickly. Be thoroughly familiar with the controls.
- 4) Stay alert – watch what you are doing.
- 5) Do not operate the product when fatigued or under the influence of alcohol or drugs.
- 6) Keep operating area clear of all persons.
- 7) Do not overreach or stand on unstable support. Keep good footing and balance at all times.
- 8) Follow the maintenance instructions specified in the manual.
- 9) WARNING – Risk of eye injury. Spray can splash back or propel objects. Always wear properly rated eye protection such as safety goggles or face shield while spraying. (Safety glasses do not provide full protection.)

ADDITIONAL SAFETY INFORMATION

▲ WARNING

- Read and follow all safety precautions on labels and in instruction manual. Failure to follow these instructions can cause serious or fatal injury.
- Spray jet can splash back and propel objects at high speed. To reduce the risk of eye injury, always wear goggles that are impact-rated and comply with ANSI Z87 "+". Goggles must also be rated for protection against droplet/splash hazards according to ANSI Z87.1.
- Keep bystanders and animals out of the work area.
- See rating plate for maximum discharge pressure and maximum discharge temperature – use only high pressure hoses and accessories rated for these amounts

or above. Use only genuine STIHL replacement parts.

- Spray gun produces strong recoil (kick-back) opposite to direction of spray. Hold firmly with both hands to reduce the risk of injury from loss of control.
- Because of high pressure and water velocity, spray jet is very powerful. To reduce risk of severe lacerations and injection of fluids below the skin, never direct spray jet towards self, other persons or animals. Keep clear of nozzle while machine is operating. Make sure spray jet does not damage object being cleaned.
- To reduce risk of fire and explosion, never spray flammable liquids.
- To reduce risk of electrocution and fire, never direct spray jet towards the machine itself, other electrical appliances or equipment, sockets or power cords. Never spray near power source.
- Protect against frost.
- Store indoors.
- If connection is made to a potable water system, the system must be protected against backflow.

5.2 Intended Use

▲ WARNING

- This pressure washer is designed for cleaning jobs around the home and garden, cleaning garden furniture, walkways, patios, vehicles, trailers and other similar applications.
- Use your pressure washer only for cleaning solid surfaces and other items that will not be damaged by water or the force of the spray jet.
- Use the pressure washer and battery only as described in this manual. Do not use it for other purposes, since misuse may result in personal injury or property damage, including damage to the pressure washer or battery.
 - Never attempt to modify or override the pressure washer's controls or safety devices in any way.
 - Never use a pressure washer that has been modified or altered from its original design.
- This power tool may be powered by a STIHL AP series battery.

The STIHL AP battery with  uses Bluetooth® technology to exchange information with mobile devices running the STIHL connected App.

Batteries, chargers and other accessories are sold separately.

5.3 Operator

▲ WARNING

- Working with the pressure washer can be strenuous. The operator must be in good physical condition and mental health. To reduce the risk of personal injury:
 - Check with your doctor before using the pressure washer if you have any health condition that may be aggravated by strenuous work.
 - Do not operate the pressure washer while under the influence of any substance (drug, alcohol or medication, etc.) that might impair vision, balance, dexterity or judgment.
 - Be alert. Do not operate the pressure washer when you are tired. Take a break if you become tired.
 - Do not permit minors to use the pressure washer.
 - Bystanders, especially children, and animals should not be allowed in the area where the pressure washer is in use.
- According to STIHL's current knowledge, the electric motor of this pressure washer should not interfere with a pacemaker.
 - However, persons with a pacemaker or other implanted medical device should consult their physician and device manufacturer before operating this pressure washer.

5.4 Personal Protective Equipment

▲ WARNING

- To reduce the risk of personal injury:
 - Always wear proper clothing and protective apparel, including proper eye protection.
- To reduce the risk of eye injury:
 - Always wear goggles that are impact-rated and marked as complying with ANSI Z87 "+". Goggles must also be rated for protection against droplet/splash hazards according to ANSI Z87.1.
 - Safety glasses do not provide full protection.
- Good footing is very important. To help maintain a secure footing and reduce the risk of injury while working:



- Wear sturdy boots with non-slip, rubber soles. Do not wear sandals, flip-flops, open-toed or similar footwear.

- To reduce the risk of electric shock:
 - Wear rubber-soled footwear that provides insulation when operating the pressure washer.
- Aqueous aerosols may form while working with a pressure washer. Inhalation of some aerosols can be hazardous. To determine the measures necessary to protect against aqueous aerosols, carry out a risk assessment before starting work. Depending on your risk assessment, class FFP2 or higher respirators may be necessary.

5.5 Pressure Washer

▲ WARNING

- To reduce the risk of electric shock, fire and explosion:
 - Do not immerse the pressure washer in water or other fluids.
 - Store the pressure washer indoors.
 - Never use your pressure washer if the battery compartment cover or casing around the motor is cracked or damaged.
- Using the battery-powered pressure washer for other purposes than intended may increase the risk of personal injury and property damage.
 - Read and follow the operating instructions in this manual for approved applications,  17.
- To reduce the risk of personal injury to the operator and bystanders:



- Always switch off the pressure washer, remove the battery, relieve system pressure and lock the spray gun trigger before assembling, transporting, adjusting, inspecting, cleaning, servicing, maintaining or storing the pressure washer, and any other time it is not in use.
- Release the trigger switch and remove the battery before clearing jammed material.
- Never leave the pressure washer unattended when the battery is inserted.
- Although certain unauthorized attachments may fit your STIHL pressure washer, their use may be extremely dangerous. Only attachments supplied by STIHL or expressly

approved by STIHL for use with this specific model are recommended.

- Use only attachments supplied or expressly approved by STIHL.
- Never modify this pressure washer in any way.
- Never attempt to modify or override the pressure washer's controls or safety devices in any way.
- Never use a pressure washer that has been modified or altered from its original design.
- If the pressure washer is dropped or subjected to similar heavy impacts:
 - Check that it is undamaged, in good condition and functioning properly before continuing work.
 - Check that the controls and safety devices are working properly.
 - Check the LEDs on the battery for error messages,  23.
 - Check that the battery has not been damaged. Never use or charge a malfunctioning, damaged, cracked, leaking or deformed battery.
 - Never work with a damaged or malfunctioning pressure washer or battery. In case of doubt, have the pressure washer and battery checked by your authorized STIHL servicing dealer.
- If the pressure washer is damaged, not working properly, has been left outdoors or exposed to rain, its components may no longer function properly and safety devices may be inoperative. To reduce the risk of personal injury and property damage:
 - Take the pressure washer to your authorized STIHL servicing dealer to be checked before further operation.
- Genuine STIHL replacement parts are specifically designed to match your pressure washer and meet safety and performance requirements. Use of parts that are not authorized or approved by STIHL may cause serious or fatal injury or property damage.
 - STIHL recommends that only identical STIHL replacement parts be used.

5.6 Connecting the Water Supply

WARNING

- When the spray gun trigger is released, fluid recoil may push non-potable water back into the potable water system.



- Do not connect the pressure washer directly to a potable water system.

- If hooking up the pressure washer to a potable water system, a backflow preventer must be installed between the water tap and the hose. The design of the backflow preventer must comply with all applicable water management codes and regulations in your area.

- If potable water has passed through the backflow preventer, it can no longer be regarded as potable water. To prevent contamination of potable water:
 - Follow the rules issued by the local water authority to prevent water flowing back from the pressure washer into the drinking water main.
 - Do not use the pressure washer with dirty water (i.e., water that contains sand, dirt or other particulate matter). If there is a risk that the water supply is dirty, use an appropriate water filter or find an alternative water source.

5.7 Using the Pressure Washer

5.7.1 Before Operation

WARNING

- Misuse or unauthorized use may result in personal injury and property damage.
 - Use the pressure washer only as described in this instruction manual.
- Using a pressure washer that is modified, damaged, improperly adjusted or maintained, or not completely and securely assembled can lead to a malfunction and increase the risk of serious personal injury or death.
 - Never operate a pressure washer that is modified damaged, improperly maintained or not completely and securely assembled.
 - Always check your pressure washer for proper condition and operation before starting work, particularly the spray gun trigger and retaining latch.
 - Ensure that the spray gun trigger and retaining latch move freely. The spray gun trigger switch must not engage until the retaining latch is moved to the unlocked position.
 - Never attempt to modify or override the controls or safety devices in any way.

- If your pressure washer or any part is damaged or does not function properly, take it to your authorized STIHL servicing dealer. Do not use the pressure washer until the problem has been corrected.
- Exposing the battery to water, detergent, or contaminants increases the risk of short circuit, fire and explosion.
 - Never operate the pressure washer without the battery compartment cover properly secured in place.
 - If the battery compartment cover is missing, worn or damaged, replace it before starting work.
- Before inserting the battery:
 - Check the contacts in the battery compartment for corrosion or other foreign matter and keep clean.
 - Never insert or use a malfunctioning, damaged, cracked, leaking or deformed battery.
 - Read and follow the instructions on switching on the pressure washer,  15.1.
 - Ensure that the high-pressure hose is in good condition and not frayed, cracked, deformed or damaged in any way. Never operate the machine with a damaged or worn high-pressure hose.
- To help reduce the risk of serious personal injury or death from unintentional starting:
 - Be sure the spray gun trigger is in the off position before inserting the battery.
 - Never carry the pressure washer with your finger on the spray gun trigger.
 - Release the spray gun trigger before removing the battery.



- Switch off the pressure washer, remove the battery, relieve system pressure, lock the spray gun trigger and disconnect from the power supply before assembling, transporting, adjusting, inspecting, cleaning, servicing, maintaining or storing the pressure washer, and any other time it is not in use.

- Always switch off the pressure washer, remove the battery, relieve system pressure and lock the spray gun trigger before attempting to remove the high pressure hose or spray lance from the spray gun.
- Always switch off the pressure washer, remove the battery, relieve system pressure and lock the spray gun trigger before

- attempting to adjust or change a spray nozzle or other accessory.
- Never leave the pressure washer unattended when the battery is inserted.
- Never store the battery in the pressure washer.

5.7.2 Holding and Controlling the Pressure Washer

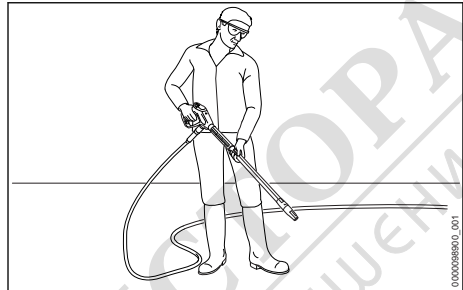

▲ WARNING

- To maintain a firm grip and properly control your pressure washer:
 - Keep the spray attachment clean and dry at all times. Keep it free of moisture, pitch, oil, grease and resin.
- To reduce the risk of serious or fatal injuries to the operator or bystanders from loss of control:
 - Always hold the spray attachment firmly with both hands when you are working.
 - Wrap your fingers tightly around the spray gun and spray lance.
 - Position the spray attachment in such a way that all parts of your body are clear of the water jet whenever the battery is inserted.
- Operating the pressure washer with one hand is extremely dangerous. One-handed operation makes it difficult to oppose and absorb reactive forces (recoil) without losing control of the pressure washer. To reduce the risk of serious or fatal injury to the operator or bystanders from loss of control:
 - Never attempt to operate the pressure washer with one hand.
- Because of the high pressure and spray velocity, fluids can penetrate the skin and cause fluid injection and/or severe injury. To reduce the risk of serious or fatal injuries to the operator or bystanders from loss of control, keep proper footing and balance at all times:
 - Take special care in overgrown or wet terrain and always watch for hidden obsta-

- cles such as tree stumps, roots, rocks, holes and ditches to avoid stumbling or falling.
- Be extremely cautious when working on slopes or uneven ground.
- To reduce the risk of injury from loss of control:
 - Never work on a ladder, roof, in a tree or while standing on any other insecure support.
 - Never operate the pressure washer above shoulder height.
 - Do not overreach. Keep proper footing and balance at all times.

5.7.3 Working Conditions

▲ WARNING

- Operate your pressure washer only under good visibility during favorable daylight conditions.
 - Postpone the work if the weather is windy, foggy, rainy or inclement.
- Your pressure washer is a one-person machine.
 - Do not allow other persons in the general work area.
 - Bystanders, especially children, and animals should not be allowed in the area where it is in use.
 - Switch off the motor immediately if you are approached.
- To reduce the risk of injury to bystanders and unauthorized users:
 - Never leave the pressure washer unattended when the battery is inserted.
 - Switch off the pressure washer and remove the battery during work breaks and any other time the pressure washer is not in use.
- Sparks generated from operation of the pressure washer may be capable of igniting combustible gases, liquids, vapors, dusts or other combustible materials and substances. To reduce the risk of fire and explosion:
 - Never operate the pressure washer in a location where combustible gases, liquids, vapors, dusts or other combustible materials and substances are present.
 - Read and follow recommendations issued by government authorities (e.g., OSHA) for identifying and avoiding the hazards of combustible gases, liquids, vapors, dusts or other combustible materials and substances.
- Spraying certain materials with the water jet may produce dust or a mist containing particulate matter capable of causing respiratory disease, cancer, birth defects and other serious harm.
 - Never spray any surface containing lead paint.
 - Never spray asbestos-containing materials such as asbestos cement or asbestos siding. Hazardous, breathable asbestos fibers may be released in addition to the dirt.
 - Consult governmental agencies such as EPA, OSHA, CARB and NIOSH and other authoritative sources on hazardous materials if you are unfamiliar with the risks associated with the particular substances you are spraying.
- Inhalation of certain dusts, especially organic dusts such as mold or pollen, can cause susceptible persons to have an allergic or asthmatic reaction. Substantial or repeated inhalation of dust or other airborne contaminants, especially those with a smaller particle size, may cause respiratory or other illnesses.
 - Control dust and mists at the source where possible.
 - To the extent possible, operate the pressure washer so that the wind or operating process directs any dust, mist or other particulate matter raised by the pressure washer away from the operator.
 - When respirable dust or other particulate matter cannot be kept at or near background levels, always wear a respirator that is approved by NIOSH and rated for worksite-specific conditions. Follow the recommendations of governmental authorities (e.g., OSHA/NIOSH) and occupational and trade associations.
- Breathing asbestos dust is dangerous and can cause severe or fatal injury, respiratory illness or cancer, including mesothelioma. The use and disposal of asbestos-containing products is strictly regulated by OSHA and EPA.
 - Stop work immediately and contact the relevant state and local authorities and/or EPA, your employer or local OSHA representative if you have reason to believe that you might be disturbing asbestos.

5.7.4 Operating Instructions

▲ WARNING

- In the event of an emergency:

- Switch off the motor immediately and remove the battery.

- To reduce the risk of fire/explosion resulting in serious or fatal injury or property damage:



- Never spray flammable or combustible liquids.
- Never draw fluids into the pump that contain solvents or undiluted acids (e.g., gasoline, heating oil, paint thinner or acetone).



- Because of the high pressure and spray velocity, fluids can penetrate the skin and cause fluid injection and/or severe injury.



- Never direct the high-pressure jet toward yourself or other persons, not even to clean clothing or shoes.
- Do not direct the high-pressure jet toward animals.



- Keep hands, feet and other parts of your body away from the water jet at all times.

- Do not direct the high-pressure jet into places you cannot see.
- Switch off the pressure washer, remove the battery, relieve system pressure and lock the spray gun trigger before changing or adjusting any spray nozzle or accessory.
- If an accident does occur and the spray appears to have penetrated the skin, seek emergency medical care. Do not treat as a simple cut.

- To reduce the risk of property damage or serious personal injury:

- Start work at the greatest effective distance from the surface being cleaned. Do not move so close that the surface is damaged by the force of the spray.
- Be especially careful when spraying softer materials such as fabric.
- Use caution when directing spray toward fragile materials such as glass. It could shatter.

- This pressure washer was designed for use with water alone or with a detergent specifically designed and approved for use with pressure washers. Use of unsuitable detergents or cleaning agents can cause personal injury and

damage the pressure washer and/or the surface being cleaned.

- Always use the detergent in the dosage specified in the detergent manufacturer's instructions for proper preparation and dilution, as well as safe use and disposal.

- Chemical detergents may contain harmful (toxic, caustic, irritant), flammable or explosive substances. They are potentially harmful and can cause skin and eye irritation, chemical burns and other serious personal injury.

- Avoid contact with skin and eyes.
- In the event of accidental contact, immediately rinse the contact area thoroughly with plenty of clean water.
- If fluid gets into your eye(s): Do not rub. Rinse water over the open eye(s) for at least 15 minutes and seek medical attention.

- To reduce the risk of injury to bystanders:
 - Do not allow other persons in the general work area.

⚠ WARNING

- To reduce the risk of short-circuit, fire or electrocution:

- Never direct the high-pressure jet toward the pressure washer itself or any of its components.

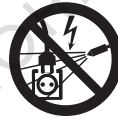

- Never direct the spray at electrical appliances and equipment, sockets or power cords.



- Never spray near electrical outlets or other power sources.
- Never use your pressure washer if the battery compartment cover or casing around the motor is cracked or damaged.

NOTICE

- Running the pressure washer without water will cause the pump to overheat, which may result in permanent damage. Always connect and turn on the water supply to the pump before starting the motor. Do not operate the pressure washer without water.

6 Battery Safety

6.1 Warnings and Instructions

▲ WARNING

- Read and follow the safety precautions on the battery and all warnings and instructions that accompany it.
- Use of unauthorized batteries can damage the power tool and result in fire, explosion and personal injury and property damage.
 - Use only genuine STIHL AP series batteries with this power tool.
- Use of STIHL AP series batteries for any purpose other than powering STIHL products could be extremely dangerous.
 - Use STIHL AP series batteries only to power compatible STIHL products.
- Use of unauthorized chargers can damage the battery and result in fire, explosion and personal injury and property damage.
 - Charge STIHL AP series batteries only with genuine STIHL AL 101, AL 301, AL 301-4 or AL 500 series chargers.
- The battery contains safety features and devices which, if damaged, may allow the battery to generate heat, rupture, leak, ignite or explode.



- Never heat the battery above 212 °F (100 °C).
- Never incinerate or place the battery on or near fires, stoves or other high-temperature locations.
- Never use or charge a malfunctioning, damaged, cracked, leaking or deformed battery.
- Never open, disassemble, crush, drop, subject to heavy impact or otherwise damage the battery.
- Never expose the battery to microwaves or high pressures.
- Never insert objects into the battery's cooling slots.
- Extreme temperatures may cause the battery to generate heat, rupture, leak, ignite or explode, resulting in severe or fatal personal injury and property damage.
 - Never charge, use or store the battery outside the specified ambient temperature limits,  24.3.
- To reduce the risk of personal injury and property damage in the event the battery emits smoke, has an unusual smell or feels unusually hot while using, charging or storing:

– Immediately discontinue using or charging the battery. Contact the authorities in the event of fire or explosion.

- To reduce the risk of a short circuit, which could lead to electric shock, fire and explosion:



- If a STIHL AP battery has been exposed to rain during work, remove it from the product and allow it to dry indoors. Make sure it is completely dry before charging or using.
- Do not handle the battery with wet hands.
- Never immerse any STIHL battery in water or other liquids.
- Never bridge the battery terminals with wires or other metallic objects.
- Keep a battery that is not in use away from small metal objects capable of conducting electricity (e.g., paper clips, nails, coins, keys).
- Store the battery indoors in a dry room.
- Never store the battery in damp or corrosive environments or in conditions that could lead to corrosion of its metal components.
- Never store the battery in the power tool.
- When storing the battery, maintain a charge of 40 % to 60 % for STIHL AP series batteries (2 green LEDs).
- If storing the battery in the charger, disconnect the charger from the outlet.
- Protect the battery from exposure to corrosive agents such as garden chemicals and de-icing salts.
- Protect the battery from exposure to conductive liquids such as salt water.
- Do not attempt to repair, open or disassemble the battery. There are no user-serviceable parts inside.
- Leaking battery fluid is potentially harmful and can cause skin and eye irritation, chemical burns and other serious personal injury.
 - Avoid contact with skin and eyes.
 - Use an inert absorbent such as sand on spilled battery fluid.
 - In the event of accidental contact, immediately rinse the contact area thoroughly with mild soap and water.
 - If fluid gets into your eye(s): do not rub. Rinse water over the open eye(s) for at least 15 minutes and seek medical attention.

- A battery fire can be dangerous. To reduce the risk of severe personal injury and property damage in the event of fire:
 - Evacuate the area. Fire can spread rapidly. Stay clear of any vapors generated and maintain a safe distance.
 - Contact the fire department.
 - Although water can be used to put out a battery fire, use of a multi-purpose dry chemical fire extinguisher is preferable.
 - Consult the fire department regarding proper disposal of a burned battery.
- Dropping the battery could result in personal injury or property damage. To prevent the battery from falling during removal:
 - Place the pressure washer on a level surface.
 - Use care when ejecting the battery.

7 Maintenance, Repair and Storage

7.1 Warnings and Instructions

▲ WARNING

- To reduce the risk of fire, electric shock or other personal injury and property damage:
 - Strictly follow the cleaning and maintenance instructions in the appropriate sections of this instruction manual.
 - STIHL recommends that all repair work be performed by authorized STIHL servicing dealers.
- Unintentional starting may result in personal injury or property damage. To reduce the risk of personal injury and property damage from unintentional starting:



– Switch off the pressure washer, remove the battery, turn off the water supply and squeeze the spray gun trigger until the pressure in the system has been fully released. Then, lock the spray gun trigger before inspecting the pressure washer or carrying out any cleaning, maintenance or repair work, before storing, and any other time the pressure washer is not in use.

- Unintentional starting may result in personal injury or property damage. To reduce the risk of personal injury and property damage from unintentional starting:
 - Switch off the pressure washer, remove the battery, turn off the water supply and

squeeze the spray gun trigger until the pressure in the system has been fully released. Then, lock the spray gun trigger before inspecting the pressure washer or carrying out any cleaning, maintenance or repair work, before storing, and any other time it is not in use.

- Use of parts that are not authorized or approved by STIHL may cause serious or fatal injury or property damage.
 - STIHL recommends that only identical STIHL replacement parts be used for repair or maintenance.
 - If using a replacement or accessory high-pressure hose, ensure that it is rated for the maximum PSI of the pressure washer.
 - If using a replacement spray gun or lance, or any other spray accessory, ensure that it is rated for the maximum PSI of the pressure washer.
- To reduce the risk of electric shock:
 - Unplug the charger from the electrical outlet before inspecting or cleaning the charger.
 - Regularly check the charger and ensure that the insulation of the power supply cord and plug are in good condition and show no signs of aging (brittleness), wear or damage.
 - Have a damaged power supply cord replaced by an authorized STIHL servicing dealer.
- To reduce the risk of short circuit, fire or explosion:
 - Never operate the pressure washer without the battery compartment cover properly secured in place.
 - Never use your pressure washer if the battery compartment cover or casing around the motor is cracked or damaged.
 - If the battery compartment cover is missing, worn or damaged, replace it before starting work.
- To reduce the risk of short circuit and fire:
 - Keep the battery guides dry and free of foreign matter. Clean as necessary with a dry cloth or soft, dry brush.
- Improper storage can result in unauthorized use, damage to the pressure washer and battery, and an increased risk of fire, electric shock and other personal injury or property damage.
 - Remove the battery from the pressure washer before storing.
 - Never store the pressure washer with the battery inserted.



- Do not transport, use or store the unit in freezing temperatures.
- If the pressure washer must be transported or stored in freezing conditions, the pump must be filled with antifreeze to prevent cracking due to water expansion, 18.2.

- When storing the battery, maintain a charge of 40 % to 60 % for STIHL AP series batteries (2 green LEDs).
- If storing the battery in the charger, disconnect the charger from the outlet.
- Store the pressure washer and battery indoors in a dry, secure place that cannot be accessed by children or other unauthorized users.
- Never store the battery in the pressure washer or in a container with small metal objects capable of conducting electricity (e.g., paper clips, nails, coins, keys).

SAVE THESE INSTRUCTIONS!

8 Before Starting Work

8.1 Preparing the Pressure Washer for Operation

Before starting work:

- ▶ Fully charge the battery, 9.2.
- ▶ Check the controls for proper function and condition, 16.1.
- ▶ Place the pressure washer on flat and firm ground or other solid surface in an open area.
- ▶ Connect the spray gun and lance, 12.2.1.
- ▶ Insert the spray nozzle, 12.3.1.
- ▶ If desired, add detergent, 17.4.
- ▶ Connect the water supply, 13.1.

8.2 Connecting to the STIHL connected App

- ▶ Turn on your mobile device's Bluetooth® interface.
- ▶ Turn on the battery's Bluetooth® interface, 11.1.
- ▶ Download the STIHL connected App from Google Play or the App Store.
- ▶ Follow in-app instructions for creating a new user account. Returning users should log in their existing account information.
- ▶ Follow the step-by-step instructions for adding the battery to your equipment list.

9 Charging the Battery

9.1 Setting up the Charger



WARNING

- Read and follow the safety precautions on the battery and charger and all warnings and instructions that accompany those products. To reduce the risk of short circuit, which could lead to electric shock, fire and explosion, make sure the charger and its components are dry and not damaged. Read and follow the warnings and instructions in your charger's manual. For optimum performance, observe the recommended ambient temperature ranges, 24.4.



WARNING

- A typical household electric circuit is between 15 and 20 amps. A single STIHL AL 500 charger draws approximately 4.8 amps. A single AL 301 or AL 301-4 charger draws approximately 4.4 amps and an AL 101 approximately 1.3 amps. To reduce the risk of fire from overloading an electrical circuit:
 - Ensure the electrical system is rated to withstand the expected electrical draw before charging your battery.
 - Charge multiple batteries one at a time or on separate circuits, unless you know your circuit can handle the total expected draw from multiple chargers.



WARNING

- Since the charger heats up during the charging process, do not operate the charger on a combustible surface or in a location where combustible gases, liquids, vapors, dusts or other materials and substances are present.

To set up the charger:

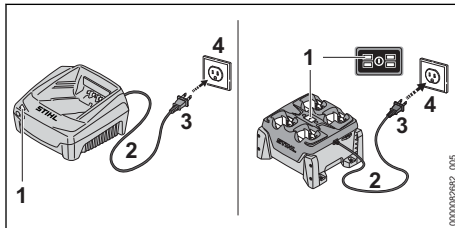

- ▶ Insert the plug (3) into a properly installed electrical outlet (4) matching the voltage and electrical frequency stated on the charger's rating plate.

The charger runs a self-test immediately after it is plugged in. The charger LED (1) will glow green for about 1 second, then it will glow red briefly before going out. Once the LED goes out, the self-test is complete and the charger is ready to charge the battery.

- ▶ Position the power supply cord (2) so that it will not be stepped on, tripped over, come in contact with sharp objects or moving parts or otherwise be subjected to damage or stress.

9.2 Charging



WARNING

- STIHL batteries contain safety features and devices which, if damaged, may allow the battery to generate heat, rupture, leak, ignite or explode. Never charge a malfunctioning, damaged, cracked, leaking or deformed battery or use a charger that has been damaged. Never insert a wet battery or adapter. Never use a wet charger. Follow all product-specific warnings and instructions accompanying your battery and charger.

A battery is not fully charged when it ships from the factory. STIHL recommends that you fully charge the battery before using it the first time.

Read and follow the warnings and instructions in your charger's manual. For optimum performance, observe the recommended ambient temperature ranges,  24.4.

The battery heats up during operation of the power tool. If a hot battery is connected to the charger, it may be necessary for it to cool down before charging starts. The charging process begins only after the battery has cooled down sufficiently.

Charging time depends on a number of factors, including battery condition and the ambient temperature. For a complete list of approximate charging times, see www.stihl.com/charging-times.

To charge an AP battery:

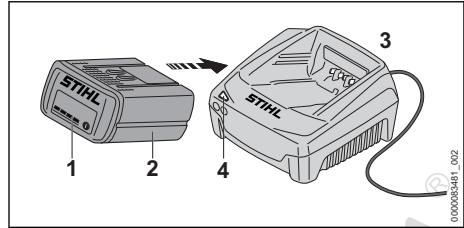

- ▶ Push the battery (2) into the charger (3) until it stops.
The LED on the **charger** glows green when the battery is charging.
The LEDs (1) on the **battery** glow green and show the state of charge.
When the LEDs on the battery go out, the charging process is complete and the charger will shut itself off. The battery can be removed from the charger.
- ▶ Disconnect the power supply cord from the electrical outlet when the charger is not in use for extended periods of time.
- ▶ Charge STIHL AP series batteries only with genuine STIHL AL 101, AL 301, AL 301-4 or AL 500 series chargers.

10 LED Diagnostics

10.1 STIHL AP Battery

10.1.1 Battery Status

Four LEDs show the status of the battery. These LEDs can glow or flash green or red.

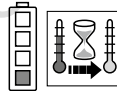

If one LED glows red continuously: the battery is either too hot or too cold. Allow the battery to warm up or cool down gradually at an ambient temperature of about 50 °F to 68 °F (10 °C to 20 °C).

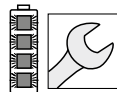

If all 4 LEDs flash red: the battery has a malfunction and must be replaced. Do not attempt to charge, use or store the battery.

10.1.2 Charge Status

The LEDs on the battery also show the battery's state of charge.

To determine the battery's state of charge:

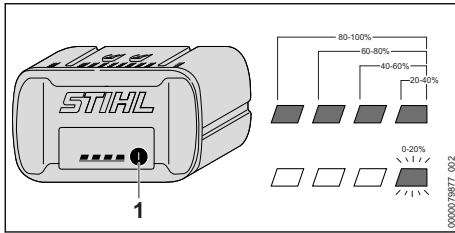

- ▶ Press the button (1) on the battery. The LEDs on the battery will glow or flash green for about 5 seconds and indicate the state of charge (see illustration).

For example:

If four green LEDs glow continuously: full charge.

If one green LED is flashing: less than 20 % charge.

11 Bluetooth® Radio Interface

11.1 Turning the Bluetooth® Interface On

- ▶ Press and hold the push button for about 3 seconds. If the Bluetooth® LED next to the connected symbol glows blue for about 3 seconds, the battery's Bluetooth® interface is on.

11.2 Turning the Bluetooth® Interface Off

- ▶ Press and hold the push button for about 3 seconds. If the Bluetooth® LED flashes blue six times, the Bluetooth® interface is off.

11.3 Resetting the Battery to Factory Settings via Bluetooth® (AP 300 S only)

Resetting the battery to the factory setting means that all user-specific data will be deleted.

- ▶ Press the push button four (4) times in quick succession and keep it pressed on the fourth time until the "BLUETOOTH®" LED next to the  symbol flashes blue.
- ▶ Then release the push button immediately.
- ▶ Connect the battery to the STIHL connected app to confirm that all user-specific data has been deleted.

12 Assembling the Pressure Washer

12.1 Assembling Parts and Accessories

WARNING

- ▶ To reduce the risk of severe injury from high-pressure spray, always switch off the pressure washer, shut off the water supply, relieve any remaining pressure in the system, lock the spray gun trigger and make sure the battery is removed before attempting to assemble the pressure washer or spray attachment.

Hose Reel Handle

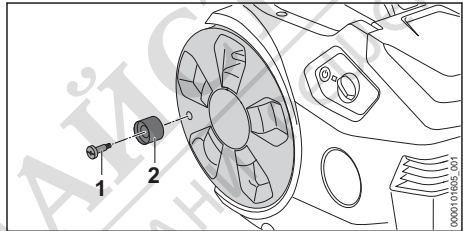

- ▶ Insert screw (1) into the hose reel handle (2).
- ▶ Insert the screw (1) with the hose reel handle (2) into the hose reel and tighten.

Holder

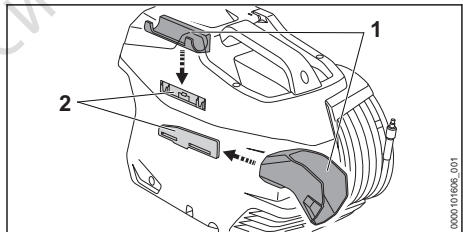

- ▶ Slide the holders (1) into the guides (2).

Nozzle

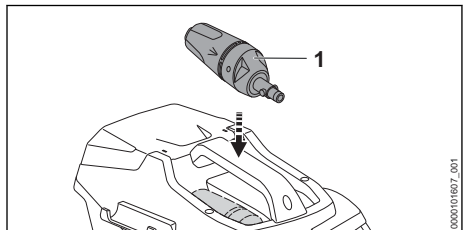



- ▶ Insert 3-in-1 nozzle (1).

12.2 Spray Gun and Lance

12.2.1 Connecting the Spray Gun and Lance

To connect the spray gun and lance:

- ▶ Switch off the pressure washer,  15.2.
- ▶ Remove the battery,  14.2.
- ▶ Shut off the water supply.
- ▶ Lock the spray gun trigger.
- ▶ Remove all sand and debris from the connections and couplings.

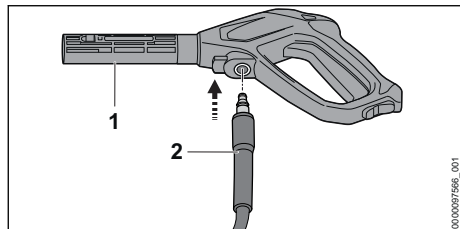

- ▶ Push the high-pressure hose (2) into the spray gun (1).
- ▶ If the high-pressure hose is difficult to push into the spray gun, apply a food-safe fitting grease to the sealing surface on the high pressure hose.

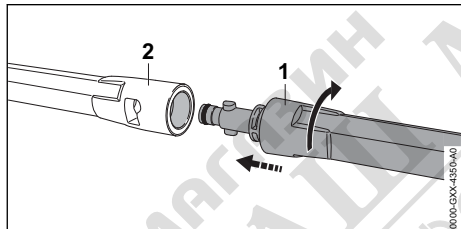

- ▶ Attach the spray lance (1) to the spray gun (2).
- ▶ Push the spray lance as far as it will go into the spray gun.
- ▶ Once inserted, turn the spray lance clockwise until it engages.
- ▶ If the spray lance is difficult to insert into the spray gun, apply a food-safe fitting grease to the sealing surface on spray gun.



12.2.2 Removing the Spray Gun and Lance



WARNING

- To reduce the risk of severe injury from high-pressure spray, always switch off the pressure washer, shut off the water supply, relieve any remaining pressure in the system, lock the spray gun trigger and make sure the battery is removed before attempting to remove or disassemble the spray gun or lance.

To remove the spray gun and lance:

- ▶ Switch off the pressure washer,  15.2.
- ▶ Remove the battery,  14.2.
- ▶ Shut off the water supply.
- ▶ Pull the spray gun trigger to relieve pressure.
- ▶ Lock the spray gun trigger.

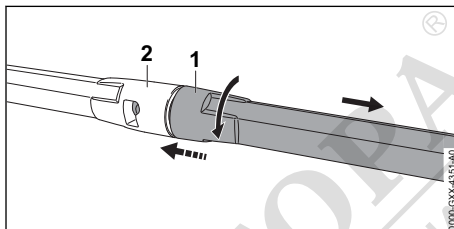

- ▶ Press the spray lance (1) against the spray gun (2) and turn the spray lance counter-clockwise.
- ▶ Pull out the spray lance.

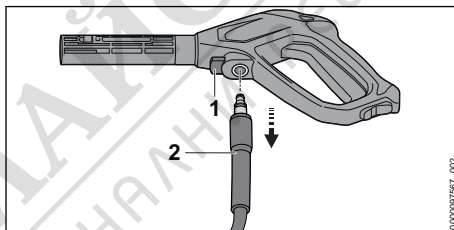

- ▶ Press down and hold the locking lever (1).
- ▶ Pull out the high-pressure hose (2).

12.3 Inserting and Removing the Spray Nozzle

12.3.1 Inserting the 3-in-1 Nozzle



WARNING



- To reduce the risk of severe injury from unintended spraying, switch off the pressure washer, relieve system pressure, lock the spray gun trigger and make sure the battery is removed before attempting to adjust or change a spray nozzle or other accessory.



WARNING

- If the nozzle is not secure, it can fly out of the spray lance during operation and cause injury. Confirm that the nozzle is fixed securely in the quick-connect coupling.

To insert the 3-in-1 nozzle:

- ▶ Switch off the pressure washer,  15.2.
- ▶ Remove the battery,  14.2.

- ▶ Pull the spray gun trigger to relieve pressure.
- ▶ Lock the spray gun trigger.
- ▶ Remove all sand and debris from the connections and couplings.

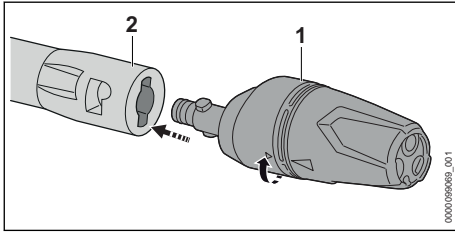

- ▶ Attach the 3-in-1 nozzle (1) to the spray lance (2).
- ▶ Push the 3-in-1 nozzle as far as it will go into the spray lance.
- ▶ Once inserted, turn the 3-in-1 nozzle clockwise until it engages.
- ▶ If the 3-in-1 nozzle is difficult to insert into the spray lance, apply a food-safe fitting grease to the sealing surface on spray lance.

12.3.2 Removing the 3-in-1 Nozzle



WARNING

- To reduce the risk of severe injury from unintended spraying, switch off the pressure washer, relieve system pressure, lock the spray gun trigger and make sure the battery is removed before attempting to adjust or change a spray nozzle or other accessory.

To remove the 3-in-1 nozzle:

- ▶ Switch off the pressure washer, [15.2](#).
- ▶ Remove the battery, [14.2](#).
- ▶ Pull the spray gun trigger to relieve pressure.
- ▶ Lock the spray gun trigger.

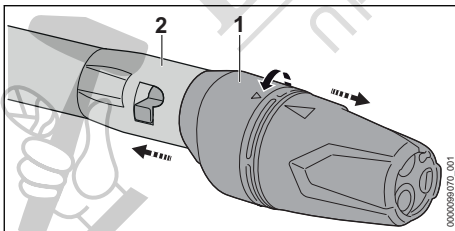

- ▶ Press the 3-in-1 nozzle (1) against the spray lance (2) and turn the 3-in-1 nozzle counter-clockwise.
- ▶ Pull out the 3-in-1 nozzle.

13 Connecting the Water Supply

13.1 Connecting the Pressure Washer to the Mains Water Supply



WARNING

- Make sure the pressure washer is switched off and the battery is removed before connecting to or disconnecting from the mains water supply.

Connecting the Water Hose

The water supply must meet the following requirements:

- Minimum length of water hose: 30 ft. (10 m)
- Maximum water inlet pressure: 145 psi (1 MPa / 10 bar)

To connect the pressure washer to the mains water supply:

- ▶ Switch off the pressure washer, [15.2](#).
- ▶ Remove the battery, [14.2](#).
- ▶ Remove all sand and debris from the connections and couplings.
- ▶ Connect the water hose to the water supply.
- ▶ Fully open the tap to flush any sand or dirt from the hose.
- ▶ Shut off the water supply.

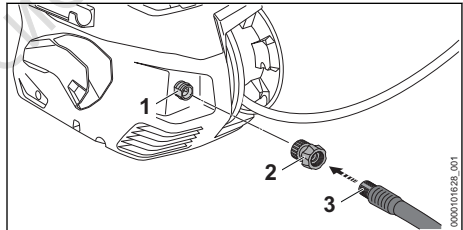



- ▶ Screw the coupling (2) onto the connector (1) and tighten by hand.
- ▶ Connect the water hose (3).
- ▶ If the spray lance is attached to the spray gun: remove the spray lance.
- ▶ Turn on the water supply.
- ▶ Pull the spray gun trigger until a steady, even water jet is delivered from the spray gun.
- ▶ Switch off the pressure washer.
- ▶ Lock the spray gun trigger.
- ▶ Connect the spray lance.
- ▶ Insert the nozzle, [12.3.1](#).

NOTICE

- Running the pressure washer without water will cause the pump to overheat, which may result in permanent damage. Always connect and turn on the water supply to the pump before starting the motor. Do not operate the pressure washer without water.

Disconnecting the Water Hose

To disconnect the water hose:

- Switch off the pressure washer,  15.2.
- Remove the battery,  14.2.
- Shut off the water supply.
- Pull the spray gun trigger to relieve pressure.
- Lock the spray gun trigger.

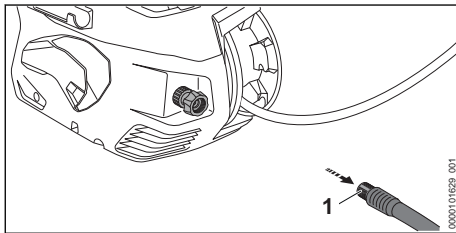



- Remove the water hose (1).

13.2 Connecting the pressure washer to another water source**WARNING**

- Make sure the pressure washer is switched off and the battery is removed before connecting to or disconnecting from another water source.

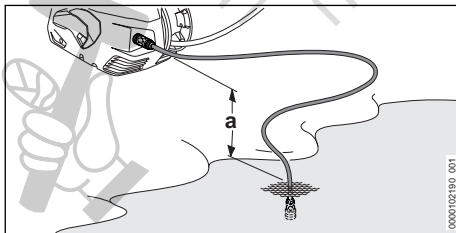
The pressure washer can draw water from rain barrels and cisterns and from running or stagnant bodies of water.



In order to draw water in, the height difference between the pressure washer and the water source should not exceed the maximum suction lift (a),  24.1.

The appropriate STIHL suction set must be used. The suction set includes a water hose with a special coupling and an integrated water filter.

Depending on the market, the appropriate STIHL suction set may be supplied with the pressure washer.

Connecting the water hose

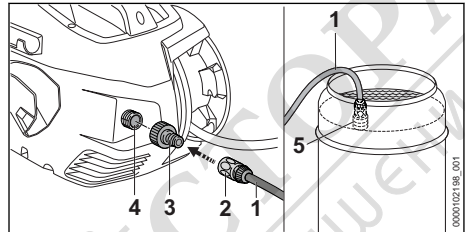

To connect the pressure washer to another water source:



- Unscrew the coupling of the pressure washer.
- Fill the water hose (1) with water until there is no air left in the water hose.
- Screw the coupling (3) onto the connector (4) and tighten by hand.
- Push the coupling (2) onto the coupling (3). The coupling (2) engages with an audible click.
- Suspend the filter (5) in the water source so that the filter (5) does not touch the bottom.
- If the spray gun is attached to the high-pressure hose: remove the spray gun.
- Hold the high-pressure hose downward.
- Switch on pressure washer and run it until an even jet of water is delivered by the high-pressure hose.
- Switch off the pressure washer.
- Attach spray gun to the high-pressure hose.
- Squeeze and hold down spray gun trigger.
- Switch on the pressure washer.

Disconnecting the Water Hose

To disconnect the water hose:

- Switch off the pressure washer,  15.2.
- Remove the battery,  14.2.
- Shut off the water supply.
- Pull the spray gun trigger to relieve pressure.
- Lock the spray gun trigger.

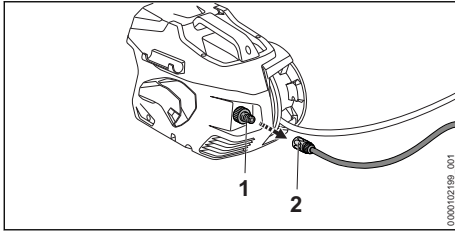

- ▶ To unlock the coupling: Pull the ring (2) or twist and hold it.
- ▶ Pull the suction set off the coupling (1).

14 Inserting and Removing the Battery

14.1 Inserting the Battery



WARNING

- To reduce the risk of personal injury or property damage from fire or electric shock, never use a malfunctioning, damaged, cracked, leaking or deformed battery, [Fig. 6](#). Never charge, use or store the battery outside the specified ambient temperature limits, [Fig. 24.3](#).



WARNING

- To reduce the risk of short circuit, fire or explosion, never operate the pressure washer without the battery compartment cover properly secured in place. If the battery compartment cover is missing, worn or damaged, replace it before starting work, [Fig. 7.1](#).



WARNING

- To reduce the risk of unintended activation, never store the battery in the pressure washer, [Fig. 20.2](#).



WARNING

- Do not handle the battery with wet hands, [Fig. 6.1](#).

To insert the battery:

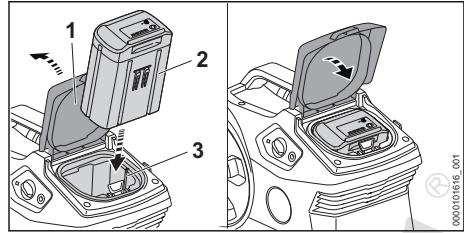

- ▶ Open the battery compartment cover (1).
- ▶ Insert the battery (2) into the battery compartment (3) until it stops.
The battery is properly inserted when you hear an audible click. In this position, there is electrical contact between the battery and the pressure washer.
- ▶ Close the battery compartment cover (1) and ensure that it is properly secured in place.

Since a new battery is not fully charged, STIHL recommends that you fully charge the battery before using it the first time, [Fig. 9](#).

14.2 Removing the Battery



WARNING

- To reduce the risk of severe personal injury from unintended activation, always remove the battery before assembling, transporting, adjusting, cleaning, servicing, maintaining or storing the pressure washer, and any other time it is not in use.



WARNING

- Use care when ejecting the battery to prevent it from falling and causing personal injury or property damage.



WARNING

- If hands become wet during operation dry them before removing the battery. Do not handle the battery with wet hands, [Fig. 6.1](#).

To remove the battery:

- ▶ Place the pressure washer on a level surface.

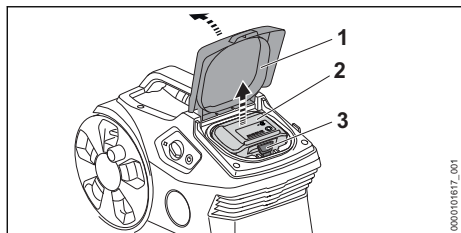

- ▶ Open the battery compartment cover (1).
- ▶ Compress the locking lever (3) to eject the battery (2) from the battery compartment.
- ▶ Close the battery compartment cover (1) and ensure that it is properly secured in place.

NOTICE

- Avoid exposing the battery to excessive heat or prolonged periods of direct sunlight. Use or storage outside the recommended ambient temperature range can reduce the performance of the battery.

15 Switching the Pressure Washer On and Off

15.1 Switching On



WARNING

- Never operate your pressure washer if it is damaged, improperly adjusted or maintained, not completely and securely assembled or not functioning properly, [§ 5.5](#). To reduce the risk of personal injury, always wear proper clothing and protective apparel, including proper eye protection, when operating your pressure washer, [§ 5.4](#).



WARNING

- To reduce the risk of electric shock or damage to the unit, ensure the battery compartment cover is closed before starting work.

Before switching on:

- ▶ Make sure you have a secure and firm footing.
- ▶ Stand upright.
- ▶ Always hold and operate the pressure washer with one hand firmly on the spray gun and your other hand firmly on the spray lance. Always hold the pressure washer with two hands in this manner.

To switch the pressure washer on:

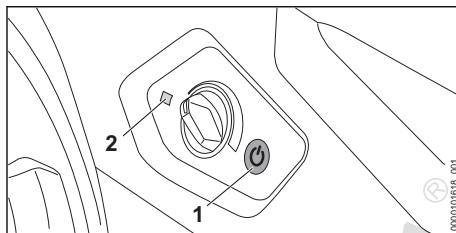

- ▶ Press the power button (1).
The LED (2) will glow green. The pressure washer is ready for operation.

The pressure washer will switch off automatically if the spray gun trigger is not activated for approximately 30 minutes. The LED (2) turns off.

To re-activate the pressure washer:

- ▶ Press the power button (1) again.

15.2 Switching Off

To switch the pressure washer off:

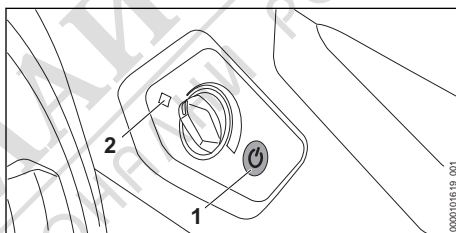

- ▶ Press the power button (1).
The LED (2) turns off.

16 Checking the Controls

16.1 Testing the Controls

Before starting work, confirm that the retaining latch (1) and spray gun trigger (2) are undamaged and functioning properly:

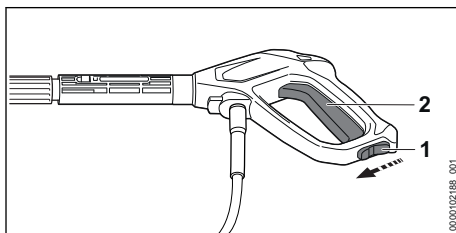



Retaining Latch (1) and Spray Gun Trigger (2)

WARNING

- ▀ To reduce the risk of serious or fatal injuries, keep hands, feet and other parts of your body away from the water jet at all times,  5.7.2. Keep bystanders out of the area while testing the controls.

To test the controls:

- ▶ Switch off the pressure washer and remove the battery.
- ▶ Slide the retaining latch to the  position (1).
- ▶ Attempt to depress the spray gun trigger. If the spray gun trigger can be depressed without first unlocking the retaining latch, take the pressure washer to an authorized STIHL servicing dealer to be repaired before use.
- ▶ Slide the retaining latch to the  position.
- ▶ Squeeze the spray gun trigger. The spray gun trigger must engage only when the retaining latch is in the unlocked position.
- ▶ Release the spray gun trigger. The spray gun trigger must return to the off position when released.

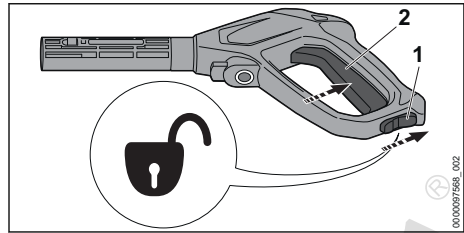

- ▶ Slide the retaining latch (1) to the  position.
- ▶ Press and hold the spray gun trigger (2). The high-pressure pump starts up automatically and water flows out of the nozzle.

Locking the spray gun trigger

To lock the spray gun trigger:

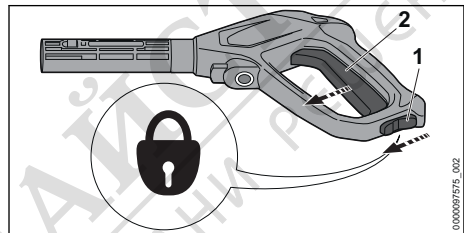

- ▶ Release the spray gun trigger (2). The high-pressure pump switches off automatically when you release the spray gun trigger. Water stops flowing out of the nozzle but the pressure washer remains switched on.
- ▶ Slide the retaining latch (1) to the  position to lock the spray gun trigger.

17 During Operation

17.1 Unrolling the High-Pressure Hose

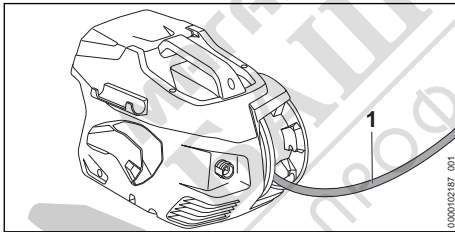

To unroll the high-pressure hose:

- ▶ Pull the high-pressure hose (1) from the hose reel.

17.2 Activating and Locking the Spray Gun Trigger

The pressure washer is designed for two-handed operation.

Activating the spray gun trigger

To pull the spray gun trigger:

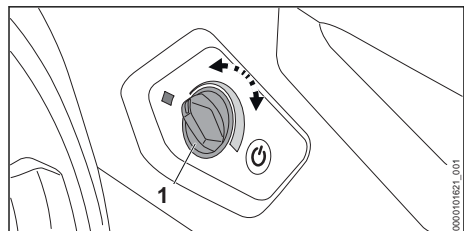

To increase working pressure

- ▶ Turn rotary control (1) clockwise until the desired working pressure is set.

To decrease working pressure

- ▶ Turn rotary control (1) counter-clockwise until the desired working pressure is set.

17.4 Adding Detergents

WARNING

- Use of unsuitable detergents or cleaning agents can damage the pressure washer or surface being cleaned and may result in personal injury. Always read and follow the detergent manufacturer's warnings and instructions regarding proper preparation, dilution, safe use and disposal.



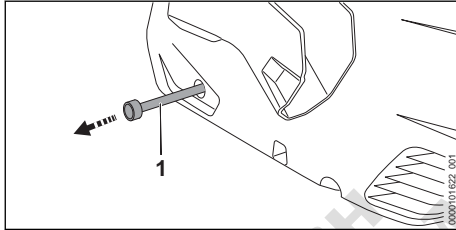

Detergents can improve cleaning effectiveness.



- ▶ Always read and follow instructions provided by the manufacturer of the detergent before starting work.
- ▶ Pull the detergent hose (1) out of the pressure washer.
- ▶ Unscrew cover of the detergent container.
- ▶ Insert the detergent hose (1) into the detergent container.
- ▶ Rotate 3-in-1 nozzle to the detergent position  and set the highest working pressure.

17.5 Cleaning



WARNING

- To reduce the risk of electric shock or damage to the unit, ensure the battery compartment cover is closed before starting work,  5.5. Always wear proper clothing and protective apparel, including proper eye protection, when operating your pressure washer,  5.4. Keep bystanders away from the work area,  5.7.4. Work carefully and maintain proper control of the pressure washer,  5.7.2.

WARNING

- To reduce the risk of fluid injection and/or severe injury, keep hands, feet and other parts of your body away from the water jet at all times and never direct the high-pressure jet toward yourself or other persons, not even to clean clothing or shoes,  5.7.4. Do not direct the high-pressure jet toward animals.

The 3-in-1 nozzle can be set according to the application:

- The fan-jet nozzle  is suitable for cleaning light or moderate cleaning.
- The rotary nozzle  is suitable for cleaning stubborn dirt on hard surfaces.
- The detergent nozzle  is suitable for cleaning with detergent.
- ▶ If you want to remove stubborn dirt, reduce the distance between the nozzle and the surface.
- ▶ If you want to remove dirt from painted, wooden or other potentially sensitive surfaces, increase the distance between the nozzle and the surface.

To adjust the 3-in-1 nozzle:

WARNING

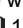
- To reduce the risk of injury from high-pressure spray, always switch off the pressure washer, relieve any remaining pressure in the system, lock the spray gun trigger and make sure the battery is removed before attempting to insert, adjust or remove the spray nozzle.
- ▶ Switch off the pressure washer, .
- ▶ Remove the battery,  14.2.
- ▶ Relieve system pressure.
- ▶ Lock the spray gun trigger.

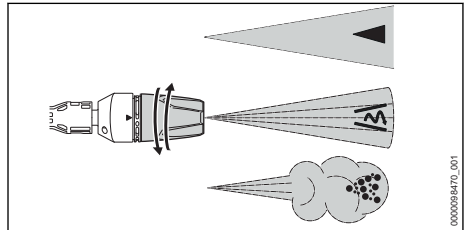

- ▶ Rotate the 3-in-1 nozzle clockwise or counter-clockwise to adjust the setting suitable for the application.

To clean:

- ▶ Before starting work, direct the water jet at an inconspicuous area of the surface and check that the surface is not damaged.
- ▶ Work at a distance that allows you to effectively clean the surface without damaging it.
- ▶ Adjust the 3-in-1 nozzle and distance from the surface to be cleaned to ensure the surface will not be damaged by the spray.

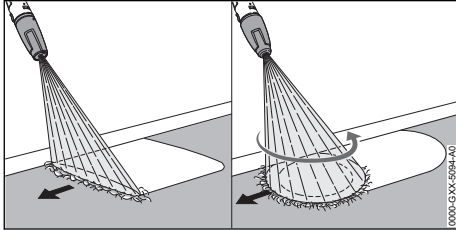

- ▶ Move the spray attachment evenly along the surface to be cleaned.
- ▶ Move forward slowly in a controlled manner.



18 After Finishing Work

18.1 Preparing for Transportation or Storage

WARNING

- To reduce the risk of personal injury from unintended activation or unauthorized use, switch off the pressure washer and remove the battery before transporting the pressure washer.

To prepare the pressure washer for transportation or storage:

- ▶ If cleaning agent has been used: flush the pressure washer.
- ▶ Push the detergent hose (3) into the pressure washer.
- ▶ Switch off the pressure washer,  15.2.
- ▶ Remove the battery,  14.2.
- ▶ Disconnect the pressure washer from the water supply.
- ▶ Press the spray gun trigger to relieve any remaining pressure in the system.
- ▶ Lock the spray gun trigger.
- ▶ Disconnect the water hose.
- ▶ Remove and clean the nozzle and spray lance.
- ▶ Remove the spray gun and let the rest of the water run out of the spray gun.
- ▶ If the pressure washer will be exposed to freezing temperatures, protect it with anti-freeze or take other measures outlined below,  18.2.

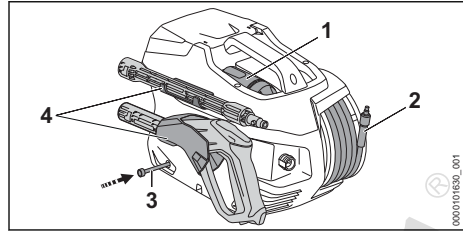





- ▶ Roll up the high-pressure hose (2) evenly.
- ▶ Insert the nozzle (1).
- ▶ Place the spray attachment in the holders (4).
- ▶ If the battery or pressure washer became damp or wet during operation, allow them to dry separately and completely before charging or storing,  24.4.
- ▶ Clean the pressure washer.

18.2 Protecting the Pressure Washer in Winter Conditions

Removing Water from the System

To remove any remaining water from the system:

- ▶ Switch off the pressure washer,  15.2.
- ▶ Remove the battery,  14.2.
- ▶ Shut off the water supply.
- ▶ Relieve system pressure.
- ▶ Disconnect the water hose,  .
- ▶ Drain the water out of the high-pressure hose and water hose.
- ▶ Insert the battery,  14.1.
- ▶ Switch on the pressure washer and let the pump run for up to 30 seconds until the water flow stops. Remaining water will be eliminated from the system.
- ▶ Switch off the pressure washer and remove the battery.

NOTICE

- Freezing temperatures can damage components of the pressure washer. STIHL recommends storing the pressure washer indoors in a dry room where it is protected from freezing temperatures. Relieve all system pressure and make sure all water is eliminated from the pump system and hoses before storing.

Protecting the Pressure Washer with Antifreeze

WARNING

- When using antifreeze to protect your pressure washer in winter conditions, observe all warnings and instructions provided by the manufacturer to reduce the risk of environmental contamination or severe personal injury from ingestion.

If the pressure washer is to be exposed to freezing temperatures, it should be protected by a glycol-based antifreeze. The antifreeze prevents water inside the pressure washer from freezing and causing damage to the pressure washer.

To protect the pressure washer with antifreeze:

- ▶ Drain the water out of the high-pressure hose.
- ▶ Disconnect the spray lance from the spray gun.
- ▶ Connect the shortest possible water hose to the pressure washer. The shorter the water hose, the less antifreeze is needed.
- ▶ Point the spray lance downward and wait until all the water has flowed out of the system.
- ▶ Pour antifreeze into a clean container.
- ▶ Connect a suction hose to the water inlet of the high-pressure pump and place the other end of the hose in the container of antifreeze.
- ▶ Squeeze and hold the spray gun trigger.
- ▶ Switch on the pressure washer.
- ▶ Hold down the spray gun trigger until an even jet of antifreeze is delivered from the spray gun. Keep the spray gun in the container.
- ▶ Press and release spray gun trigger several times.
- ▶ Switch off the pressure washer and remove the battery.
- ▶ Detach the spray gun, high-pressure hose and water hose and allow residual antifreeze to run into the container.
- ▶ Collect and dispose of the antifreeze in accordance with the manufacturer's specifications and all federal, state and local laws, regulations and ordinances.

19 Transporting

19.1 Transporting the Pressure Washer

WARNING

- To reduce the risk of personal injury from unintended activation, never transport the pressure washer with the battery inserted.

When transporting the pressure washer:

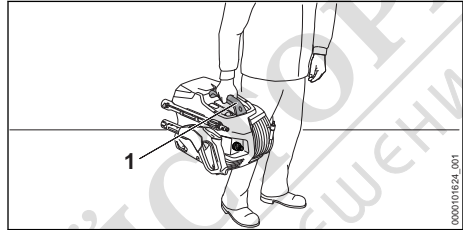

- ▶ Carry the pressure washer by the carrying handle (1).
- ▶ When transporting the pressure washer in a vehicle, ensure that the pressure washer is standing upright, lying on its back, secured with lashing straps, belts or a net and cannot topple over or move.

19.2 Battery

WARNING

- To reduce the risk of a short circuit, which could lead to electric shock, fire and explosion, never transport the battery with small metal objects capable of conducting electricity (e.g., paper clips, nails, coins, keys),  6.

When transporting the battery:

- ▶ Secure the battery in a container against impact or damage. Never transport the battery with small metal objects capable of conducting electricity (e.g., paper clips, nails, coins, keys).
- ▶ If you are transporting the battery in a vehicle, secure it and its container to prevent turnover, impact and damage.

STIHL batteries comply with the requirements set forth in UN-Manual of Tests and Criteria, Part III, Subsection 38.3.

Commercial air, vessel and ground transportation of lithium ion cells and batteries is regulated. The battery is classified as a UN 3480, Class 9, packaging group II product. Shipping it, either as a complete tool or the battery, requires compli-

ance with all applicable shipping regulations. Check with the ground, vessel, air cargo or passenger airline to determine if transport is prohibited or subject to restrictions or exemptions prior to shipping or travel.



Normally, no further conditions have to be met by the user in order to transport STIHL batteries by road to the power tool's operating site. Check and comply with any special regulations that may apply to your situation.

For further information please go to www.stihl-usa.com/battery-transportation-safety.



20 Storing

20.1 Storing the Pressure Washer

WARNING

- Store the pressure washer indoors in a dry, secure place that is inaccessible to children and other unauthorized users,  5.5. Never store the battery in the pressure washer. Improper storage can result in unauthorized use and damage to the pressure washer,  5.5.

When storing the pressure washer:



- ▶ Clean the pressure washer,  21.
- ▶ Secure and position the pressure washer to prevent turnover, impact and damage.
- ▶ Store the pressure washer indoors in a dry and secure location, out of the reach of children and other unauthorized persons.
- ▶ If the pressure washer cannot be stored in a room where it is protected from freezing temperatures, protect the pressure washer as outlined above,  18.2.

NOTICE

- Freezing temperatures can damage components of the pressure washer. STIHL recommends storing the pressure washer indoors in a dry room where it is protected from freezing temperatures. Relieve all system pressure and make sure all water is eliminated from the pump system and hoses before storing.

20.2 Battery

WARNING

- To reduce the risk of a short circuit, which could lead to electric shock, fire and explosion, never store the battery with small metal objects capable of conducting electricity (e.g., paper clips, nails, coins, keys),  6. If the battery is damp or wet, allow it to dry thoroughly before storing,  6.

WARNING

- Extreme temperatures can damage the battery and may also cause the battery to generate heat, rupture, leak, ignite or explode, resulting in severe or fatal personal injury or property damage. Never charge, use or store the battery outside the specified ambient temperature limits,  24.3.

To properly store the battery:

- ▶ Remove the battery from the pressure washer.
- ▶ When storing the battery, maintain a charge of 40 % to 60 % for STIHL AP series batteries (2 green LEDs).
- ▶ If storing the battery in the charger, disconnect the charger from the outlet.
- ▶ Make sure the battery is dry and store it indoors in a dry and secure location.
- ▶ Keep it out of the reach of children and other unauthorized persons.
- ▶ Protect the battery against dampness and corrosive agents such as garden chemicals and de-icing salts.
- ▶ Protect the battery from exposure to conductive liquids such as salt water.
- ▶ For maximum battery life, store the battery at an ambient temperature between 50 °F and 68 °F (10 °C and 20 °C) with a charge between 40 % and 60 % for STIHL AP series batteries (2 green LEDs).
- ▶ Do not leave spare batteries unused. Use them in rotation.

NOTICE

- A battery that is not stored properly may experience deep discharge, which can result in permanent damage. To avoid deep discharge:
 - Remove the battery from the pressure washer after finishing work.
 - For maximum battery life, store the battery with a charge between 40 % and 60 % for STIHL AP series batteries (2 green LEDs).
 - If storing the battery in the charger, disconnect the charger from the outlet.
 - For maximum battery life, store the battery at an ambient temperature between 50 °F and 68 °F (10 °C and 20 °C).

21 Cleaning**21.1 Flush the Pressure Washer**

If cleaning agent has been used:

- ▶ Rotate 3-in-1 nozzle into the detergent position  and set the highest power level.
- ▶ Switch on pressure washer and flush with clear water for approximately 30 seconds.

21.2 Cleaning the Pressure Washer and Battery**! WARNING**

- Before carrying out any of the cleaning work specified in this chapter  21, take certain measures to reduce the risk of personal injury from unintended activation: switch off the pressure washer and remove the battery. Relieve all system pressure by pulling the trigger switch and lock the spray gun trigger.

To clean the pressure washer and Battery:

- ▶ Clean the pressure washer's polymer components, couplings and connectors with a slightly dampened cloth. Do not use abrasives or solvents that may damage the pressure washer's polymer components.
- ▶ Do not use a pressure washer to clean the unit or otherwise spray it with water or other liquids.
- ▶ Keep the battery housing and guides dry and free from foreign matter and clean as necessary with a soft brush or soft, dry cloth.

21.3 Cleaning the Nozzle and Spray Lance

A clogged nozzle can cause excessive pressure to build in the pump. Clean the nozzle if it becomes clogged.

To clean the nozzle and spray lance:

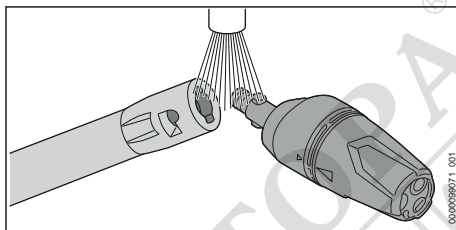

- ▶ Rinse the nozzle and spray lance under running water and dry them with a cloth.

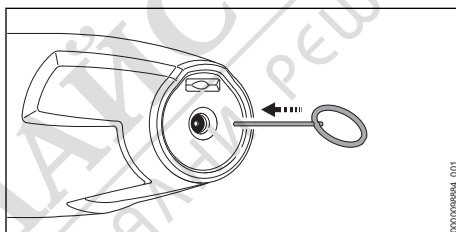

- ▶ If the nozzle is blocked, use the cleaning needle to clear the opening.

21.4 Cleaning the Water Intake Screen

To clean the water intake screen:

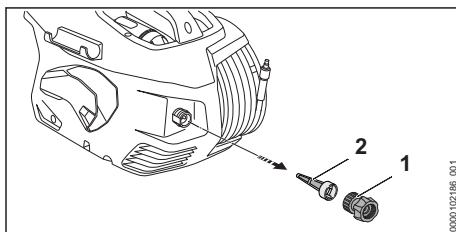

- ▶ Unscrew the coupling (1).
- ▶ Pull out the water intake screen (2).
- ▶ Rinse the water intake screen under warm running water.
- ▶ Re-insert the water intake screen.
- ▶ Screw on the coupling and tighten it by hand.

21.5 Cleaning the Filter of the Hose Kit

To clean the filter:

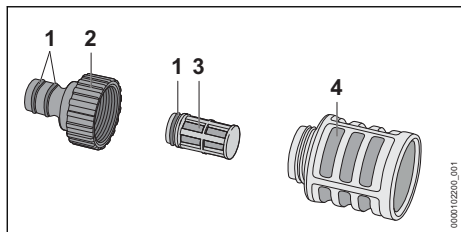

- ▶ Unscrew the coupling (2).
- ▶ Remove the filter element (3) from the filter (4).
- ▶ Rinse the coupling (2), the filter element (3) and filter (4) under warm running water.
- ▶ Grease the O-rings (1) with food-safe grease.
- ▶ Re-assemble the filter.

22 Inspection and Maintenance

22.1 Inspection and Maintenance Chart

Always remove the battery before carrying out any inspection, cleaning or maintenance.

The following maintenance intervals are examples and apply for normal operating conditions. Actual use and your experience will determine the frequency of required inspection and maintenance.

		Before starting work	After finishing work or daily	Weekly	Relevant Chapter
Complete Machine	Visual inspection	X			
	Clean		X		📖 21
Connectors on high-pressure hose	Clean		X		
Coupling on the spray lance and spray gun	Clean	X			📖 21.3
Water intake screen at inlet of high-pressure pump	Clean			X	📖 21.4
Spray nozzle	Clean		X		📖 21.3

22.2 Inspecting and Maintaining the Pressure Washer

⚠ WARNING

- Before carrying out any of the maintenance work specified in this chapter 📖 22, take certain measures to reduce the risk of personal injury from unintended activation: switch off the pressure washer and remove the battery. Relieve all system pressure and lock the spray gun trigger.

To properly maintain the pressure washer:

- ▶ Inspect battery compartment cover, hoses, couplings, connectors and O-rings periodically and have a worn component replaced.
- ▶ Have worn, missing or damaged safety labels replaced by an authorized STIHL servicing dealer.

The pump is pre-filled with pump oil and does not require replacement or maintenance.

22.3 Lubricating the Connections

To lubricate the connections:

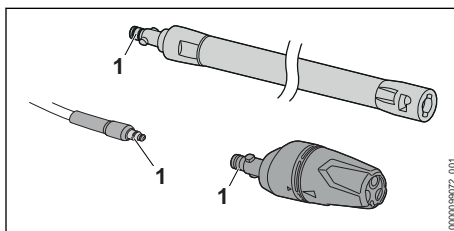

- ▶ Grease the O-rings (1) with food-safe fitting grease.

23 Troubleshooting Guide

23.1 Pressure Washer

Always switch off the pressure washer, remove the battery, relieve system pressure and lock the spray gun trigger before carrying out any inspection, cleaning or maintenance.

Condition	LEDs on Battery	Cause	Remedy
The pressure washer does not start when switched on. The electric motor hums.	1 LED flashes green.	Battery has low charge.	▶ Charge the battery, 11 9.
	1 LED glows red.	Battery too hot / too cold.	▶ Remove the battery, 11 14.2. ▶ Allow the battery to warm up or cool down gradually at ambient temperatures of about 50 °F to 68 °F (10 °C to 20 °C).
	4 LEDs flash red.	Malfunction in battery.	▶ Remove the battery and reinsert it, 11 14. ▶ Switch on the pressure washer, 11 15.1. ▶ If the LEDs continue to flash, do not attempt to use. The battery has a malfunction and must be replaced.
	3 LEDs glow red.	Pressure washer too hot.	▶ Remove the battery, 11 14.2. ▶ Allow the pressure washer to cool down. ▶ Clean the nozzle, 11 21.3.
	3 LEDs flash red.	Malfunction in pressure washer.	▶ Remove the battery and reinsert it, 11 14. ▶ Switch on the pressure washer, 11 15.1. ▶ If the LEDs still flash, do not attempt to use. The pressure washer has a malfunction and must be checked by a servicing dealer.
Pressure washer cuts out during operation.	1 LED glows red.	Battery too hot / too cold.	▶ Remove the battery, 11 14.2. ▶ Allow the pressure washer and battery to cool down gradually at ambient temperatures of about 50 °F to 68 °F (10 °C to 20 °C).
	3 LEDs glow red.	Pressure washer too hot.	▶ Clean the nozzle, 11 21.3.
Run-time is too short.		Battery not fully charged.	▶ Charge the battery, 11 9.
		Useful life of battery has been reached or exceeded.	▶ Have the battery checked by an authorized STIHL servicing dealer.
Battery is not being charged even though LED on charger glows green.	1 LED glows red.	Battery too hot / too cold.	▶ Allow the battery to warm up or cool down gradually at ambient temperatures of about 50 °F to 68 °F (10 °C to 20 °C). ▶ Operate the charger indoors in a dry room. For optimum performance, observe the recommended ambient temperature ranges, 11 24.3.
The high-pressure pump repeatedly switches on and off without pulling the spray gun trigger.		There is a leak in the high-pressure pump, high-pressure hose or spray attachment.	▶ Have the pressure washer inspected and repaired by an authorized STIHL servicing dealer.
The water pressure fluctuates or drops.		There is not enough water.	▶ Open the water tap fully. ▶ Make sure that a sufficient quantity of water is available.

Condition	LEDs on Battery	Cause	Remedy
		The nozzle is blocked.	▶ Clean the nozzle, ☐ 21.3 .
		The water intake screen or water filter is blocked.	▶ Clean water intake screen, ☐ 21.4 . ▶ Clean water filter, ☐ 21.5 .
		The high-pressure pump, high-pressure hose or spray attachment is leaking.	▶ Ask a STIHL servicing dealer to inspect the pressure washer.
The shape of the water jet has changed.		The nozzle is blocked.	▶ Clean the nozzle, ☐ 21.3 .
		The nozzle is worn.	▶ Insert a new nozzle.
Detergent is not being drawn in.		The detergent bottle is empty.	▶ Fill the bottle with detergent.
		The filter of the detergent hose is blocked.	▶ Clean the detergent hose with water.
The connections of the pressure washer, high-pressure hose, spray gun or spray lance are stiff.		The O-rings of the connections have not been greased.	▶ Grease the O-rings. ☐ 22.3
Battery cannot be found with the STIHL connected App.		Bluetooth® interface at the battery or at your mobile device is not turned on.	▶ Activate the Bluetooth® interface at the battery and at your mobile device, ☐ 11.1 .
		Distance between the battery and your mobile device is too large.	▶ Reduce the distance between the battery and your mobile device, ☐ 24.2 . ▶ If the battery still cannot be found with the STIHL connected App: Contact an authorized STIHL servicing dealer for assistance.

24 Specifications

24.1 STIHL REA 100.0 PLUS

For household use.

- Approved battery type: STIHL AP series
- Weight without battery, with spray attachment and high-pressure hose: approximately 15.4 lbs (7 kg)

Electrical

- Rated current: 34.7 A
- Rated power: 1300 W
- Insulation: Class III (Triple Insulation)

High-Pressure Pump

- Rated Pressure: 1800 psi (12.5 MPa / 125 bar)

- Maximum Pressure: 2100 psi (15 MPa / 150 bar)
- Minimum water throughput: 1.2 gpm (4.5 l/min)
- Maximum water throughput: 1.3 gpm (5 l/min)
- Maximum suction height from a tank: 1.6 ft. (0.5 m)
- Maximum water temperature in pressure mode: 104 °F (40 °C)

Water Supply

- Maximum water inlet pressure: 145 psi (1 MPa / 10 bar)
- Maximum water temperature: 104 °F (40 °C)

Pressure-dependent data were measured at an inlet pressure of 0.3 MPa (44 psi).

For technical information regarding the STIHL AP series batteries, see the product information accompanying your battery.

For technical information regarding the STIHL AL 101, 301, 301-4 and 500 series chargers, see the product information accompanying your charger.

Batteries, chargers and other accessories sold separately. Contact your authorized STIHL servicing dealer for pricing and availability.

24.2 STIHL AP Series Battery

Approved charger types: STIHL AL 101, AL 300, AL 301, AL 301-4, AL 500, AL 501.

- Battery technology: Lithium-Ion
- Voltage: 36 V
- Rated capacity in Ah¹: See rating plate
- Stored energy in Wh²: See rating plate
- Weight in kg: See rating plate
- Bluetooth® interface (only for batteries with



- Data transmission protocol: Bluetooth® 5.1. The mobile receiving devices must be compatible with Bluetooth® Low Energy 5.0 and support the Generic Access Profile (GAP).
- Frequency band: ISM band 2.4 GHz
- Radiated maximum transmission power: 1 mW
- Bluetooth® signal range: maximum 33 ft. (10 m). The signal range may vary depending on ambient conditions and the performance of the designated receiving device, i.e., smartphone or tablet. The Bluetooth® range may be significantly limited when the signal is transmitted through metallic barriers (e.g., walls, shelving units, etc.) or near strong electromagnetic fields.
- Minimum mobile terminal device (e.g., tablet, smartphone) system requirements: Android or iOS (in current version or higher)

For a complete list of approximate charging times, see www.stihl.com/charging-times.

For a complete list of approximate battery run-times, see www.stihl.com/battery-life.

Bluetooth®

The Bluetooth® word mark and logos are registered trademarks owned by Bluetooth SIG, Inc. These word mark/logos are used by STIHL under license.

If the battery is equipped with a Bluetooth® interface, local operating restrictions (in aircraft or hospitals, for example) must be observed.

Other Trademarks

Apple and the Apple logo are trademarks of Apple Inc., registered in the U.S. and other countries.

App Store is a service mark of Apple Inc.

Google Play and the Google Play logo are trademarks of Google Inc.

24.3 Ambient Temperature Limits



WARNING

- Extreme temperatures can damage the battery and may also cause it to generate heat, rupture, leak, ignite or explode, resulting in severe or fatal personal injury or property damage. Never charge, use or store the battery outside the ambient temperature limits specified below.
 - Do not charge the battery below - 4 °F (- 20 °C) or above 122 °F (50 °C).
 - Do not use the pressure washer or battery below - 4 °F (- 20 °C) or above 122 °F (50 °C).
 - Do not store the pressure washer or battery below - 4 °F (- 20 °C) or above 158 °F (70 °C).

24.4 Ambient Temperature Recommendations

For optimum performance, observe the following ambient temperature ranges for the pressure washer and battery:

- Charging: 41 °F to 104 °F (5 °C to 40 °C)
- Use: 14 °F to 104 °F (- 10 °C to 40 °C)
- Storage: - 4 °F to 122 °F (- 20 °C to 50 °C)

¹Rated capacity calculated pursuant to IEC 61960. Usable energy available to the operator will be less.

²The battery is marked with its stored energy as provided by the cell manufacturer. Usable energy available to the operator will be less.

Charging, using or storing the battery outside the recommended ambient temperature ranges may reduce performance.

If the battery became damp or wet during operation, allow it to dry at least 48 hours at temperatures between 59 °F (15 °C) and 122 °F (50 °C) and relative humidity below 70 % before charging or storing. Higher humidity can extend the drying time.

24.5 Symbols on the Pressure Washer and Battery

Symbol	Explanation
A	Ampere
Ah	Ampere hour
V	Volt
Hz	Hertz
kW	Kilowatt
Wh	Watt hour
t _{in max}	Maximum water temperature in pressure mode
p	Rated Pressure
p _{max}	Maximum Pressure
Q _{min}	Minimum water throughput
m	Weight
IPX5	Protection against spraying or splashing water from all directions.



Spray gun trigger is locked.



Spray Gun trigger is unlocked.



Certification/listing mark of MET



STIHL products must not be disposed of in the household trash, but only in accordance with local, state and federal laws and regulations and as provided in this manual, 26.1.



This product is designed for use with a STIHL battery. Permissible batteries are listed in this User Manual.



Direct current



Number of cells and stored energy according to cell manufacturer's specification. Usable energy will be less.



The RBRC seal indicates that STIHL has prepaid for battery recycling.



Manufacturer Code



The battery is equipped with Bluetooth® and can be connected with the STIHL connected App.

24.6 FCC 15 Compliance Statement

This device complies with part 15 of the FCC Rules.

Operation is subject to the following two conditions:

- 1) This device may not cause harmful interference, and
- 2) this device must accept any interference received, including interference that may cause undesired operation.

Note: This equipment has been tested and found to comply with the limits for a Class B digital device, pursuant to part 15 of the FCC Rules. These limits are designed to provide reasonable protection against harmful interference in a residential installation. This equipment generates, uses and can radiate radio frequency energy and, if not installed and used in accordance with the instructions, may cause harmful interference to radio communications. However, there is no guarantee that interference will not occur in a particular installation.

If this equipment does cause harmful interference to radio or television reception, which can be determined by turning the equipment off and on, the user is encouraged to try to correct the interference by one or more of the following measures:

- reorient or relocate the receiving antenna,
- increase the separation between the equipment and receiver,
- connect the equipment to an outlet on a circuit different from that to which the receiver is connected,
- consult an authorized STIHL servicing dealer or an experienced radio/TV technician for help.

Do not change or modify this product in any way unless specifically allowed in this manual, since this could void your authority to operate it.

24.7 Engineering Improvements

STIHL's philosophy is to continually improve all of its products. As a result, engineering changes and improvements are made from time to time. Therefore, some changes, modifications and improvements may not be covered in this manual. If the operating characteristics or the appearance of your machine differs from those described in this manual, please contact your STIHL dealer or the STIHL distributor in your area for assistance.

25 Replacement Parts and Equipment

25.1 Genuine STIHL Replacement Parts

STIHL recommends the use of genuine STIHL replacement parts. Genuine STIHL parts can be identified by the STIHL part number, the **STIHL** logo and, in some cases, by the STIHL parts symbol . The symbol may appear alone on small parts.

26 Disposal

26.1 Disposal of the Power Tool

STIHL products must not be thrown in household trash or disposed of except as outlined in this manual.

- ▶ Take the power tool, accessories and packaging to an approved disposal site for environmentally friendly recycling.
- ▶ Contact your authorized STIHL servicing dealer for the latest information on disposal and recycling.

26.2 Battery Recycling

WARNING

- Handle discharged/depleted batteries carefully. Even if believed to be discharged, lithium ion batteries may never totally discharge and still may deliver a dangerous short circuit current. If damaged or exposed to extreme temperatures, they may leak, generate heat, catch fire or explode.
- ▶ Observe all federal, state and local disposal rules and regulations.

- ▶ Contact your authorized STIHL servicing dealer for the latest information on waste disposal.
- ▶ Recycle depleted batteries promptly.
- ▶ Keep batteries away from children. Do not disassemble and do not dispose of in fire.



STIHL is committed to the development of products that are environmentally responsible. This commitment does not stop when the product leaves the authorized STIHL servicing dealer. STIHL has partnered with the RBRC (Rechargeable Battery Recycling Corporation) to promote the collection and recycling of spent STIHL lithium ion batteries in the United States and Canada.

The RBRC seal indicates that STIHL has prepaid for battery recycling. RBRC has a toll free phone number (1-800-822-8837) that connects you to information on battery recycling locations and information on battery disposal bans or restrictions in your area. You can also return your spent battery to any authorized STIHL servicing dealer for recycling free of charge.

27 Limited Warranty

27.1 STIHL Incorporated Limited Warranty Policy

This product is sold subject to the STIHL Incorporated Limited Warranty Policy, available at www.stihlusa.com/warranty.html. It can also be obtained from your authorized STIHL dealer or by calling 1-800-GO-STIHL (1-800-467-8445).

28 Trademarks

28.1 Registered Trademarks

STIHL®	FARM BOSS®
STIHL ®	iCademy®
	MAGNUM®
The color combination orange-grey (U.S. Registrations #2,821,860; #3,010,057, #3,010,058, #3,400,477; and #3,400,476)	MasterWrench Service®
AutoCut®	MotoMix®
YARD BOSS®	OILOMATIC®
STIHL ROLLO-MATIC®	ROCK BOSS®
WOOD BOSS®	STIHL Cutquik®
	STIHL DUROMATIC®
	STIHL Quickstop®
	STIHL WOOD BOSS®
	TIMBERSPORTS®