

DEWALT®



CE

СУК
РА



МАГАЗИН
БАШ МАЙСТОР
ПРОФЕСИОНАЛНИ РЕШЕНИЯ

www.DEWALT.com

DWST83470

DWST83471

DWST83472

English (*original instructions*) 3

Русский (*перевод с оригинала инструкции*) 11

Українська (*переклад з оригінальної інструкції*) 24



МАГАЗИН
БАШ МАЙСТОРА[®]
ПРОФЕСІОНАЛНИ РЕШЕННЯ

Fig. D

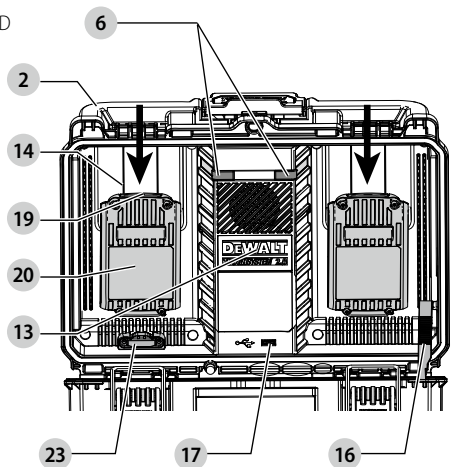

Fig. E

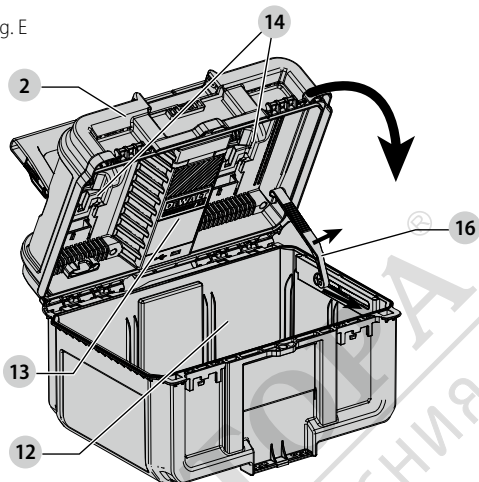

Fig. F

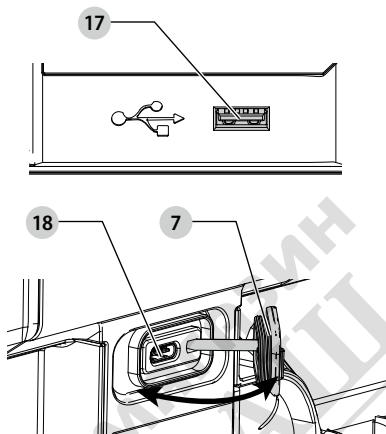

Fig. G

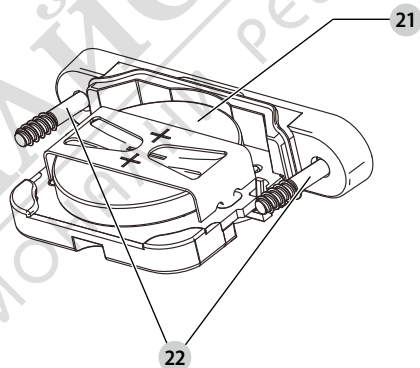
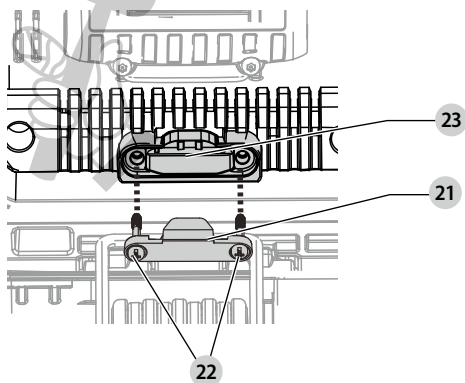

Fig. H



TOUGHSYSTEM 2.0 DUAL PORT CHARGER

DWST83470, DWST83471, DWST83472

Congratulations!

You have chosen a DEWALT tool. Years of experience, thorough product development and innovation make DEWALT one of the most reliable partners for professional power tool users.

Technical Data

	DWST83470	DWST83471	DWST83472
Power source	AC	AC	AC
Mains voltage	V _{ac} 230	230	230
Input AC frequency	Hz 50	50	50
Type	1	1	1
Output			
USB Type A	A 2	2	2
USB Type C	A 3	3	3
Battery Charging Port	A 6	6	6
Type	1	1	1
USB charging ports	Type A, Type C	Type A, Type C	Type A, Type C
Battery type	Li-Ion	Li-Ion	Li-Ion
Battery Voltage	V _{dc} 18/54	18/54	18/54
Weight (without battery packs)	kg 3,9	3,9	3,9

The vibration and/or noise emission level given in this information sheet has been measured in accordance with a standardised test given in EN62841 and may be used to compare one tool with another. It may be used for a preliminary assessment of exposure.



WARNING: The declared vibration and/or noise emission level represents the main applications of the tool. However, if the tool is used for different applications, with different accessories or is poorly maintained, the vibration and/or noise emission may differ. This may significantly increase the exposure level over the total working period.

An estimation of the level of exposure to vibration and/or noise should also take into account the times when the tool is switched off or when it is running but not actually doing the job. This may significantly reduce the exposure level over the total working period.

Identify additional safety measures to protect the operator from the effects of vibration and/or noise such as: maintain the tool and the accessories, keep the hands warm (relevant for vibration), organisation of work patterns.



WARNING: To reduce the risk of injury, read the instruction manual.

Definitions: Safety Guidelines

The definitions below describe the level of severity for each signal word. Please read the manual and pay attention to these symbols.



DANGER: Indicates an imminently hazardous situation which, if not avoided, **will** result in **death or serious injury**.



WARNING: Indicates a potentially hazardous situation which, if not avoided, **could** result in **death or serious injury**.



CAUTION: Indicates a potentially hazardous situation which, if not avoided, **may** result in **minor or moderate injury**.

NOTICE: Indicates a practice **not related to personal injury** which, if not avoided, **may** result in **property damage**.



DENOTES RISK OF ELECTRIC SHOCK.



DENOTES RISK OF FIRE.

GENERAL POWER TOOL SAFETY WARNINGS



WARNING: Read all safety warnings, instructions, illustrations and specifications provided with this power tool. Failure to follow all instructions listed below may result in electric shock, fire and/or serious injury.

SAVE ALL WARNINGS AND INSTRUCTIONS FOR FUTURE REFERENCE

The term "power tool" in the warnings refers to your mains-operated (corded) power tool or battery-operated (cordless) power tool.

1) Work Area Safety

- Keep work area clean and well lit.** Cluttered or dark areas invite accidents.
- Do not operate power tools in explosive atmospheres, such as in the presence of flammable liquids, gases or dust.** Power tools create sparks which may ignite the dust or fumes.
- Keep children and bystanders away while operating a power tool.** Distractions can cause you to lose control.

2) Electrical Safety

- Power tool plugs must match the outlet. Never modify the plug in any way. Do not use any adapter plugs with earthed (grounded) power tools.** Unmodified plugs and matching outlets will reduce risk of electric shock.
- Avoid body contact with earthed or grounded surfaces, such as pipes, radiators, ranges and refrigerators.** There is an increased risk of electric shock if your body is earthed or grounded.
- Do not expose power tools to rain or wet conditions.** Water entering a power tool will increase the risk of electric shock.
- Do not abuse the cord. Never use the cord for carrying, pulling or unplugging the power tool. Keep cord away from heat, oil, sharp edges or moving**

parts. Damaged or entangled cords increase the risk of electric shock.

- e) **When operating a power tool outdoors, use an extension cord suitable for outdoor use.** Use of a cord suitable for outdoor use reduces the risk of electric shock.
- f) **If operating a power tool in a damp location is unavoidable, use a residual current device (RCD) protected supply.** Use of an RCD reduces the risk of electric shock.

3) Personal Safety

- a) **Stay alert, watch what you are doing and use common sense when operating a power tool. Do not use a power tool while you are tired or under the influence of drugs, alcohol or medication.** A moment of inattention while operating power tools may result in serious personal injury.
- b) **Use personal protective equipment. Always wear eye protection.** Protective equipment such as a dust mask, non-skid safety shoes, hard hat or hearing protection used for appropriate conditions will reduce personal injuries.
- c) **Prevent unintentional starting. Ensure the switch is in the off position before connecting to power source and/or battery pack, picking up or carrying the tool.** Carrying power tools with your finger on the switch or energising power tools that have the switch on invites accidents.
- d) **Remove any adjusting key or wrench before turning the power tool on.** A wrench or a key left attached to a rotating part of the power tool may result in personal injury.
- e) **Do not overreach. Keep proper footing and balance at all times.** This enables better control of the power tool in unexpected situations.
- f) **Dress properly. Do not wear loose clothing or jewellery. Keep your hair and clothing away from moving parts.** Loose clothes, jewellery or long hair can be caught in moving parts.
- g) **If devices are provided for the connection of dust extraction and collection facilities, ensure these are connected and properly used.** Use of dust collection can reduce dust-related hazards.
- h) **Do not let familiarity gained from frequent use of tools allow you to become complacent and ignore tool safety principles.** A careless action can cause severe injury within a fraction of a second.

4) Power Tool Use and Care

- a) **Do not force the power tool. Use the correct power tool for your application.** The correct power tool will do the job better and safer at the rate for which it was designed.
- b) **Do not use the power tool if the switch does not turn it on and off.** Any power tool that cannot be controlled with the switch is dangerous and must be repaired.
- c) **Disconnect the plug from the power source and/or remove the battery pack, if detachable, from the power tool before making any adjustments,**

changing accessories, or storing power tools. Such preventive safety measures reduce the risk of starting the power tool accidentally.

- d) **Store idle power tools out of the reach of children and do not allow persons unfamiliar with the power tool or these instructions to operate the power tool.** Power tools are dangerous in the hands of untrained users.
- e) **Maintain power tools and accessories. Check for misalignment or binding of moving parts, breakage of parts and any other condition that may affect the power tool's operation. If damaged, have the power tool repaired before use.** Many accidents are caused by poorly maintained power tools.
- f) **Keep cutting tools sharp and clean.** Properly maintained cutting tools with sharp cutting edges are less likely to bind and are easier to control.
- g) **Use the power tool, accessories and tool bits, etc. in accordance with these instructions, taking into account the working conditions and the work to be performed.** Use of the power tool for operations different from those intended could result in a hazardous situation.
- h) **Keep handles and grasping surfaces dry, clean and free from oil and grease.** Slippery handles and grasping surfaces do not allow for safe handling and control of the tool in unexpected situations.

5) Battery Tool Use and Care

- a) **Recharge only with the charger specified by the manufacturer.** A charger that is suitable for one type of battery pack may create a risk of fire when used with another battery pack.
- b) **Use power tools only with specifically designated battery packs.** Use of any other battery packs may create a risk of injury and fire.
- c) **When battery pack is not in use, keep it away from other metal objects, like paper clips, coins, keys, nails, screws or other small metal objects, that can make a connection from one terminal to another.** Shorting the battery terminals together may cause burns or a fire.
- d) **Under abusive conditions, liquid may be ejected from the battery; avoid contact. If contact accidentally occurs, flush with water. If liquid contacts eyes, additionally seek medical help.** Liquid ejected from the battery may cause irritation or burns.
- e) **Do not use a battery pack or tool that is damaged or modified.** Damaged or modified batteries may exhibit unpredictable behaviour resulting in fire, explosion or risk of injury.
- f) **Do not expose a battery pack or tool to fire or excessive temperature.** Exposure to fire or temperature above 130 °C may cause explosion.
- g) **Follow all charging instructions and do not charge the battery pack or tool outside the temperature range specified in the instructions.** Charging improperly or at temperatures outside the specified range may damage the battery and increase the risk of fire.

6) Service

- a) **Have your power tool serviced by a qualified repair person using only identical replacement parts.** This will ensure that the safety of the power tool is maintained.
- b) **Never service damaged battery packs.** Service of battery packs should only be performed by the manufacturer or authorised service providers.

SAVE ALL WARNINGS AND INSTRUCTIONS FOR FUTURE REFERENCE

Important Safety Instructions for All Battery Chargers

- Before using charger, read all instructions and cautionary markings on charger, battery pack, and product using battery pack.



WARNING: Shock hazard. Do not allow any liquid to get inside charger. Electric shock may result.



CAUTION: Burn hazard. To reduce the risk of injury, charge only DEWALT rechargeable batteries. Other types of batteries may burst causing personal injury and damage.

NOTICE: Under certain conditions, with the charger plugged into the power supply, the exposed charging contacts inside the charger can be shorted by foreign material. Foreign materials of a conductive nature such as, but not limited to, steel wool, aluminum foil or any buildup of metallic particles should be kept away from charger cavities. Always unplug the charger from the power supply when there is no battery pack in the cavity. Unplug charger before attempting to clean.

- **Children are not allowed to use or play with this charger.** This charger can be used by persons with reduced physical, sensory or mental capabilities or lack of experience and knowledge if they have been given supervision or instruction concerning use of the appliance in a safe way and understand the hazards involved. Otherwise, there is a risk of injuries.
- **Children shall be supervised during cleaning to ensure that they do not play with the appliance.**
- **To reduce the risk of injury, charge only DEWALT rechargeable batteries.** Other types of batteries may burst causing personal injury and damage.
- **DO NOT attempt to charge the battery pack with any chargers other than the ones in this manual.** The charger and battery pack are specifically designed to work together.
- **These chargers are not intended for any uses other than charging DEWALT rechargeable batteries.** Any other uses may result in risk of fire, electrical shock or electrocution.
- **Do not expose charger to rain or snow.**
- **Pull by plug rather than cord when disconnecting charger.** This will reduce risk of damage to electric plug and cord
- **Make sure that cord is located so that it will not be stepped on, tripped over, or otherwise subjected to damage or stress.**

- **Do not use an extension cord unless it is absolutely necessary.** Use of improper extension cord could result in risk of fire, electric shock, or electrocution.
- **Do not place any object on top of charger or place the charger on a soft surface that might block the ventilation slots and result in excessive internal heat.** Place the charger in a position away from any heat source. The charger is ventilated through slots in the top and the bottom of the housing.
- **Do not operate charger with damaged cord or plug — have them replaced immediately.**
- **Do not operate charger if it has received a sharp blow, been dropped, or otherwise damaged in any way.** Take it to an authorised service centre.
- **Do not disassemble charger; take it to an authorised service centre when service or repair is required.** Incorrect reassembly may result in a risk of electrical shock, electrocution or fire.
- **In case of damaged power supply cord, the supply cord must be replaced immediately by the manufacturer, its service agent or similar qualified person to prevent any hazard.**
- **Disconnect the charger from the outlet before attempting any cleaning. This will reduce the risk of electric shock.** Removing the battery pack will not reduce this risk.
- **NEVER attempt to connect 2 chargers together.**
- **The charger is designed to operate on standard 230V household electrical power. Do not attempt to use it on any other voltage.** This does not apply to the vehicular charger.
- **Take care to ensure that the charger is standing in a steady, secure position.** A falling battery or charger may present a risk of injury to yourself and/or others.
- **The location in which the charger is used should be clean and dry.** Use of a charger in a dirty or wet area could result in risk of fire, electric shock, or electrocution.
- **Always unplug the charger from the power supply when there is no battery pack in the cavity.**
- **Foreign materials of a conductive nature, such as, but not limited to, grinding dust, metal chips, steel wool, aluminum foil or any buildup of metallic particles should be kept away from the charger cavities and ventilation slots.**

SAVE THESE INSTRUCTIONS

Safety Instructions for Chargers

- **Do not abuse cord.** Never carry the charger by its cord. Never pull the cord to disconnect from the socket. Keep the cord away from heat, oil and sharp edges.
- **Remove the battery pack(s).** Unplug before leaving it unattended. Remove the battery pack(s) when not in use, and before servicing.
- This appliance is intended to be used in moderate climates.

- This appliance is not intended for use by persons (including children) with reduced physical, sensory or mental capabilities, or lack of experience and knowledge, unless they have been given supervision or instruction concerning use of the appliance by a person responsible for their safety.
- **Connect the charger to a mains supply that is properly connected to earth.** Socket and extension cord must have an operative protective conductor.
- **When operating the charger in damp environments is unavoidable, use a residual current device (RCD).** The use of a residual current device (RCD) reduces the risk of electric shock.
- Children should be supervised to ensure that they do not play with the appliance.
- Charger shall not be exposed to dripping or splashing; no objects filled with liquids, such as vases, shall be placed on it.
- No exposed flame sources, such as lighted candles, should be placed on the charger.
- Mains plug is used as the disconnect device; the disconnect device (plug) shall remain readily operable.

Grounding Instructions

The charger must be grounded. In the event of malfunction or breakdown, grounding provides a path of least resistance for electric current to reduce the risk of electric shock. The charger is equipped with a cord having an equipment-grounding conductor and a grounding plug. The plug must be plugged into an appropriate outlet that is properly installed and grounded in accordance with all local codes and ordinances.

⚠ DANGER: Improper connection of the equipment-grounding conductor can result in a risk of electric shock. The conductor with insulation having an outer surface that is green with yellow stripes is the equipment-grounding conductor. If repair or replacement of the cord or plug is necessary, do not connect the equipment-grounding conductor to a live terminal. Repairs shall only be performed by a DEWALT service agent. Do not modify the plug provided with the charger – if it will not fit the outlet, have a proper outlet installed by a DEWALT repair agent.

For grounded, cord-connected charger rated 16A and lower and intended for use on a nominal 230V supply circuit

The charger is for use on a nominal 230 V circuit, and has a grounding plug that looks like the plug in the following illustration.

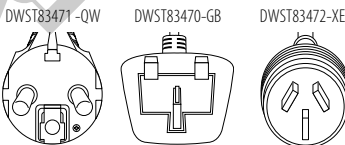

SAVE THESE INSTRUCTIONS

USB Charging Port Safety Warnings

- **The USB charging port is not intended for any use other than supplying power/charging small USB electronics.** Any other uses may result in risk of fire, electric shock or electrocution.
- **Do not expose the USB charging port to rain or snow.**
- **When operating the USB charging port outdoors, always provide a dry location.**
- **Do not operate the USB charging port charger has received a sharp blow, been dropped or otherwise damaged in any way.** Take the product to an authorized service center.

Residual Risks

⚠ WARNING: We recommend the use of a residual current device with a residual current rating of 30mA or less.

In spite of the application of the relevant safety regulations and the implementation of safety devices, certain residual risks cannot be avoided. These are:

- Impairment of hearing.
- Risk of personal injury due to flying particles.
- Risk of burns due to accessories becoming hot during operation.
- Risk of personal injury due to prolonged use.

SAVE THESE INSTRUCTIONS

Electrical Safety

The electric motor has been designed for one voltage only. Always check that the power supply corresponds to the voltage on the rating plate.



Your DEWALT tool is double insulated in accordance with EN62841; therefore no earth wire is required.

If the supply cord is damaged, it must be replaced only by DEWALT or an authorised service organisation.

Mains Plug Replacement (U.K. & Ireland Only)

If a new mains plug needs to be fitted:

- Safely dispose of the old plug.
- Connect the brown lead to the live terminal in the plug.
- Connect the blue lead to the neutral terminal.

⚠ WARNING: No connection is to be made to the earth terminal.

Follow the fitting instructions supplied with good quality plugs. Recommended fuse: 13 A.

Using an Extension Cable

If an extension cable is required, use an approved 3-core extension cable suitable for the power input of this tool (see **Technical Data**). The minimum conductor size is 1.5 mm²; the maximum length is 30 m.

When using a cable reel, always unwind the cable completely.

Package Contents

The package contains:

- 1 Toughsystem 2.0 Charger Box
- 1 Li-Ion battery pack (C1, D1, G1, L1, M1, P1, S1, T1, X1, Y1 models)
- 2 Li-Ion battery packs (C2, D2, G2, L2, M2, P2, S2, T2, X2, Y2 models)
- 1 Instruction manual

NOTE: Battery packs, are not included with N models. Battery packs are not included with NT models. B models include Bluetooth® battery packs.

NOTE: The Bluetooth® word mark and logos are registered trademarks owned by the Bluetooth®, SIG, Inc. and any use of such marks by DeWALT is under license. Other trademarks and trade names are those of their respective owners.

- Check for damage to the tool, parts or accessories which may have occurred during transport.
- Take the time to thoroughly read and understand this manual prior to operation.

Markings on Tool

The following pictograms are shown on the tool:



Read instruction manual before use.



Wear ear protection.



Wear eye protection

Date Code Position (Fig. A)

The date code **19**, which also includes the year of manufacture, is printed into the housing.

Example:

2022 XX XX

Year and Week of Manufacture

Description (Fig. A)



WARNING: Never modify the power tool or any part of it. Damage or personal injury could result.

- 1 Carry handle
- 2 Storage door
- 3 Door latch handle
- 4 Metal latch
- 5 Latch pin slot
- 6 Charging lights
- 7 USB-C port cover.
- 8 Power cord
- 9 Cord retaining hooks
- 10 Security locking hole
- 11 Stacking latch

Intended Use

This battery charger is designed to charge DeWALT 18V and 54V FLEXVOLT™ lithium-ion battery packs.

This battery charger is equipped with one USB-A and one USB-C charging port and is designed to charge or supply power to USB compatible devices.

DO NOT use under wet conditions or in the presence of flammable liquids or gases.

DO NOT let children come into contact with the tool. Supervision is required when inexperienced operators use this tool.

- **Young children and the infirm.** This appliance is not intended for use by young children or infirm persons without supervision.
- This product is not intended for use by persons (including children) suffering from diminished physical, sensory or mental abilities; lack of experience, knowledge or skills unless they are supervised by a person responsible for their safety. Children should never be left alone with this product.

OPERATION

Instructions for Use



WARNING: Always observe the safety instructions and applicable regulations.



WARNING: To reduce the risk of serious personal injury, turn tool off and disconnect tool from power source/battery pack before making any adjustments or removing/installing attachments or accessories.

An accidental start-up can cause injury.

Charging a Battery (Fig. A, E, F)

1. Plug the charger into an appropriate outlet.
2. Insert and fully seat battery pack. The red charging light(s) will continuously blink while charging.
3. Charging is complete when the red charging light(s) remain(s) continuously ON. Battery pack can be left in charger or removed. Some chargers require the battery pack release button to be pressed for removal.



WARNING: Only charge batteries in air temperature over 40 °F (4.5 °C) and below 104 °F (+40 °C).

4. Charger will not charge a faulty battery pack, which may be indicated by the charging light(s) staying OFF. Take charger and battery pack to an authorized service center if light(s) stay(s) OFF.

NOTE: Refer to label near charging light(s) on charger for blink patterns. Older chargers may have additional information and/or may not have a yellow indicator light.

NOTE: To remove the battery pack, some chargers require the battery pack release button to be pressed.

Hot/Cold Pack Delay

When the charger detects a battery pack that is too hot or too cold, it automatically starts a Hot/Cold Pack Delay, suspending charging until the battery pack has reached an appropriate temperature. The charger then automatically switches to the

pack charging mode. This feature ensures maximum battery pack life.

A cold battery pack may charge at a slower rate than a warm battery pack.

The hot/cold pack delay will be indicated by the red light(s) continuing to blink but with the yellow light continuously ON. Once the battery pack has reached an appropriate temperature, the yellow light will turn OFF and the charger will resume the charging procedure.

This charger is equipped with an internal fan. The fan will turn on automatically when a battery is being charged.

CAUTION: Never operate the charger if the fan does not operate or if the ventilation slots are blocked. Do not permit foreign objects to enter the interior of the charger.

NOTE: To ensure maximum performance and life of lithium-ion battery packs, charge the battery pack fully before first use.

1. Plug the charger into an appropriate outlet before inserting battery pack.
2. To unlock the storage door **2**, flip up the door latch handles **3** and lift and move the metal latches **4** from the latch pin slot **5** of the storage door.
3. Open the storage door **2** to access the storage compartment **12** and the battery charger **13**.
4. Slide the battery pack **20** onto the left or right side charger rails **14**, making sure the battery is fully seated. The left or right side charging light **6** will blink continuously indicating that the charging process has started.

NOTE: Charging can take place with the storage door **2** open or closed.

NOTE: To close the storage door **2**, use one hand to support the storage door and use the other hand to lift up and slide the door brace **16** towards the front of the box.

5. The **Stage 1** charging blink indicator represents the charge process that charges the majority of the battery's capacity.
6. The **Stage 2** charging blink indicator represents the remainder, or top off charge process, for the battery to reach full capacity.
7. The completion of charge for **Stage 1** or **Stage 2** will be indicated by the stage's light remaining ON continuously.
8. The battery pack is fully charged when both **Stage 1** and **Stage 2** charging lights remain ON continuously, and it may be removed and used at this time or left in the charger.

NOTE: To remove the battery pack, some chargers require the battery pack release button **19** to be pressed.

Indicators			
	Stage 1 Charging	--- ---	
	Stage 2 Charging	--- ---	
	Fully Charged	—————	
	Hot/Cold Pack Delay*	--- ---	

*The red light will continue to blink, but a yellow indicator light will be illuminated during this operation. Once the battery pack has reached an appropriate temperature, the yellow light will turn off and the charger will resume the charging procedure.

A charger will not charge a faulty battery pack. The charger refusing to light could indicate a problem with the charger or a faulty battery pack.

NOTE: If the charger refuses to light, take the charger and battery pack to be tested at an authorized service center.†

Leaving the Battery Pack In the Charger

The charger and battery pack can be left connected with the charge indicators showing pack charged.

Charger Cleaning Instructions

WARNING: Shock hazard. Disconnect the charger from the AC outlet before cleaning. Dirt and grease may be removed from the exterior of the charger using a cloth or soft non-metallic brush. Do not use water or any cleaning solutions.

Proper Hand Position (Fig. E)

WARNING: To reduce the risk of serious personal injury, ALWAYS use proper hand position as shown.

WARNING: To reduce the risk of serious personal injury, ALWAYS hold securely in anticipation of a sudden reaction.

Carry Handle (Fig. A)

This charger has a built in carry handle **1** that allows you to carry the charger when not attached to a ToughSystem® storage box.

Storage Compartment (Fig. F)

WARNING: Avoid overfilling the storage compartment to prevent any interference with the batteries being charged.

WARNING: Do not force close the storage door. If the storage door will not fully close or the door latches will not lock easily, ensure the storage compartment is not overfilled. Remove a few items and try closing the storage door and locking the latches again.

This charger has a built in storage compartment **12** to carry your extra batteries, cords or tools.

1. To unlock the storage door **2**, flip up the door latch handles **3** and lift and remove the metal latches **4** from the latch pin slot **5** of the storage door.
2. To access the storage compartment **12**, open the storage door **2** until the door brace **16** locks into position.
3. To close the storage door **2**, use one hand to support the storage door **2** and use the other hand to lift up and slide the door brace **16** towards the front of the box.
4. To lock the storage door **2**, lift and move the metal latches **4** to the latch pin slot **5** of the storage door. Press down and inward on the door latch handles **3** until they make an audible click. Ensure the door latch handles are securely held in place.

USB Charging Ports (Fig. A, G)

This charger is equipped with one USB-A **17** and one USB-C **18** charging ports. The USB-A **17** delivers up to 2.4 amps and the USB-C **18** delivers up to 3.0 amps of total current.

NOTE: The current delivered to the device is dependent upon the user's device and user's chosen cable.

NOTE: Do not plug in devices that exceed the output ratings on the rating label. Doing so will shorten the chargers useful life.

Using the USB-A port:

1. Open the storage door to gain access to the USB-A charging port **17**.
2. Insert a USB-A plug into USB-A charging port **17** to supply power or charge your device.

Using the USB-C port:

1. The USB-C charging port **18** is located on the back of the box, above the power cord **8**.
2. Pull back the USB-C port cover **7** to reveal the USB-C charging port **18**.
3. Insert a USB-C plug into USB-C charging port **18** to supply power or charge your device.

NOTE: Ensure the port cover is reinstalled after use.

MAINTENANCE



WARNING: To reduce the risk of serious personal injury, turn unit off and disconnect it from power source and remove the battery pack before making any adjustments or removing/installing attachments or accessories. An accidental start-up can cause injury.

Your DEWALT product has been designed to operate over a long period of time with a minimum of maintenance. Continuous satisfactory operation depends upon proper care and regular cleaning.

Storage and Transportation

- Always store disconnected from power supply!
- Avoid using the product outdoors or transporting in an open vehicle if there is noticeable damage to the sealing gasket or plastic exterior.
- Avoid continuous exposure to rain or other precipitation if stored outdoors or on a vehicle, or if transported in an open vehicle.
- Store the charger in a place that is as cool and dry as possible.
- Store the charger in a place where it cannot be accessed by children or unauthorized persons.
- Check the charger for damage before use after long periods of storage.



Lubrication

Your power tool requires no additional lubrication.



Cleaning



WARNING: Blow dirt and dust out of the main housing with dry air as often as dirt is seen collecting in and around the air vents. Wear approved eye protection and approved dust mask when performing this procedure.



WARNING: Never use solvents or other harsh chemicals for cleaning the non-metallic parts of the tool. These chemicals may weaken the materials used in these parts. Use a cloth dampened only with water and mild soap. Never let any liquid get inside the tool; never immerse any part of the tool into a liquid.

Optional Accessories



WARNING: Since accessories, other than those offered by DEWALT, have not been tested with this product, use of such accessories with this tool could be hazardous. To reduce the risk of injury, only DEWALT-recommended accessories should be used with this product.

Consult your dealer for further information on the appropriate accessories.

Tool Connect™ Chip (Fig. I)

Optional Accessory



WARNING: To reduce the risk of serious personal injury, turn unit off and disconnect it from power source and remove the battery pack before making any adjustments or removing/installing attachments or accessories. An accidental start-up can cause injury.

Your tool is Tool Connect™ Chip ready and has a location for installation of a Tool Connect™ Chip.

Tool Connect™ chip **21** communicates with an optional application for your smart device (such as a smart phone or tablet) that connects the device to utilize the mobile application for inventory management functions.

Refer to **Tool Connect™ Chip Instruction Sheet** for more information.

Installing the Tool Connect™ Chip

1. Insert the Tool Connect™ Chip **21** into the empty pocket **23**.
2. Ensure that the Tool Connect™ Chip is flush with the housing. Secure it with the retaining screws **22** and tighten the screws.
3. Refer to **Tool Connect™ Chip Instruction Sheet** for further instructions.

Protecting the Environment



Separate collection. Products and batteries marked with this symbol must not be disposed of with normal household waste.

Products and batteries contain materials that can be recovered or recycled, reducing the demand for raw materials. Please recycle electrical products and batteries according to local provisions. Further information is available at www.2helpU.com.

Rechargeable Battery Pack

This long-life battery pack must be recharged when it fails to produce sufficient power on jobs that were easily done before. At the end of its technical life, discard it with due care for our environment:

- Run the battery pack down completely, then remove it from the tool.
- Li-Ion cells are recyclable. Take them to your dealer or a local recycling station. The collected battery packs will be recycled or disposed of properly.

Batteries				DWST83470 DWST83471 DWST83472
Cat #	V _{DC}	Ah	Weight (kg)	Chargers/Charge Times (Minutes)
DCB546	18/54	6.0/2.0	1.05	170
DCB547	18/54	9.0/3.0	1.46	270
DCB548	18/54	12.0/4.0	1.44	350
DCB181	18	1.5	0.35	45
DCB182	18	4.0	0.61	120
DCB183/B	18	2.0	0.40	60
DCB184/B	18	5.0	0.62	150
DCB185	18	1.3	0.35	40
DCB187	18	3.0	0.54	90
DCB189	18	4.0	0.54	120
DCBP034	18	1.7	0.31	50

NOTE: Battery charge times matrix provided for guidance only; charge times will vary depending on temperature and condition of batteries.

