

OPERATING INSTRUCTIONS AND SAFETY NOTES

Rotary Pump

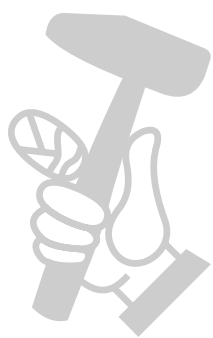

МАГАЗИН МАЙСТОРА
БАШ МАЙСТОРА
ПРОФЕССИОНАЛНИ РЕШЕНИЯ



Pressol Schmiergeräte GmbH

This documentation is exclusively intended for the operating company and their staff.

Without our written consent, the content of this documentation (textes, figures, drawings, charts, diagrams etc.), must not be duplicated or distributed, neither in full or in part, utilized for the purpose of competition or passed on/made available to third parties.

Pressol Schmiergeräte GmbH

Parkstraße 7
93167 Falkenstein | Germany
Tel. +49 9462 17-0
Fax +49 9462 17-208
info@pressol.com
www.pressol.com

Operating instructions translation

Date of issue: 07/2021

We reserve the right to make design and product modifications, which serve to improve the product.

Table of Contents

1.	Introduction	3
1.1.	Preface	3
1.2.	Obligations of the personnel	3
1.3.	Symbols in this manual	3
1.3.1.	Structure of the safety notes	3
1.3.2.	Hazard symbols	4
1.3.3.	General symbols	4
2.	Safety instructions	4
2.1.	Authorized personnel	4
2.2.	Intended conditions of use	4
2.3.	Reasonably foreseeable misuse	5
3.	Risks when handling diesel, combustibles and oils	5
4.	Technical data	5
5.	Assembly	6
6.	Commissioning	7
7.	Disposal	7
8.	Repair/Service	7
9.	Exploded view rotary pump	8

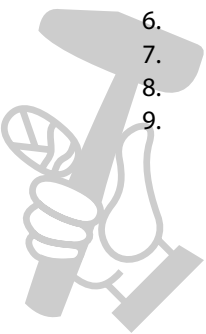

1. Introduction

1.1. Preface



IMPORTANT

- Read and observe the directions of use carefully before use.

Our staff will be pleased to provide support if you have any questions about the product.

Yours sincerely, Pressol Schmiergeräte GmbH

1.2. Obligations of the personnel

Before they start to work, all persons who are entrusted to work with the rotary pump are obliged:

- to follow all applicable regulations on occupational safety and accident prevention;
- to read and to comply with all safety instructions and warning notes contained in these operating instructions.

Please observe the following instructions in the interest of all concerned:

- Refrain from any unsafe working methods!
- Adhere to all hazard and warning notes contained in this manual!
- In addition to this documentation, keep to all generally accepted safety rules, legal provisions as well as all other binding rules regarding occupational safety, accident prevention and environmental protection!
- Wear appropriate protective clothing in accordance with the work to be done!
- Perform only work for which you have been sufficiently trained and instructed!
- Only genuine spare parts as well as original tools and auxiliaries of the manufacturer are allowed to be used in order to ensure the functional safety and maintain the warranty coverage.

1.3. Symbols in this manual

1.3.1. Structure of the safety notes

The safety notes have the following structure:



SIGNAL WORD

Type and source of the hazard

- Consequences of non-compliance with the notes
- Measures to avoid that risk

Depending on the danger level, different signal words are used:



Signal word	Danger level	Consequences of non-compliance
DANGER	Imminent threat of danger	Death or serious bodily injury
WARNING	Possible threat of danger	Death or serious bodily injury
CAUTION	Possibly dangerous situation	Minor bodily injury



Note

Indicates further information or tips which facilitate work

1.3.2. Hazard symbols

Symbol	Meaning
	General hazard symbol. The warning note marked in this way contains supplementary information on the type of hazard.
	This symbol warns of a hazardous explosive atmosphere

1.3.3. General symbols

Symbol	Meaning
■	A small black square indicates the work you have to perform
–	The dash denotes lists

2. Safety instructions

Various dangers may occur if the rotary pump is improperly handled during installation, commissioning and daily operation.

**WARNING****Risk of injury and damage to material property because of improper handling**

- Hold the manual at the disposal of the operating staff at the usage site of the unit.
- Country-specific safety measures and accident prevention regulations must be observed.

2.1. Authorized personnel

Only qualified and authorized persons are allowed to operate and to work on the rotary pump.

Persons are qualified if they are, due to their training, experience, instruction and knowledge of the relevant standards, able to assess assigned tasks and to identify potentially hazardous situations.

All persons charged with installation, operation, maintenance and repair work, must have read and understood this operation manual.

2.2. Intended conditions of use

The rotary pump is to be used only for the delivery of:

- oils, up to SAE 90
- self-lubricating, non-aggressive media
- fuel oil
- diesel
- petroleum

The temperature of the pumped liquid must be between +10 °C and +35 °C.

Application:

- For filling measuring vessels, storage cans and canisters.

2.3. Reasonably foreseeable misuse

Any departure from the usage stipulations (other fluid media, use of force) or user modifications (changes, use of non-original parts) can be dangerous and are considered as non-intended usage.

The user is liable for any damage resulting from non-intended use.

Not allowed to be used in the food industry.



DANGER

Risk of injury and material damage from explosive vapors

- Never use the pump to deliver fatty substances or explosive fluids such as petrol or other fluids with similar flashpoints!

3. Risks when handling diesel, combustibles and oils

Diesel and combustibles are flammable liquids. This must be also taken into consideration regarding the storage. If improperly handled, they can cause risks to human health or to the environment.

Escaping liquids can cause environmental harm. Do not allow to enter sewage or ground water. Comply with all country-specific statutory water pollution control stipulations.



DANGER

Use of diesel and combustibles

- May be fatal if swallowed and enters airways.
- Do not smoke, do not use open fire and do not weld when handling diesel and combustibles.

Use of oils

- Oils may cause lung damage if swallowed.



CAUTION

- Avoid skin and eye contact!
- In case of contact with eyes, rinse immediately with plenty of clean water and seek medical advice!
- Keep at hand and observe the material data safety sheet.

4. Technical data

Pump type	Rotary pump 13055 / 13056	
Delivery rate	(l/rotation)	0,3
Delivery rate at 60 rotations/min	(l/min)	18 (diesel)
Pumping media	Oils up to SAE 90 self-lubricating, non-aggressive media fuel oil diesel petroleum	
Usage	Containers for 60 / 200 / 220 l	
Discharge	Discharge spout or discharge hose with steel spout	
Telescopic suction tube 3-pieces	(mm)	355-955
Barrel screw coupling	G 2" a	
Material pump housing	Impact resistant die casting	

Tab. 4.-1: Technical data

5. Assembly

- Check and prepare all parts before assembly. Refer to fig. 5.-1 (1).
- Connect the lower part of the suction tube with the middle part of the suction tube and the strainer. Refer to fig. 5.-1 (2).
- Push the barrel screw coupling on the upper part of the suction tube. Tighten the barrel screw coupling. Place the O-ring above the thread on the upper part of the suction tube. Refer to fig. 5.-1 (3).
- Assemble the lower suction tubes and the strainer (fig. 5-1 (2)) to the upper part of the suction tube with pump and discharge spout. Refer fig. 5.-1 (4).
- The rotary pump is prepared for the assembly to appropriate containers by means of the barrel screw coupling. Refer fig. 5.1-(5).

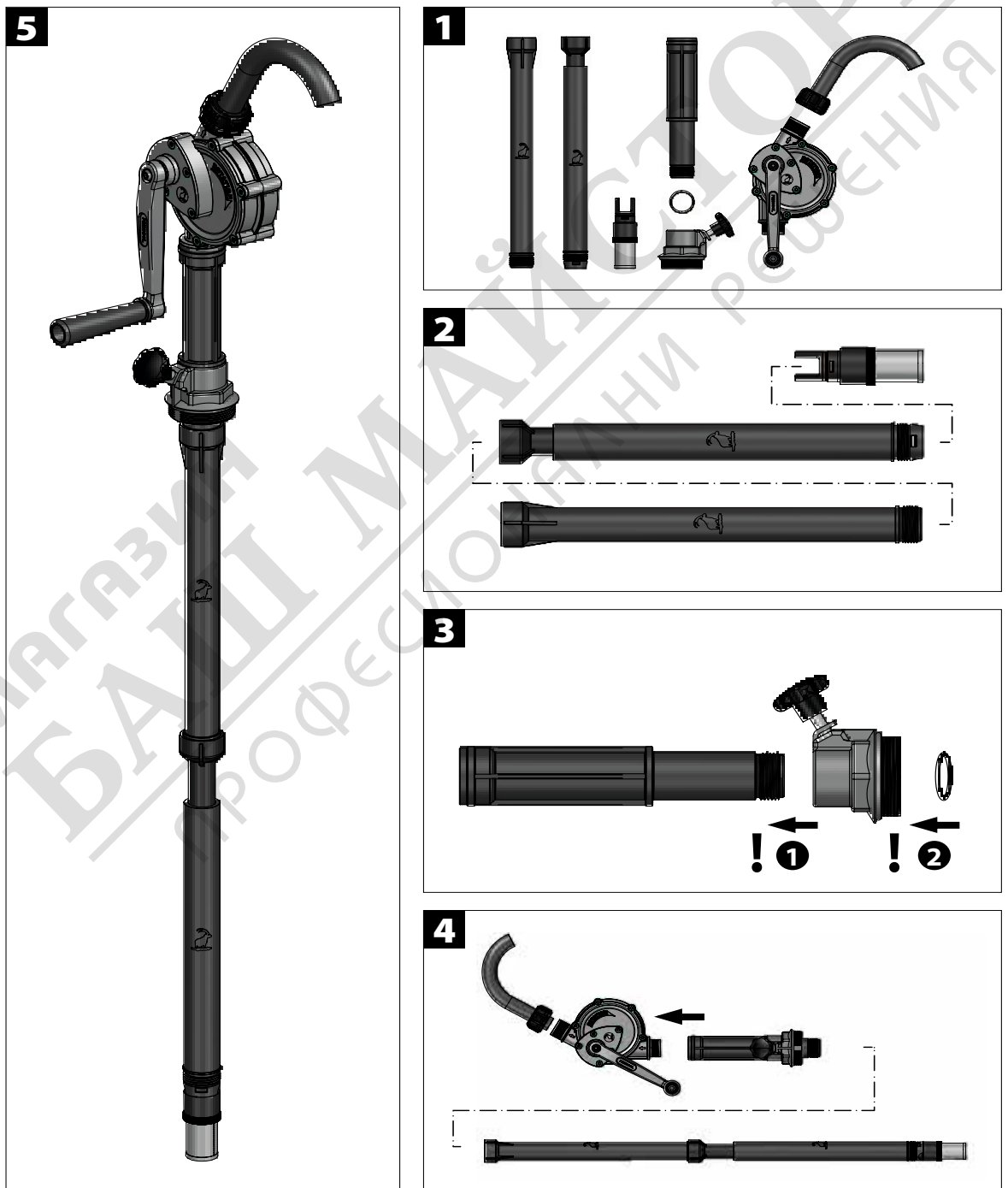

Fig. 5.-1: Assembly

6. Commissioning

- Before starting up, check the pump for proper installation and visible damage.
- 2 to 3 fast rotations for pump suction.
- In case of heavy oils (from SAE 75-ISO VG 32-10W) it may be necessary to fill the pump.

7. Disposal

The operating company is responsible for the proper disposal of the pump.

Dispose of the different materials in accordance with all industry-specific, local, regional and federal regulations.

Only qualified personnel is authorized to disassemble and dispose of the pump.

8. Repair/Service

The rotary pump was developed and produced according to the highest quality standards.

Should a problem develop, despite all quality controls, please contact our customer service:

Pressol Schmiergeräte GmbH

Tel.: +49 9462 17-246

Fax: +49 9462 1063

service@pressol.com

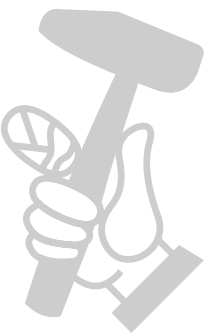

9. Exploded view rotary pump

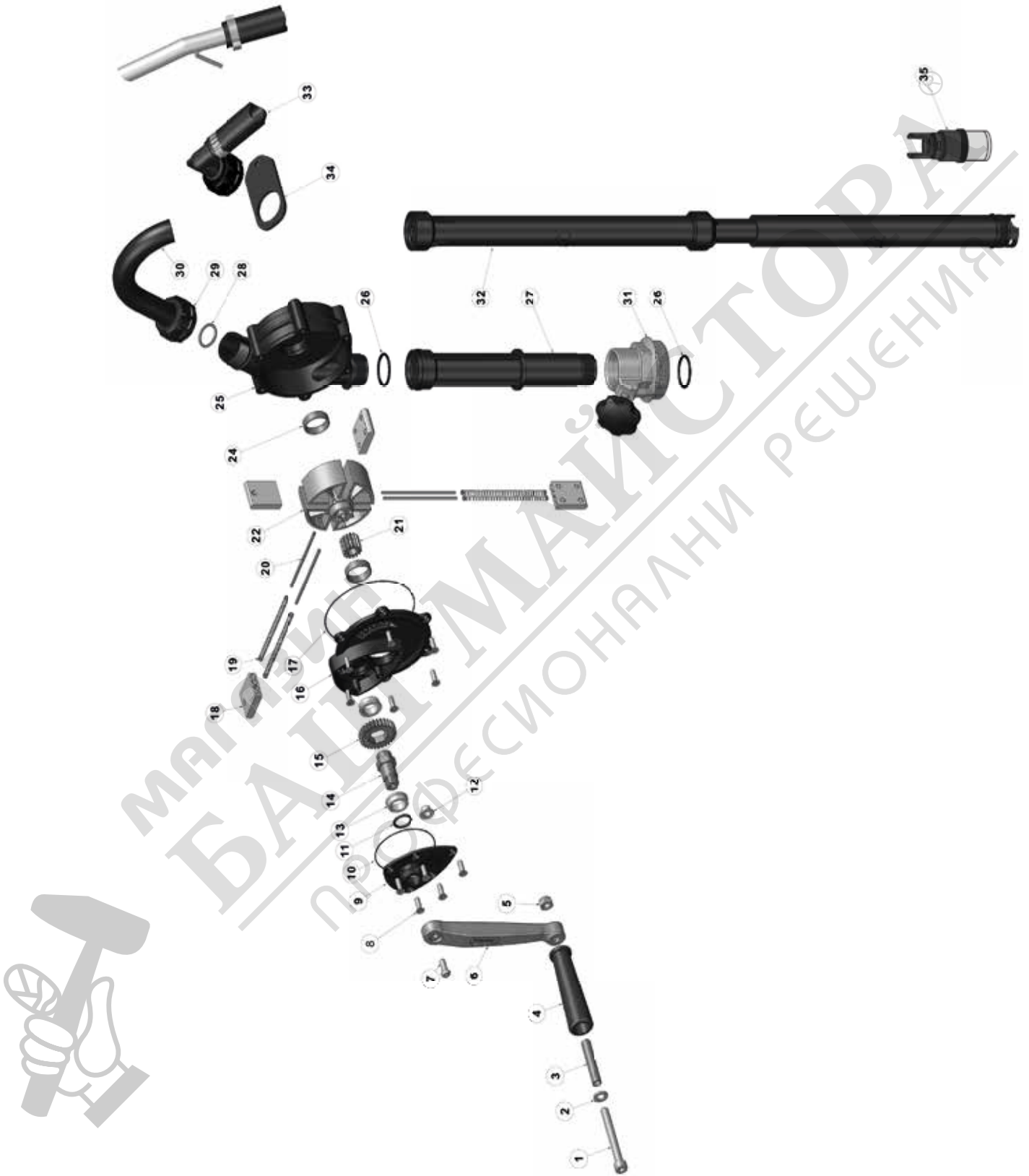

Fig. 9-1: Exploded view rotary pump

Pos.	Quantity	Description	Item number
1	1	Cylinder screw M 8x70	84 755
2	1	Washer 8,4x1,6	84 754
3	1	Sleeve	89 469
4	1	Crank handle	88 853
5	1	Hexagonal nut M 8 DIN 985	00 019
6	1	Crank	88 854 777
7	1	Lens head screw M 6x16	91 185
8	11	Self-tapping screw	91 468
9	1	Gear cover	88 864 777
10	1	O-ring NBR 70-65x1	88 908
11	1	O-ring FKM 80-16x25,5	89 277
12	1	Bearing sleeve	88 852
13	2	Plain bearing with flange	88 861
14	1	Shaft	88 855
15	1	Gear wheel Z30	88 797
16	1	Gear housing	88 865
17	1	O-ring NBR 70-98x1	89 316
18	4	Lamella	88 858
19	4	Compression spring 5x0,6x100	88 850
20	4	Pin	89 468
21	1	Gear wheel Z15	81 099
22	1	Rotor	88 859
24	2	Bearing ring	88 863
25	1	Housing	88 866
26	2	O-ring NBR 70-29x2,5	89 111
27	1	Adapter G1" m - G1" f	88 851
28	1	O-ring NBR 70-20x2,5	88 137
29	1	Coupling nut G1"	82 857 012
30	1	Discharge spout	81 112
31	1	Clamping device complete	04 464 001
32	1	Telescopic suction tube 3-pieces	13 094
33	1	Discharge hose complete set	13 044 020
34	1	Hose holder	00 845
35	1	Strainer	13 097 003

Tab. 9.-1: Overview of components for fig. 9.-1

Pressol Schmiergeräte GmbH

Parkstraße 7

93167 Falkenstein | Germany

Tel. +49 9462 17-0

Fax +49 9462 17-208

info@pressol.com

www.pressol.com

МАГАЗИН
БАШ МАЙСТОРА®
ПРОФЕСИОНАЛНИ РЕШЕНИЯ

