

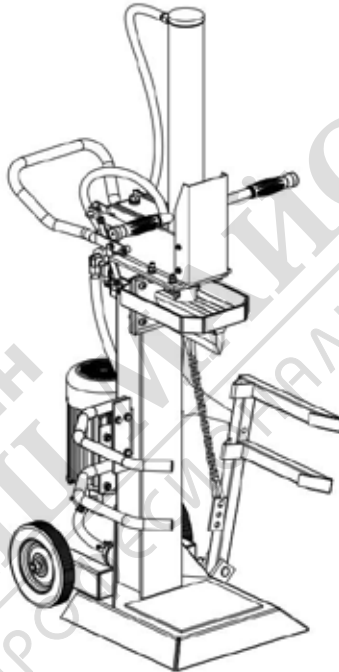

**Manual de utilizare**  
**Használati és karbantartási kézikönyv**  
**User manual**



Despicator vertical lemne, pg. 6

Rönkhasító, pg. 22

Vertical log splitter, pg. 38

**BTA-DV8T / BTA-DV10T / BTA-DV12T**  
**BTA-DV15T / BTA-DV18T**



**Italia Star Com Due S.R.L.**

Autostrada Bucuresti-Pitesti, km. 13/2, Loc. Chiajna, IF

☎ 004/021.433.03.27













info@italiastar.ro

[www.italiastar.ro](http://www.italiastar.ro)

Please read this operation manual carefully before using this product.

## Explanation of the Warning Symbols

This User's Guide describes safety symbols as well as internationally used symbols and pictograms placed on this machine. Prior to using this machine, you must have read all safety warnings. Improper usage of this log splitter may cause injuries as a result of fire or electric shock, or entail cutting injuries and damage to property.

			
<b>WARNING:</b> Read the safety warnings and operating instructions given in this User's Guide and keep the latter in a safe place for later reference.	Wear solid footwear to protect your feet from falling logs.	Wear safety gloves to protect your hands from wood chips and splinters.	Wear safety goggles or a visor to protect your eyes from wood chips and splinters coming off.
			
Do not allow any persons to stay within your working area. Any persons or animals around must be at least 5 m away from this machine.	Waste oil must be disposed of in accordance with the locally applicable laws and must never flow into the environment.	<b>CAUTION:</b> There is a hazard of cutting or crushing injuries. Keep your hands off the splitting wedge when the latter is moving.	<b>WARNING:</b> Closely watch the direction of the log pusher.
			
<b>WARNING:</b> Never use your hands to remove a log jammed on the splitting wedge. Use a suitable tool to do so.	<b>WARNING:</b> Pull the mains plug before doing any cleaning and maintenance work.	Never remove any guards and safety devices.	<b>WARNING:</b> Do not use this wood splitter in the rain. Also avoid use under wet conditions.

## General Safety Instructions

Read this chapter with utmost care. Exact knowledge of the described dangerous situations during the operation of the machine and of the instructions for proper usage is indispensable to avoid injuries of persons and animals as well as damage to property.

**IMPORTANT:** This log splitter exclusively serves for splitting logs, whose dimensions must correspond to the recommendations given herein. Any other use shall be considered improper, and the manufacturer will not be liable to any consequential injuries of persons or animals as well as to any damage to property as a result of improper usage of this machine.

The user must be within the specified working area and must use both hands to actuate the control device. Under no circumstances must the user employ any other systems. Any other persons or animals, with the exception of the user, must keep a safety distance of 5 m around this log splitter while it is in use. Check the ground on which you intend to work for stability and firm hold. This log splitter may only be used with its protective facilities properly installed. Disregarding the instructions given in this chapter can result in severe consequential personal injuries or damage to property or to this machine itself.

1. Only one person is allowed to work on this machine.
2. No one may use this log splitter without having read its User's Guide before, or without having been instructed on the rules for proper and safe machine usage.
3. The operator must be at least 18 years old. Trainees at a minimum age of 16 years may only work on this machine under supervision.
4. Never wear any jewellery (rings, necklaces, watches, etc.) or wide clothes such as oversized overalls, gloves or shoes as these could be caught by moving parts. Specific protective clothing such as safety shoes and special gloves are mandatory. Always wear a hair net if you have longer or long hair.
5. Always wear safety goggles. Bear in mind that normal glasses do not offer sufficient protection as they can even cause more severe injuries as a result of glass breakage.
6. Always use this log splitter on dry, level and unfrozen ground. If you use this log splitter outdoors on a lawn make sure that the grass has been cut short.
7. Ensure good footing so that you can keep your balance. Never stand on your log splitter. Ensure that the log splitter is firmly placed on the ground so that it cannot fall over. This can avoid serious injuries.
8. Stay sufficiently away from the splitting wedge to avoid injuries caused by chips and splinters coming off.
9. Keep any other persons away. Any other persons, children or animals, with the exception of the user, must keep a safety distance of 5 m around this log splitter while it is in use.
10. Make sure whether you have removed any foreign bodies from the log you want to split to prevent them from coming off during splitting and cause damage to this machine.
11. Never split any logs which contain nails, cables or dangerous foreign substances. Make sure that always both ends of the log you are just processing are split as square as possible. This is the only way to guarantee that the log will not be forced out of its vertical position, while branches must have been cut off flush.
12. Never split any logs, whose dimensions are bigger than those specified under "Size of Logs". Otherwise, injuries or irreparable damage to the machine will be the result.
13. Split the logs along the grain. Never place a log on this splitter crosswise to split it this way. This could result in injuries and damage to the machine.
14. Never pile up the logs in order to process several logs at the same time. Parts of the wood could be flung off into the air and hit you.
15. ONLY use your hands to operate the levers. Never use your feet, knees, a rope or similar means to operate the levers. Continuously concentrate on the movements of the splitting wedge. Never try to load the log splitter while its splitting wedge is in motion. Do not put your hands in the vicinity of the moving parts of this machine.
16. Protect your hands. Never bring your hands in the vicinity of any gaps opening in the log as these may close in a matter of seconds and crush or even cut off your hands. Do not remove any jammed parts of a log with your hands. When the splitting wedge of the log splitter is returning keep your hands off the machine, as this log splitter has been designed so that it will automatically stop once the cylinder has fully retracted.
17. Do not run this log splitter under full load for more than 5 seconds by keeping the cylinder pressed, for example, or if you want to split a hard log. This would result in quick overheating of the pressurized oil causing consequential damage to the machine. It is advisable to turn the log 90° and to try to split it at this position. If it is still impossible to split such log please dispose of it instead of subjecting it to any further splitting process to avoid damage to the machine.
18. Do not press the splitting wedge against the log. You could cause breakage of the wedge or damage to the column.
19. Do not use the log splitter under any circumstances when you are under the influence of alcohol, drugs or medications, or if you are tired.
20. This machine must never be used in damp or potentially explosive areas. Never use this machine in rooms containing aggressive vapours (natural gas, petrol vapours or inflammable vapours).
21. Never smoke while you are working on this machine and make sure that there are no open fire sources or oil tanks in the vicinity of your working area. DANGER – EXPLOSION HAZARD.
22. Check whether your power supply circuit is efficiently fused and conforms with the properties of the motor. Conformity with the power rating, the voltage and the frequency (refer to the values indicated on the type label), earthing and a standard voltage transformer connected in series are indispensable.
23. Never leave this machine unattended after you have powered it up, or while it is working. Keep an eye on the machine until it has come to a complete standstill. Unplug the power cord when you do not use this machine, or before you do any maintenance work, change the connections and move the machine. Please read this User's Guide before doing any maintenance work.
24. Keep your workplace inaccessible to children. Lock your working room. Store your log splitter in a room which is inaccessible to children and other persons who are not familiar with how to use this machine.

## Proper Usage

1. This machine is in conformity with the applicable EC Machine Directive.
2. Logs may only be split in the direction of the grain. Never try to split logs lying in horizontal position or crosswise to the grain.
3. The safety, working and maintenance instructions given by the manufacturer as well as the dimensions indicated in the technical specifications must be kept.
4. The relevant rules for the prevention of accidents and all other generally accepted safety regulations must be observed.
5. This log splitter may only be used, maintained or repaired by skilled persons who are familiar with it and have been informed on the hazards related to it. Any unauthorized modifications made to this log splitter will exclude the manufacturer's liability to any damage resulting therefrom.
6. This log splitter may only be used in connection with original accessories and tools from its manufacturer.
7. Any usage in excess of this will be considered improper. The manufacturer will not be liable to any damage resulting therefrom, and the risk of it shall solely be borne by the user.

**NOTE:** This machine has been designed and built on condition that this User's Guide be followed. Any modifications to this machine or using it for any purposes it has not been designed for can lead to serious or fatal accidents and will result in the annulment of any right to claim under warranty.

## Residual Risks

Even proper usage can still involve the following residual risks:

- ò Injuries to your fingers and hands caused by the splitting tool.
- ò Injuries by workpieces and parts coming off as a result of improper holding and guiding.
- ò Injuries by contact with live parts when electric components are opened or defective.
- ò Hearing impairment after working for a long time without wearing ear protection.
- ò Residual hazards can be minimized if you follow the instructions given in the "Proper Usage" and "Safety Instructions" chapters as well as in this User's Guide in general.

## Operating Conditions

This log splitter is designed for outdoor temperatures between +5 °C and 40 °C and for installation at a maximum altitude of 1000 m above sea level. The air humidity at the workplace should not exceed 50 % at 40 °C. This machine can be stored or handled at outdoor temperatures between -25 °C and 55 °C.

## Electrical Safety

**IMPORTANT:** Make sure that the electric circuit is fused, and that the power, voltage and frequency of the motor is supported by your mains supply. Also, make sure, that your power supply is earthed. Connect your log splitter to earth. Never open the ON/OFF switchbox. However, if it should become necessary to do so, contact a skilled electrician. Make sure that you will never touch live contacts, specifically when you plug or unplug your log splitter. This machine and its power cord must never get into contact with water. Never use its power cord to move/shift your log splitter. Always unplug the power cord before handling your log splitter. Do not yank the plug out of the wall socket by the cable and protect the latter against heat sources, oil and objects which can damage it. Neither expose your log splitter to rain nor to wetness.

**NOTE:** When equipment like this is being started a short-time voltage drop may occur, particularly if the mains quality is poor. Such drops can affect other consumers (e. g. flickering of a lamp). At a mains impedance of  $Z_{max} < 0.448 \Omega$ , such trouble is not to be expected. (For further information, please contact your local energy supply company.)

## Electrical Connection

The single-phase 230 V/50 Hz motor of this log splitter should be connected to a standard 230 V  $\pm 10$  %/50 Hz  $\pm 1$  Hz power supply source provided with a residual-current circuit breaker.

**CAUTION:** Any unprofessional use of extension cables can cause overheating of this log splitter. Ensure that the extension cable is not longer than 10 m and its wire cross section is not less than 2.5 mm<sup>2</sup>. Never use uninsulated or bare cables, respectively. The extension cable must be suitable for outdoor use.

Assembly (Fig. 1)

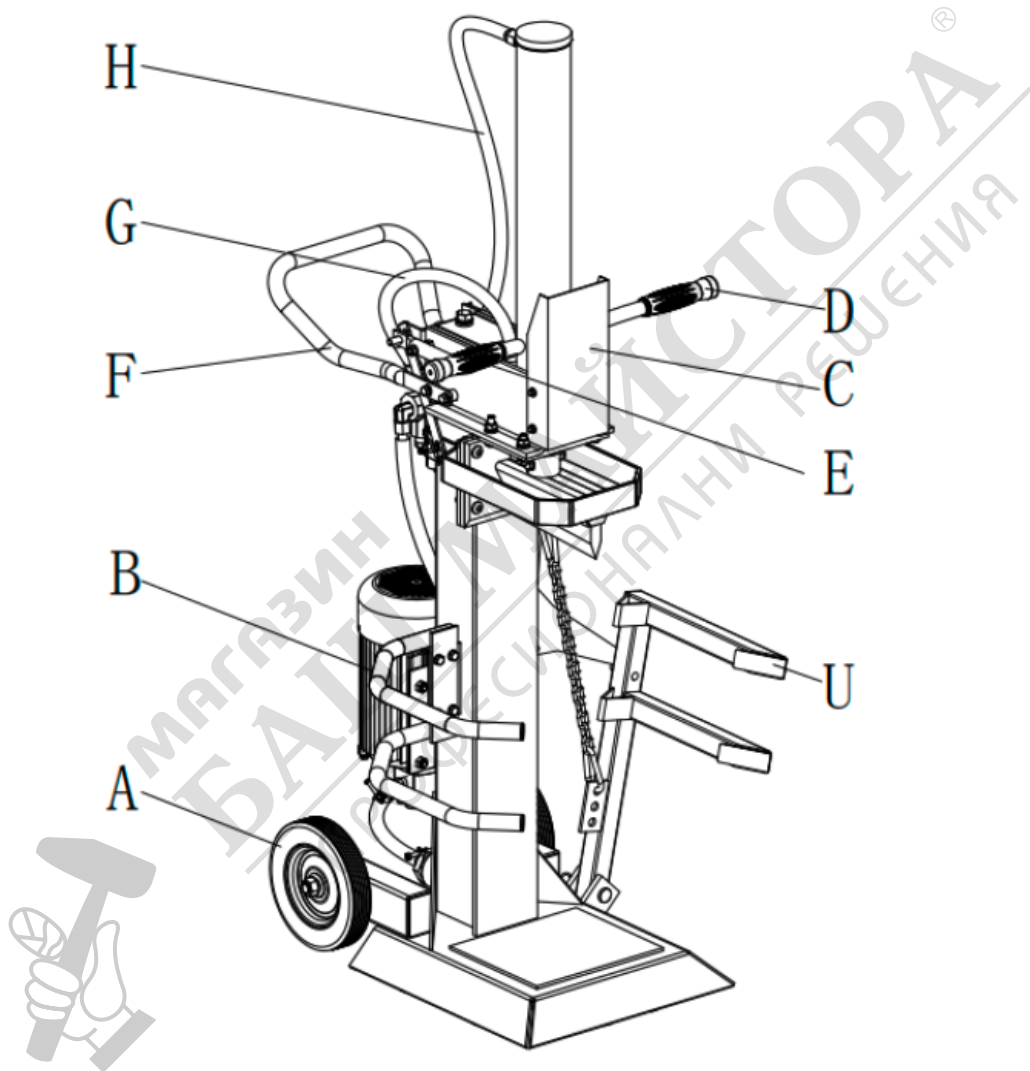

(Fig. 2)

	A	x2	B	x2	C	x1	D	x1
	E	x1	F	x1	G	x1	H	x1
	I	x4	J	x2	K	x4	L	x4
M	x8	N	x4	O	x4	P	x8	
Q	x16	R	x10	S	x4	T	x4	

A	Wheel	B	Protection Pipe	C	Protection Cover
D	Handle Connecting Plate(Right)	E	Handle Connecting Plate(Left)	F	Handle Bar
G	High Pressure Hose A	H	High Pressure Hose B	I	Washer Ø16
J	Nut M16	K	Bolt M10x35	L	Spring washer Ø10
M	Washer Ø8	N	Nut M10	O	Bolt M6x12
P	Bolt 8x20	Q	Washer 8	R	Nut M8
S	Spring Washer Ø8	T	Bolt M8x16		

## Assembly and Preparation (Fig. 4)

### Unpacking

Unpacking this log splitter requires at least two persons. To place the log splitter on the floor, proceed step by step as described below. Ensure that block (B) supports the log splitter box (A) at a point above its middle. The other end of block (B) should rest on a fixed object such as a wall. Fasten wedge (C) under the lifted box to prevent the latter from slipping off. After that, you can remove the packing carton from the log splitter.

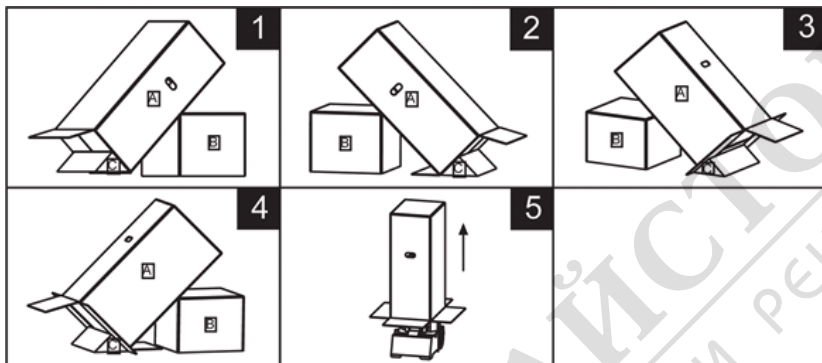

## Assembly

1. Assemble the wheel to the main body by using , Washer 16 and Nut M16 (Fig. 5).

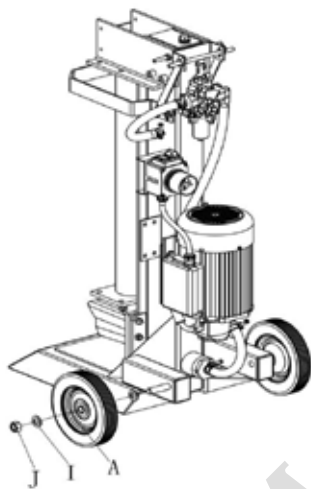

2.(1) Assemble the High Pressure Hose A.

(2) Assemble the cylinder by using Bolt M10x35, Spring Washer Ø 8, Washer Ø10, Nut M10(Fig. 6)

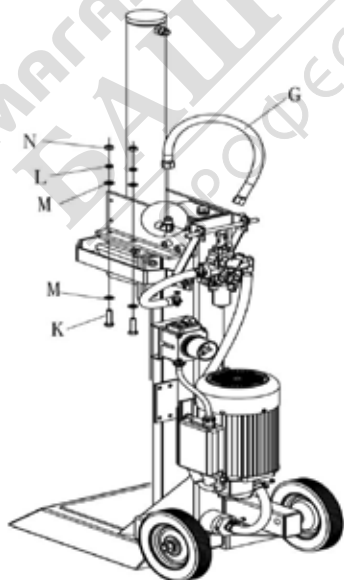

- 3.(1) Assemble the Handle Connecting Plate by using Washer 8 and Nut M8
- (2) Assemble the Protection Cover by using Bolt M6x12(Fig. 7).

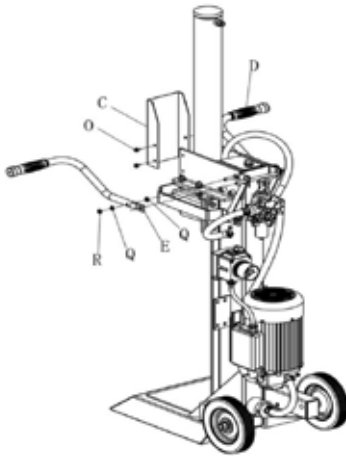

- 4.(1) Assemble the Handle Bar by using Spring Washer 8,Washer 8, Bolt M8x10.
- (2) Assemble the Protection Pipe by using Washer 8, Bolt M8x20(Fig. 8)
- (3) Attach all the hoses to the machine as the following, including High Pressure Oil B(Fig. 9)

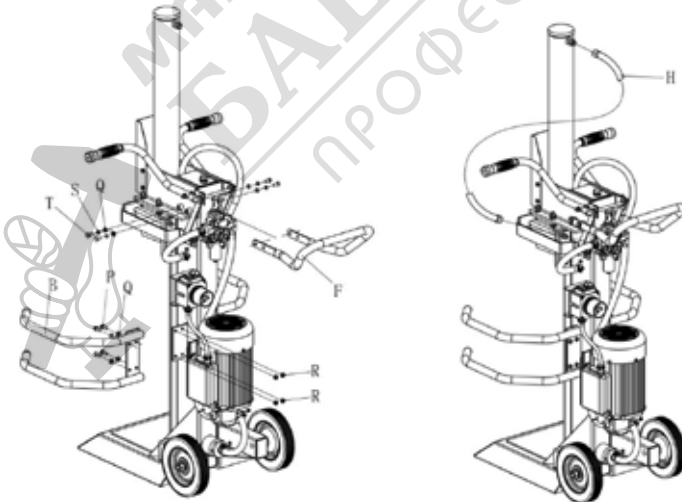

## Transporting the Log Splitter to the Working Area

For easier handling, this log splitter is provided with two wheels. To move the log splitter hold transport handle (A) with your hand and carefully tilt back the log splitter. Make sure that the oil tank cap is closed.

**NOTE:** IF YOU USE A CRANE TO HANDLE THE LOG SPLITTER USE A SUITABLE LIFTING ROPE TO SLING THE HOUSING AND HOIST THE MACHINE CAREFULLY. NEVER HANG THE CRANE HOOK INTO THE TRANSPORT HANDLE.

## Startup

Please follow the instructions given below before getting started:

**To ensure the enough Hydraulic oil filled before using the machine. Suggest fill Hydraulic oil 7.5 Liters**

**The following oil grades are suitable for this log splitter:**

USE OIL TYPE HYDRAULIC 46

**Remove the OIL TANK CAP, FILL IN ENOUGH HYDRALIC OIL AND FIX TIGHTLY BEFORE USING. (Fig. 10)**

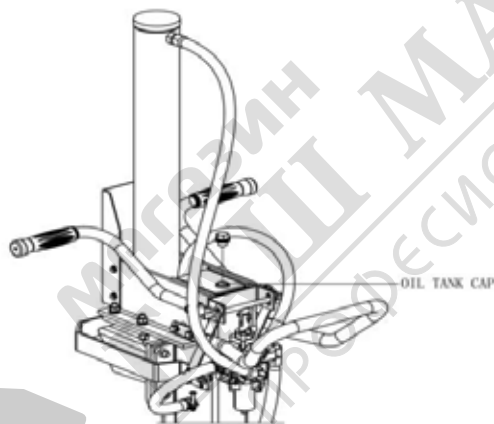

1. The machine must be placed so as to be stable and secured against skidding. Provide sufficient room around your log splitter so that you can safely operate it.
2. Ensure that no unauthorized persons (especially children) can approach your working area.
3. Prior to startup, all guards and safety devices must have been properly attached. Check whether all screws, bolts, hydraulic couplings and pipe clamps have been properly tightened. Always make sure before each starting that the hydraulic oil level is sufficient.
4. This machine must never be used when it is in an inoperable condition or needs some maintenance. Before using this log splitter, get familiar with its controls and safety elements and with how they work.
5. Make sure that the data indicated on the type label conform with your mains data before you connect your log splitter.

### Size of Logs

1. Choose your workplace in consideration of your safety regulations. Keep your logs to be split ready to hand. Remove the split logs from the working area.
2. Before you split your logs, sort out those logs which are longer than **65 cm**. If you want to split logs which are very big in diameter it is recommended that they should not exceed a maximum length of **40 cm**. Always choose the suitable height for the respective log length. Always use the locking device to secure the table at the desired position.
3. Do not run this log splitter under full load for more than 5 seconds.

NOTE: NEVER TRY TO SPLIT FRESH WOOD.

DRY WOOD IS MUCH EASIER TO SPLIT THAN FRESH, WET LOGS. IN ADDITION, IT DOES NOT TEND TO GET JAMMED DURING SPLITTING SO FREQUENTLY.



МАГАЗИН  
БАШ МАЙСТОРА  
ПРОФЕСИОНАЛНИ РЕШЕНИЯ



## Application

### IMPORTANT:

1. To ensure longer life apply some grease to the sliding surfaces of the arm whenever you intend to use this machine.
2. Always lay the power cord so that it cannot be damaged (by your working).
3. Check the running direction of the motor. When you start the motor the splitting wedge will be automatically moved to its topmost position. If the splitting wedge is already at its topmost position press the two operating levers down to activate the splitting mechanism. This will bring the splitting wedge down. If the splitting wedge does not move upward after you have started the motor immediately stop the machine. After that, use a screwdriver to change the polarity of the motor . If you have no adequate qualification to do so contact an electrician under any circumstances.

CAUTION: NEVER RUN THE MOTOR IN THE WRONG DIRECTION. THIS WILL INEVITABLY LEAD TO DAMAGE TO THE PUMPING SYSTEM, AS A RESULT OF WHICH YOU WILL NO LONGER BE ENTITLED TO CLAIM UNDER WARRANTY.

4. If you want to run this log splitter at very low temperatures run the machine idle for 15 min. before beginning to work to allow the hydraulic oil to warm up.
5. Prior to beginning your work, perform the following steps to check the functionality of your log splitter.
  - a. Press both operating levers down. This must bring the splitting wedge down.
  - b. If you release one of the two levers the splitting wedge will stop at its current position.
  - c. Pull up both levers will induce the splitting wedge to automatically return to the top.
6. Place vertically under the splitting wedge the log to be split. Make sure that the log is even and does not fall over on the splitting table. Never try to split canted logs.

IMPORTANT: ALWAYS SPLIT YOUR LOGS ALONG THE GRAIN. NEVER LOAD THE LOGS CROSSWISE TO THE GRAIN, AS THIS CAN LEAD TO SEVERE DAMAGE TO THE MECHANICAL AND HYDRAULIC SYSTEMS.

7. Hold the log with both levers to guarantee a stable standing position of the log. Then move both levers down to split the log.  
Releasing one of the two levers will induce the splitting wedge to stop. If you pull up both levers the splitting wedge will automatically move to its topmost position.
8. Immediately remove the split log parts from your working area and pile them up, if necessary. Thus you can reduce the risk of working accidents.
9. After you have finished your work, allow the splitting wedge and the arm move to their topmost positions .  
Then stop the motor and unplug the machine from your power supply source. Allow the machine to cool down. After that, you should clean and, if necessary, lubricate your machine. This log splitter may only be stored in vertical position and at a dry and clean place. Ensure that the oil tank cap is well closed and that no oil will emerge during storage.

### CAUTION:

1. Always disconnect your power supply source from your machine before you begin to release any jammed logs.
2. Do not allow any other persons to assist you in releasing a jammed log.
3. When releasing a jammed log, never stick into your log splitter any means such as foreign objects of any kind. Please do not maltreat the jammed log with your feet or with any objects either, as a sudden release of the jammed piece will cause the log pusher to give way which can lead to personal injuries or damage to your machine, respectively.
4. All safety rules contained in the "General Safety Instructions" chapter shall apply to any of the interventions described before. The manufacturer will not be liable to any injuries of persons or animals or to damage to property as a result of improper use of this machine or of non-observance of the safety regulations.

## Maintenance and Care

Maintain your log splitter carefully. Clean the machine after each use. To guarantee the best possible and safest performance keep your log splitter clean. Lubricate the machine according to the instructions. Check all seals, pipes and couplings for leakage before you start your log splitter. Keep the operating levers and the mains switch clean, dry and free of oil or grease.

### Cleaning the Log Splitter

1. Unplug the power cord.
2. Use a moist cloth to clean the plastic parts. Do not use any cleaning agents, solvents or pointed objects.
3. Use a soft brush to remove dust deposits from the motor ventilation slots and from moving parts at regular intervals.
4. Apply some oil to all moving parts at regular intervals.

### Hydraulic Oil Change

**IMPORTANT:** Take waste oil to a public receiving depot or observe the relevant disposal regulations of your country where this log splitter is used. Do not dispose of the oil into sewerage systems, into the soil or into water bodies of any kind.

The hydraulic system is a closed system consisting of an oil tank, an oil pump and of control valves. Too low an oil level can damage the pump. The oil level should not be lower than 1 – 2 cm above the lower surface of the oil tank.

Change the oil completely once per year.

1. Ensure that no foreign particles will get into the oil tank.
2. Properly dispose of the waste oil after each oil change.
3. Allow your log splitter to run idle for a few minutes after each oil change before you place it into operation again.

The following oil grades are suitable for this log splitter:

**USE OIL TYPE HYDRAULIC 46**

### Cleaning and Sharpening Sliding Surfaces

This log splitter is equipped with a specifically treated splitting wedge. After a long period of being in use, it can happen that guiding surfaces have experienced some abrasion and are getting dull. Using a suitable file, you can remove material deposits and sharpen the wedge. In the end, it is recommended that the surface you have treated be moistened with some oil or other lubricant.

### Environment, Recycling and Disposal



Packaging and products should be properly disposed of by being brought to the responsible disposal facility. Carton packaging and electric equipment can be taken to a corresponding recycling materials receiving depot or be conveniently disposed of through the manufacturer, for instance. With your cooperation, we can contribute to protect our environment by recirculating recycled materials into the production process. Please note: Do not dispose of this product into your dustbin. Synthetic parts are suitably labeled for plastics recycling.

## Specifications

Model		<b>BTA-DV8T</b>
Motor		230V/50Hz/3000 W/IP54
Splitting capacity	Diameter	40cm
	Length	65cm
Max.force		8T
Hydraulic oil volume		7.5litres
Splitting wedge stroke		192 mm
Weight		102kg

Model		<b>BTA-DV10T</b>
Motor		400V/50Hz/3000 W/IP54
Splitting capacity	Diameter	50cm
	Length	65cm
Max.force		10T
Hydraulic oil volume		7.5L
Splitting wedge stroke		192mm
Weight		110kg

Model		<b>BTA-DV12T</b>
Motor		400V/50Hz/3500 W/IP54
Splitting capacity	Diameter	50cm
	Length	65cm
Max.force		12T
Hydraulic oil volume		7.5L
Splitting wedge stroke		192mm
Weight		113kg

Model		<b>BTA-DV15T</b>
Motor		400V/50Hz/4000 W/IP54
Splitting capacity	Diameter	50cm
	Length	110cm
Max.force		15T
Hydraulic oil volume		11L
Splitting wedge stroke		192mm
Weight		183kg

Model		<b>BTA-DV18T</b>
Motor		400V/50Hz/4000 W/IP54
Splitting capacity	Diameter	50cm
	Length	110cm
Max.force		18T
Hydraulic oil volume		18L
Splitting wedge stroke		192mm
Weight		193kg

The three-phase 400 V/50 Hz motor of this log splitter should be connected to a standard 400 V + 10 %/50 Hz + 1 Hz power supply source provided with a residual-current circuit breaker. The main connection and any extension cables must have five wires = 3P + N + PE (3/N/PE). Also, the main connection must be fused (16 A max.) Electric cables must be of H 07 RN type and in conformity with EN 60245.

## Troubleshooting and Fault Clearance

Problem	Possible Cause	Remedy
1. Motor does not start.	1.1 No power in wall socket.	1.1 Check fuse box.
	1.2 Extension cable defective.	1.2 Unplug, check and use new one, if necessary.
	1.3 Wrong supply, 230 V, single-phase current.	1.3 2-pole plug with 1.5 mm diameter.
	1.4 Switch defective.	1.4 Have it checked by electrician.
2. Wrong motor direction.	2.1 Wrong polarity.	2.1 Change polarity using a screwdriver (electrician).
		2.2 Change polarity (electrician).
3. Splitter not moving although motor is running.	3.1 Valve not opened, caused by loose connection.	3.1 Tighten loose parts.
	3.2 Oil level too low.	3.2 Replenish oil.
4. Splitter working, however, with untypical noise and vibration.	4.1 Oil level too low.	4.1 Replenish oil.



МАГАЗИН  
БАШ МАЙСТОРА  
ПРОФЕСИОНАЛНИ РЕШЕНИЯ



# Machine register, tests and maintenance

Nr.	Date	Fault description	Repaires performed	Guarantee extension	L.S.
1					
2					
3					
4					
5					



Authorized service:

Italia Star Com Due S.R.L.  
 km 13.2 Bucuresti - Pitesti highway  
 Chiajna - Ilfov - Romania  
 Tel: 004 / 021.433.03.27  
 Fax: 004 / 021.433.03.26  
 info@italiastar.ro www.italiastar.ro



## Warranty Certificate

Series AA No. \_\_\_\_\_

Product name: \_\_\_\_\_

Model : \_\_\_\_\_

Series no.: \_\_\_\_\_

Accessories: \_\_\_\_\_

Seller: \_\_\_\_\_

Signature / stamp: \_\_\_\_\_

Buyer: \_\_\_\_\_

Address : \_\_\_\_\_

Date of purchase: \_\_\_\_\_

Signature / stamp: \_\_\_\_\_

DISTRIBUTOR: \_\_\_\_\_

NAME: \_\_\_\_\_

ADDRESS: \_\_\_\_\_

*I hereby confirm that I received the product in perfect condition with the utilization manual and I fully agree that this warranty certificate is valid only accompanied with the purchase invoice or receipt. If the product is not accompanied by this certificate or warranty is expired or canceled by the service due to abnormal usage conditions, the repairs will be done and charged after my consent.*



## Warranty Conditions

..... months warranty period from the date of purchase.

The service under terms of warranty has to be required to the closest Authorised Assistance Centre (you can find the list in our sales network or check it on our website [www.italiastar.ro](http://www.italiastar.ro) in the Service area) ; the buyer has to apply for warranty always showing documents about the date of purchase of the item itself.

As warranty we mean repair or substitution of those spares that have manufacturing defects.

For all the Italia Star products, the terms of warranty are one year after the date of delivery to the user.

Repairs done during the warranty period do not interrupt the period of the general warranty itself.

The warranty service include repair or substitution of all the defective parts; if the repair is done at the customer's place all the transfer to and from the assistance centre will be charged to the purchaser.

All the reparations under terms of warranty, even if done in one of our authorised assistance centres, have to be approved by Italia Star Service department in order to allow the reparations.

The warranty cannot be accepted in the following cases:

- When the repair or substitution of the parts has been done by a non-authorised Italia Star assistance service;
- When the cause of the problem is due to the use of non original Italia Star spare parts;
- When the user install on the machine non original or not indicated on the manual accessories;
- When the product has been, modified, repaired, disassembled from the buyer or from others;
- When there are modifications in the product done without Italia Star authorisation that can have influence on the correct functioning of the product;
- In case of incorrect start-up, incorrect use of the machine, incorrect use of the instruction given in the operating and maintenance manual, and not execution of the maintenance scheduled procedures;

- In case of natural disasters;
- In case of standard wear and tear;
- In case of damages caused by use of inadequate fuel and lubricant;
- In case of damages to the electrical components caused by an inadequate electrical system, in case of problems given by the electrical alimentation net, or by connections done without following the instruction of the operating and maintenance manual.

The warranty is granted within the following operating hours:

- Diesel / gasoline engines operating at 3000 rpm - 1000 hours
- Diesel engines operating at 1500 rpm - 2000 hours

\* Subject to the maintenance schedule specified in the user manual.  
\* Brushes are not covered by warranty, those are consumables.

**\*THE WARRANTY IS NOT TRANSMISSIBLE**

### Authorized Service

Name: \_\_\_\_\_

Address: \_\_\_\_\_

Phone: \_\_\_\_\_

e-mail: \_\_\_\_\_



[www.bisonte-romania.ro](http://www.bisonte-romania.ro)



**Italia Star Com Due S.R.L.**

Autostrada Bucuresti-Pitesti, km. 13/2, Loc. Chiajna, IF

☎ 004/021.433.03.27

info@italiastar.ro

[www.italiastar.ro](http://www.italiastar.ro)