



# DAEWOO

POWER PRODUCTS

## DBC SERIES

Gasoline Brush Cutters

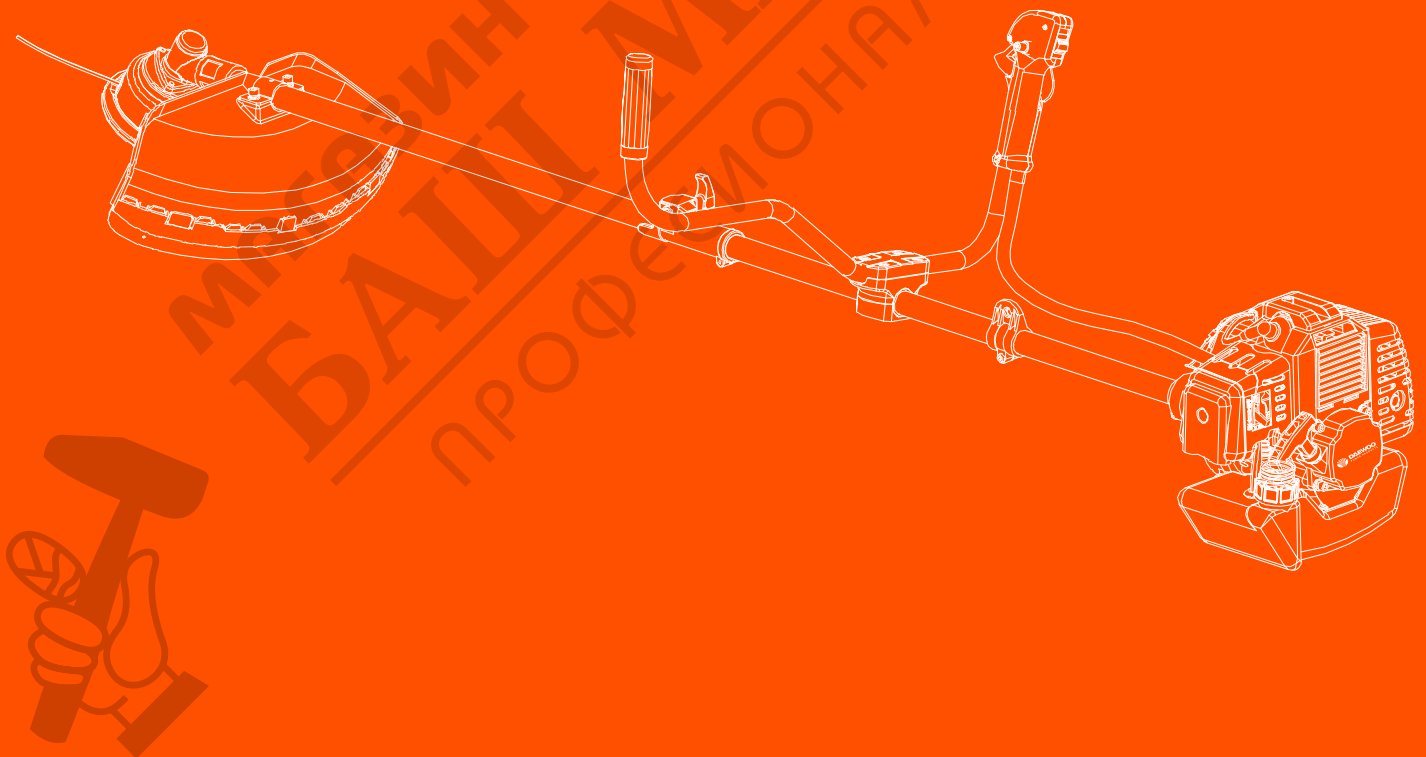

### USER'S MANUAL

[www.daewoopowerproducts.com](http://www.daewoopowerproducts.com)

Manufactured under license of Daewoo International Corporation, Korea

# INDEX

<b>1. PARTS LOCATION</b> .....	2
<b>2. WARNING LABELS ON THE MACHINE</b> .....	3
<b>3. SYMBOLS ON THE MACHINE</b> .....	3
<b>4. FOR SAFE OPERATION</b> .....	4
<b>5. SET UP</b> .....	8
<b>6. FUEL</b> .....	10
<b>7. OPERATION</b> .....	12
<b>8. MAINTENANCE</b> .....	14
<b>9. STORAGE</b> .....	17
<b>10. TROUBLESHOOTING GUIDE</b> .....	17
<b>11. SPECIFICATIONS</b> .....	18
<b>WARRANTY</b> .....	19

МАГАЗИН МАЙСТОРА  
 БАШ  
 ПРОФЕСІОНАЛНИ РЕШЕННЯ

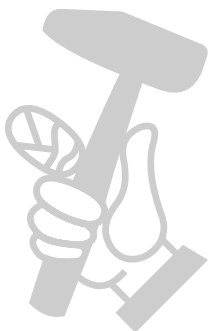

## 1. PARTS LOCATION

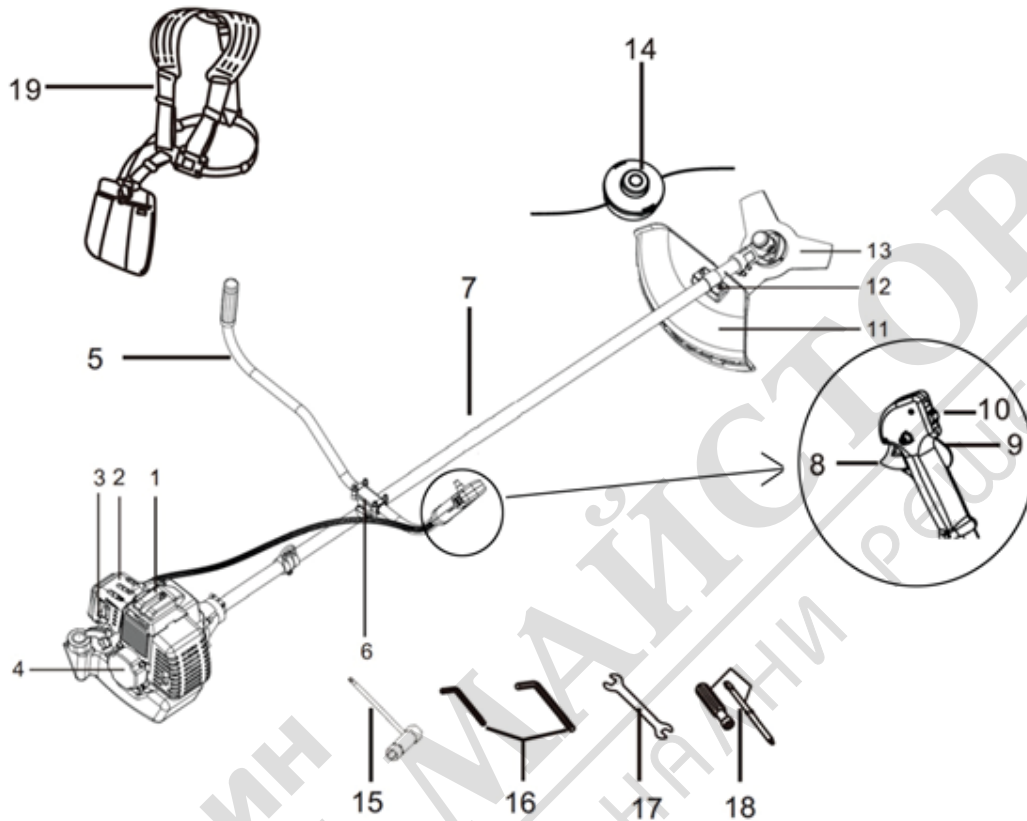

- |                           |                             |
|---------------------------|-----------------------------|
| 1. Engine                 | 11. Protection shield       |
| 2. Air cleaner cover      | 12. Protection shield plate |
| 3. Choke lever            | 13. 3T blade                |
| 4. Recoil starter         | 14. Line Head               |
| 5. Handle                 | 15. Wrench                  |
| 6. Handle bracket         | 16. Angled bar              |
| 7. Pipe                   | 17. Spanner                 |
| 8. Throttle Trigger lever | 18. Wrench                  |
| 9. Throttle lever         | 19. Harness                 |
| 10. Switch                |                             |

## 2. WARNING LABELS ON THE MACHINE

- (1) Read owner's manual before operating machine.
- (2) Wear head, eye and ear protection.
- (3) Wear foot protection.
- (4) Wear gloves.
- (5) Beware of thrown objects.
- (6) Warning / Attention
- (7) Keep all children, bystanders and helpers 15 meters away from the brush cutter

### IMPORTANT

If warning label peel off or become soiled and impossible to read, you should contact the dealer from which you purchased the product to order new labels and affix them in the required location(s).

### WARNING

Never modify your brush cutter. We won't warrant the machine, if you use the remodeled brush cutter or you don't observe the proper usage written in the manual.



## 3. SYMBOLS ON THE MACHINE

For safe operation and maintenance, symbols are carved in relief on the machine. According to these indications, please be careful not to make a mistake.

- (a) The port to refuel the "MIX GASOLINE"  
Position: FUEL TANK CAP

- (b) The direction A to close the choke  
The direction B to open the choke  
Position: AIR CLEANER COVER

- (c) This unit is fitted with only flexible line cutter.  
Never use cutting blade made of metal or plastic.  
Position: DEBRIS GUARD

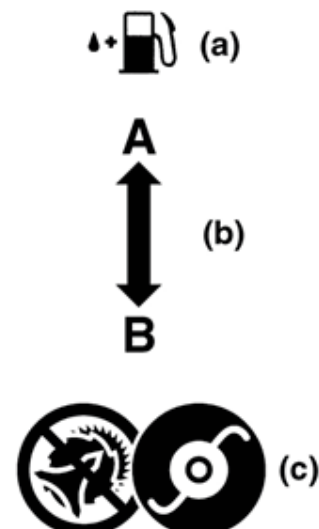

#### 4. FOR SAFE OPERATION

1. Read this manual carefully until you completely understand and follow all safety and operating instructions.



2. Keep this manual handy so that you may refer to it later whenever any questions arise. Also note, if you have any questions which cannot be answered herein, contact the dealer from whom you purchased the product.

3. Always be sure to include this manual when selling, lending, or otherwise transferring the ownership of this product.



4. Never allow children or anyone unable to fully understand the directions given in the manual to use the machine.

#### - WORKING CONDITION

1. When using the product, you should wear proper clothing and protective equipment.

- (1) Helmet
- (2) Ear protectors
- (3) Protection goggles or face protector
- (4) Thick work gloves
- (5) Non-slip-sole work boots



2. And you should carry with you.

- (1) Attached tools and files
- (2) Properly reserved fuel
- (3) Spare blade
- (4) Things to notify your working area (rope, warning signs)
- (5) Whistle (for collaboration or emergency)
- (6) Hatchet or saw (for removal of obstacles)



3. Do not wear loose clothing, jewelry, short trousers, sandals, or go barefoot. Do not wear anything which might be caught by a moving part of the unit. Secure hair so it is above shoulder length.



## - WORKING CIRCUMSTANCE

1. Never start the engine inside a closed room or building. Exhaust gases contain dangerous carbon monoxide.
2. Never use the product,
  - a. when the ground is slippery or when you can't maintain a steady posture.
  - b. At night, at times of heavy fog, or at any other times when your field of vision might be limited and it would be difficult to gain a clear view of the working area.
  - c. During rain storms, during lightning storms, at times of strong or gale-force winds, or at any other times when weather conditions might make it unsafe to use the product.



## - WORKING PLAN

1. You should never use the product when under the influence of alcohol, when suffering from exhaustion or lack of sleep, when suffering from drowsiness as a result of having taken cold medicine or at any other time when a possibility exists that your judgment might be impaired or that you might not be able to operate the product properly and in a safe manner.
2. When planning your work schedule, allow plenty of time to rest. Limit the amount of time over which the product is to be used continuously to somewhere around 30~40 minutes per session, and take 10~20 minutes of rest between work sessions. Also try to keep the total amount of work performed in a single day under 2 hours or less.



## WARNING

1. If you don't observe the working time, or working manner (See USING THE PRODUCT), Repetitive Stress Injury (RSI) could occur. If you feel discomfort, redness and swelling of your fingers or any other part of your body, see a doctor before getting worse.



2. To avoid noise complaints, in general, operate product between 8a.m. and 5p.m. on weekdays and 9a.m. to 5p.m. weekends.

## NOTE

Check and follow the local regulations as to sound level and hours of operations for the product.



## - BEFORE STARTING THE ENGINE

1. The area within a perimeter of 50 feet (15m) of the person using the product should be considered a hazardous area into which no one should enter. If necessary, yellow warning rope, warning signs should be placed around the perimeter of the area. When work is to be performed simultaneously by two or more persons, care should also be taken to constantly look around or otherwise check for the presence and locations of other people working so as to maintain a distance between each person sufficient to ensure safety.

2. Check the condition of working area to avoid any accident by hitting hidden obstacles such as stumps, stones, cans, or broken glass.

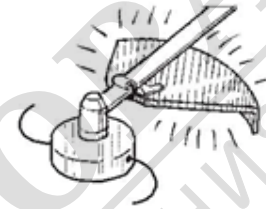
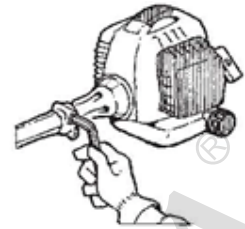

### IMPORTANT

Remove any obstacle before beginning work.

3. Inspect the entire unit for loose fasteners and fuel leakage. Make sure that the cutting attachment is properly installed and securely fastened.

4. Be sure the debris guard is firmly attached in place.

5. If the cutting head is the metal blade, use the shoulder strap. Adjust the strap for comfort before starting the engine. The strap should be adjusted so the left hand can comfortably hold the handlebar grip approximately waist high.

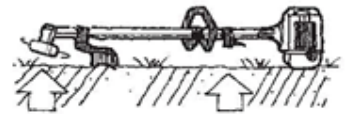

## - STARTING THE ENGINE

1. Keep bystanders and animals at least 50feet (15m) away from the operating point. If you are approached, immediately stop the engine.

2. The product is equipped with a centrifugal clutch mechanism, so the cutting attachment begins to rotate as soon as the engine is started by putting the throttle into the start position. When starting the engine, place the product onto the ground in a flat clear area and hold it firmly in place so as to ensure that neither the cutting part nor the throttle come into contact with any obstacle when the engine starts.



### WARNING

Never place the throttle into the high speed position when starting the engine.

3. After starting the engine, check to make sure that the cutting attachment stops rotating when the throttle is moved fully back to its original position.

If it continues to rotate even after the throttle has been moved fully back, turn off the engine and take the unit to your authorized servicing dealer for repair.

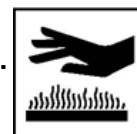

## - USING THE PRODUCT

### IMPORTANT

Cut only materials recommended by the manufacturer. And use only for tasks explained in the manual.

1. Grip the handles firmly with both hands using your whole hand. Place your feet slightly apart (slightly further apart than the width of your shoulders) so that your weight is distributed evenly across both legs, and always be sure to maintain a steady, even posture while working.
2. Keep cutting attachment below waist level.
3. Maintain the speed of the engine at the level required to perform cutting work, and never raise the speed of the engine above the level necessary.
4. If the unit start to shake or vibrate, turn off the engine and check the whole unit. Do not use it until the trouble has been properly corrected.
5. Keep all parts of your body away from rotating cutting attachment and hot surfaces.
6. Never touch the muffler, spark plug, or other metallic parts of the engine while the engine is in operation or immediately after shutting down the engine. Doing so could result in serious burns or electrical shock.

### • IF SOMEONE COMES

1. Guard against hazardous situations at all times. Warn adults to keep pets and children away from the area. Be careful if you are approached. Injury may result from flying debris.
2. If someone calls out or otherwise interrupts you while working, always be sure to turn off the engine before turning around.



## - MAINTENANCE

1. In order to maintain your product in proper working order, perform the maintenance and checking operations described in the manual at regular intervals.
2. Always be sure to turn off the engine before performing any maintenance or checking procedures.

### WARNING

The metallic parts reach high temperatures immediately after stopping the engine.

3. Under no circumstances should you ever take apart the product or alter it in any way. Doing so might result in the product becoming damaged during operation or the product becoming unable to operate properly.

## - HANDLING FUEL

1. The engine of the product is designed to run on a mixed fuel which contains highly flammable gasoline. Never store cans of fuel or refill the tank of the unit in any place where there is a boiler, stove, wood fire, electrical sparks, welding sparks, or any other source of heat or fire which might ignite the fuel.

2. Never smoke while operating the unit or refilling its fuel tank.

3. When refilling the tank, always turn off the engine and allow it to cool down. Take a careful look around to make sure that there are no sparks or open flames anywhere nearby before refueling.

4. Wipe spilled fuel completely using a dry rag if any fuel spillage occurs during refueling.

5. After refueling, screw the fuel cap back tightly onto the fuel tank and then carry the unit to a spot 10feet (3m) or more away from where it was refueled before turning on the engine.

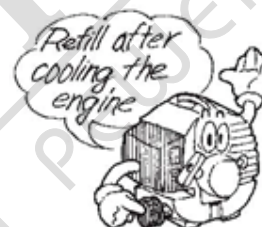

## - TRANSPORTATION

1. When hand-carrying the product, cover over the cutting part if necessary, lift up the product and carry it paying attention to the blade.

2. Never transport the product over rough roads over long distances by vehicle without removing all fuel from the fuel tank. If doing so, fuel might leak from the tank during transport.

## 5. SET UP

### - INSTALLING HANDLE (01)

1. Loosen the 4bolts on the upper cap and insert the handles equally. Retighten the bolts.

2. Put the handle assembly into the bracket and put the upper cap over it. Tighten the cap securely.

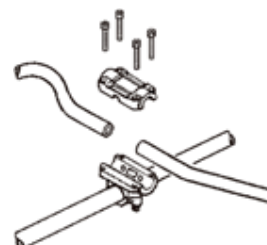

### - CONNECTING THROTTLE WIRE (02, 03)

1. Remove the air cleaner cover.

2. Connect the end of the throttle wire to the joint on the top of the carburetor.



### - CONNECTING SWITCH WIRES

Connect the switch wires between the engine and the main unit. Pair the wires of the same color.

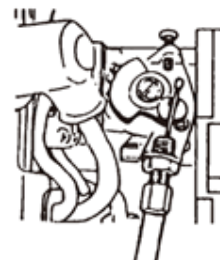

- INSTALLING PROTECTION SHIELD (04)

Attach the protection shield with the bolts combined to the shaft tube.

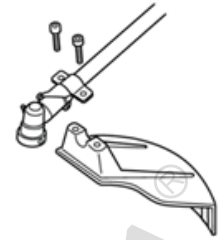

- INSTALLING CUTTING BLADE (05)

1. Put the angled bar (1) into the side holes of the gear case (2) and the plate (3) so as to fasten the axle.
2. Mount the blade (4) and the washer (5) onto the axle.
3. Mount the washer (6) and the nut (7). Fasten tightly anti-clockwise.

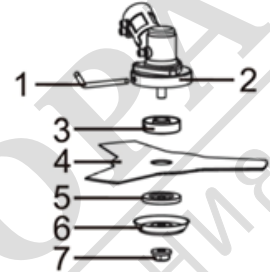

- INSTALLING CUTTING HEAD (06)

1. Put the angled bar (1) into the side holes of the gear case (2) and the plate (3) so as to fasten the axle.
2. Mount the trimmer head (8) on the axle. Fasten tightly anti-clockwise.

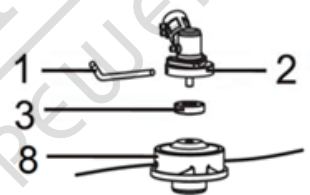

- HARNESS

**WARNING**

- ALWAYS WEAR THE PROVIDED HARNESS WHEN USING THE MACHINE!
- Always make sure the machine is hooked securely to the harness.
- If you don't, you will be unable to control the machine safely. This can result in injury to yourself or others.
- Never use a harness with a defective quick release or any other damage.



**HOW TO WEAR**

1. Wear the provided harness without twisted bands, with the hanger on your right side.



(1) Hanger



**BALANCE THE UNIT**

1. Hook your machine to the hanger.
2. Adjust the bands of the harness to have the blade parallel to the ground when standing in your normal working position to provide you most effectiveness and comfort on operating the machine.
3. In order to prevent the hanger position to change during operation, turn up the extra part of the band from the buckle.
4. When correctly adjusted, check the correct working of the harnesses' QUICK RELEASE.



## 6. FUEL

### WARNING

- Gasoline is very flammable. Avoid smoking or bringing any flame or sparks near fuel.
- Wipe up all spills before starting the engine.
- Make sure to stop the engine and allow it cool before refueling the unit.
- Keep open flames away from the area where fuel is handled or stored.



### IMPORTANT

- Never use oil for 4 cycle engine use or water cooled 2-cycle engine.
- Never use "FUEL WITH NO OIL (RAW GASOLINE)".
- Never use fuel laced with water.
- Mixed fuels which have been left unused for a period of one month or more may clog the carburetor or result in the engine failing to operate properly. Put remained fuel into an air-tight container and keep it in the dark and cool room.
- Please ask for "mixed gasoline for air-cooled 2-cycle engines" at your nearest gas station, or use fuel made by putting unleaded gasoline for automobiles and air-cooled 2-cycle engine oil into a mixing container in accordance with the following ratios and then shaking to mix well.



### Mixing ratios:

When using commercially available 2-cycle oil (FB grade): 25:1  
(160 ml of oil for every 4 liters of gasoline)

### - STARTING ENGINE

#### WARNING

The cutting head will start rotating upon the engine starts.

1. Feed fuel into the fuel tank and tighten the cap securely.
2. Rest the unit on a flat, firm place. Keep the cutting head off the ground and clear of surrounding objects as it will start rotating upon starting of the engine.
3. Push the primer pump several times until overflowed fuel flows out in the return tube. (OP1)
3. Move the choke lever to the closed position. (OP2)

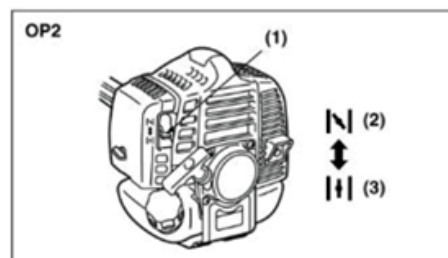
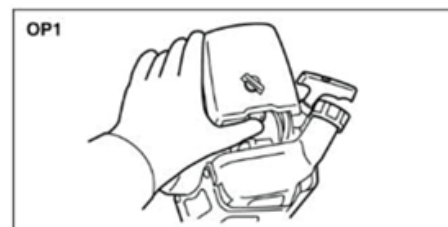

(1) Choke lever (2) Closed position (3) Open position

4. Set the ignition switch to the “start” position. While pulling the throttle lever, push the throttle set button, and release the throttle, then the throttle lever is into the “Start position. (OP3)

(A) Stop position (B) Start position

5. While holding the unit firmly, pull out the starter rope quickly until engine fires. (OP4)

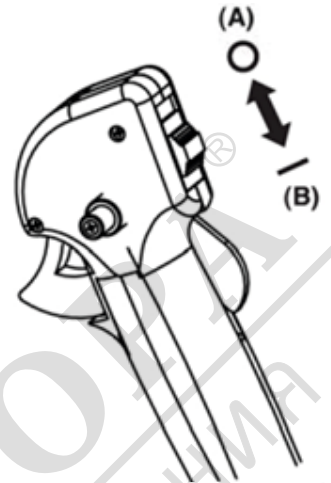

**IMPORTANT**

- Avoid pulling the rope to its end or returning it by releasing the knob. Such actions can cause starter failures.

6. Move the choke lever to the open position (OP2). And pull out the starter rope quickly to restart engine. (OP4)

7. Allow the engine to warm up for several minutes before starting operation.



**NOTE**

1. When restarting the engine immediately after stopping it, leave the choke open (OP2) and push the primer pump several times (OP4).

2. Overchoking can make the engine hard to start due to excess fuel. When the engine failed to start after several attempts, open the choke and repeat pulling the rope, or remove the spark plug and dry it.

**- STOPPING ENGINE**

1. Release the throttle lever and run the engine for a half minute.
2. Shift the ignition switch to the STOP position. (OP3)

**NOTE**

- Except for an emergency, avoid stopping the engine while pulling the throttle lever.

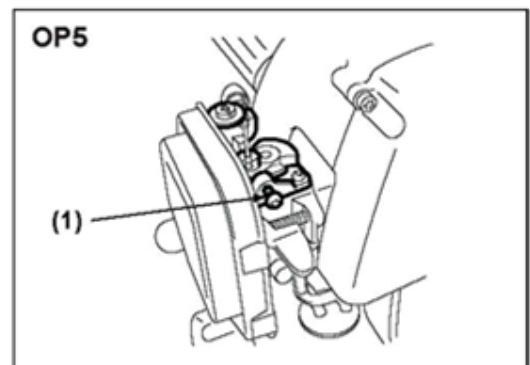

**- ADJUSTING IDLING SPEED (OP5)**

1. When the engine tends stop frequently at idling mode, turn the adjusting screw clockwise.
2. When the cutting head keeps rotating after releasing the trigger, turn the adjusting screw

(1) Idle speed adjuster

**NOTE**

- Warm up the engine before adjusting the idling speed.

## - LINE HEAD USAGE

### WARNING

1. Always wear eye protection such as safety goggles. Never lean over the rotating cutting head. Rocks or other debris could be thrown into eyes and face and cause serious personal injury.
2. Keep the debris guard attached in place at all times when the unit is operated.



### TRIMMING GRASS AND WEEDS

- Always remember that the TIP of the line does cutting. You will achieve better results by not crowding the line into the cutting area. Allow the unit to trim at its own pace.
1. Hold the unit so the head is off the ground and is tilted about 20 degrees toward the sweep direction. (OP6)
  2. You can avoid thrown debris by sweeping from your right to the left.
  3. Use a slow, deliberate action to cut heavy growth. The rate of cutting motion will depend on the material being cut. Heavy growth will require slower action than will light growth.
  4. Never swing the unit so hard as you are in danger of losing your balance or control of the unit.
  5. Try to control the cutting motion with the hip rather than placing the full workload on the arm and hands.
  6. Take precautions to avoid wire, grass and dead, dry, long-stem weeds from wrapping around the head shaft. Such materials can stall the head and cause the clutch to slip, resulting in damage to the clutch system if repeated frequently.

## 7. OPERATION

### ADJUSTING THE LINE LENGTH

- Your brush cutters is equipped with a semi- auto type nylon line head that allows the operator to advance the line without stopping the engine. When the line becomes short, lightly tap the head on the ground while running the engine at full throttle.
- Each time the head is bumped, the line advance about 1 inch (25.4 mm). For better effect, tap the head on bear ground or hard soil. Avoid bumping in thick, tall grass as the engine may stall by overload.

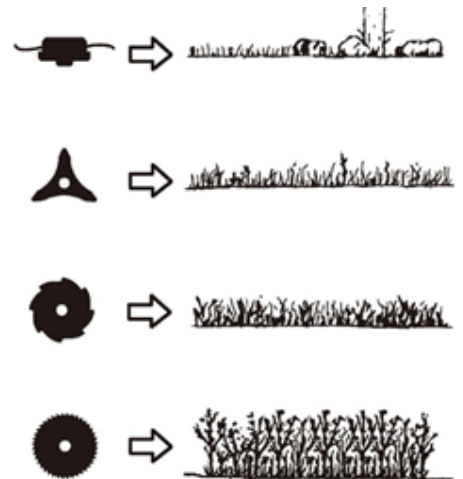

## METAL BLADE USAGE

### CUTTING METHOD

Choose a suitable recommended cutting attachment according to the object to be cut.

#### WARNING

- When sharpening, removing, or reattaching the blade, be sure to wear thick, sturdy gloves and use only proper tools and equipment to prevent injury.

1. Check the bolt to fasten the blade and be sure the bolt has no fault, and no abrasion.

2. Be sure that the blade and the holder have been fastened according to instruction and the blade turns smoothly without abnormal noise.

#### WARNING

- The rotating parts fastened incorrectly may cause serious accident to the operator.
- Make sure that the blade is not bent, warped, cracked, broken or damaged.
- If you find any error to the blade, discard it and change new one.

- By using the harness, hang the unit on your right side. Adjust the harness length so that the cutting head may become parallel to the ground.

#### WARNING

- Make sure to use harness and cutting attachment guard. If not, it is very dangerous when you slip or lose your balance.

### CUTTING METHOD

(a) Use the front left side cutting.

(b) Guide the blade from your right to left with it tilted slightly to your left.

(c) When mowing a wide area, start working from your left end to avoid interference of cut grass.

(d) The blade may be seized by weeds if the engine speed is too low, or the blade cuts too deep into weeds. Adjust the engine speed and cutting depth according to the condition of object.

#### WARNING

- If the grass or other object gets caught in the blade, or if the unit starts to shake or vibrate, turn off the engine and check the whole unit. Change the blade if it has been damaged.

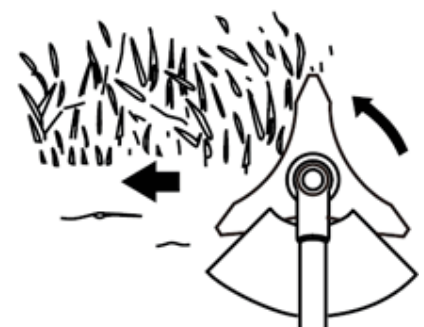

- Turn off the engine and make sure the blade has completely stopped before checking the blade, and removing any object got caught in.

#### CONTROLLING BLADE BOUNCE

- Kick out can cause serious personal injury. Carefully study this section. It is important that you understand what causes kick out, how you can reduce the chance of kick out and how you can remain in control of the unit if kick out does occur.

### 8. MAINTENANCE

Maintenance, replacement, or repair of the emission control device and systems may be performed by any non-road engine repair establishment or individual.

#### WARNING

- Always be sure to stop the engine before inspecting the brush cutter for problems or performing maintenance.
- Never alter the brush cutter or take the engine apart.

	System/components	Procedure	Before use	Every 25 hours after	Every 50 hours after	Every 100 hours after	Note
ENGINE	fuel leaks, fuel spillage	wipe out	✓				
	fuel tank, air filter, fuel filter	inspect/clean	✓	✓			replace, if necessary
	idle speed adjuster	see adjusting idling speed	✓				replace carburetor if necessary
	spark plug	clean and readjust plug gap			✓		GAP: .025 in (0.6 ~ 0.7 mm) replace, if necessary
	intake air cooling vent	clean		✓			
SHAFT	throttle trigger, stop switch	check operation	✓				
	cutting parts	replace if something's wrong	✓				
	angle transmission	grease		✓			
	screws/nuts/bolts	tighten/replace	✓			✓	except adjusting screws
	cutting attachment guard	make sure to attach	✓				

#### - REFILLING TRIMMING LINE

1. For replacement line, use a diameter of 2.4mm (.095in). The spool is capable for a line up to 6m (20ft) on the 10cm (4") head. Avoid using a larger line as it may cut down the trimming performance.
2. Pinch the slotted area on the both sides of the spool housing to unhook the bottom cap.
3. Take out the spool and pull off the old line. Put one end of new line through the spool holes and pull it until the length is equal between each part of the line.
4. Wind up the line in the correct direction as indicated on the spool.
5. Hook each end of the line in the slot on the edge of the spool, and then put the ends through the eyelets on the housing. Make sure that the spring and the washers are in place.
6. While holding the spool against the housing, pull the line ends to release them from the slot.
7. Line up the slot on the bottom cap with the hook on the housing, press the cap against the housing until it clicks.

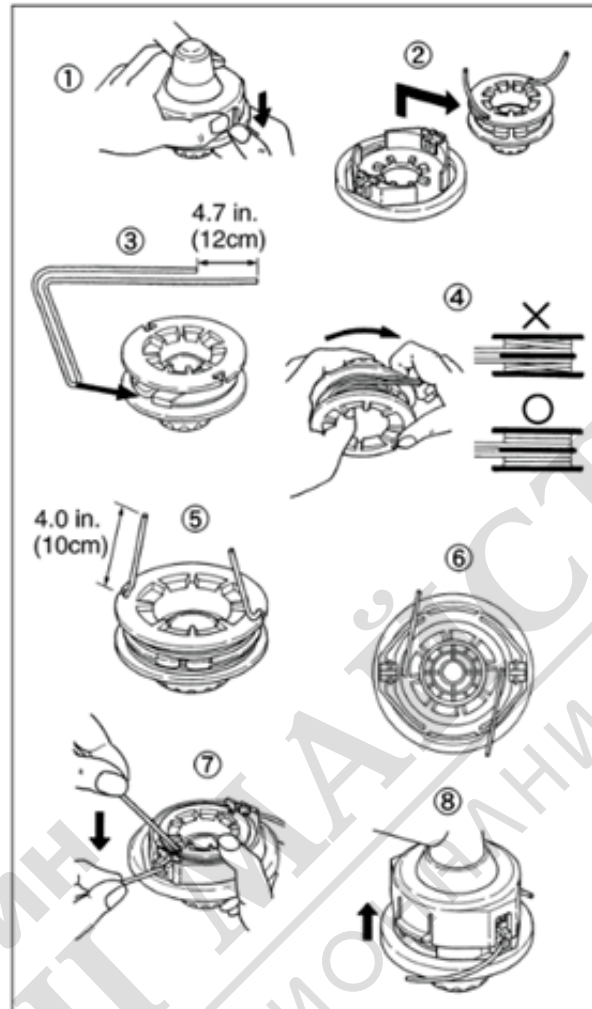

**- AIR FILTER**

- The air filter, if clogged, will reduce the engine performance. Monthly check and clean the filter element in warm, soapy water as required. Dry completely before installing. If the element is broken or shrunk, replace with a new one.

(1) Air filter

**- FUEL FILTER**

- When the engine runs short of fuel supply, check the fuel cap and the fuel filter for blockage.

(1) Fuel filter

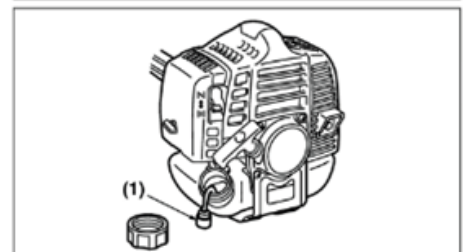
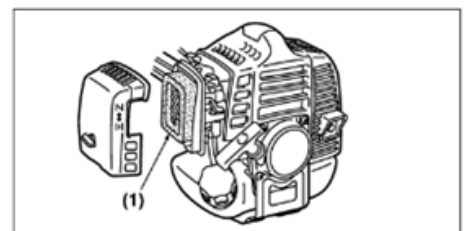

### SPARK PLUG

- Starting failure and mis-firing are often caused by a fouled spark plug. Periodically clean the spark plug and check that the spark gap is in the correct range.
- When you take off the spark plug, twist (1) and pull off the cap (2).

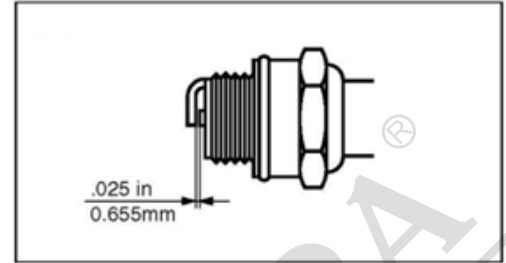

### IMPORTANT

- Note that using any spark plugs other than those designated may result in the engine failing to operate properly or in the engine becoming overheated and damaged.
- To install the spark plug, first turn the plug until it is finger tight, then tighten it a quarter turn more with a socket wrench.

TIGHTENING TORQUE: 9.8~11.8 N.m

### - MUFFLER

#### WARNING

- Inspect periodically, the muffler for loose fasteners, any damage or corrosion. If any sign of exhaust leakage is found, do not use the brush cutter and have it repaired immediately.
- Note that failing to do so may result in the engine catching on fire.

### - INTAKE AIR COOLING VENT

#### WARNING

- Never touch the cylinder, muffler, or spark plugs with your bare hands immediately after stopping the engine. The engine can become very hot when in operation, and doing so could result in severe burns.
- When checking the brush cutter to make sure that it is okay before using it, check the area around the muffler and remove any wood chips or leaves which have attached themselves to the brush cutter. Note that failing to do so could cause the muffler to become overheated, and that this in turn could cause the brush cutter to catch on fire. Always make sure that the muffler is clean and free of wood chips, leaves, and other waste before use.
- Check the intake air cooling vent and the area around the cylinder cooling fins after every 25 hours of use for blockage, and remove any waste which has attached itself to the brush cutter. Note that it is necessary to remove the plug guard shown in Figure in order to be able to view the upper part of the cylinder.

### IMPORTANT

- If waste gets stuck and causes blockage around the intake air cooling vent or between the cylinder fins, it may cause the engine to overheat, and that in turn may cause mechanical failure on the part of the brush cutter. (MA6)

(1) Cylinder fin

(2) Intake air cooling vent (back)

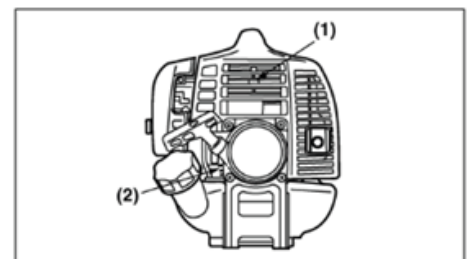

**- PROCEDURES TO BE PERFORMED AFTER EVERY 10 HOURS OF USE**

1. Remove the muffler, insert a screwdriver into the vent, and wipe away any carbon buildup. Wipe away any carbon buildup on the muffler exhaust vent at the same time.
2. Tighten all screws, bolts, and fittings.
3. Check to see if any oil or grease has worked its way in between the clutch lining and drum, and if it has wiped it away using oil-free, lead-free gasoline.

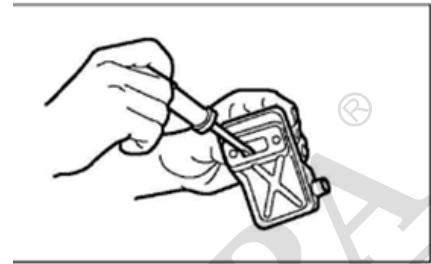

**9. STORAGE**

- Aged fuel is one of major causes of engine starting failure. Before storing the unit, empty the fuel tank and run the engine until it uses all the fuel left in the fuel line and the carburetor. Store the unit indoor taking necessary measures for rust prevention.

**10. TROUBLESHOOTING GUIDE**

**Case 1. Starting failure**

CHECK	PROBABLE CAUSES	ACTION
fuel tank	incorrect fuel	drain it and with correct fuel
fuel filter	fuel filter is clogged	clean
carburetor adjustment screw	out of normal range	adjust to normal range
sparkling (no spark)	spark plug is fouled/wet	clean/dry
	plug gap is incorrect	correct (GAP: 0.6~0.7mm)
spark plug	disconnected	retighten

**Case 2. Engine starts but does not keep running/Hard re-starting.**

CHECK	PROBABLE CAUSES	ACTION
fuel tank	incorrect fuel or staled fuel	drain it and with correct fuel
carburetor adjustment screw	out of normal range	adjust to normal range
muffler,cylinder (exhaust port)	carbon is built-up	wipe away
air cleaner	clogged with dust	wash
cylinder fin, fan cover	clogged with dust	clean

When your unit seems to need further service, please consult with service shop in your area.

## 11. SPECIFICATIONS

MODEL	DBC260	DBC330	DBC430	DBC520	DTR300
Engine	Single cylinder, 2 stroke, air cooled				
Displacement	26 cc	30.5 cc (CE) / 33 cc (not CE)	42.7 cc (CE) / 43 cc (not CE)	52 cc	26 cc
Fuel tank capacity	600 ml	850 ml	1200 ml	1200 ml	600 ml
Noise level	113 dB				
Rated speed	7500 rpm				
Max speed	9000 rpm				
Max power	0.7 kW	0.9 kW	1.2 kW	2.2 kW	0.7 kW
Start	Manual				
Mixture (oil:gasoline)	1:25				
Cutting head	400-450 mm				
Cutting blade	3 T				N/A
Cutting width	255 mm for cutting blade 400-450 for cutting head				400-450 for cutting head
Gross weight	7 kg	8 kg	8.5 kg	8.7 kg	7.0 kg
Net weight	6 kg	7 kg	7.5 kg	7.7 kg	6.0 kg

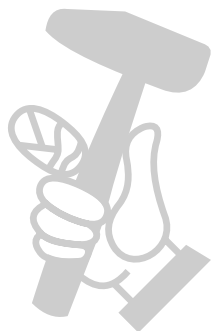



**DAEWOO**

POWER PRODUCTS



МАГАЗИН МАЙСТОРА®  
БАШ ПРОФЕССИОНАЛЬНЫЕ РЕШЕНИЯ

[www.daewoopowerproducts.com](http://www.daewoopowerproducts.com)

Manufactured under license of Daewoo International Corporation, Korea