

RTD 18 LTX BL 30

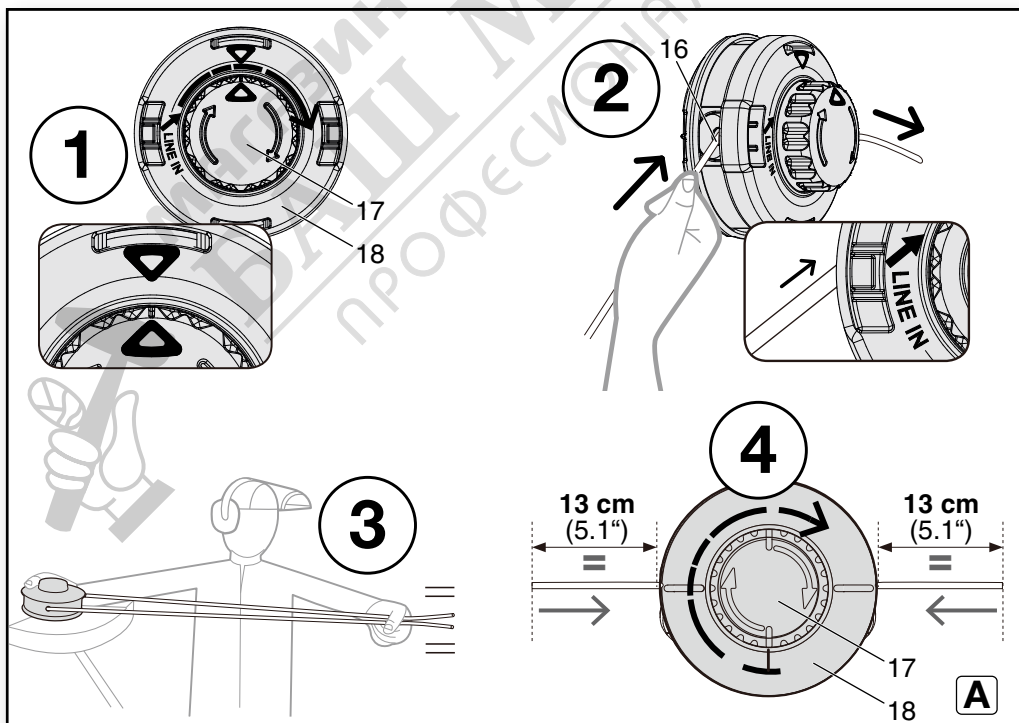

de	Originalbetriebsanleitung	5	no	Original bruksanvisning	73
en	Original instructions	13	da	Original bruksanvisning	80
fr	Notice originale	20	pl	Instrukcja oryginalna	87
nl	Oorspronkelijke gebruiksaanwijzing	28	el	Πρωτότυπο οδηγιών χρήσης	95
it	Istruzioni originali	36	hu	Eredeti használati utasítás	103
es	Manual original	43	ru	Оригинальное руководство по эксплуатации	110
pt	Manual original	51	uk	Оригінальна інструкція з експлуатації	119
sv	Bruksanvisning i original	59			
fi	Alkuperäiset ohjeet	66			

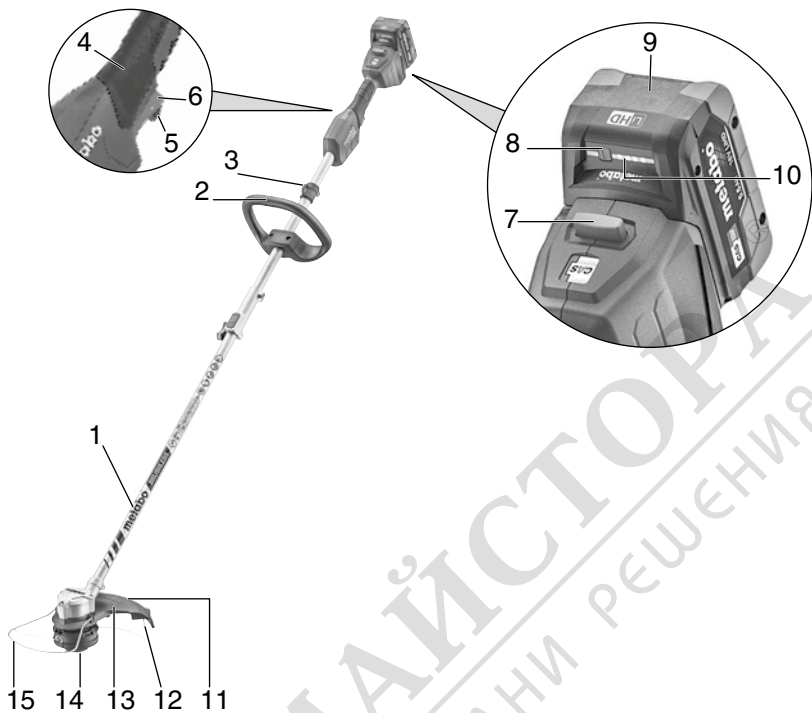

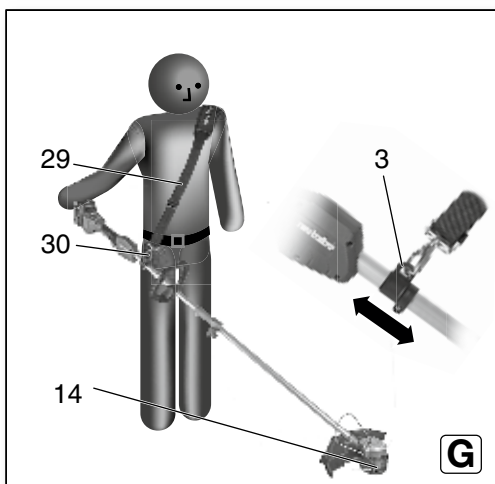
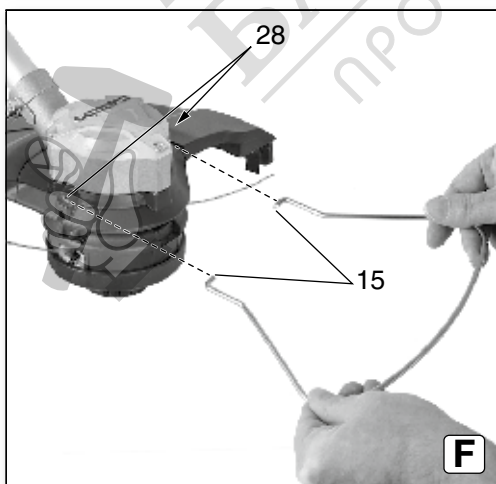
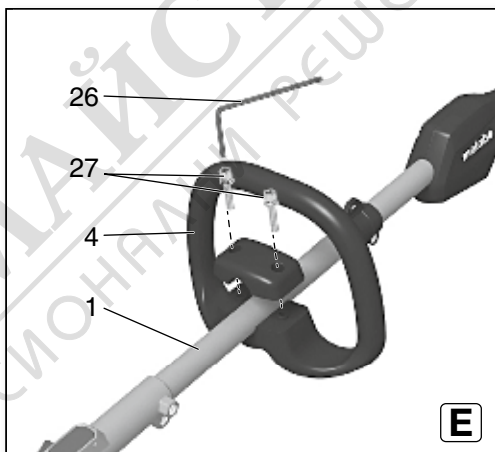
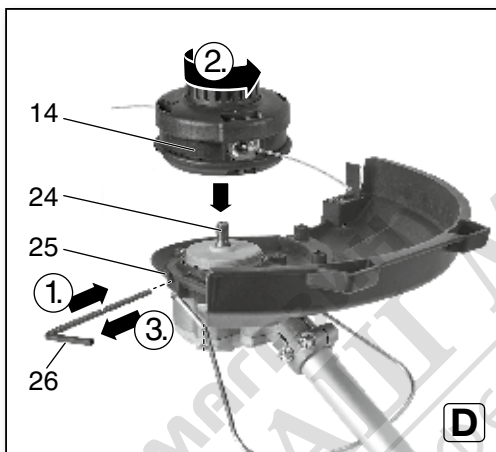
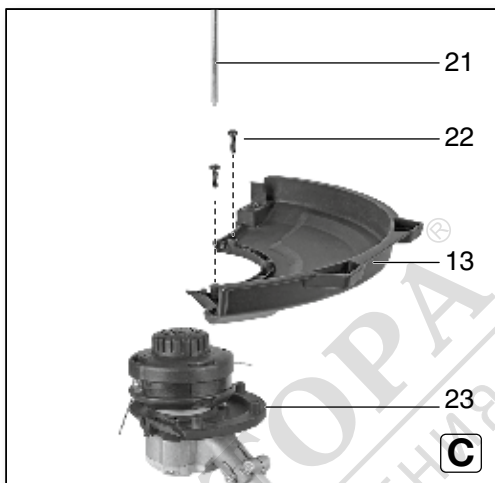
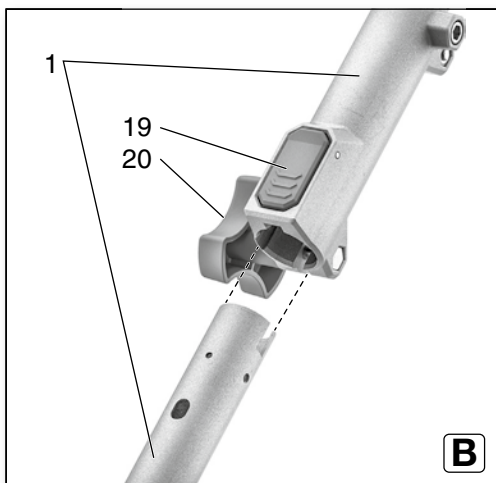



RTD 18 LTX BL 30

*1) Serial Number		01720..
U	V	18
B	cm (in)	30 (11 13/16)
H	m (in)	4 (157 1/2)
H_X	mm (in)	2 (0.0625)
n₀	/min (rpm)	6500
m	kg (lbs)	3,8 (8.4)
a_n/K_n	m/s²	3,5 / 1,5
L_{pA}/K_{pA}	dB(A)	76 / 3
L_{WA}/K_{WA}	dB(A)	87 / 1,7
L_{WA(G)} *5)	dB(A)	93



*2) 2014/30/EU, 2006/42/EC, 2011/65/EU, 2000/14/EC

*3) EN 62841-1:2015, FprEN IEC 62841-4-4:2020, EN IEC 63000:2018

*4) Intertek Deutschland GmbH, Stangenstraße 1, D-70771 Leinfelden-Echterdingen, Germany, NB 0905

2021-05-19, Bernd Fleischmann

Direktor Produktentstehung & Qualität (Vice President Product Engineering & Quality)

*6) Metabowerke GmbH - Metabo-Allee 1 - 72622 Nuertingen, Germany

Original instructions

1. Declaration of Conformity

We declare and accept sole responsibility for ensuring: these cordless lawn trimmers identified by their type and serial number *1) conform to all relevant provisions of the directives *2) and standards *3). Technical documentation at *6).

2000/14/EC: Conformity assessment procedures in accordance with Annex VI
Named body *4), Guaranteed sound power level LWA(G) *5),
- see page 4.

For UK only:

We as manufacturer and authorized person to compile the technical file, see *6) on page 4, hereby declare under sole responsibility that this cordless lawn trimmer, identified by type and serial number *1) on page 4, fulfil all relevant provisions of following UK Regulations S.I. 2016/1091, S.I. 2008/1597, S.I. 2012/3032, S.I. 2001/1701 and Designated Standards *3)

S.I. 2001/1701: Conformity assessment procedures in accordance with Schedule 9.
Approved Body: Intertek Testing & Certification Ltd.
Academy Place, 1-9 Brook Street, Brentwood, Essex, CM14 5NQ, UK, Body-No: 0395
Guaranteed sound power level LWA(G) *5) on page 4.

2. Specified Conditions of Use

The cordless lawn trimmer is intended exclusively for use with the line head for mowing and trimming work.

The cordless lawn trimmer must not be used for cutting and trimming of hedges, bushes and other vegetation, where the cutting level is not parallel to the surface of the underground.

Use only the recommended thread heads and protective equipment! The use of other tools (e.g. brush cutter, grass blade, multi-piece metal cutting tools with swivel chains and flail blades or circular saw blades) can cause serious injuries.

The cordless lawn trimmer may rest on the ground when working.

The user bears sole responsibility for any damage caused by inappropriate use.

Generally accepted accident prevention regulations and the safety instructions must be observed.

3. General Safety Information



For your own protection and for the protection of your power tool, pay attention to all parts of the text that are marked with this symbol!



WARNING – Read the operating instructions to reduce the risk of injury.



WARNING – Read all safety warnings, instructions, illustrations and specifications provided with this power tool. Failure to follow all instructions listed below may result in electric shock, fire and/or serious injury.

Keep all safety instructions and information for future reference.

Always include these documents when passing on your power tool.

Residual risks: Even when the device is used as intended, there could be residual risks. Observe all safety warnings and instructions.

Possible hazards:

- Injuries and material damage caused by flying parts.
- Lung damage if no suitable dust mask is worn.
- Hearing damage if no suitable hearing protection is worn.
- Health detriment, due to vibration emissions, if the machine is used over a long period of time or if it not properly guided or maintained.

4. Special safety instructions

4.1 Lawn trimmer safety warnings

- a) **Do not use the machine in bad weather conditions, especially when there is a risk of lightning.** This decreases the risk of being struck by lightning.
- b) **Thoroughly inspect the area for wildlife where the machine is to be used.** Wildlife may be injured by the machine during operation.
- c) **Thoroughly inspect the area where the machine is to be used and remove all stones, sticks, wires, bones, and other foreign objects.** Thrown objects can cause personal injury.
- d) **Before using the machine, always visually inspect to see that the cutter and the cutter assembly are not damaged.** Damaged parts increase the risk of injury.
- e) **Keep guards in place. Guards must be in working order and be properly mounted.** A guard that is loose, damaged, or is not functioning correctly may result in personal injury.
- f) **Keep all cooling air inlets clear of debris.** Blocked air inlets and debris may result in overheating or risk of fire.
- g) **Wear eye protection and ear protection.** Adequate protective equipment will reduce personal injury.
- h) **While operating the machine, always wear non-slip and protective footwear. Do not operate the machine when barefoot or wearing open sandals.** This reduces the chance of injury to the feet from contact with the moving cutter.
- i) **Always wear clothing such as trousers that covers the operator's legs while operating the**

machine. Contact with the moving cutter or line may cause injury.

j) **Keep bystanders away while operating the machine.** Thrown debris can result in serious personal injury.

k) **Do not operate the machine above waist height.** This helps prevent unintended cutter contact and enables better control of the machine in unexpected situations.

l) **Exercise caution when operating the machine in wet grass. Walk, never run.** This reduces the risk of slipping and falling which may result in personal injury.

m) **Do not operate the machine on excessively steep slopes.** This reduces the risk of loss of control, slipping and falling which may result in personal injury.

n) **When working on slopes, always be sure of your footing, always work across the face of slopes, never up or down and exercise extreme caution when changing direction.** This reduces the risk of loss of control, slipping and falling which may result in personal injury.

o) **Keep all power cords and cables away from cutting area.** Power cords or cables may be hidden in hedges or bushes and can be accidentally cut or damaged by the line or cutter.

p) **Keep all parts of the body away from the moving trimmer cutter or line. Do not clear material from the machine until it has been disconnected from the power source.** The moving trimmer cutter or line may result in serious personal injury.

q) **Carry the machine with the machine switched off and away from your body.** Proper handling of the machine will reduce the likelihood of accidental contact with a moving trimmer cutter or line.

r) **Only use replacement cutting heads and trimmer cutters or lines specified by the manufacturer. Do not replace the trimmer cutters or lines with metal wires or blades.** Incorrect replacement parts may cause loss of control, breakage and injury.

4.2 Introduction

- Carefully read the operating instructions. Familiarise yourself with the controls and the proper use of the machine.
- Do not allow children, persons with reduced physical, sensory or mental abilities or lack of experience and/or knowledge, or persons not familiar with these instructions to use this machine. Local regulations may limit the age of the operator.
- Children should be supervised to ensure that they do not play with the tool.
- Do not operate the machine if persons, especially children, or pets are nearby.
- The user is responsible for injuries or material damage to other persons or their property.
- Do not modify the device.

- National regulations may restrict the use of the machine.

4.3 Preparation

- Do not wear loose-fitting clothing or clothing with dangling strings or ribbons. Always wear face protection and protective goggles. Wear protective gloves.
- Never replace the non-metalling cutting line with a metallic cutting line. Use only genuine accessories.
- Practice all work techniques. Inexperienced persons are strongly advised to seek competent advice and guidance from an experienced person before operating this machine.

4.4 Operation

- **Do not operate the machine in rain or wet conditions.** Water entering the machine may increase the risk of electric shock or malfunction that could result in personal injury.
- Use the machine only in daylight or good artificial light.
- Keep the ventilation openings free from foreign bodies.
- Do not use a power tool while you are tired or under the influence of drugs, alcohol or medication. A moment of inattention while operating power tools may result in serious personal injury.
- Always use the supplied carry strap/shoulder strap.
- Avoid adverse body positions. Keep proper footing and balance at all times, especially when working on sloped ground.
- Ensure stable footing. If you lose your balance, immediately let go of the switch (6).
- Make sure you have the correct working position, take breaks and change working position.
- Do not mow near steep slopes, ditches or embankments.
- Watch out for holes, furrows, rocks and other hidden objects that can cause you to fall. Remove all obstacles such as stones and branches
- Always guide the line head close to the ground.
- Never operate the machine with damaged protective equipment or without protective equipment (e.g. guard, handle).
- Carefully start up the motor according to the instructions and with your feet far away from the cutting thread.
- Danger from parts moving hazardously. Do not touch moving parts. Before any contact, all parts must have come to a complete standstill and the battery pack must have been removed.
- Switch off the motor and remove battery pack. Ensure that all moving parts have come to a standstill:
 - if you leave the machine unattended;
 - before clearing any blockages;
 - before checking or cleaning the machine or before carrying out any work on the machine;

- if a foreign object has been hit or if the machine has been dropped. Check the machine for damage and have repairs carried out before putting the machine back into operation.
- when the machine starts to vibrate excessively.
- If the machine starts to vibrate with unusual strength, an immediate check is required:
 - check for damage;
 - replace or repair damaged parts;
 - ensure that all nuts, bolts and screws are tightened.
- In the event of an accident or malfunction, switch off the machine immediately and remove the battery pack.
- **Avoid accidental operation. Make sure that the machine is switched off before connecting the battery and before picking up or carrying the lamp.** Carrying the machine with your finger on the switch or energising machines that have the switch on invites accidents.
- Remove the battery pack from the tool...
 - ...before making any adjustments, changing tools, maintenance or cleaning.
 - ...if the operator moves away from the tool.
 - ...prior to the removal of blockages.
 - ...after touching a foreign body in order to check the tool for damage.
 - ...for immediate checking, when the machine starts to vibrate excessively.

4.5 Maintenance and storage

- Maintain power tools and accessories. Many accidents are caused by poorly maintained power tools.
- All nuts, bolts and screws must always be tightened to ensure that the machine is in safe operating condition.
- Remove the battery pack from the machine, wait until all moving parts have come to a standstill before making any adjustments, retrofitting, maintenance, cleaning or before storing the machine.
- Replace worn or damaged parts for safety reasons. Use only original spare parts and accessories.

4.6 Use and handling cordless tools

- **Only recharge with the charger specified by the manufacturer.** A charger that is suitable for one type of battery pack may create a risk of fire when used with another battery pack.
- **Use power tools only with specifically designated battery packs.** Use of any other battery packs may create a risk of injury and fire.
- **When not in use, keep batteries away from paper clips, coins, keys, nails, screws or other small metal objects that could bridge the contacts.** Shorting the battery terminals together may cause burns or a fire.
- **Under abusive conditions, liquid may be ejected from the battery. Avoid contact. If contact accidentally occurs, flush with water. If liquid contacts eyes, additionally seek medical help.** Liquid ejected from the battery may cause irritation or burns.
- **Do not use a battery pack or tool that is damaged or modified.** Damaged or modified batteries may exhibit unpredictable behaviour resulting in fire, explosion or risk of injury.
- **Do not expose a battery pack or tool to fire or excessive temperature.** Exposure to fire or temperature above 130 °C (265 °F) may cause explosion.
- **Follow all charging instructions and do not charge the battery pack or tool outside the temperature range specified in the instructions.** Charging improperly or at temperatures outside the specified range may damage the battery and increase the risk of fire.



Protect battery packs from water and moisture!

Do not expose battery packs to fire!

- Do not use faulty or deformed battery packs!
- Do not open battery packs!
- Do not touch or short circuit battery pack contacts!



A slightly acidic, flammable fluid may leak from defective Li-ion battery packs!



If battery fluid leaks out and comes into contact with your skin, rinse immediately with plenty of water. If battery fluid leaks out and comes into contact with your eyes, wash them with clean water and seek medical attention immediately!

- If the machine is defective, remove the battery pack from the machine.

Transport of li-ion battery packs:

- The shipping of li-ion battery packs is subject to laws related to the carriage of hazardous goods (UN 3480 and UN 3481). Inform yourself of the currently valid specifications when shipping li-ion battery packs. If necessary, consult your freight forwarder. Certified packaging is available from Metabo.
- Only send the battery pack if the housing is intact and no fluid is leaking. Remove the battery pack from the machine for sending. Prevent the contacts from short-circuiting (e.g. by protecting them with adhesive tape).

4.7 Icons



WARNING – General hazards!



Read the operating instructions.



Ensure that nobody gets injured by catapulted foreign bodies. Keep other people away.



Keep persons nearby and pets at a safe distance to the device.



Keep other people away. Maintain a distance of at least 15 m from persons and objects.

^



Protect the device from water and moisture. Do not expose to rain.



Wear safety goggles.



Wear ear protectors. High noise levels over a prolonged period of time may affect your hearing.



Wear head protection if there is the risk of falling parts.



Wear non-slip foot protection.



Do not use metal blades and metal saw blades.



Wear gloves.

5. Overview

See pages 2 and 3.

- 1 Rod (two-piece)
- 2 Handle
- 3 Suspension point
- 4 Handle
- 5 Switch lock
- 6 Switch (switching on/off, setting speed)
- 7 Battery pack release button
- 8 Capacity indicator button *
- 9 Battery pack *
- 10 Capacity and signal indicator *
- 11 Arrows show the direction of line head
- 12 Line cutter (WARNING! Danger of injury from the sharp edges of the blade)
- 13 Safety guard
- 14 Line head
- 15 Plant guard
- 16 Thread (cutting line)
- 17 Cap (of the line head)
- 18 Base body (of the line head)
- 19 Unlock button
- 20 Wing nut
- 21 Screwdriver
- 22 Screws (to fix the safety guard)
- 23 Flange (guard)
- 24 Drive shaft
- 25 Drilled hole (to lock the drive shaft)
- 26 Allen key
- 27 Screws of the handle
- 28 Holes (to fix the plant guard)
- 29 Shoulder strap
- 30 Carabiner hook

*equipment-specific

6. Initial Operation



WARNING! Switch off the machine and remove (9) battery pack. Unintentional startup can cause serious injuries. The machine must be stationary.



WARNING! Danger of injury from sharp cutting edge on the line cutter (12). Wear protective gloves.

6.1 Assembling/disassembling rod (1) (fig. B)

Assembling:

1. Push the rod ends into each other so that the release button (19) engages.
2. Tighten the wing screw (20).

Disassembling (for transport / storage):

1. Release the wing (20) screw.
2. Press the release button (19) and pull apart the rod ends at the same time.

6.2 Attaching the guard (13) (fig. C)



WARNING! Danger of injury from sharp cutting edge on the line cutter (12). Wear protective gloves.

1. Place the safety guard (13) onto the flange (23).
2. Insert the screws (22) with screwdriver (21) and firmly tighten them.

6.3 Attaching / removing the line head (14) (fig. D)

Fitting

1. Locking the drive shaft (24):
 - Insert the supplied Allen key (26) into the drilled hole (25).
 - Turn the drive shaft (24) by hand until the Allen key (26) can be pushed in and the drive shaft cannot be turned anymore.
2. As shown, screw on the line head (14) in anti-clockwise direction and tighten by hand.
3. Release the drive shaft:
 - Pull out the Allen key (26).

Removal

Proceed in the same way as for the attachment, however unscrew the line head in clockwise direction.

6.4 Insert cutting line (16) in line head (14) (fig. A)

1. Hold tight the base body (18). Turn the cap (17) in clockwise direction until the triangular marks are opposite each other (and/or the continuous groove on the side of the print head is aligned with the triangle of the line head's cap).
2. Bend the end of the line straight (so that it can be inserted more easily). Push the line end (16) into the opening marked with an arrow and the words "LINE IN. NOTE: See fig. A: Push in exactly in the direction of the arrow (slightly slanted)!"

Result: The line end emerges from the opposite opening.

3. Pull out the shorter line until both lines are of equal length.
4. Hold tight the base body (18). Turn the cap (17) in clockwise direction: The line is wound up in the base body. Stop when 13 cm (5.1") of line still protrudes on both sides. (A line that is too long is automatically cut off by the line cutter (12)).

6.5 Attach the handle (fig. E):

1. Choose the right position, see chapter 7.1.
2. Attach the handle (2) as shown to the rod (1) and firmly tighten the screws (27) with supplied Allen key (26).

6.6 Fitting / setting the plant guard (15) (fig. F)

Attaching:

Pull the ends of the plant guard (15) apart a little and insert them into the drilled holes (28) on the housing.

Setting

Fold the plant guard (15), as required, upwards or downwards.

6.7 Battery pack

Charge the battery pack before use.

Recharge the battery pack if performance diminishes.

Instructions on charging the battery pack can be found in the operating instructions of the Metabo charger.

In case of Li-Ion battery packs with capacity and signal display (10) (equipment-specific):

- Press the button (8); the LEDs indicate the charge (10) level.
- The battery pack is almost flat and must be recharged if one LED is flashing.

Inserting and removing the battery pack

 **WARNING!** Before removing or inserting the battery pack: Switch off the machine and wait until the motor is at a standstill.

Insertion: Slide in the battery packs (9) until they engage.

Removal: Press the battery pack release button (7) and pull out the battery packs (9).

7. Use

 **WARNING!** Wear protective goggles during operation. Always wear only one shoulder strap. Do not carry any other tools while carrying the machine.

7.1 Setting the machine for the user (fig. G)

1. Tighten the shoulder strap (29). Adjust the length in such a way that the carabiner hook (30) is about a hand width below the hip.
2. Hook in carabiner hook from the suspension point (3).

3. Balance the machine:

- Loosen the screw of the suspension point (3).
 - Move the suspension point in such a way that the line head (14) rests slightly on the ground when balanced.
 - Tighten again the screw of the suspension point
4. Attach the handle in a comfortable position. See chapter 6.5.

Note: To remove the shoulder strap, unhook the carabiner hook from the suspension point (3).

7.2 Start the machine, modify the speed

1. Firmly hold the machine with the right hand on the handle (4) and with the left hand on the handle (2).
2. Press and keep pressed the switch lock (5).
3. Press the switch (6) to start up. The speed can be changed by depressing the switch.

7.3 Stopping the machine

Release the switch (6). Hold the machine by the handles with both hands and wait until the machine has come to a complete standstill.

7.4 Mowing

Always guide the line head (14) close to the ground. Move the line head (14) evenly back and forth. Walk forward slowly and carefully.

7.5 Readjust the cutting line

With the machine **running**, briefly tap the line head (14) onto the ground: About 3 cm of line is readjusted. A line that is too long is automatically cut off by the line cutter (12).

If the lines break off directly at the line head or are too short, they must be pulled out by hand:

-  **WARNING!** Remove battery pack (9). Unintentional startup can cause serious injuries. The machine must be stationary.
- Switch off the machine, allow the motor to come to a standstill, remove battery pack (9).
- Press and keep pressed the cap (17).
- Pull out lines by hand.
- If the cutting line is used up: see chapter 6.4.

8. Cleaning, transporting, storage

 **WARNING!** Remove battery pack (9). Unintentional startup can cause serious injuries. The machine must be stationary.

 **WARNING!** Danger of injury from sharp cutting edge on the line cutter (12). Wear protective gloves.

8.1 Cleaning

- Clean after each use: Remove grass clippings, leaves, dirt and other deposits.

8.2 Transporting, storage

- Clean and maintain the machine before storage.
- Always keep the cutting line moist. A dry cutting line breaks off more quickly and wears out faster.

E.g. remove the cutting line from the reel and store in a bowl of water.

- Make sure that the machine does not have any loose or damaged parts.
If necessary:
 - Replace damaged parts.
 - Tighten the screws.
 - If necessary, have them repaired in a specialist workshop.
- Store the machine in a dry place.
- Ensure that children cannot get anywhere near the machine.
- For space-saving transport or storage, the rod can (1) can be disassembled into two parts. See chapter 6.1.
- Secure in a safe position for transport.

9. Maintenance

 **WARNING!** Remove battery pack (9). Unintentional startup can cause serious injuries. The machine must be stationary.

 **WARNING!** Danger of injury from sharp cutting edge on the line cutter (12). Wear protective gloves.

9.1 General maintenance

- Check the machine for damaged, missing or loose parts such as screws, nuts, bolts and caps before each use.
- Check the machine before each use for damage and ageing and have it repaired in a specialist workshop immediately if necessary.
- Tighten all fasteners and caps properly.
- Clean the machine with a dry cloth. Do not use water.
- **Never service damaged battery packs.** Service of battery packs should only be performed by the manufacturer or authorized service providers.

9.2 Replacing cutting line

See chapter 6.4.
Order number see chapter 11.

9.3 Lubrication

Lubrication is not required.

10. Troubleshooting Guide

One LED of the capacity display (10) flashes.

Battery pack empty.
- Charge battery pack.

Machine emits a lot of noise.

Cutting line is too short.
- Readjust cutting line (see chapter 7.5)

All LEDs of the capacity and signal display (10) flash.

Overload.
- Let the machine cool down.
- Move forward more slowly.

The machine does not start.

The battery pack performance is weak.
- Charge battery pack.

The machine vibrates heavily.

The cutting line (16) is not the same length on both side.
- Readjust the cutting line. See chapter (7.5).

The machine stops during the mowing process.

Battery pack empty.
- Charge battery pack.

There is a blockage.
- Remove battery pack (9). Check the line head (14).

The operating temperature of the machine is too high.
- Let the machine cool down.

11. Accessories

Use only original Metabo or CAS (Cordless Alliance System) battery packs and accessories.

Use only accessories that fulfil the requirements and specifications listed in these operating instructions.

- A Cutting line Ø 2 mm, spiral-shaped (as spare)
Order no.: 628423000
- B Cutting line Ø 2 mm, wave-shaped
Order no.: 628430000
- C Complete line head (complete housing incl. reel and cutting line, (as spare)
Order no.: 628429000
- D Shoulder strap (as spare)
Order no.: 628427000
- E Back carry strap
Order no.: 628428000
- F Battery packs with different capacities. Buy battery packs only with voltage suitable for your power tool.

Order no.:	625367000	4.0 Ah (LiHD)
Order no.:	625368000	5.5 Ah (LiHD)
Order no.:	625369000	8.0 Ah (LiHD)
Order no.:	625549000	10.0 Ah (LiHD)
etc.		
Order no.:	625027000	4.0 Ah (Li-Ion)
Order no.:	625028000	5.2 Ah (Li-Ion)
etc.		
- G Chargers: ASC 55, ASC 145, etc.

For a complete range of accessories, see www.metabo.com or the catalogue.

12. Repairs

 Repairs to electrical tools must only be carried out by qualified electricians and only with original spare parts!

Contact your local Metabo representative if you have Metabo power tools requiring repairs. For addresses see www.metabo.com.

You can download a list of spare parts from www.metabo.com.

13. Environmental Protection

Observe national regulations on environmentally compatible disposal and on the recycling of disused machines, packaging and accessories.

Packaging materials must be disposed of according to their labelling in accordance with municipal guidelines. Further information can be found at www.metabo.com in the "Service" section.

Battery packs may not be disposed of with regular waste. Return faulty or used battery packs to your Metabo dealer!

Do not allow battery packs to come into contact with water!

 Only for EU countries: never dispose of power tools in your household waste!
According to European Directive 2012/19/EU on Waste from Electric and Electronic Equipment and implementation in national law, used power tools must be collected separately and recycled in an environmentally-friendly manner.
Discharge the battery pack in the power tool before disposal. Prevent the contacts from short-circuiting (e.g. by protecting them with adhesive tape).

14. Technical Specifications

Explanatory notes regarding the specifications on page 4.

Changes due to technological progress reserved.

U = voltage
B = cutting width
H = max. cutting line length
H_X = cutting line diameter
n₀ = No-load speed
m = weight (with the smallest battery pack)

Measured values determined in conformity with EN 62841-4-4; 2000/14/EC.

Permitted ambient temperature during operation: -20 °C to 50 °C (limited performance with temperatures below 0 °C). Permitted ambient temperature for storage: 0 °C to 30 °C

Recommended ambient temperature when charging: 0 °C to 40 °C

== direct current

The technical specifications quoted are subject to tolerances (in compliance with relevant valid standards).

Emission values

These values make it possible to assess the emissions from the power tool and to compare different power tools. The actual load may be higher or lower depending on operating conditions, the condition of the power tool or the accessories used. Please allow for breaks and periods when the load is lower for assessment purposes. Arrange protective measures for the user, such as organisational measures based on the adjusted estimates.

Vibration total value (vector sum of three directions):

a_h = vibration emission value

K_h = uncertainty (vibration)

Typical A-weighted sound levels:

L_{pA} = sound-pressure level

L_{WA} = Acoustic power level

K_{pA}, K_{WA} = Uncertainty

L_{WA(G)} = Guaranteed acoustic power level as per 2000/14/EC



 **Wear ear protectors!**