

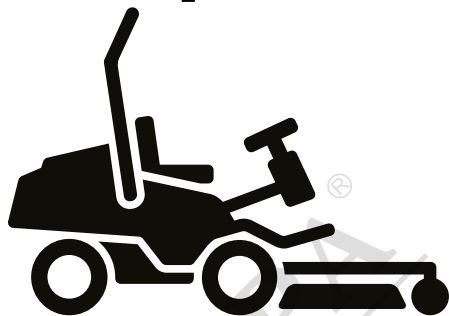

# Husqvarna®



## P 520DX, P 525DX, P 525DX Cabin

EN  
ES  
IT  
PT

Operator's manual  
Manual de usuario  
Manuale dell'operatore  
Manual do utilizador

2-67  
68-135  
136-203  
204-270



МАГАЗИН МАЙСТРОМ  
ПРОФЕСИОНАЛНИ РЕШЕНИЯ

---

## Contents

---

Introduction.....	2	Transportation, storage and disposal.....	55
Safety.....	10	Technical data.....	58
Assembly.....	15	Accessories.....	65
Operation.....	20	Service.....	65
Maintenance.....	27	Warranty.....	65
Troubleshooting.....	51	Declaration of Conformity.....	66

---

## Introduction

---

### Pre-delivery inspection and product numbers

---

**Note:** A pre-delivery inspection has been done of this product. Make sure that you receive a signed copy of the pre-delivery inspection document from your dealer.

---

Service agent contact information:	
This operator's manual belongs to product with product number / serial number:	
	/
Engine:	
Transmission:	

### Product description

The P 520DX and P 525DX are front mowers. The power source is a diesel engine. Forward and reverse pedals let the operator adjust the speed gradually. The products have all-wheel drive (AWD) and are used with Combi cutting decks with Bioclip®. The P 525DX Cabin is a P 525DX with a cabin.

### Intended use

The product is made to cut grass in commercial areas. Attach an optional accessory to use the product for other tasks. Speak to your Husqvarna dealer for more information about which accessories that are available.

### Insure your product

Make sure that you have insurance coverage for your new product. Speak to your insurance company if you are not sure. We recommend a fully comprehensive insurance that includes third party, fire, damage, theft and liability.

### Firmware

Make sure that the latest software versions are installed on the product. Speak to your Husqvarna servicing dealer.

## Product overview (P 520DX, P 525DX)

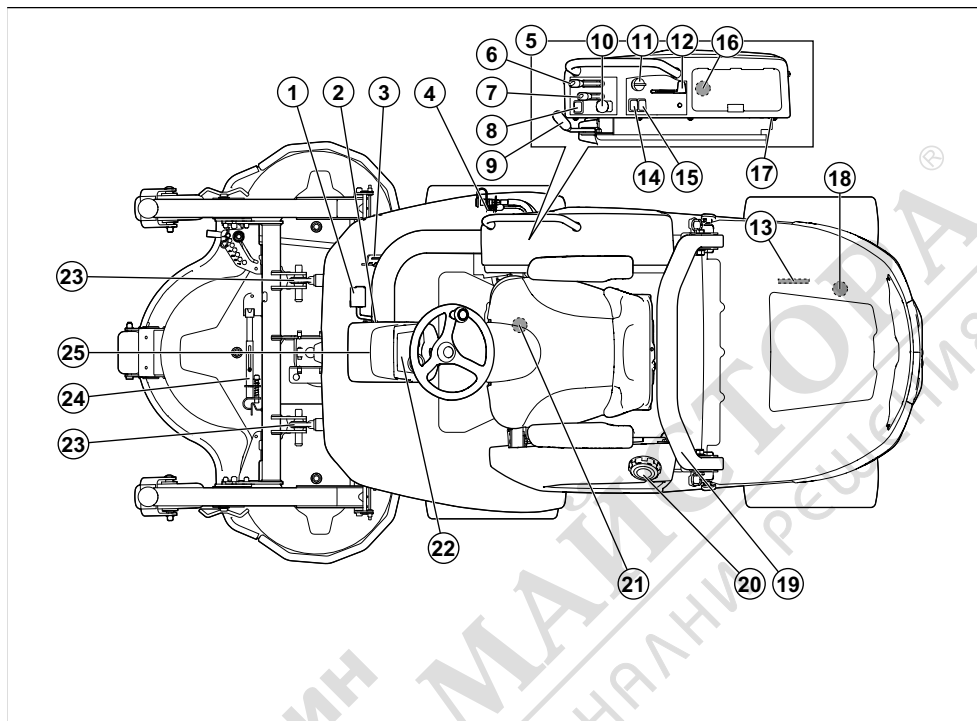

- |  |   |
|--|---|
| 1. Forward pedal   | 13. Type plate                              |
| 2. Lock lever for pedal position (not available for P 520DX)         | 14. Headlight switch                        |
| 3. Rearward pedal  | 15. Switch for the power outlet, 12 V       |
| 4. AUX power outlet, 12 V (accessory for P 520DX)                    | 16. USB outlets, 5 V                        |
| 5. Right side control panel  | 17. Power outlet, 12 V                      |
| 6. Lever for hydraulic lift  | 18. Bypass valve for the rear transmission  |
| 7. Lever for cutting height (accessory for P 520DX)                  | 19. ROPS (Roll Over Protective Structure)   |
| 8. Function button for hydraulic accessories (accessory for P 520DX) | 20. Fuel tank cap                           |
| 9. Parking brake   | 21. Bypass valve for the front transmission |
| 10. PTO button   | 22. Display                                 |
| 11. Ignition key   | 23. Lift arms                               |
| 12. Throttle control   | 24. Service stay                            |
|  | 25. Steering column                         |

## Product overview (P 525DX Cabin)

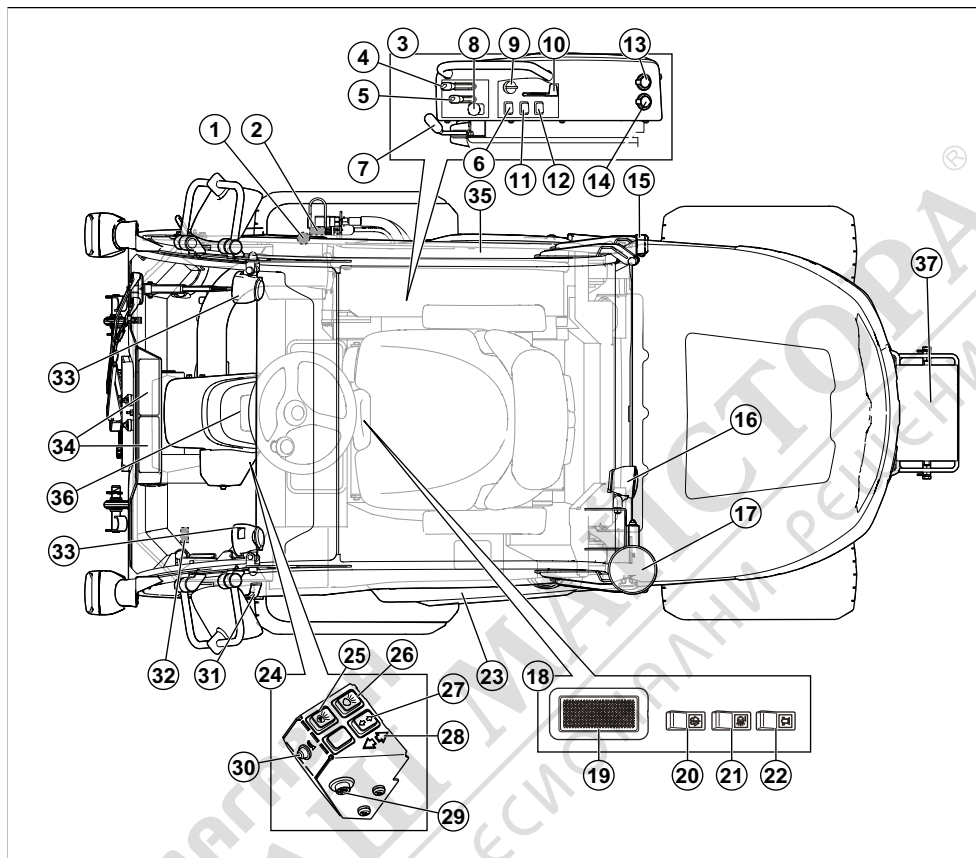

- |  |  |
|--|--|
| 1. Airflow adjuster for the cabin heat       | 18. Control panel in the roof of the cabin       |
| 2. AUX power outlet, 12 V                    | 19. Switch for the inner light of the cabin      |
| 3. Right side control panel                  | 20. Switch for the windshield wipers             |
| 4. Lever for hydraulic lift                  | 21. Switch for the rear work lights on the cabin |
| 5. Lever for cutting height                  | 22. Switch for the warning lights on the cabin   |
| 6. Function button for hydraulic accessories | 23. Door   |
| 7. Parking brake                             | 24. Control panel                                |
| 8. PTO button                                | 25. Switch for the parking lights                |
| 9. Ignition key                              | 26. Switch for the low beam lights               |
| 10. Throttle control                         | 27. Switch for the turn signal                   |
| 11. Headlight switch                         | 28. Turn signal indicator                        |
| 12. Power switch for the power outlet        | 29. Switch for the hazard light                  |
| 13. USB outlets, 5 V                         | 30. Buzzer                                       |
| 14. Power outlet, 12 V                       | 31. Handle                                       |
| 15. Rear lights                              | 32. Venting stay                                 |
| 16. Rear work lights                         | 33. Front work lights                            |
| 17. Warning lights                           | 34. Air fan and filtration                       |

- 35. Emergency exit
- 36. Display
- 37. Counterweight

## Power outlets

The product has the power outlets that follow:

- 12 V power outlet
- USB outlets
- 12 V AUX power outlet (accessory for P 520DX)

To find the fuses for the power outlet, refer to *Fuse overview on page 38*.

To find the outlets, refer to *Product overview (P 520DX, P 525DX) on page 3*.

Turn the power outlet on and off with the power switch on the control panel.

## Hour meter

The product has 2 hour meters on the display. The hour meters show how many hours of operation of the engine has in total (A) and during the operation period (B). The last digit of the hour meter for the operation period, shows tenth of an hour (6 minutes).

The time with ignition on but engine off, is not registered.

**Note:** The total hour meter (A) only shows full hours.

**Note:** A operation period is the time the engine been turned on during 1 day. A new operation period starts if the engine is turned off for a minimum of 6 h.

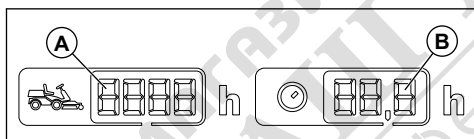

## Husqvarna Connect

The product has wireless technology and can connect to mobile devices that have the Husqvarna Connect app installed. The Husqvarna Connect app is a free app for your mobile device. The Husqvarna Connect app gives extended functions for your Husqvarna product:

- Lock and unlock function to prevent not approved operation of the product.
- Extended product information.
- Information about, and help with, product parts and servicing.

## Husqvarna Fleet Services™

Husqvarna Fleet Services™ is a cloud solution that gives the commercial fleet manager an overview of all products. For more information about Husqvarna Fleet Services™, refer to [www.husqvarna.com](http://www.husqvarna.com).

## To connect to the product with Husqvarna Fleet Services™

1. Download the Husqvarna Fleet Services™ app to your mobile device.
2. Log on to the Husqvarna Fleet Services™ app.
3. Follow the instructions about how to pair the product with Husqvarna Fleet Services™.

## Headlights

The product has a work light and a high beam light.

- Push the power switch to position (A) to make the lights go off.

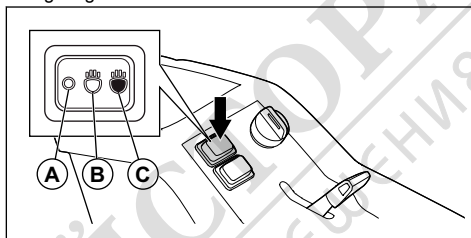

- Push the power switch to position (B) to make the work light come on.
- Push the power switch to position (C) to also make the high beam light come on.

The work light stays on for 3 minutes after the ignition key is set to STOP. When the headlights are on, the display shows the headlight symbol. Refer to *Display on page 7*.

## Forward and rearward pedals

The speed is gradually adjusted with 2 pedals. The left pedal (A) is used to move forward, and the right pedal (B) is used to move rearward. The product brakes when the pedals are released.

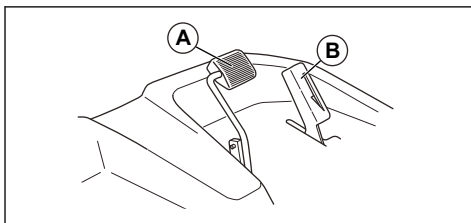

## Lift lever for hydraulic lift of the cutting deck

The lift lever for hydraulic lift is used to lift and lower the cutting deck. The hydraulic lift uses hydraulic pressure and the engine must be started for the lift to operate.

In mow position, the cutting deck moves in level with the ground.

- Position (A) moves the cutting deck to the mow position.
- Position (B) lowers the lift arms.
- Neutral position (C).
- Position (D) moves the cutting deck to transport position.

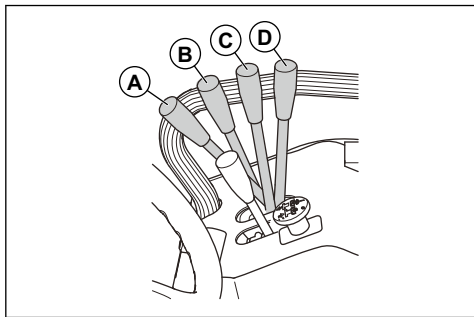

**WARNING:** The cutting deck can always be lifted and lowered. The hydraulic force can cause serious injury.

## Function button for hydraulic accessories

The function button is adjacent to the lift lever for hydraulic accessories.

The function button operates differently for different accessories. Refer to the operator's manual of the accessory.

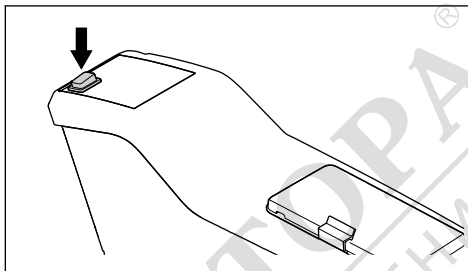

## Cutting deck

The cutting decks for this product are Combi cutting decks with BioClip®. BioClip® cuts the grass into fertilizer. The Combi cutting decks can also be used without BioClip®. Without BioClip® the grass is ejected to the rear.



## Display

The display on the instrument panel shows information of the status of the product.

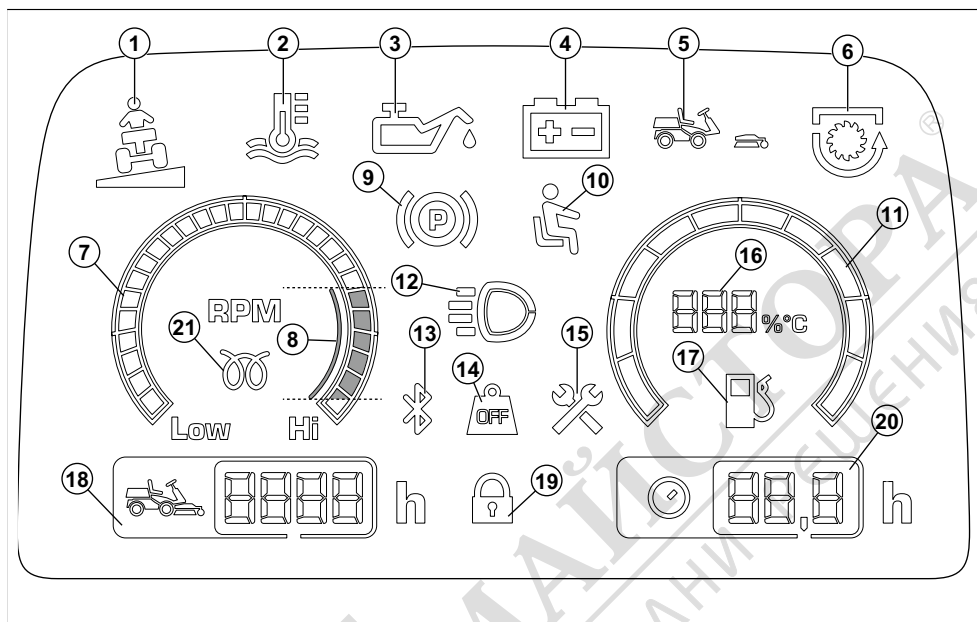

1. Slope indicator (Not applicable for this product)
2. Indicator for engine water temperature
3. Indicator for engine oil pressure
4. Battery level indicator
5. Cutting deck indicator (Not applicable for this product)
6. PTO indicator
7. Tachometer
8. Recommended engine RPM when you operate the product.
9. Parking brake indicator
10. Operator presence control (OPC)
11. Fuel gauge
12. Work light or high beam light indicator
13. Bluetooth®
14. Weight transfer disengaged (Not applicable for this product)
15. Servicing indicator
16. Fuel gauge measured in steps of 5%

**Note:** If the engine water temperature indicator is on, the fuel gauge shows the engine temperature.

17. Low fuel level indicator
18. Hour meter. Total run time in hours.
19. Digital lock

20. Hour meter. Working day hours/day. Refer to *Hour meter* on page 5.
21. Glow plug indicator

**Note:** The look of the display can be different on different models.

**Note:** When the ignition key is turned from the STOP position to the ON position, all symbols light up for a short period of time. After this, only the symbols in operation are on.

### Cabin heat

The P 525DX Cabin has cabin heat to increase the temperature in the cabin. The cabin heat can also be used to remove frost from the windows during cold weather conditions.

### Symbols on the product



**WARNING:** Be careful and use the product correctly. This product can cause serious injury or death to the operator or others.



Read the operator's manual carefully and make sure that you understand the instructions before you use this product.



Rotating blades. Keep body parts away from the cover when the engine is on.



Warning: rotating parts. Keep body parts away.



Warning: rotating belt pulley. Keep body parts away when the engine is on.



Warning: risk of crush injuries.



Warning: risk of crush injuries. The lift arms will move with great force, keep body parts away.



Look out for ejecting objects and ricochets.



Hot surface.



Never use the product if persons, especially children, or animals, are in the vicinity.



Look behind you before and while you move the product rearward.



Never cut grass across a slope. Do not cut grass on ground that slopes more than 10°. Refer to *To cut grass on slopes on page 13*.



Do not keep passengers on the product or equipment.



Risk of injury if the product overturns.



Operate the product very slowly if no cutting deck is attached.



Operate the product at full speed only when a cutting deck is attached.



Move forward.



Neutral gear.



Move rearward.



Parking brake.



Apply parking brake.



Release parking brake.



This product is in accordance with applicable EC directives.



This product conforms to applicable UK regulations.



Noise emission to the environment label as per EU and UK directives and regulations, and New South Wales legislation "Protection of the Environment Operations (Noise Control) Regulation 2017". The guaranteed sound power level of the product is specified in *Technical data on page 58* and on the label.



Always use approved hearing protection.



Activate the product.



Stop the engine.



Engine speed – fast.



Engine speed – slow.



Fuel.



The blades are engaged.



The blades are disengaged.



Oil level.



Scannable code



**Environmental mark.** The product or package of the product is not domestic waste. Recycle it at a recycling station for electrical and electronic equipment.



Do not use the seat belt if the ROPS is down.



Always use the seat belt when the ROPS is up.



**Note:** Other symbols/decals on the product refer to certification requirements for some commercial areas.

## Type plate

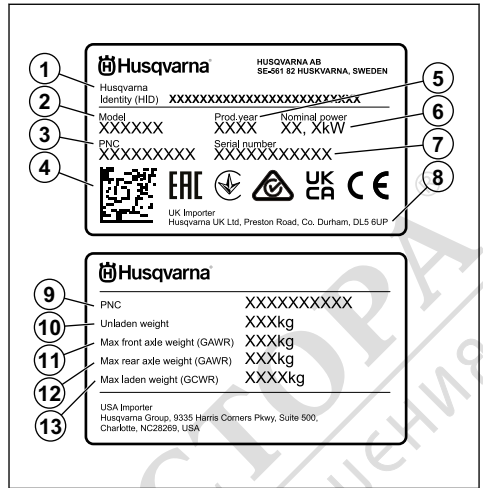

1. Husqvarna Identity (HID) with article number, factory and line, date, sequence number and control number
2. Model name
3. Product number code (PNC)
4. Scannable code
5. Production year
6. Rated power
7. Serial number with production date, year, week and sequence number
8. Manufacturer and manufacturer address
9. Product number code (PNC)
10. Product weight, unladen
11. Maximum front axle weight (GAWR)
12. Maximum rear axle weight (GAWR)
13. Maximum laden weight (GCWR)

## Euro V Emissions



**WARNING:** Tampering with the engine voids the EU type-approval of this product.

## Product liability

As referred to in the product liability laws, we are not liable for damages that our product causes if:

- the product is incorrectly repaired.
- the product is repaired with parts that are not from the manufacturer or not approved by the manufacturer.
- the product has an accessory that is not from the manufacturer or not approved by the manufacturer.
- the product is not repaired at an approved service center or by an approved authority.

# Safety

## Safety definitions

Warnings, cautions and notes are used to point out specially important parts of the manual.



**WARNING:** Used if there is a risk of injury or death for the operator or bystanders if the instructions in the manual are not obeyed.



**CAUTION:** Used if there is a risk of damage to the product, other materials or the adjacent area if the instructions in the manual are not obeyed.

**Note:** Used to give more information that is necessary in a given situation.

## General safety instructions



**WARNING:** This product can cut off hands and feet and throw objects. Serious injury or death may occur if you do not obey the safety instructions.



**WARNING:** Do not continue to use a product with damaged cutting equipment. Damaged cutting equipment can throw objects and cause serious injury or death. Replace damaged blades immediately.



**WARNING:** This product produces an electromagnetic field during operation. This field may under some circumstances interfere with active or passive medical implants. To reduce the risk of serious or fatal injury we recommend persons with medical implants to consult their physician and the medical implant manufacturer before operating this product.



**WARNING:** Read the warning instructions that follow before you use the product.

- Always be careful and use your common sense. Avoid all situations which you consider to be beyond your capability. If you feel uncertainty about the operating procedures after you read the operator's manual, consult an expert before you continue.

- Read and understand the operator's manual and the instructions on the product carefully before you start the product.
- Learn how to use the product and its controls safely and learn how to stop the product quickly.
- Learn to recognize the safety decals.
- Keep the product clean to make sure that you can clearly read signs and stickers.
- Keep in mind that the operator will be held responsible for accidents that involve other persons or their property.
- Do not transport passengers. The product must only be used by one person.

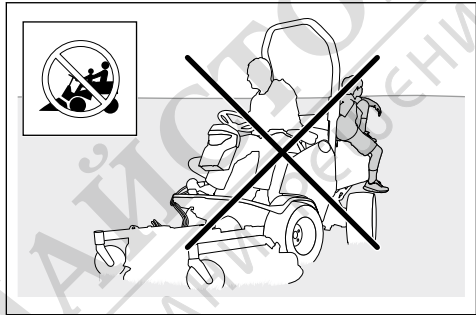

- Do not let the product stay unsupervised with the engine on. Always stop the blades, apply the parking brake, stop the engine and remove the ignition key before you let the product stay unsupervised.
- Only use the product in daylight or in other well-lit conditions. Keep the product at a safe distance from holes or other irregularities in the ground. Look out for other possible risks.
- Do not use the product in bad weather, for example in fog, in rain, moist or in wet locations, strong winds, intense cold, risk of lightning, etc.
- Find and mark stones and other fixed objects to prevent collision.
- Clear the area of objects such as stones, toys, wires, etc. that may become caught in the blades and be thrown out.

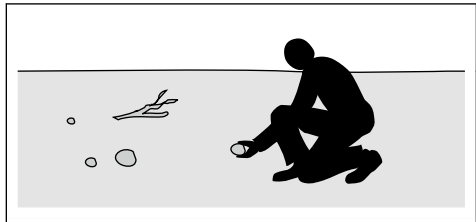

- Do not let children or other persons not approved for operation of the product to use or do servicing on it. Local laws may regulate the age of the user.
- Make sure that nobody else is in the vicinity of the product when you start the engine, engage the drive or start to move the product.
- Keep an eye on the traffic when you mow near a road or move across a road.
- Do not use the product if you are fatigued, while under the influence of alcohol or drugs, medicine or anything that can have a negative effect on your vision, alertness, coordination or judgement.
- Do not change the adjustment for the engine speed control.
- Always park the product on a level surface with the engine stopped.

### Safety instructions regarding children



**WARNING:** Read the warning instructions that follow before you use the product.

- Serious accidents can occur if you are not on your guard for children in the vicinity of the product. Children can be attracted to the product and to mowing. It is very possible that children do not stay where you last saw them.
- Keep children away from the area to be mowed. Make sure that an adult is responsible for the children.
- Keep an eye out and stop the product if children enter the work area. Be very careful near corners, bushes, trees or other objects that prevents a clear view.
- Before and while you move the product in reverse, look behind you and look down to make sure there are no small children in the vicinity of the product.
- Do not let children ride along. They can fall off and get seriously injured or prevent safe maneuvering of the product.
- Do not let children operate the product.

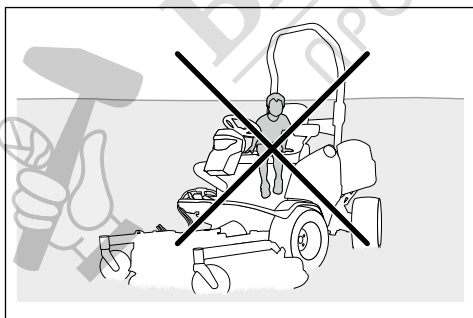

### Safety instructions for operation



**WARNING:** Do not touch the engine or exhaust system during or directly after operation. The engine and the exhaust system become very hot during operation. Risk of burn injuries, fire and damage to property or adjacent areas. When you operate the product, keep away from bushes and other objects.



**WARNING:** Read the warning instructions that follow before you use the product.

- Always look down and behind you before and while you move in reverse. Look out for large and small obstacles.
- Decrease the speed before you turn around a corner.
- Stop the blades when you move across areas that you do not cut.



**CAUTION:** Read the caution instructions that follow before you use the product.

- Before you operate the product, clear the cold air intake of the engine from grass and dirt. If the cold air intake is blocked, there is a risk of engine damage.
- Move around stones and other larger objects carefully and make sure that the blades do not hit the objects.
- Do not operate the product across objects. Stop and examine the product and cutting deck if you operate the product across or into an object. If it is necessary, make repairs before you restart.

### Personal protective equipment



**WARNING:** Read the warning instructions that follow before you use the product.

- Use approved personal protective equipment when you use the product. Personal protective equipment cannot fully prevent injury but it decreases the degree of injury if an accident does occur. Let your dealer help you select the right equipment.
- Always wear approved hearing protection. Long term exposure to noise can result in permanent hearing impairment.
- Always wear protective shoes or protective boots. Steel toes are recommended. Do not use the product barefoot.

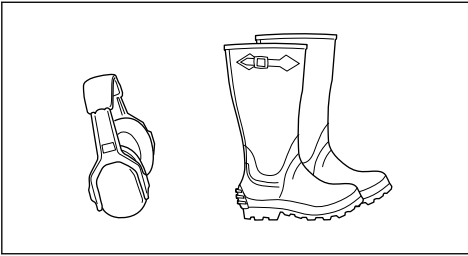

- Wear gloves when necessary, for example when you attach, examine or clean the cutting equipment.
- Do not wear loose-fitting clothing, jewelry or other items that can get caught in moving parts.
- Keep first aid equipment and fire extinguisher close at hand.

### Safety devices on the product



**WARNING:** Read the warning instructions that follow before you use the product.

- Do not use a product with defective safety devices. Do a check of the safety devices regularly. If the safety devices are defective, speak to your Husqvarna service agent.
- Do not make modifications on safety devices. Do not use the product if protective plates, protective covers, safety switches or other protective devices are not attached or are defective.

### Roll Over Protection Structure (ROPS)

ROPS is a protective frame that decreases the risk of injury if the product overturns. Use the ROPS and the safety belt when you operate the product on slopes.

### Safety belt

The safety belt prevents injury if accidents occur or the product overturns. Use the safety belt only when the ROPS is engaged. Make sure that the seat belt is correctly attached and not damaged.

### Operator presence control (OPC)

The OPC is engaged when the operator lifts from the seat. The OPC indicator in the display comes on. The OPC engages the safety circuit. Refer to *To do a check of the operation conditions on page 12*.

### To do a check of the ignition lock

- Start and stop the engine to do a check of the ignition lock. Refer to *To start the engine on page 22* and *To stop the engine on page 25*.
- Make sure that the engine starts when you turn the ignition key to start position.

- Make sure that the engine stops immediately when you turn the ignition key to stop position.

### To do a check of the operation conditions

The operation conditions are as follows:

- The engine can only be started when the drive of the blades is disengaged.
- The engine can only be started when the parking brake is applied.
- The drive of the blades can only operate when the operator sits in the seat.

Do a check of the operation conditions daily.

1. Try to start the engine with the drive of the blades engaged. If the operation conditions works, the engine does not start.
2. Try to start the engine without the parking brake applied. If the operation conditions works, the engine does not start.
3. Start the engine, engage the drive on the blades and lift from the seat. If the operation conditions works, the blades in the cutting deck stop.

### To do a check of the forward drive pedal and rearward drive pedal

1. Start the product.
2. Make sure that the forward drive pedal and rearward drive pedal are not blocked and can be operated freely.
3. Push the forward drive pedal carefully to move forward.
4. Release the forward drive pedal to brake. Make sure that the brake engages when the forward drive pedal is released.
5. Do the same procedure for the rearward drive pedal.

**Note:** The product has a brake function that engages automatically when you release the pedals. To decrease the speed faster, push the other pedal.

6. Make sure that the product does not move when the forward drive and rearward drive pedals are not engaged.

### Parking brake



**WARNING:** If the parking brake does not work, the product can start to move and cause injury or damage. Make sure that the parking brake is regularly examined and adjusted.

Refer to *To do a check of the parking brake on page 33*.

## Muffler

The muffler keeps the noise levels to a minimum and sends the exhaust fumes away from the operator.

Do not use the product if the muffler is missing or defective. A defective muffler increases the noise level and the risk of fire.



**WARNING:** The muffler becomes very hot during and after use and when the engine operates at idle speed. Be careful near flammable materials and/or fumes to prevent fire.

### To do a check of the muffler

- Examine the muffler regularly to make sure that it is attached correctly and not damaged.

### Protective covers

Missing or damaged protective covers increase the risk of injury on moving parts and hot surfaces. Do a check of the protective covers before you operate the product. Make sure that the protective covers are correctly attached and do not have cracks or other damages. Replace damaged covers.

### Power switches for safety signals - P 525DX Cabin

The power switches for safety signals are found on the panel to the left of steering wheel.

- Horn (A)
- Parking lamp (B)
- Low beam lights (C)
- Turn signal (D)
- Hazard lights (E)

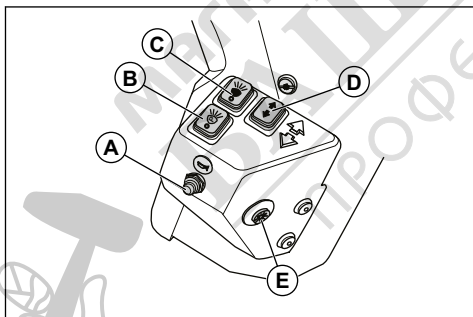

### To cut grass on slopes



**WARNING:** Read the warning instructions that follow before you use the product.

- To cut grass on slopes increases the risk that you can not control the product and that it overturns. This can cause injury or death. It is necessary to cut the

grass carefully on all slopes. If you cannot reverse up a slope or if you do not feel safe, do not cut it.

- Remove stones, branches and other obstacles.
- Cut up and down the slope, not from side to side.
- Do not move down a slope with the cutting deck lifted.
- Do not operate the product on ground that slopes more than 10°.

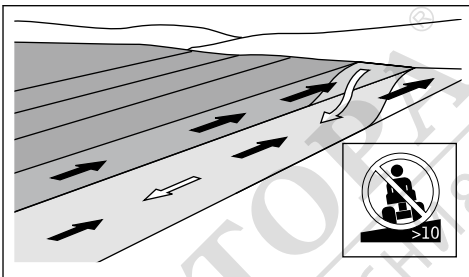

- Do not start or stop on a slope.
- Move smoothly and slowly on slopes.
- Do not make sudden changes in speed or direction.
- Do not turn more than necessary. Turn slowly and gradually when you move down a slope. Move at low speed. Turn the wheel carefully.
- Look out for and do not move across furrows, holes and bumps. There is a higher risk that the product overturns on ground that is not flat. Long grass can hide obstacles.
- Do not cut grass near edges, ditches or banks. The product can suddenly overturn if a wheel moves across the edge of a steep slope or a ditch, or if an edge gives way. If the product falls into water, there is a risk of drowning.

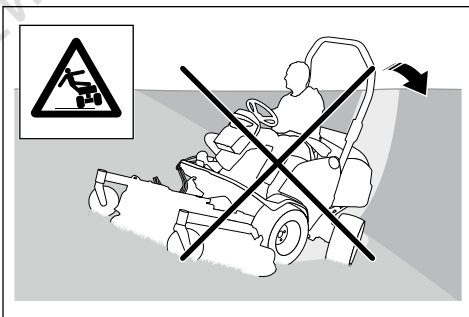

- Do not mow wet grass. It is slippery, and tires can lose their grip so that the product skids.
- Do not put your foot on the ground to try to make the product more stable.
- Move very carefully if an accessory or other object is attached that can make the product less stable.
- To make the product more stable, attach wheel weights or counterweights. Speak to your dealer for more information. On P 525DX, use counterweights

since wheel weights can not be used on AWD products.

## Fuel safety



**WARNING:** Be careful with fuel. It is very flammable, and can cause injury and damage to property.



**WARNING:** Read the warning instructions that follow before you use the product.

- Do not fill the fuel tank indoors.
- Diesel and diesel fumes are poisonous and very flammable. Be careful with diesel to prevent injury or fire.
- Do not remove the fuel tank cap or fill the fuel tank when the engine is on.
- Let the engine become cool before you refuel.
- Do not smoke when you fill fuel.
- Do not fill fuel near sparks or naked flames.
- If there are leaks in the fuel system, do not start the engine until the leaks are repaired.
- Do not fill above recommended fuel level. The heat from the engine and the sun makes the fuel expand and the fuel overflows if the tank is filled too much.
- Do not fill too much. If you spill fuel on the product, clean up the spill and wait until it is dry before you start the engine. If you spill on your clothing, change it.
- Store fuel in approved containers only.
- Store the product and fuel in such a way that there is no risk that fuel leaks or fumes can cause damage.
- Drain off the fuel in an approved container outdoors and away from naked flames.

## Battery safety



**WARNING:** A damaged battery can cause an explosion and cause injury. If the battery has a deformation or is damaged, speak to an approved Husqvarna service agent.



**WARNING:** Read the warning instructions that follow before you use the product.

- Use protective glasses when you are near batteries.
- Do not wear watches, jewelry or other metal objects near the battery.
- Keep the battery out of reach for children.
- Charge the battery in a space with good airflow.
- Keep flammable materials at a minimum clearance of 1 m when you charge the battery.

- Discard replaced batteries. See *Disposal on page 57*.
- Explosive gases can come from the battery. Do not smoke near the battery. Keep the battery away from open flames and sparks.

## Transport safety

- Use an approved transport vehicle for transportation of the product.
- A markets national or local regulations can set limit to the transportation of the product.
- The operator of the transport vehicle is responsible to attach the product safely during transport. Refer to *To safely attach the product on a trailer for transport on page 55*.

## Safety instructions for maintenance



**WARNING:** The product is heavy and can cause injury or damage to property or the adjacent area. Do not do maintenance on the engine or the cutting deck without these conditions:

- The engine is off.
- The product is parked on a level surface.
- The parking brake is applied.
- The ignition key is removed.
- The cutting deck is disengaged.
- The main switch is set to off. Refer to *To start the engine on page 22*.



**WARNING:** The exhaust fumes from the engine contain carbon monoxide, an odorless, poisonous and very dangerous gas. Do not run the product in closed spaces or spaces with not sufficient air flow.



**WARNING:** Read the warning instructions that follow before you use the product.

- For best performance and safety, do maintenance on the product regularly as given in the maintenance schedule. Refer to .
- Electrical shocks can cause injuries. Do not touch the cables when the engine is on. Do not do a function test on the ignition system with your fingers.
- Do not start the engine if the protective covers are removed. There is a high risk of injury caused by moving or hot parts.
- Let the product become cool before you do maintenance near the engine.
- The blades are sharp and can cause cuts. Wind protection around the blades or use protective gloves when you do work on the blades.

- Always put the cutting deck in servicing position to clean it. Do not park the product near the edge of a ditch or slope to get access to the cutting deck.



**CAUTION:** Read the caution instructions that follow before you use the product.

- Do not turn over the engine if the spark plug or ignition cable is removed.

- Make sure that all nuts and bolts are tightened correctly and that the equipment is in good condition.
- Do not change the adjustment of governors. If the engine speed is too high, the product components can become damaged. Refer to *Technical data on page 58* for highest permitted engine speed.
- The product is approved only with the equipment supplied or recommended by the manufacturer.

## Assembly

### To attach the cutting deck Combi 132, Combi 155

**Note:** Make sure that the cutting deck and the product are on level ground before you attach the cutting deck.

1. Put the lift lever to the position (B) to lower the lift arms.

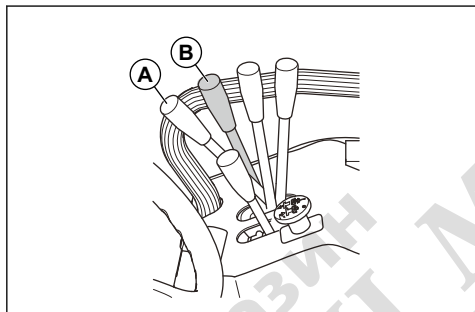

**WARNING:** Do not put the lift lever in the mow position (A). The force from the lift spring can cause serious injury.

2. Carefully operate the product in front of the cutting deck.
3. Put the lift arms into the joint of the cutting deck.
4. Apply the parking brake.
5. Stop the engine.

6. Install the bolts (C) and attach the pins (D) on the lift arms.

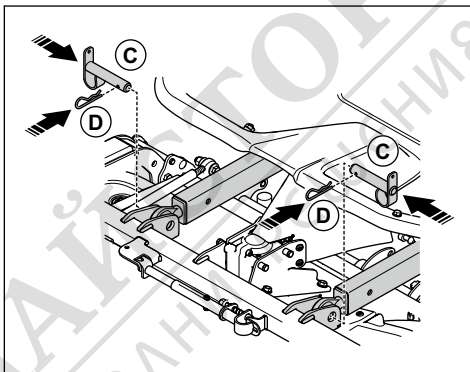

7. Remove the 2 screws and the service hatch.

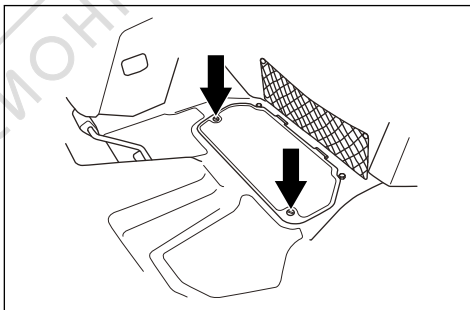

8. Pull back the coupling of the drive shaft and attach the drive shaft to the PTO.

**Note:** Make sure that the arrow on the symbol points to the product.

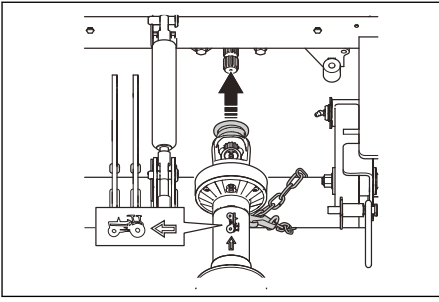

9. Put the rear lock chain around the lift beam.
10. Attach the lock chain to the drive shaft.
11. Pull back the coupling of the drive shaft and attach the drive shaft to the bevel gear shaft of the cutting deck.

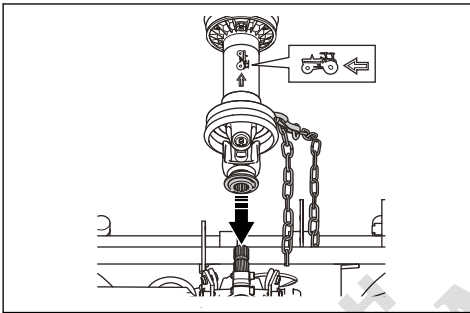

12. Fold the rubber casing above the shaft joint.
13. Put the front lock chain around the pipe.
14. Attach the lock chain to the drive shaft.
15. Attach the service hatch and tighten the screws.
16. Start the engine.
17. Move the lift lever rearward to lift the cutting deck.  
Lift until the pivot wheels of the cutting deck do not touch the ground.
18. Stop the engine.
19. Pull the spring (E) and attach to the lifting eyes on the cutting deck (F).

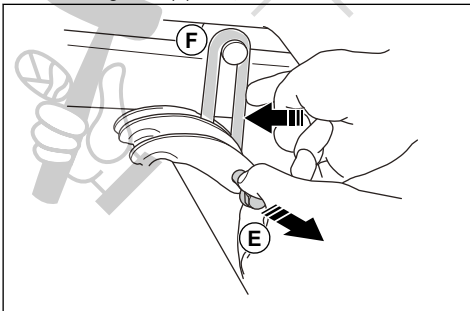

20. Do a check of the parallelism of the cutting deck.  
Refer to *To do a check of the parallelism of the cutting deck on page 33.*

## To attach the cutting deck Combi 132 X, Combi 155 X

1. Attach the cutting deck. Refer to *To attach the cutting deck Combi 132, Combi 155 on page 15.*
2. Put the hydraulic hoses from the cutting deck through the loop.

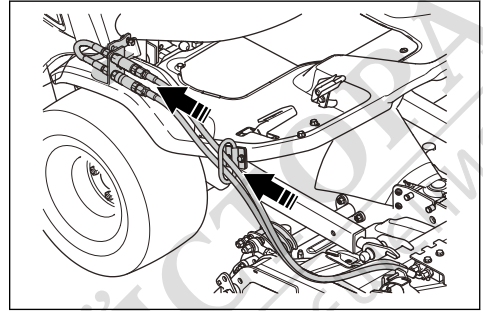

3. Connect the hydraulic hoses to the coupling on the product. The flange and the notch must line up correctly.

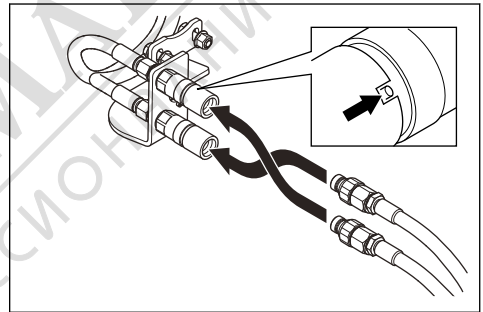

**Note:** The position of the hydraulic hoses controls the operation function of the cutting height lever. To change the operation function of the cutting height lever, change the position of the hydraulic hoses.

## To remove the cutting deck

1. Park the product on level ground.
2. Stop the engine.
3. Move the cutting height lever forward and rearward 2-3 times to release remaining pressure.
4. For Combi 132 X and Combi 155 X, release the couplings and disconnect the hydraulic hoses.
5. Apply the parking brake.
6. Move the lift lever forward to lower the cutting deck. Stop before the pivot wheels of the cutting deck touch the ground.

7. Pull the spring (A) and remove the lifting eyes (B).

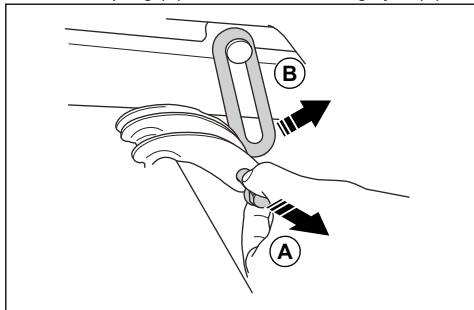

8. Start the engine.  
9. Put the lift lever to the position (C) to lower the lift arms.

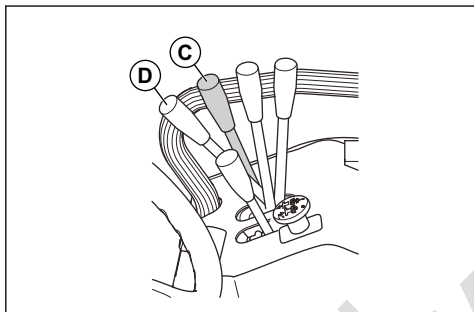

**WARNING:** Do not put the lift lever in the mow position (D). The hydraulic force can cause serious injury.

10. Stop the engine.  
11. Remove the 2 screws and the service hatch.

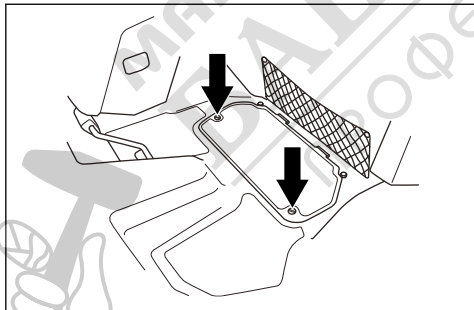

12. Lift off the rubber casing from the shaft joint.  
13. Pull back the coupling of the drive shaft and remove the drive shaft from the bevel gear shaft of the cutting deck and from the PTO shaft.  
14. Remove the lock chains.

15. Remove the pins (E) and the bolts (F) from the lift arms.

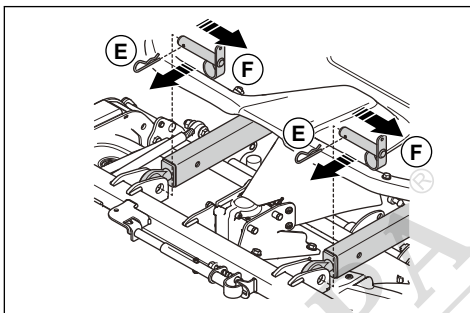

## To remove and install the cabin

1. Remove the cabin door. Refer to *To remove and install the door on page 19*.
2. Remove the emergency door. Refer to *To remove and install the emergency door on page 19*.
3. Remove the rubber straps and open the engine cover.
4. Disconnect the battery.

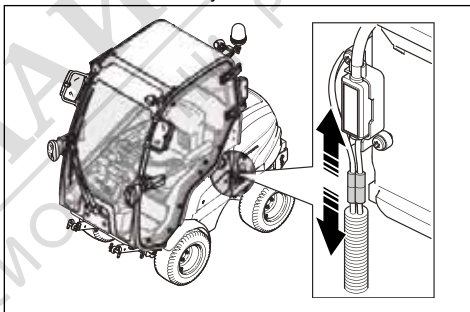

5. Remove the service lid. Refer to *To remove the service lid on page 30*.
6. Remove the cover of the fuse box. Refer to *To remove the cover of the control box on page 31*.
7. Disconnect the cable for cabin control. The cable has a black plug.

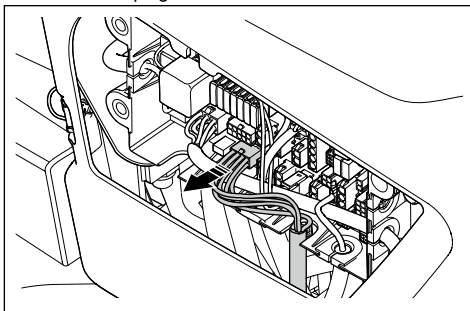

8. Put the rubber grommet in the empty slot.
9. Disconnect the 2 connectors from the headlight switch.

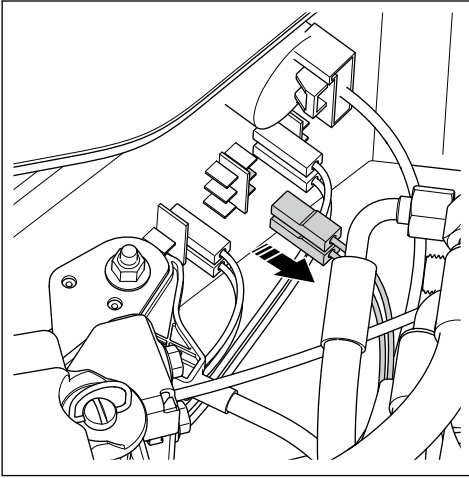

10. Remove the cable bridge from the connector and install the connector on the headlight switch.

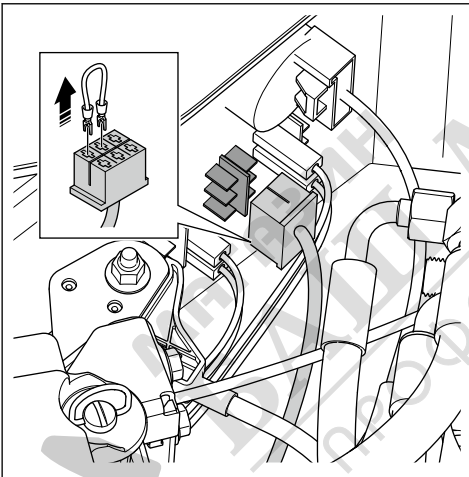

11. Turn the headlight switch ON and OFF to make sure the headlights work correctly.
12. Put a cloth below the hoses for the cabin heat.

**Note:** To prevent coolant leakage, make sure that the cabin heat is off before you disconnect the hoses.

13. Disconnect the hoses for the cabin heat.

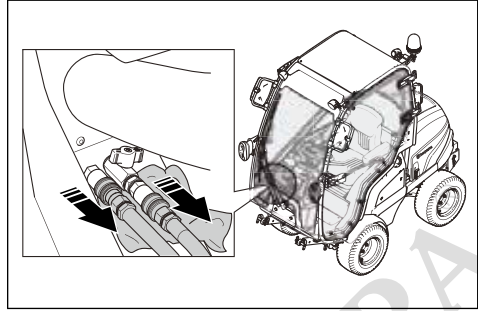

14. Remove the 2 screws and the 2 washers behind the seat (A).

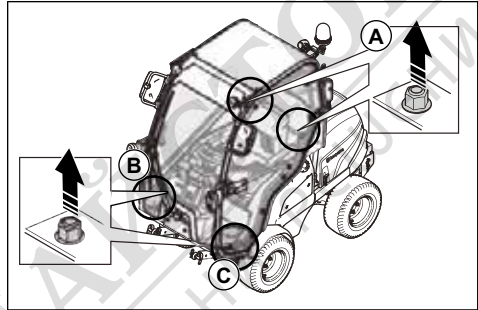

15. Remove the screw and the washer behind the hoses for the cabin heat (B).
16. Remove the screw and the washer at the front of the door (C).
17. Fold the seat forward.
18. Put 2 straps through the door and the emergency exit.

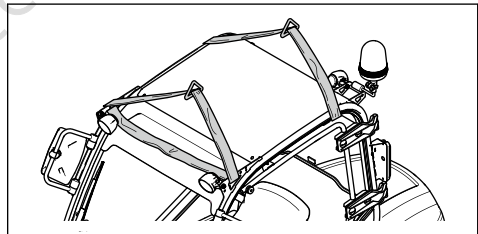

19. Put the straps 2 turns through the cabin.

20. Attach the straps in the lifting eyes of the cabin.

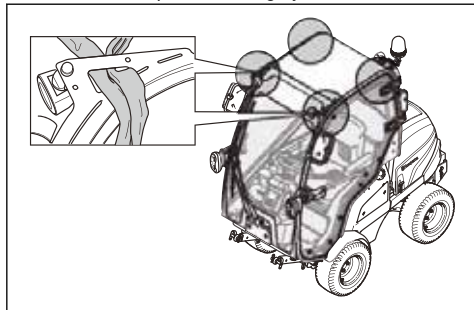

21. Carefully lift the cabin in the straps with a lift.

22. Lift the cabin 10 cm above the product.



**CAUTION:** Make sure that the cabin is lifted above the bolts.

23. Carefully move the cabin forward.

24. Put the cabin in the cabin support. Refer to *Storage of the cabin on page 56*



**WARNING:** ROPS must be installed when the cabin is removed. Refer to *To engage and disengage the Roll Over Protection Structure (ROPS) on page 19.*

25. Install in the opposite sequence.

### To remove and install the door

1. Open the door 90 degrees.
2. Pull out the gas spring and loosen the ball joint.
3. Lift the door to remove it.
4. Install in the opposite sequence.

### To remove and install the emergency door

1. Open the lock handle on the emergency door.
2. Remove the hinge pin.
3. Open the door 90 degrees.
4. Lift the emergency door to remove it.
5. Install in the opposite sequence.

## To engage and disengage the Roll Over Protection Structure (ROPS)

- Remove the 2 bolts that hold the ROPS and fold it rearwards to disengage. Engage the ROPS in the opposite sequence.

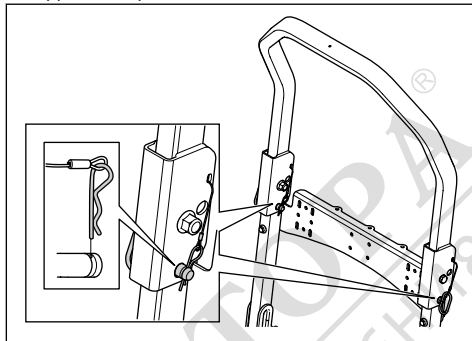

**WARNING:** Obey the following instructions for the ROPS and the seat belt.

- Do not use the seat belt if the ROPS is disengaged.

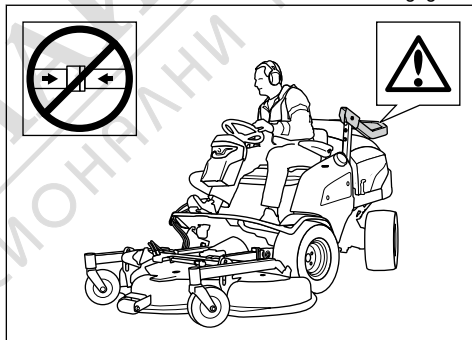

- Always use the seat belt when the ROPS is engaged.

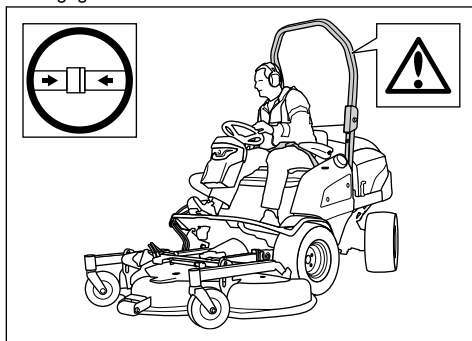

- Make sure that the ROPS is correctly attached and not damaged.

# Operation

## Introduction



**WARNING:** Before you operate the product, you must read and understand the safety chapter.

## To fill fuel



**WARNING:** Diesel fuel is very flammable. Be careful and refuel outdoors. Refer to *Fuel safety on page 14*.



**WARNING:** Do not use the fuel tank as a support area.



**CAUTION:** Incorrect type of fuel can result in engine damage.

- To agree with the emission regulations, the diesel fuel must comply with the standard EN590 or ASTM D975 and have a Sulphur content of less than 500ppm or 0,05% of weight. Refer to the Kubota Operators Manual for further information regarding fuel quality.
- Use diesel fuel with a minimum cetane rating of 45. Do not use diesel fuel that has a RME mix that contains more than 5% in mineral oil-based fuels.

**Note:** It is necessary to use fuel for cold weather if the temperature is below 0°C / +32°F. Speak to your Husqvarna servicing dealer for more information.

- Do a check of the fuel level before each use and refuel if it is necessary.
- Do not fill fuel above the maximum level mark on the fuel tank.

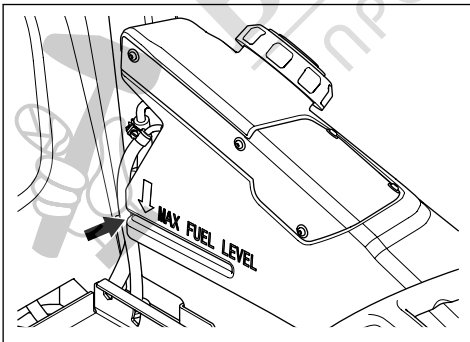

## To adjust the seat (P 520DX, P 525DX)



**WARNING:** Do not adjust the seat during operation of the product.

1. To adjust the suspension of the seat, rotate lever (A). Pull the lever up for more suspension and push the lever down for less suspension.

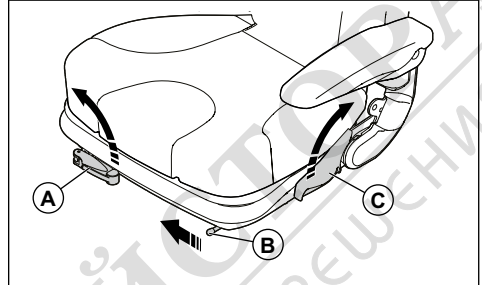

2. To adjust the seat forward and rearward, pull the lever (B) in the direction of the middle of the seat. Move the seat to the correct position.
3. To adjust the backrest, pull the lever (C) to the left of the seat. Move the backrest to the correct position.

## To adjust the seat (accessory for P 520DX, P 525DX)



**WARNING:** Do not adjust the seat during operation of the product.

1. To adjust the seat forward and rearward, pull lever (A) below the front edge of the seat. Move the seat (B) to the correct position.

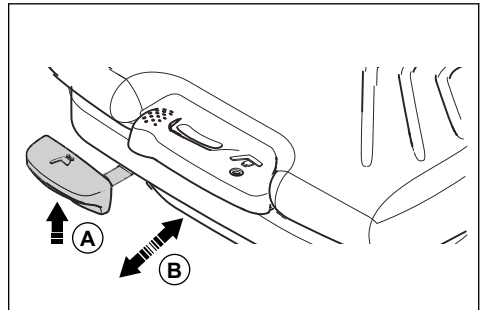

2. To adjust the suspension of the seat, pull the lever (C) to the left. Pull the lever up for more suspension and push the lever down for less suspension (D).

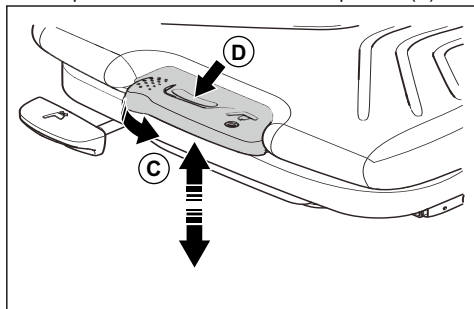

3. To adjust the backrest, pull the lever (E) to the left of the seat. Move the backrest to the correct position.

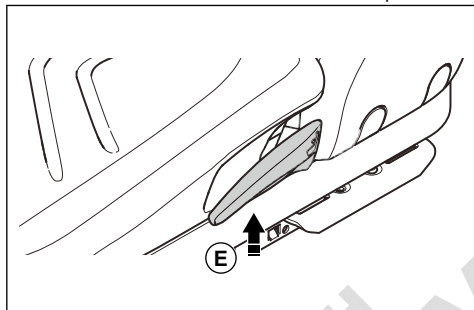

4. To adjust the lumbar support, turn the lever (F) to the left of the backrest. Turn the lever counterclockwise for more support.

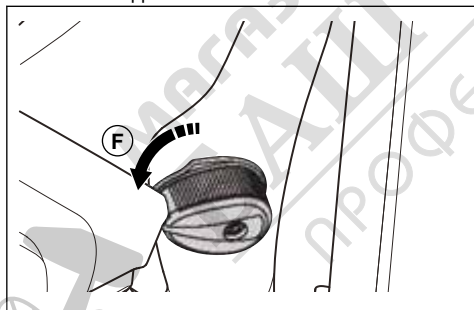

## To tilt the seat forward (P 520DX, P 525DX)

- Pull the lock lever up and tilt the seat forward.

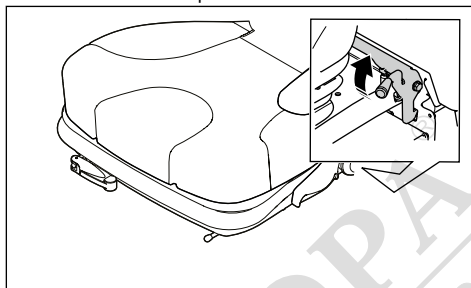

## To tilt the seat forward (P 525DX Cabin)

1. Remove the 2 knobs and the 2 washers.

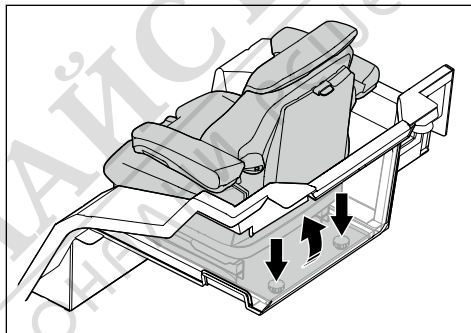

2. Tilt the seat forward.

## To lift the cutting deck

1. Push the PTO button to disengage the drive of the cutting deck.

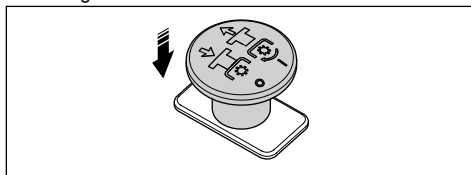

2. Move the lift lever to transport position to lift the cutting deck.

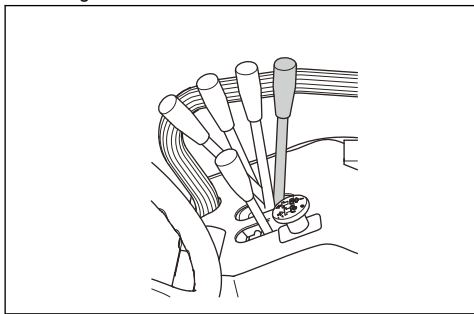

**Note:** You can lift the cutting deck a small distance with the drive on the blades engaged. Use this function for very long grass or rough surfaces.



**WARNING:** Lifting the cutting deck while the drive is engaged can throw objects and cause serious injury or death.

## To lower the cutting deck to the mow position

1. Move the lift lever for hydraulic lift forward to lower the cutting deck to the mow position (A).

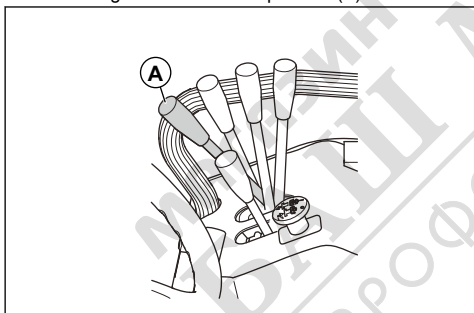

2. Pull the PTO button to engage the drive on the cutting deck blades.

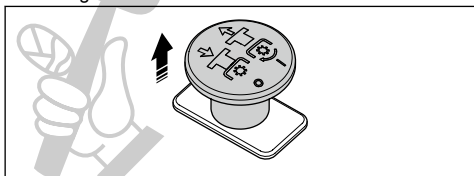

## To start the engine

1. Push down and turn the main switch to the ON position.

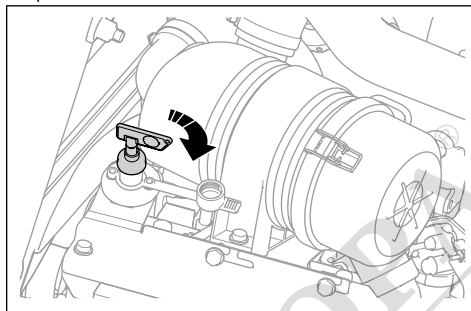

2. Apply the parking brake.
3. Push the PTO button to disengage the operation of the cutting deck.

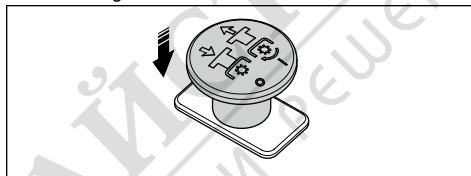

4. Move the throttle control to the middle position.

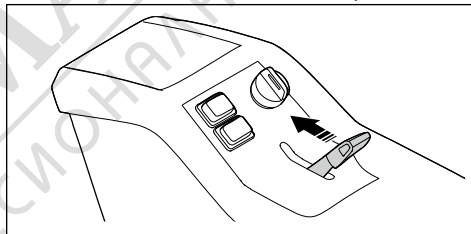

5. Turn the ignition key to the ON position. Wait for the display lights to come on.
6. Turn the ignition key to the arrow position. Hold it in this position until the engine starts.

- When the engine starts, immediately release the ignition key to the ON position, to prevent damage to the starter.

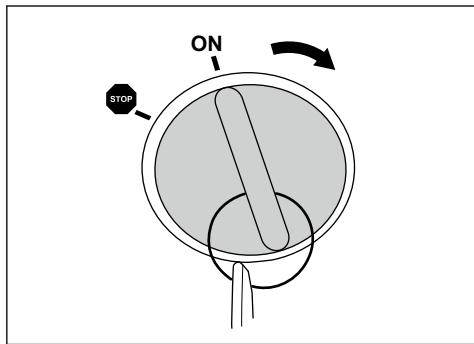

**CAUTION:** Do not run the starter for more than 6 seconds at a time. If the engine does not start, wait 15 seconds before you try again.

- Let the engine run at ½ throttle for 3-5 minutes before you apply a heavy load.
- Push the throttle control to full throttle position.



**CAUTION:** To engage the blades when the engine is at full speed causes strain on the drive belts and the clutch. Do not apply full throttle until the cutting deck is lowered to the mow position.

## To operate the product

- Start the engine.
- Release the parking brake.

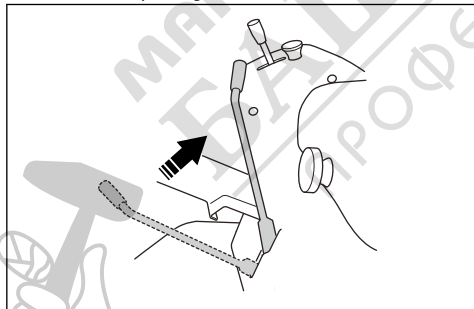

- Carefully push down one of the pedals. The speed increases the more the pedal is pushed down. Use pedal (A) to move forward, and pedal (B) to move in reverse.

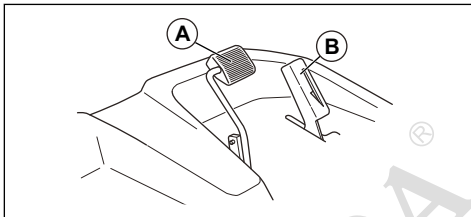

- Release the pedal to brake. To brake harder, push down the other speed pedal.
- Pull the PTO button to engage the operation of the blades on the cutting deck.

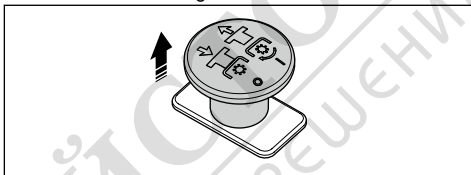

## To set the forward pedal positions (P 525DX, P525DX Cabin)

The forward pedal can be set to transport speed or working speed using the lock lever.

- Move the lock lever from position (A) to position (B) to set the pedal to working speed.

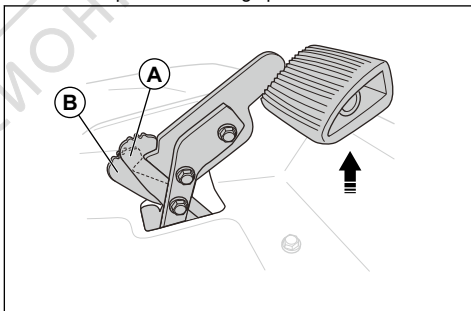

- Lift the pedal until the lock lever moves into position (A) to set the pedal to transport speed.

## To adjust the ground pressure of the hydraulic lift arms

The hydraulic lift arms has a lift spring that helps to increase or decrease the ground pressure from the pivot wheel on the cutting deck.

- Remove the cutting deck. Refer to *To remove the cutting deck on page 16*.
- Apply the parking brake.

3. Move the lever for the hydraulic lift arms rearward to fully lift the hydraulic lift arms.
4. Turn the ignition key to the STOP position.
5. To increase or decrease the ground pressure, remove the pin and the bolt and move the lift spring to one of the positions.

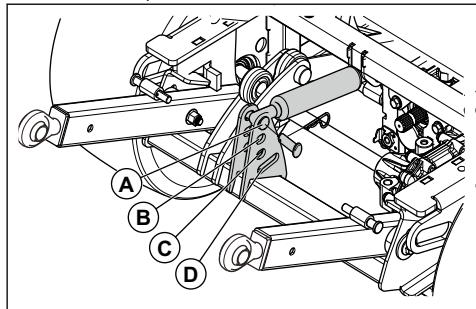

- a) Use position (A) for the lowest ground pressure. Position (A) is used for example when a cutting deck is attached to the product.
- b) Use position (B) or (C) for increased ground pressure.
- c) Use position (D) to disengage the lift spring. Position (D) is used for example when a snow blade is attached to the product.

## To adjust the cutting height Combi 132, Combi 155

1. Park the product on level ground.
2. Apply the parking brake.
3. Move the lever for the hydraulic lift arms rearward to fully lift the cutting deck.
4. Turn the ignition key to the STOP position.
5. Remove the cutting height adjustment knob on the side of the cutting deck.

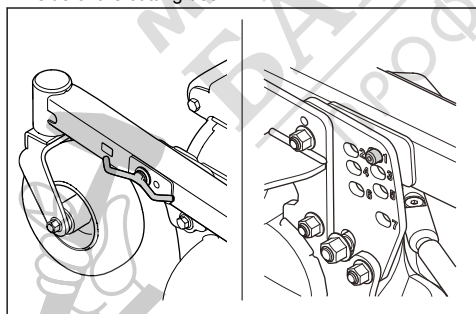

6. Put the cutting height adjustment knob in 1 of the holes on the adjustment plate.

**Note:** The cutting height is shown with the numbers 1–7. Refer to the table below.

Number	Cutting height, mm/in.
1	30/1.2
2	40/1.6
3	52/2
4	64/2.5
5	76/2.3
6	93/3.7
7	112/4.4

7. Tighten the cutting height adjustment knob.
8. Do the above steps on the other side of the cutting deck.
9. Remove the locking pin on the cutting height adjustment lever in the top left corner of the cutting deck.

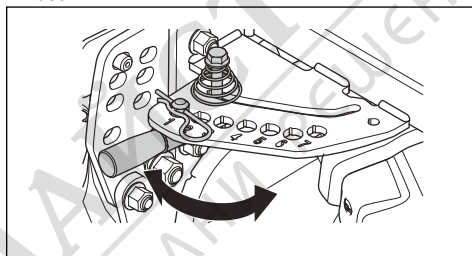

10. Push the cutting height adjustment lever down and pull the lever horizontally.
11. Put the lever in the hole with the same number as on the adjustment plate.

**Note:** Make sure the same number is selected on all adjustment points.

12. Attach the locking pin on the cutting height adjustment lever.
13. Adjust the parallelism of the cutting deck. Refer to *To adjust the parallelism of the cutting deck on page 34.*

## To adjust the cutting height (Combi 132 X, Combi 155 X)

1. Park the product on level ground.
2. Move the lift lever for hydraulic lift forward to lower the cutting deck to the mow position.

3. Move the cutting height lever forward and rearward to adjust the cutting height.

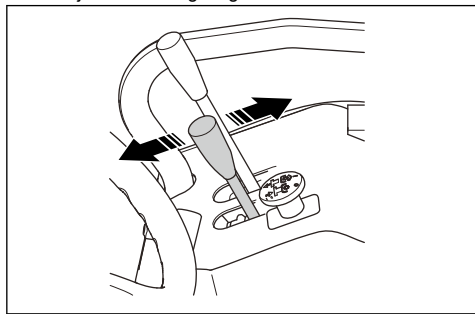

**Note:** The selected cutting height is shown with the numbers 1–7 on the cutting deck. Refer to the table below.

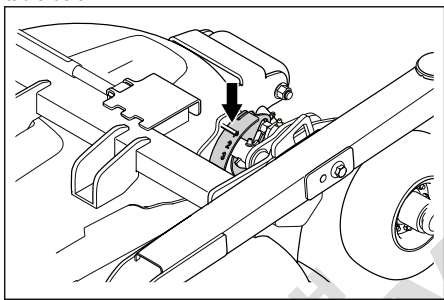

Number	Cutting height, mm/in.
1	30/1.2
2	40/1.6
3	52/2
4	64/2.5
5	76/2.3
6	93/3.7
7	112/4.4

4. Adjust the parallelism of the cutting deck. Refer to *To adjust the parallelism of the cutting deck on page 34.*



## To operate the cabin heat

1. Engage (A) and disengage (B) the cabin heat with the valve on the hose to the right of the forward pedal.

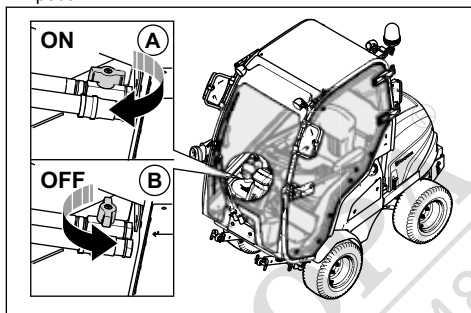

2. Turn the airflow adjuster to set the airflow (0–3).

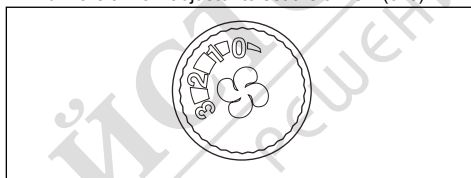

3. Pull the circulation lever to the right (A) to engage the air circulation throttle. Pull the circulation lever to the left (B) to disengage the air circulation throttle.

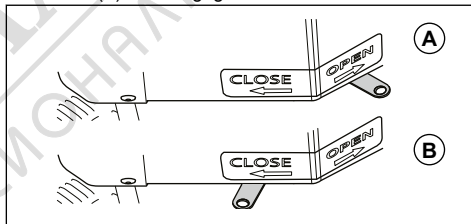

## To stop the engine

1. Park the product on level ground.
2. Apply the parking brake.
3. Push the PTO button to disengage the drive on the cutting deck.

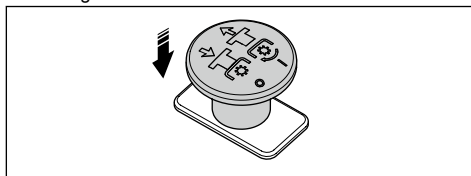

4. Push the lever for the hydraulic lift arms forward to lower the cutting deck to the ground.

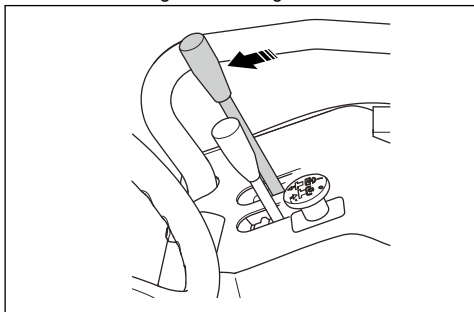

5. Move the throttle control rearward to the low speed position.
6. Turn the ignition key to the STOP position.

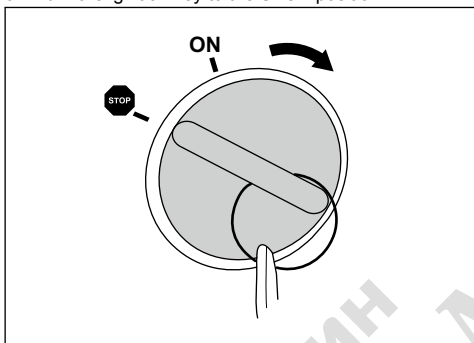

7. At the end of operation, or when you do maintenance on the product, turn the main switch to the OFF position.

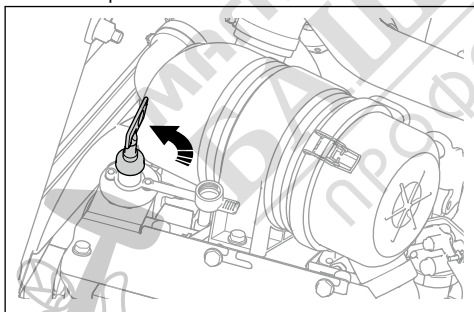

## To apply and release the parking brake

1. To apply the parking brake, move the parking brake lever fully forward.

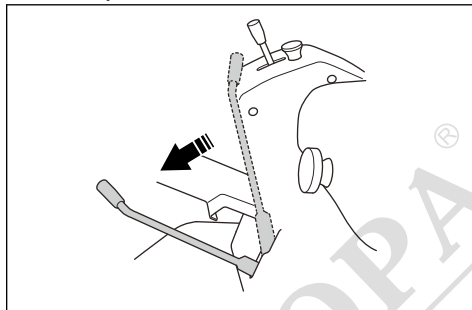

2. To release the parking brake, move the parking brake lever fully rearward.

## To set the 12 V power outlet to on or off

- Push the power switch (A) on the right control panel to set the power outlet (B) to on or off. The voltage of the power outlet is 12 V. The power outlet has a fuse, refer to *Fuse overview on page 38*.

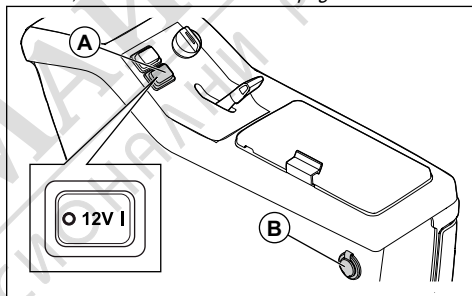

**Note:** The AUX 12 V and the USB outlets are always set to on.

## To get a good cutting result

- For best performance, do maintenance on the product regularly as given in the maintenance schedule. Refer to .
- Do not cut a wet lawn. Wet grass can give a bad cutting result.
- Start with a high cutting height and decrease it gradually.
- Cut with blades that rotate at high speed (highest permitted engine speed, refer to *Technical data on page 58*). Move the product forward at low speed. If the grass is not too high and thick, you can get a good cutting result also at a higher speed.
- Cut the grass in an irregular pattern.
- To get the best cutting result, cut the grass frequently and use the Bioclip® function.

## To disengage the hydrostatic transmission

To move the product with the engine off, you must open the hydraulic circuits on the front and the rear transmission. This is done by opening the bypass valves in the transmission motors.



**CAUTION:** The product has no brakes when the bypass valves are open. The bypass valves must be closed before you operate the product.



**CAUTION:** Do not tow the product in high speed or for long distances. This will cause damage to the transmissions.

### Rear transmission

- To open the bypass valve, open the locknut (A)  $\frac{1}{4}$ – $\frac{1}{2}$  turn counterclockwise and then the valve screw (B) 2 turns counterclockwise.

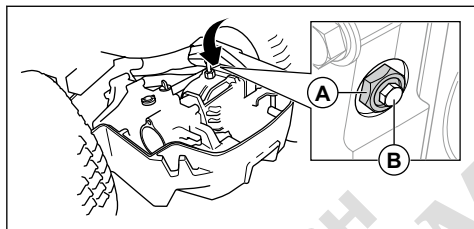

- To close the bypass valve, close the valve screw (B) and tighten to 8 Nm and then tighten the locknut (A) to 30 Nm.

### Front transmission

- To open the bypass valve, open the locknut (A)  $\frac{1}{4}$ – $\frac{1}{2}$  turn counterclockwise and then the valve screw (B) 2 turns counterclockwise.

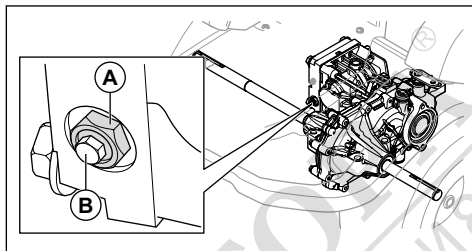

- To close the bypass valve, close the valve screw (B) and tighten to 8 Nm and then tighten the locknut (A) to 30 Nm.

## Maintenance

### Introduction



**WARNING:** Read and understand the safety chapter before you do maintenance on the product.

X = Maintenance done by the operator. The instructions are given in this operator's manual.

O = Maintenance done by the service agent. The instructions are not given in this operator's manual.

### Maintenance schedule

\* = General maintenance done by the operator. The instructions are not given in this operator's manual.

**Note:** If more than one time interval is identified in the table, the shortest time interval is for the first maintenance only.

Maintenance	Daily	Week-ly	First 50 h	Maintenance interval in hours			
				100	200	400	800
Make sure that nuts and screws are tightened.	*						
Make sure that there are no fuel, water or oil leaks.	*						
Clean the machine.	X						
Make sure that the safety devices are not defective.	X						
Lubricate. Refer to <i>Lubrication overview on page 50</i> .		X					

Maintenance	Daily	Week-ly	First 50 h	Maintenance interval in hours				
				100	200	400	800	
Make sure that the fuel hoses and the couplings are clean and not damaged.			*	*				
Make sure that the hoses and the couplings for the cooling system are clean and not damaged.			*	*				
Examine the 12 V battery.		*						
Do a check of the electrical connections and cables.			*	*				
Do a check of the parking brake wire and adjust the parking brake.					○			
Do a check of the software for the product and update if necessary.				○				
Do a check of the tension of the PTO belts and make sure the belts are not worn.			X	X				
Replace the PTO belts.						○		
Replace the PTO switch.			Each 10 years					
				○				
<b>Hydraulic system</b>								
Make sure that the hydraulic hoses and the hydraulic couplings are clean and not damaged.			*	*				
Do a check of the oil level in the hydraulic oil tank.		X						
Replace the hydraulic oil filter.			*			*		
Replace the hydraulic oil.						*		
<b>Engine</b>								
Make sure that the cold air intake of the engine is not blocked.	*							
Do a check of the coolant level.	X							
Replace the coolant.							○	
Do a check of the engine oil level.	X							
Replace the engine oil.			X	X				
Replace the oil filter.			X	X				
Clean the air filter.	X							
Replace the air filter.						X		
Replace the primary fuel filter and the secondary fuel filter.				X				
Do a check of the tension of the alternator belt and tighten if necessary.				*				
Replace the alternator belt.							○	

Maintenance	Daily	Weekly	First 50 h	Maintenance interval in hours			
				100	200	400	800
Do a check of the fuel hoses and make sure that there are no cracks or leakages.							*
Replace the fuel hoses.	Each 5 years ○						
<b>Cutting deck</b>							
Clean the cutting deck, below the belt covers and below the cutting deck.	*						
Examine the cutting deck for damages.	*						
Examine the blades in the cutting deck. Sharpen and balance if it is necessary.		○					
Examine the V-belt of the cutting deck.			X	X			
Replace the V-belt of the cutting deck.						X	
Do a check of the oil level in the bevel gear.					X		
Replace the oil in the bevel gear.						X	
Do a check of the parallelism of the cutting deck.			X	X			
<b>Wheels and transmissions</b>							
Examine and tighten the wheel nuts with the correct torque. (84 Nm)			*		*		
Do a check of/adjust front and rear wheel speed.				○			
Make sure that the tire pressure is correct. Refer to <i>Technical data on page 58</i> .		X					
Replace the oil in the transmissions						*	
Lubricate the wheel axles splines				○			
Do a check of the oil level in the transmissions and clean the magnetic plug.						*	

## To clean the product



**CAUTION:** Do not use a high-pressure washer or a steam cleaner. Water can go into bearings and electrical connections and cause corrosion which causes damage to the product.

- Clean the product immediately after use.
- Do not clean hot surfaces such as the engine, muffler and exhaust system. Wait until the surfaces are cool, then remove the grass or dirt.
- Before you clean with water, clean with a brush. Remove grass cuttings and dirt on and around the transmission, the air intake, and the engine.

- Use running water from a hose to clean the product. Do not use high pressure.
- Do not point the water at electrical components or bearings. Detergent usually increases the damage.
- To clean the cutting deck, put it in the servicing position and clean it with a water hose.
- When the product is clean, start the cutting deck for a short period to remove remaining water.

## To clean the engine and the muffler

Keep the engine and muffler free from grass cuttings and dirt. Grass cuttings soaked in fuel or oil on the engine can increase the fire risk and the risk that the engine becomes too hot. Let the engine cool before it is cleaned. Clean with water and a brush.

Grass cuttings around the muffler dry quickly and are a fire risk. Use a brush or remove the grass cuttings with water when the muffler is cold.

### To clean the cold air intake of the engine

- Make sure that the cold air intake grille is not blocked. Remove grass and dirt with a soft brush.

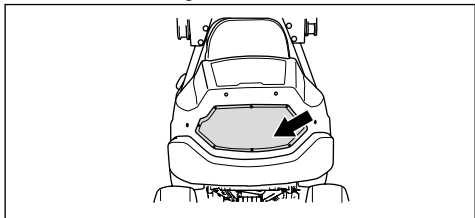

### To remove the covers

#### To remove and install the front cover of the steering column

1. Remove the 2 screws and tilt the front cover of the steering column forward.

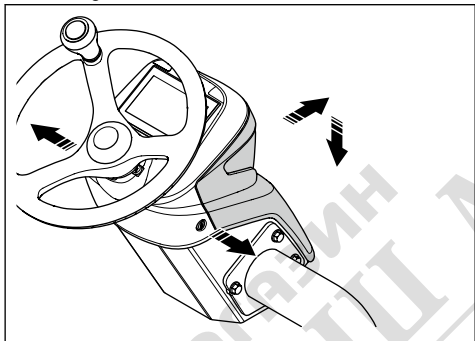

2. Disconnect the wires.

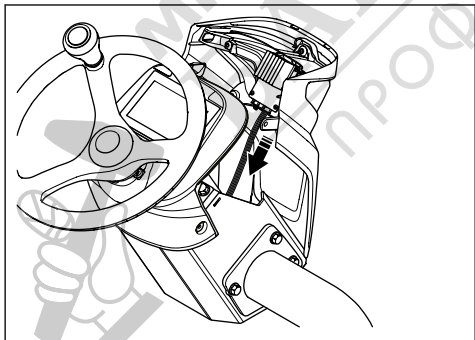

3. Hold the front cover of the steering column in a vertical position and remove it.

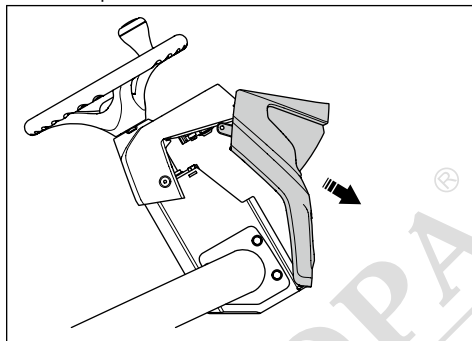

4. Install in opposite sequence.

#### To open the engine cover

1. Remove the rubber straps on both sides of the engine cover.
2. Open the engine cover rearward.

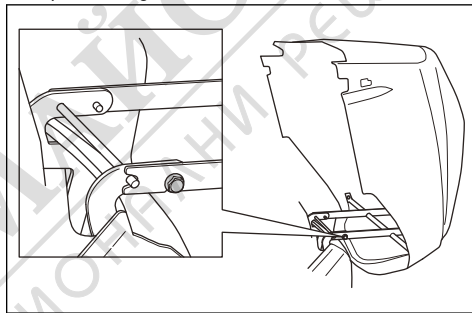

**Note:** To remove the engine cover fully, remove the bolts by the hinges.

#### To remove the service lid

1. Turn the 2 screws ¼ turn counterclockwise to open them.

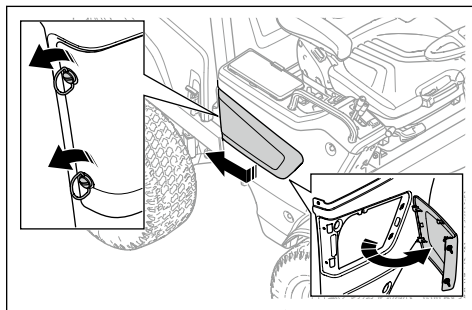

2. Pull the service lid rearward to release it from the hooks.

### To remove the cover of the control box

1. Turn the 3 screws  $\frac{1}{4}$  turn counterclockwise and remove the cover.

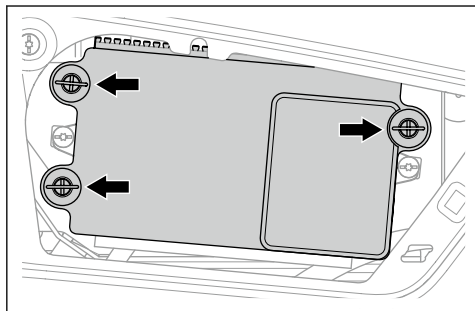

### To remove the right side cover

1. Remove the 5 screws and remove the side cover.

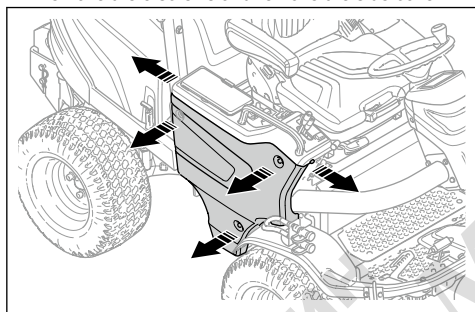

### To remove the service hatch

1. Turn the 2 screws  $\frac{1}{4}$  turn and lift off the service hatch.

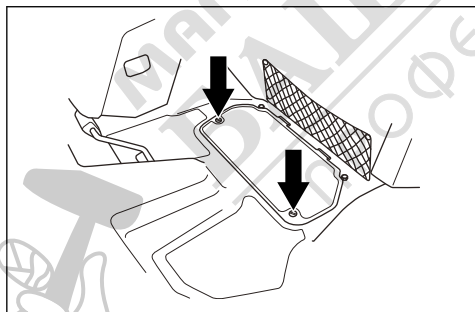

### To remove the cover plate

1. Remove the 2 screws and remove the cover plate.

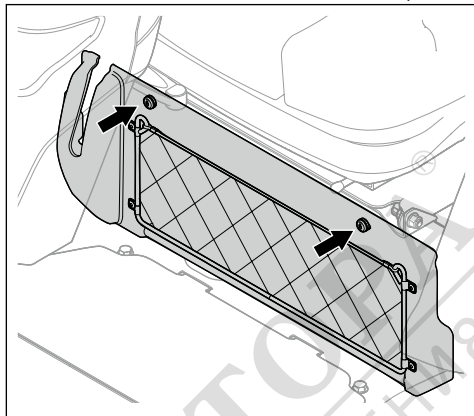

### To remove the transmission cover

1. Remove the 4 screws.

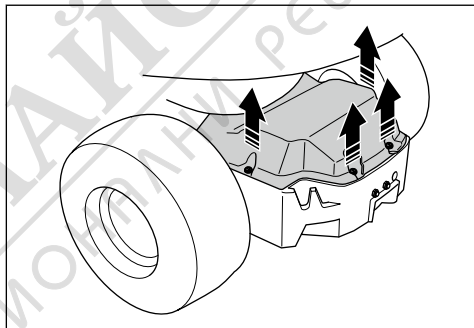

2. Lift and remove the transmission cover.

### To replace the headlights

1. Remove the front cover of the steering column.  
Refer to *To remove and install the front cover of the steering column* on page 30.
2. Remove the 3 screws of the headlights.

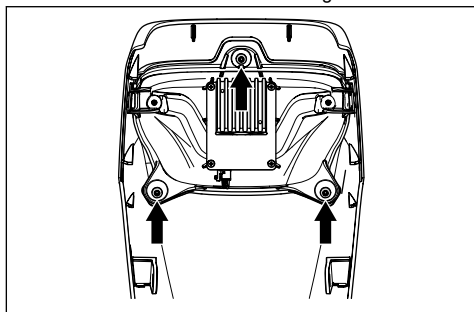

3. Remove the headlights.
4. Assemble in opposite sequence.

### To replace a low and high beam lamp (P 525DX Cabin)

1. Remove the 4 screws that hold the lamp module and lift it out.

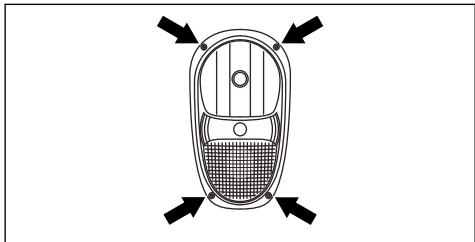

2. Disconnect the cables from the broken lamp.
3. Push the spring lock and remove the lamp.

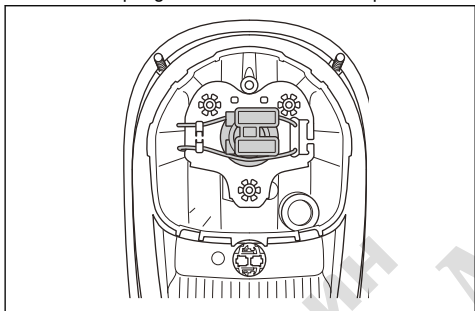

4. Put the new lamp into the lamp housing. Refer to *Technical data on page 58*.
5. Connect the cables to the new lamp.
6. Attach the lamp module and tighten the screws.

### To replace a parking lamp

1. Remove the 4 screws that hold the lamp module and lift it out.
2. Disconnect the cables from the broken lamp.
3. Remove the lamp.
4. Put the new lamp into the lamp housing. Refer to *Technical data on page 58*.
5. Connect the cables to the new lamp.
6. Attach the lamp module and tighten the screws.

### To replace a turn signal lamp

1. Remove the 4 screws that hold the lamp module and lift it out.
2. Disconnect the cables from the broken lamp.

3. Turn the lamp counterclockwise and remove the lamp.

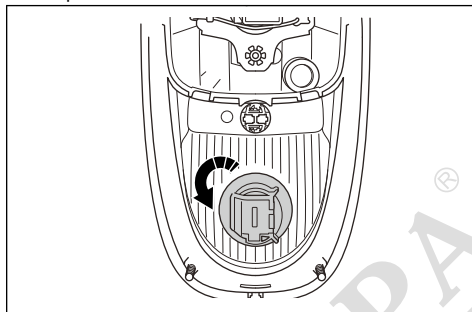

4. Put the new lamp into the lamp housing. Refer to *Technical data on page 58*.
5. Connect the cables to the new lamp.
6. Attach the lamp module and tighten the screws.

### To replace the front work lights (P 525DX Cabin)

1. Disconnect the cables from the broken lamp.

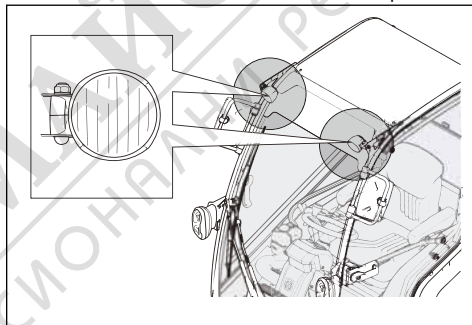

2. Turn the lamp counterclockwise and remove the lamp.

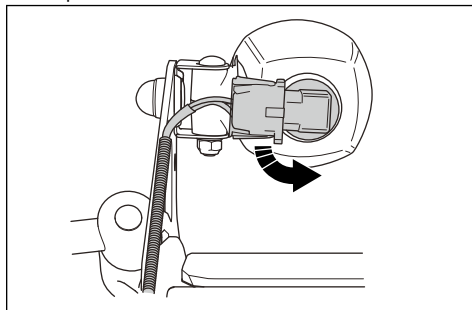

3. Put the new lamp into the lamp housing. Refer to *Technical data on page 58*.
4. Connect the cables to the new lamp.

## To replace the rear work lights (P 525DX Cabin)

1. Disconnect the cable from the broken lamp.

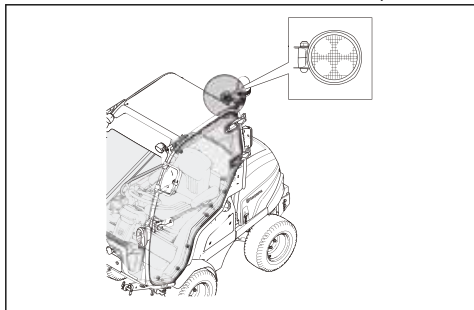

2. Remove the screw on the lamp connector.
3. Remove the lamp connector with the lamp attached.
4. Install in the opposite sequence.

## To replace the rear lights (P 525DX Cabin)

1. To replace the rear lights, contact an approved service agent.

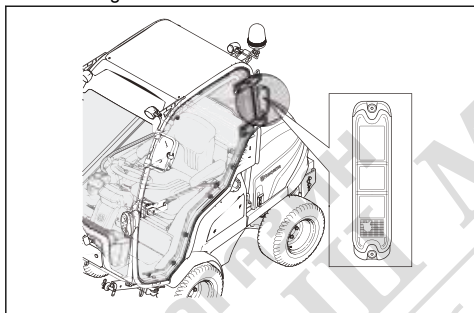

## To replace the warning lights (P 525DX Cabin)

1. Loosen the wing nut.

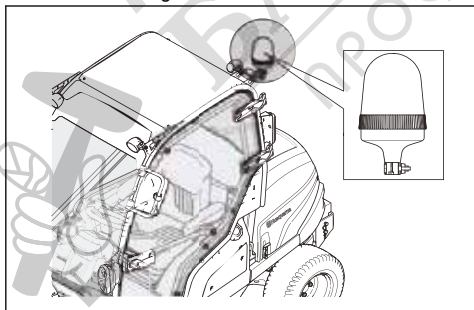

2. Remove the lamp.
3. Attach the new lamp.

## To do a check of the parking brake

1. Park the product on a hard surface that slopes maximum 10°.

**Note:** Do not park the product on a grass slope when you do a check of the parking brake.

2. Push the parking brake forward.

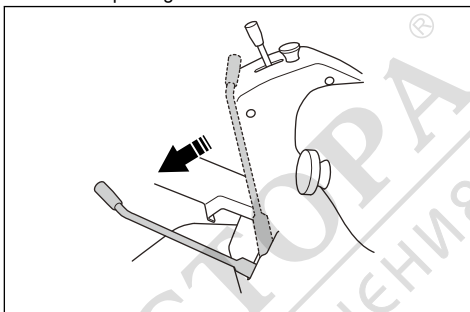

3. If the product starts to move, let an approved service agent adjust the parking brake.
4. Pull the parking brake rearward to release the parking brake.

## To do a check of the parallelism of the cutting deck

1. Do a check of the air pressure in the tires. Refer to *Tire pressure on page 40*.
2. Park the product on a level surface.
3. Lower the cutting deck to mow position.
4. Set the cutting height lever to the middle position.
5. Measure the distance between the ground and the front and rear edges of the cutting deck.
  - a) Measure Combi 132 and Combi 155 in 2 areas. Make sure that the rear edge is 6–9 mm ( $\frac{1}{4}$ – $\frac{3}{8}$  in.) higher than the front edge.

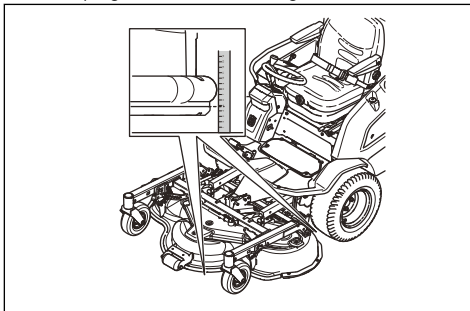

- b) Measure Combi 132 X and Combi 155 X in 4 areas. Make sure that the rear edge is 6–9 mm ( $\frac{1}{4}$ – $\frac{3}{8}$  in.) higher than the front edge.

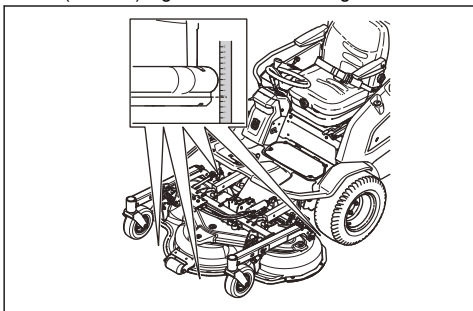

6. Adjust the cutting deck if it is necessary. Refer to *To adjust the parallelism of the cutting deck on page 34.*

### To adjust the parallelism of the cutting deck

1. Turn the track rod to extend it or make it shorter. Extend the track rod to lift the rear edge of the cutting deck. Make the track rod shorter to lower the rear edge of the cutting deck.

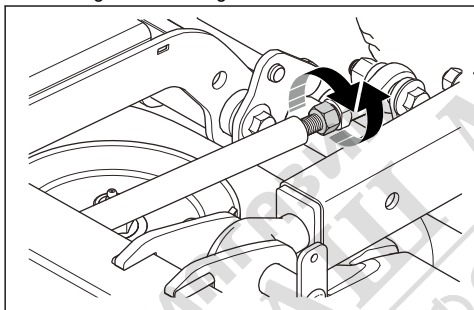

---

**Note:** For Combi 132 X, Combi 155 X, adjust the track rods on the 2 sides.

---

2. Tighten the nuts on the track rod.
3. Do a check of the parallelism. Refer to *To do a check of the parallelism of the cutting deck on page 33.*



## Fuel system overview

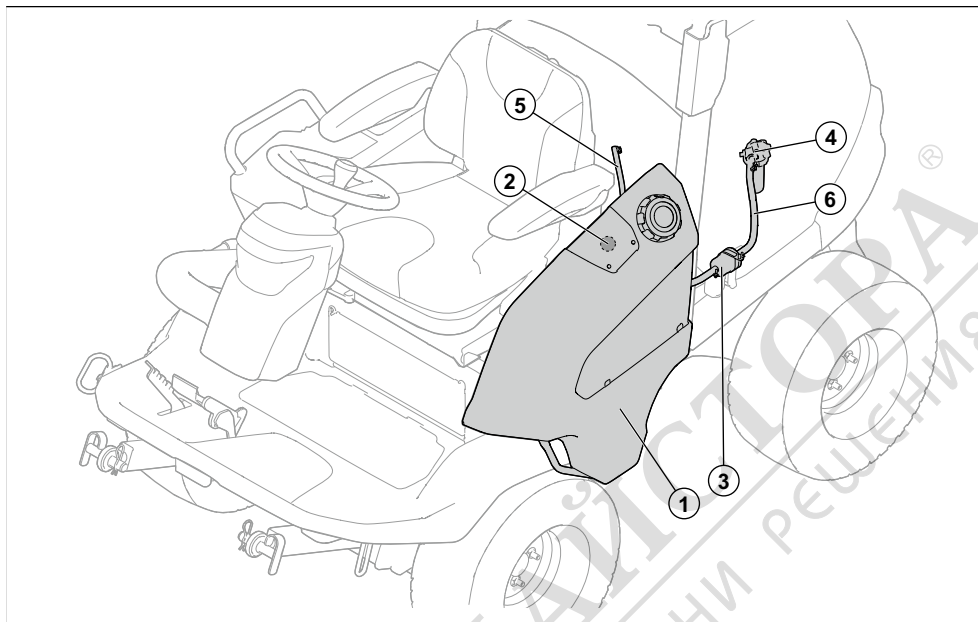

1. Diesel fuel tank
2. Electric fuel gauge
3. Prefilter
4. Fuel filter
5. Fuel return hose
6. Fuel hose

5. Remove the paper filter.

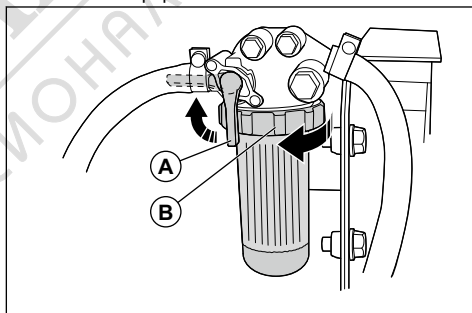

### To replace the fuel filters

#### To replace the paper filter in the main filter

1. Open the engine cover. Refer to *To open the engine cover on page 30*.
2. Remove the air filter. Refer to *To clean and replace the air filter on page 36*.
3. Close the fuel valve (A).
4. Turn the locknut (B) ½ a turn counterclockwise and remove the filter housing.

6. Put a new paper filter in the filter housing.
7. Turn the locknut ½ a turn clockwise to attach the filter housing.

#### To replace the fuel prefilter

You find the fuel prefilter below the battery housing on the left side of the product.



**WARNING:** Use protective gloves to prevent skin irritation. Fuel can come from the fuel filter and onto your skin.

1. Remove the screw to the clamp that holds the fuel prefilter in position.

2. Pull the fuel filter out from the clamp.
3. Loosen the screws to the hose clips.
4. Move the hose clips away from the fuel prefilter with a pair of flat pliers.
5. Pull off the fuel prefilter from the hose ends. There is a risk of a small fuel leak.

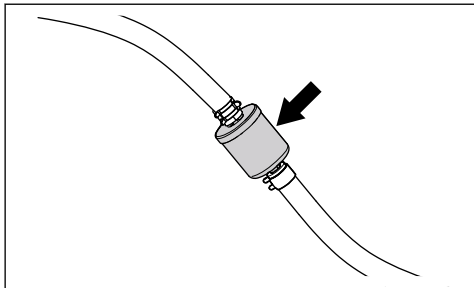

6. Make sure that the new fuel prefilter is in the correct direction for the fuel flow. Push the new fuel prefilter into the ends of the hoses. Apply liquid detergent to the ends of the fuel prefilter to make the connection easier.

7. Push the hose clips against the fuel prefilter.

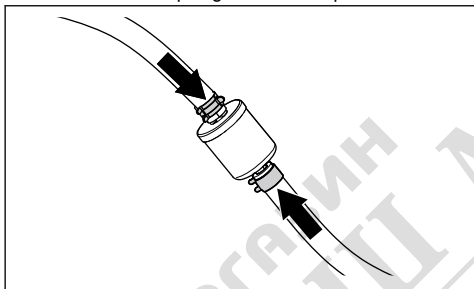

8. Tighten the screws to the hose clips and install the fuel prefilter in the clamp.

## To clean and replace the air filter



**CAUTION:** Do not start the engine when the air filter is removed.

1. Open the engine cover.

2. Loosen the 2 latches that hold the air filter cover.

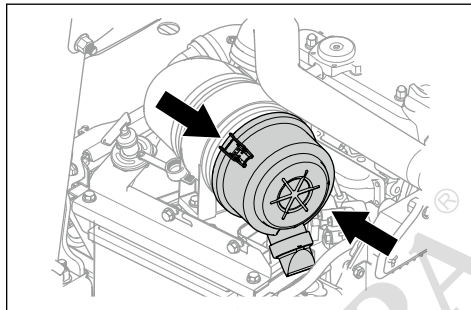

3. Remove the air filter cover.
4. Remove the air filter cartridge from the filter housing.

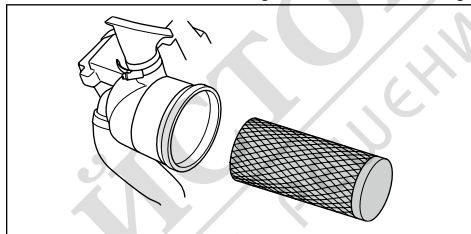

5. Clean the inner surface of the air filter housing with a dry cloth.
6. Hit the air filter cartridge carefully against a hard surface. Replace the air filter if it cannot be fully cleaned or if it is damaged.



**CAUTION:** Do not use compressed air to clean the air filter.

7. Put the air filter cartridge in its initial position in the filter housing. Make sure that the air filter cartridge is correctly installed on the top of the air intake.
8. Install the air filter cover and make sure that the particle collector points down.

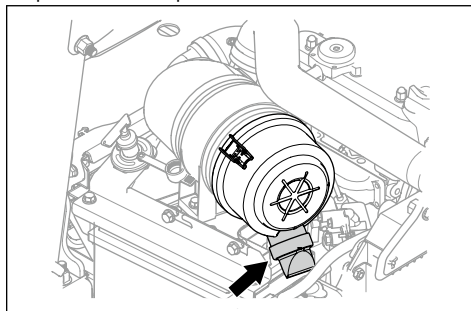

## To clean and replace the inlet filter on the cabin heat

1. Loosen the 2 knobs on the fan system cover and remove the cover.

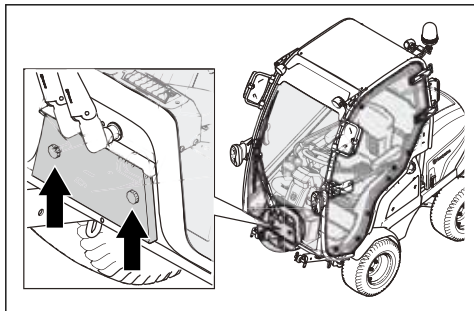

2. Pull out the filter holder.
3. Lift out the inlet filter.
4. Carefully clean the inlet filter with a brush.
5. If the inlet filter does not become clean, replace it.
6. Put the inlet filter into the filter holder.
7. Attach the filter holder and tighten the knobs.

## Electrical system overview

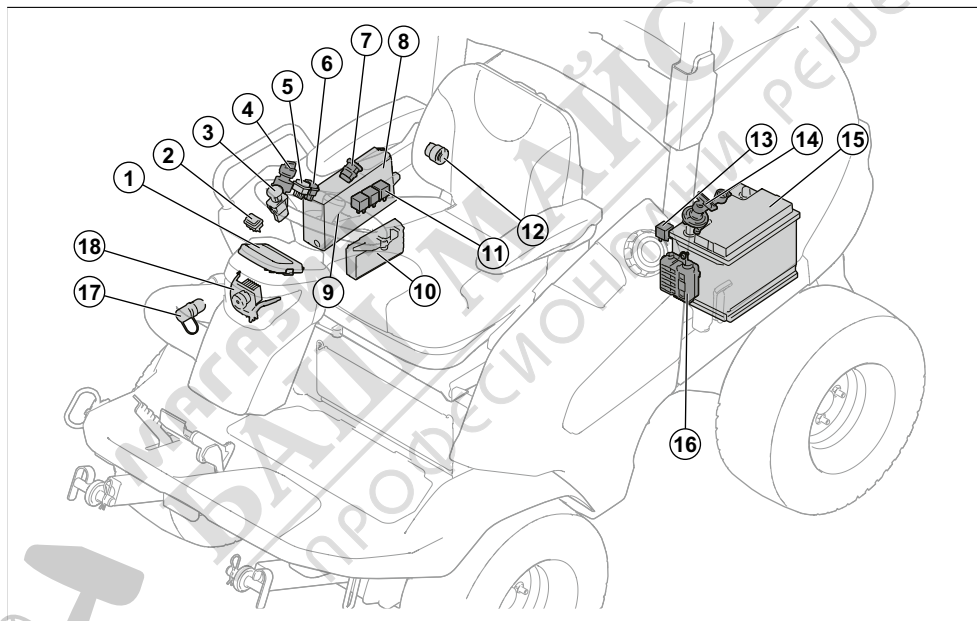

- |  |  |
|--|--|
| 1. Display   | 10. Mower control module                           |
| 2. Function button for hydraulic accessories (accessory for P 520DX) | 11. Relay  |
| 3. PTO button  | 12. Power outlet, 12 V                             |
| 4. Ignition key  | 13. Relay  |
| 5. Headlight indicator   | 14. Main switch                                    |
| 6. Power switch for the power outlet                                 | 15. Battery  |
| 7. USB outlets   | 16. Fuse box                                       |
| 8. Control box   | 17. AUX power outlet, 12 V (accessory for P 520DX) |
| 9. Servicing connector   | 18. Headlights                                     |

## Fuse overview

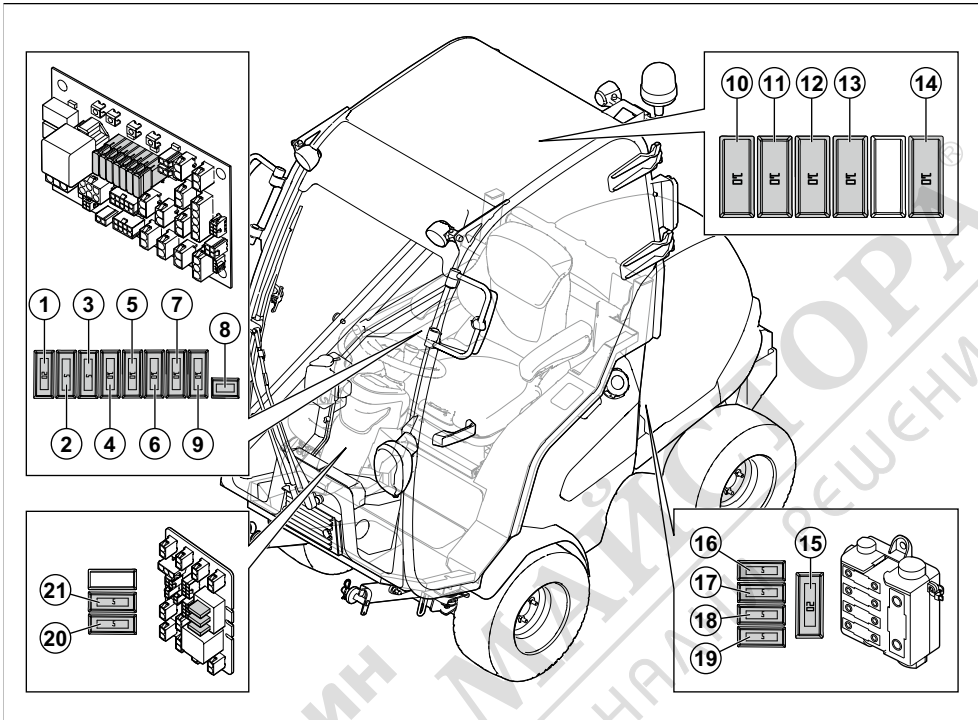

1. 12 V power to the mower control module, 20 A
2. Diesel display power, 5 A
3. Ignition power, 5 A
4. J14 + 12 V, beacon light, 10 A
5. J16 + 12 V, Extra switch, Extra out, Hydraulic power, 10 A
6. Parking brake / Seat, 10 A
7. Light power, 10 A
8. Cabin power, auto fuse
9. USB, 12 V outlet, 12 V switch power, 10 A
10. Windshield wiper, 10 A (P 525DX Cabin)
11. Cabin heat, 10 A (P 525DX Cabin)
12. Rear work light, 10 A (P 525DX Cabin)
13. Low beam light, 10 A (P 525DX Cabin)
14. Front work light, 10 A (P 525DX Cabin)
15. High power safety fuse, 150 A
16. Empty
17. Cabin power fuse, 50 A (P 525DX, P 525DX Cabin)
18. Power engine/Glow plug fuse, 50 A
19. Fuse for control board power supply, 50 A
20. Buzzer, 5 A
21. Parking light, 5 A

### To replace a fuse

A broken fuse is identified by a burned fuse wire.

The list of fuses can be found in the fuse overview, refer to *Fuse overview on page 38*.

1. Find the broken fuse:
  - a) Remove the right side cover to replace fuses 1–9. Refer to *To remove the right side cover on page 31*.

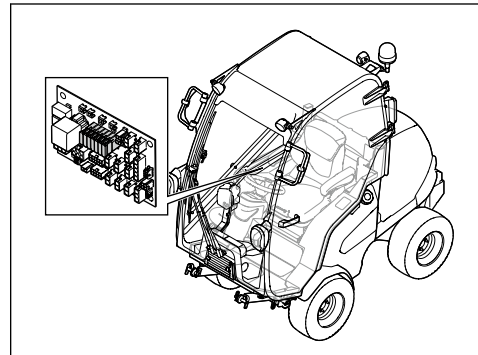

- b) Remove the cover in the cabin roof to replace fuses 10–14.

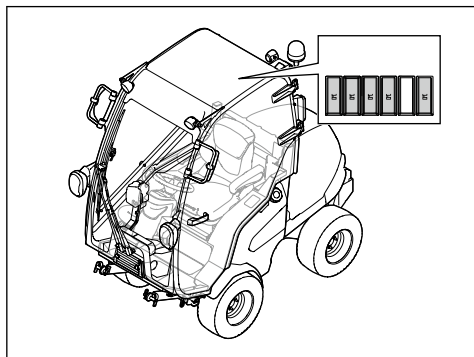

- c) Open the engine cover to replace fuses 15–19. Refer to *To open the engine cover on page 30*. The fuses are in the fuse box in front of the battery.

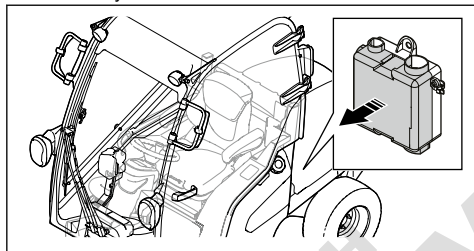

- d) Remove the front cover of the steering column to replace fuses 20–21. Refer to *To remove and install the front cover of the steering column on page 30*.

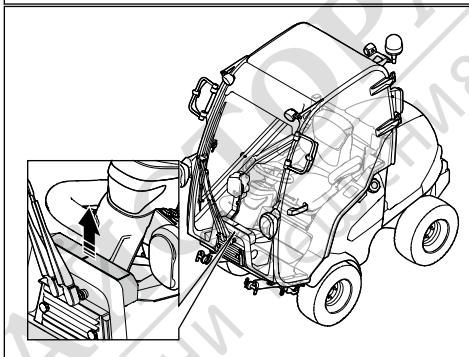
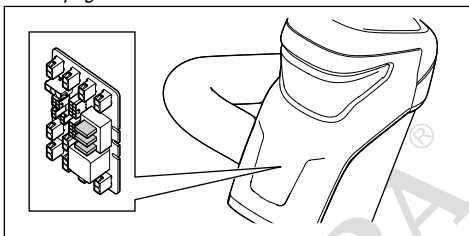

- e) For P 525DX Cabin, to get access to the front cover remove the 4 screws on the air circulation unit. Remove the air circulation unit.
2. Pull the fuse from the holder.
  3. Replace the broken fuse with a new fuse of the same type. Refer to *Fuse overview on page 38*.
  4. Attach the covers.

**Note:** If the main fuse breaks again a short period after you replace it, there is a short circuit. Repair the short circuit before you operate the product again. Let an approved service agent help you.

## To charge the battery

- Charge the battery if it is too weak to start the engine.
- Use a standard battery charger.



**CAUTION:** Do not use a boost charger or start booster. That will cause damage to the electrical system of the product.

- Always disconnect the charger before starting the engine.



## To do an emergency start of the engine

If the battery is too weak to start the engine, you can use jumper cables to do an emergency start. This product has a 12 V system with negative ground. The product that is used for the emergency start must also have a 12 V system with negative ground.

### To connect the jumper cables



**WARNING:** Risk of explosion because of explosive gas that comes from the battery. Do not connect the negative terminal of the fully charged battery to or near the negative terminal of the weak battery.



**CAUTION:** Do not use the battery of your product to start other vehicles.

1. Open the engine cover. Refer to *To open the engine cover on page 30*.
2. Connect one end of the red cable to the POSITIVE battery terminal (+) on the weak battery (A).

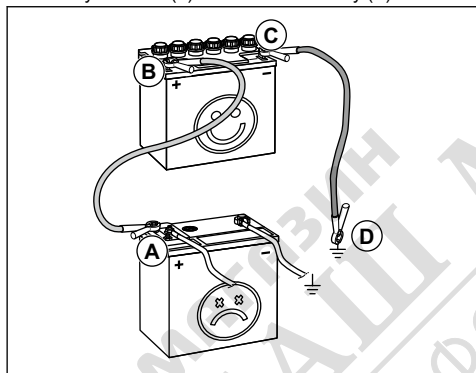

3. Connect the other end of the red cable to the POSITIVE battery terminal (+) on the fully charged battery (B).



**WARNING:** Do not short circuit the ends of the red cable against the chassis.

4. Connect one end of the black cable to the NEGATIVE battery terminal (-) on the fully charged battery (C).
5. Connect the other end of the black cable to a CHASSIS GROUND (D), away from the fuel tank and the battery.
6. Replace the covers.

## To remove the jumper cables

**Note:** Remove the jumper cables in the opposite sequence to how you connect them.

1. Remove the BLACK cable from the chassis.
2. Remove the BLACK cable from the fully charged battery.
3. Remove the RED cable from the 2 batteries.

## Tire pressure

Refer to *Technical data on page 58* for the correct tire pressure.

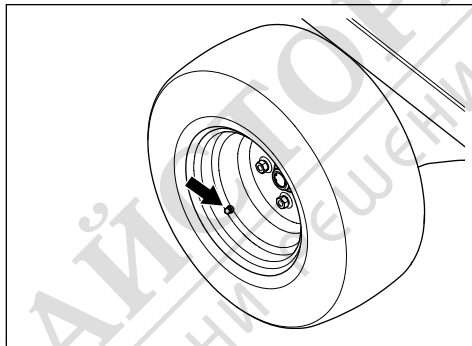

## To put the cutting deck in servicing position

1. Do the procedure in *To remove the cutting deck on page 16* but do not disconnect the lift arms.
2. Remove the service stay from the cutting deck.

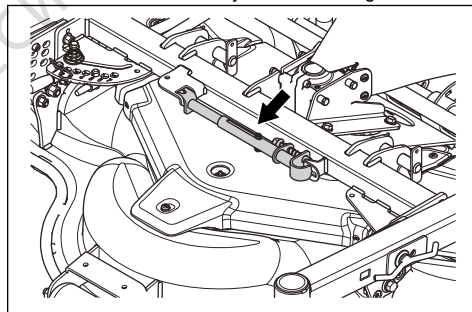

**WARNING:** Attach the service stay and the safety straps when the cutting deck is in servicing position. To not use the service stay or safety straps correctly can result in serious injury or death.

3. Attach the service stay to the red point below the bottom plate.

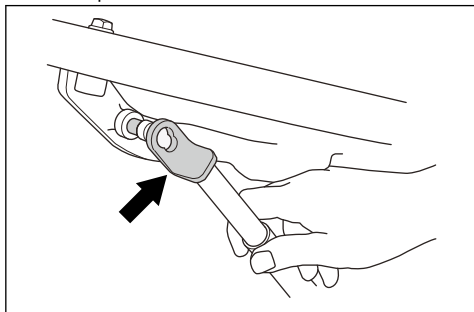

4. Pull the pin on the other end of the service stay. Attach the service stay to the red mark on the pipe on the cutting deck.

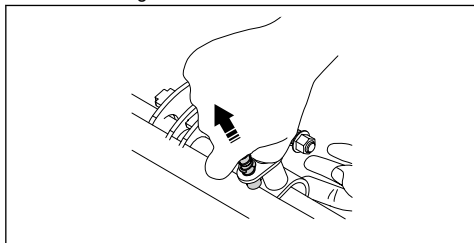

5. Start the engine.
6. Move the lever for the hydraulic lift arms rearward to lift the cutting deck fully.
7. Attach 1 end of the safety straps around the pipe adjacent to the steering column (A).

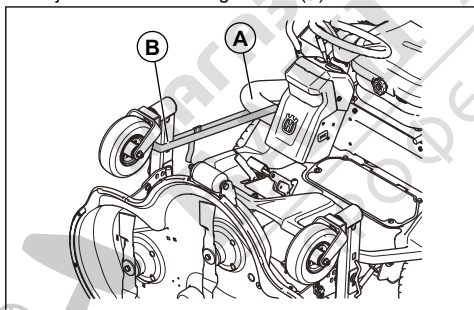

8. Attach the other end of the safety strap around the pivoting wheels of the cutting deck (B).
9. To put the cutting deck in mow position, follow the instructions in the opposite sequence.

## To replace the belt on the cutting deck

1. Remove the 3 screws that hold the belt cover.
2. Remove the belt cover.
3. Attach the service stay to the tension spring.
4. Push the service stay and remove the belt.

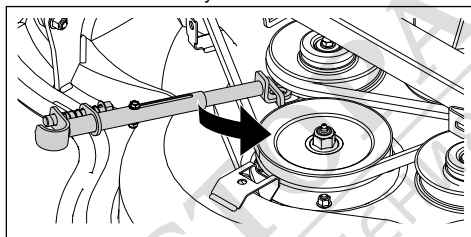

5. Attach the belt around the pulleys as shown in the illustration.

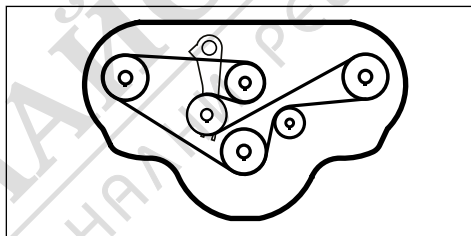

## PTO system overview

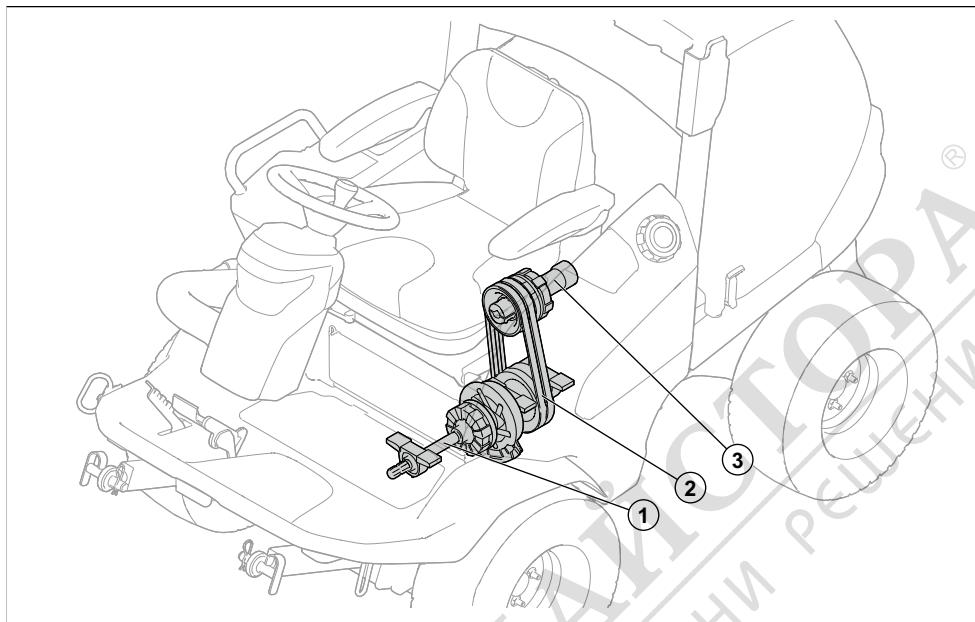

1. PTO shaft
2. Belts
3. Hydraulic pump drive shaft

### To adjust the PTO belts

1. Release the locknut (A).
2. Tighten the adjustment screw (B) until the sleeve (C) cannot be rotated by hand.
3. Hold the adjustment screw (B) and tighten the locknut (A).

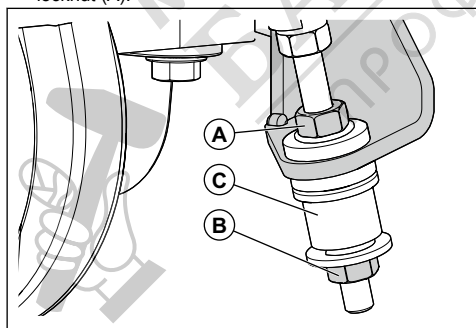

### To remove and attach the BioClip® plug

1. Put the cutting deck in servicing position.

2. Remove the 3 screws that hold the BioClip® plug and remove the plug.

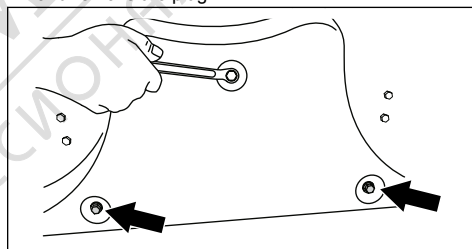

3. Attach 3 M8x15 mm screws in the screw holes for the BioClip® plug to prevent damage to the threads.
4. Put the cutting deck in mow position.
5. Attach the BioClip® plug in the opposite sequence.

### To examine the blades



**CAUTION:** Damaged or incorrectly balanced blades can cause damage to the product. Replace damaged blades. Let an approved service agent help you sharpen and balance blunt blades.

1. Put the cutting deck in servicing position.

- Look at the blades to see if they are damaged and if it is necessary to sharpen them.

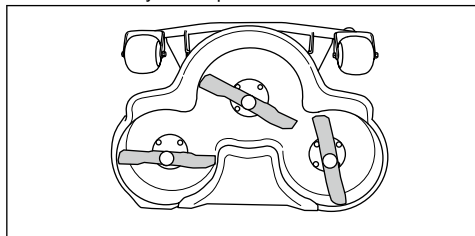

- Tighten the blade bolts with the correct tightening torque. Refer to *Technical data on page 58*.

## To replace the blades

- Put the cutting deck in servicing position.
- Lock the blade with a wooden block (A).

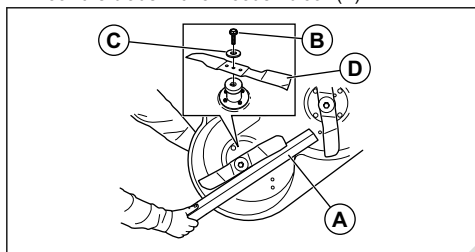

- Loosen and remove the blade bolt (B), the washers (C) and the blade (D).
- Install the new blade with the pointed ends in the direction of the cutting deck.



**WARNING:** Incorrect blade type can cause objects to eject from the cutting deck and cause serious injury. Use only the blades given in *Technical data on page 58*.

- Install the washer and the bolt to attach the blade. Tighten the bolt with the correct torque. Refer to *Technical data on page 58*.

## To do a check of the engine oil level

- Park the product on level ground and stop the engine.
- Open the engine cover.
- Loosen the dipstick and pull it out.
- Clean the oil from the dipstick.
- Put the dipstick in the dipstick opening.
- Pull the dipstick out and read the oil level.

- The oil level must be between the marks on the dipstick.

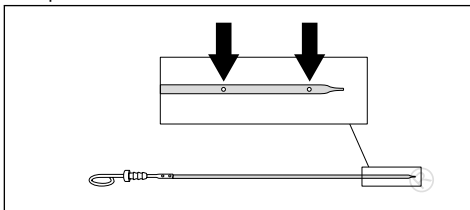

- If the oil level is low, fill with engine oil and do a check of the oil level again.

**Note:** See *Technical data on page 58* of engine oil recommended. Do not mix different types of oil.

- Tighten the dipstick correctly before you start the engine. Start and idle the engine for approximately 30 seconds. Stop the engine. Wait 30 seconds and do a check of the oil level again.

## To change the engine oil and the oil filter

If the engine is cold, start the engine for 1–2 minutes before you drain the engine oil. This makes the engine oil warm and easier to drain.



**WARNING:** Do not operate the engine for more than 1–2 minutes before you drain the engine oil. The engine oil becomes very hot and can cause burn injuries. Let the engine become cool down before you drain the engine oil.



**WARNING:** If you spill engine oil on your body, clean with soap and water.

- Put a container below the oil drain plug on the left side of the engine.

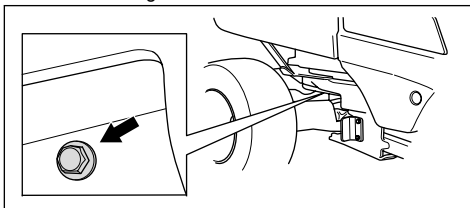

- Remove the oil drain plug.
- Remove the dipstick.
- Drain the oil into the container.
- Put a new gasket on the oil drain plug. Attach the oil drain plug and tighten it.

6. Turn the oil filter counterclockwise to remove it.

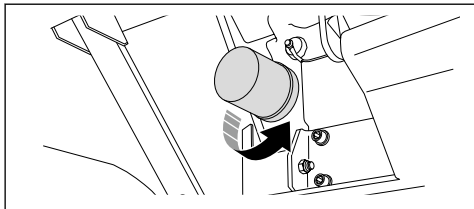

7. Lightly lubricate the rubber seal on the new oil filter with new oil.
8. To attach the oil filter, turn it clockwise by hand until the rubber seal is in position, then tighten a half turn more.
9. Fill with new oil as given in *Technical data on page 58*.
10. Start the engine and let it run at idle speed for 3 minutes.
11. Stop the engine and make sure that the oil filter does not leak.
12. Do a check of the oil level.

**Note:** For safe disposal of used engine oil, see *Disposal on page 57*.

## To do a check of the transmission oil level

1. Use the oil dipstick to read the oil level in the transmission.

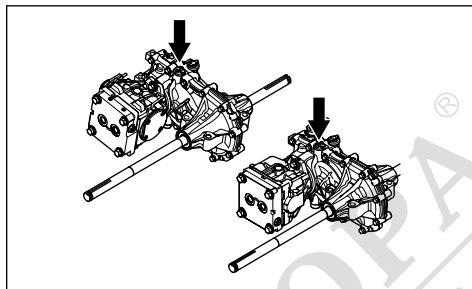

2. The oil level must be between the marks on the dipstick.

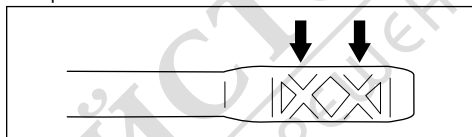

3. If the oil level is too low, fill with the type of oil given in *Technical data on page 58*.



# Hydraulic overview

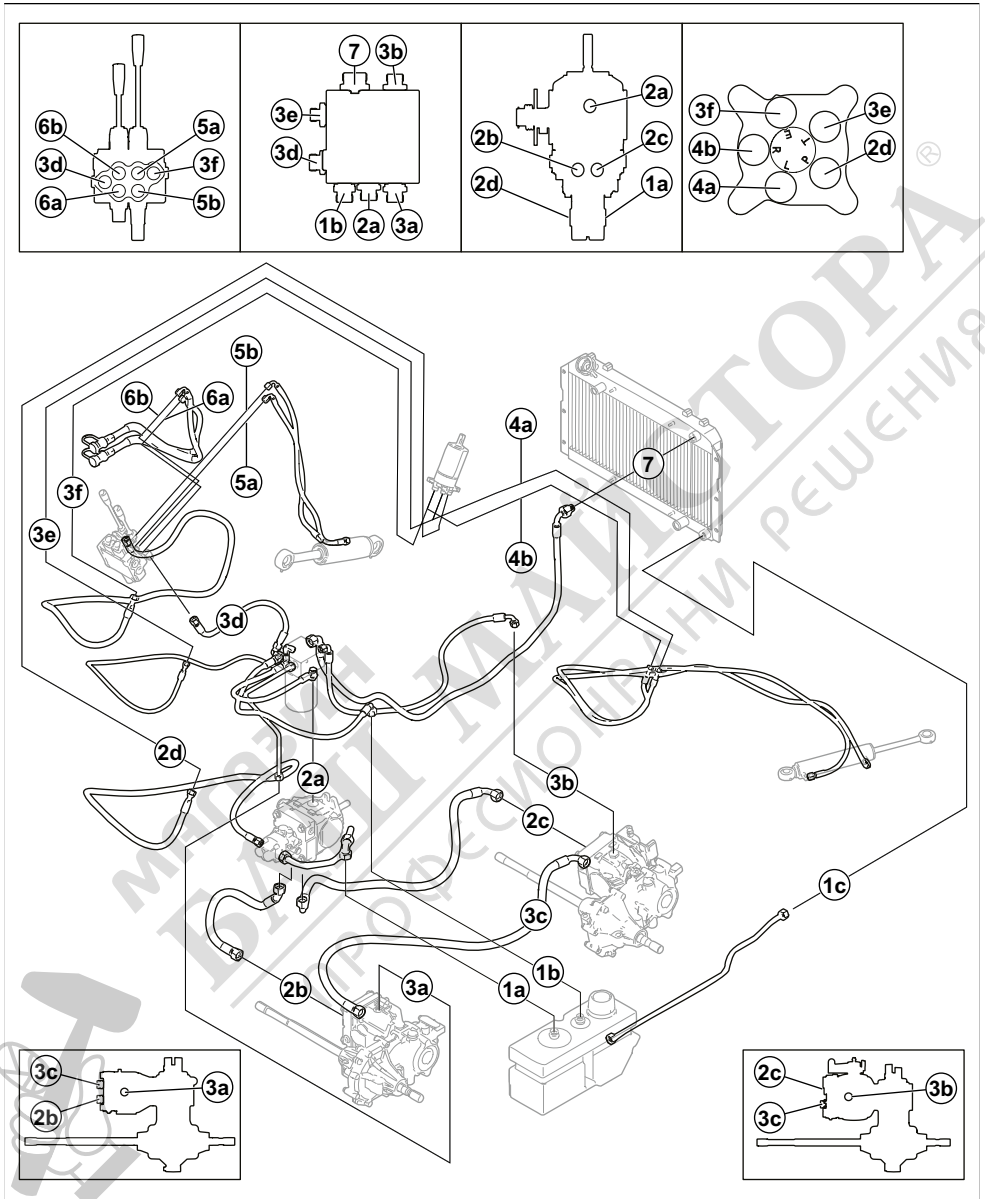

1a: Hydraulic tank – pump

1b: Hydraulic tank – filter

1c: Hydraulic tank – hydraulic oil cooler

2a: Filter – valve block

2b: Filter – pump

2c: Front transmission – pump

- 2d: Pump – power steering
- 3b: Front transmission – filter
- 3a: Rear transmission – filter
- 3c: Rear transmission – front transmission
- 4a: Power steering – steering cylinder
- 4b: Power steering – steering cylinder
- 5a: Valve block – lift cylinder
- 5b: Valve block – lift cylinder
- 6a: Valve block – Cutting deck coupling
- 6b: Valve block – Cutting deck coupling
- 7: Filter – hydraulic oil cooler

## To do a check of the oil level in the hydraulic system

1. Tilt the seat forward. Refer to *To tilt the seat forward (P 520DX, P 525DX)* on page 21.
2. Clean the area around the oil tank cap with a dry cloth.
3. Remove the oil tank cap and examine the hydraulic oil level. Correct level is 40–60 mm from the top of the strainer.

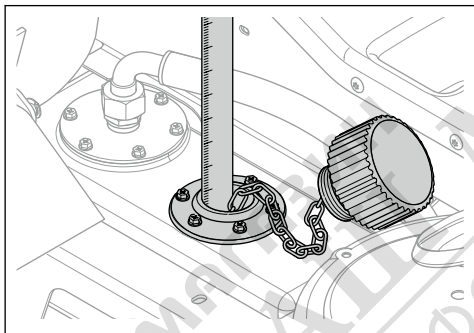

4. If the oil level is too low, fill with the type of oil given in *Technical data* on page 58.

## To do a check of the oil level in the bevel gear of the cutting deck

1. Park the product on a level surface.
2. Lower the cutting deck to mow position.

3. Put a clean metal rod into the gear housing. The metal rod must be a minimum of 100 mm long and maximum 3 mm in diameter.

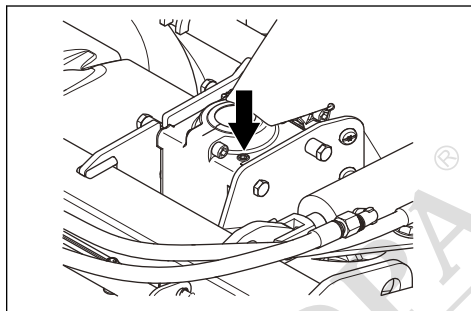

4. Lower the metal rod to the bottom of the gear housing.
5. Pull the metal rod out and read the oil level.
6. Measure the part of the metal rod that has oil on it. There must be oil on 15 mm of the metal rod.
7. Fill with gearbox oil if the oil level is less than 15 mm of the metal rod. Refer to *Quick maintenance guide* on page 48 for recommended oil.

## To replace the oil in the bevel gear of the cutting deck

1. Remove the cutting deck. Refer to *To remove the cutting deck* on page 16.
2. Put the cutting deck on its front edge and drain the oil through the oil fill plug.
3. Drain the oil into a container.
4. Fill with 80 ml new hydraulic oil as given in *Technical data* on page 58.
5. Do a check of the oil level. Refer to *To do a check of the oil level in the bevel gear of the cutting deck* on page 46.

## To do a check of the coolant level

1. Park the product on level ground and stop the engine.
2. Open the engine cover. Refer to *To open the engine cover* on page 30.
3. Open the coolant cap.

4. Do a check of the coolant level. Fill the coolant tank if it is necessary. Refer to *Technical data on page 58*.

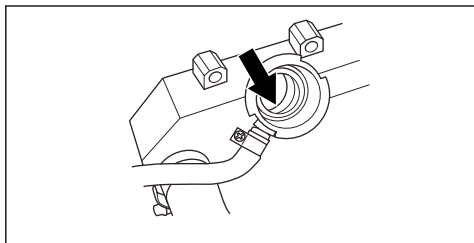

5. Do a check of the coolant level in the expansion tank. The level must be at the LOW mark when the engine is cold.

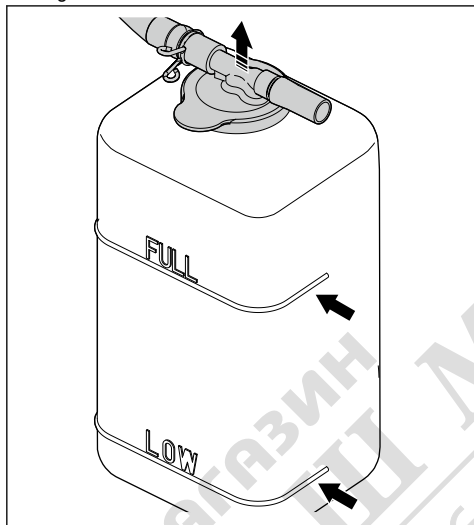

# QUICK MAINTENANCE GUIDE

First service after 50 hours

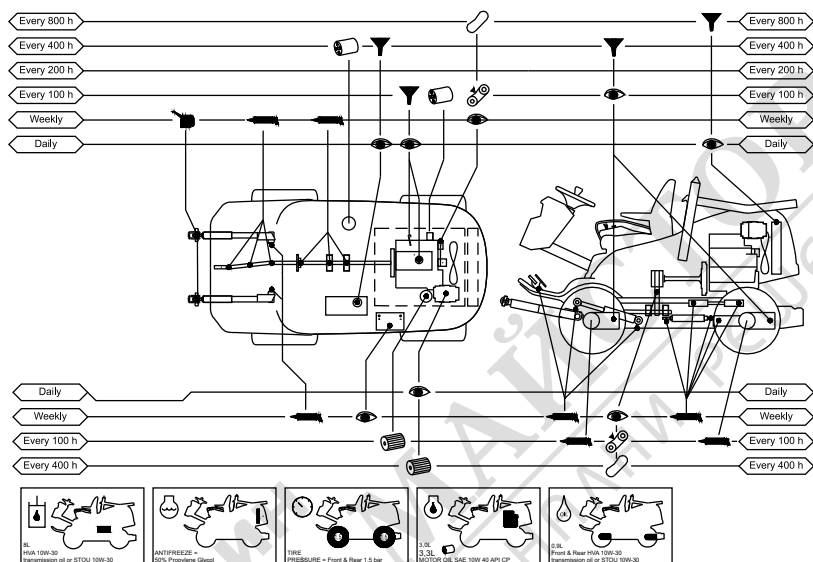

# QUICK MAINTENANCE GUIDE

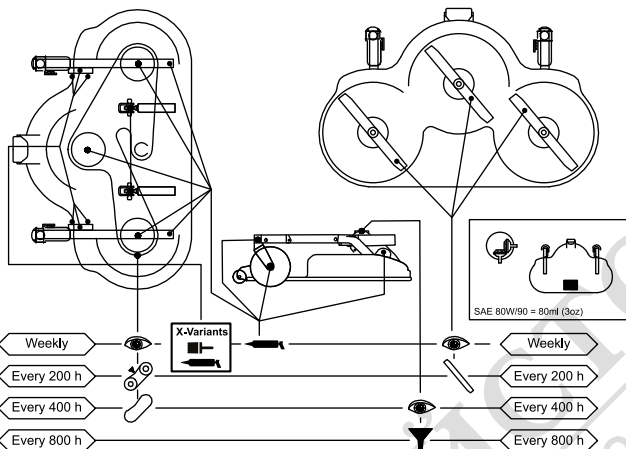

## Symbols on the quick maintenance guide



Replace the filter



Replace the oil



Examine visually or do a check of the oil level



Lubricate the grease nipple with grease



Lubricate with engine oil



Do a check of the condition and tension of the drive belt



Replace the drive belt



Replace the blades

## Lubrication overview

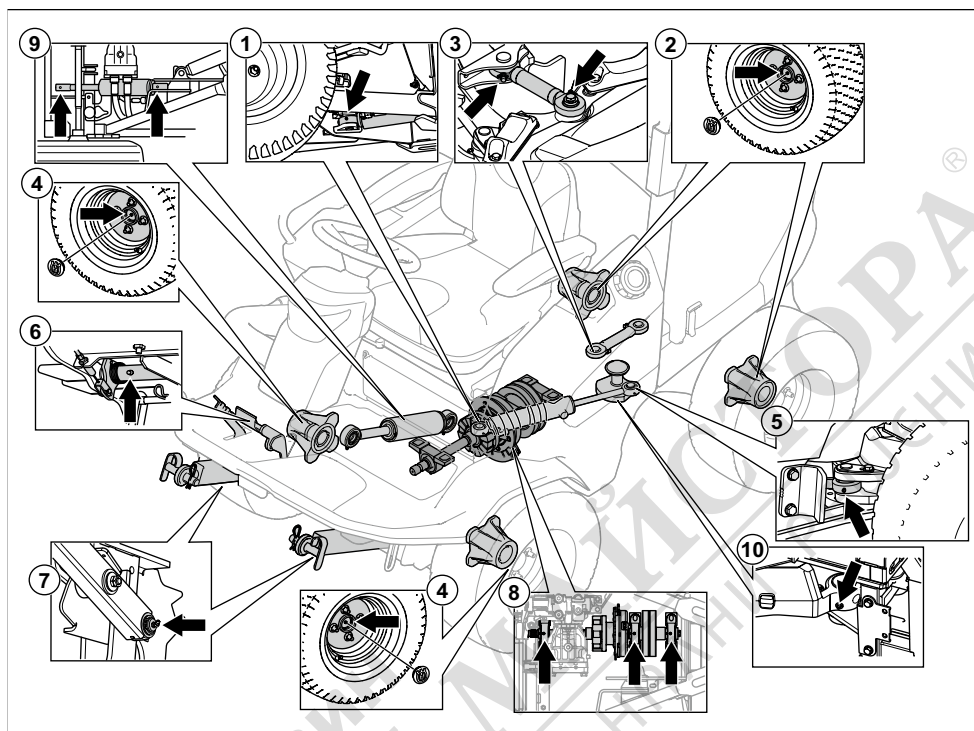

For 1–7, use calcium grease.

For 8, use lithium complex grease.

1. Steering cylinder - front
2. Rear axle splines
3. Control stay
4. Front axle splines
5. Steering cylinder - rear
6. Pedal shaft. Two positions.
7. Lift arms
8. Bearing housing (high temperature lithium grease)
9. Lift cylinder
10. Articulated steering joint

- Lubricate 2 times a week if you operate the product daily.
- Do not spill lubricant on the drive belts or the grooves of the belt pulleys. If you do spill, clean with alcohol. If the friction between the drive belt and the pulley is not sufficient after you clean with alcohol, replace the drive belt.



**CAUTION:** Do not use gasoline or other petroleum products to clean drive belts.

## Lubrication, general information

- Remove the ignition key to prevent accidental movements during lubrication.
- Clean the area before you lubricate a part on the product.
- Use engine oil when you lubricate with an oil can.
- When you lubricate with grease, use a chassis or ball bearing grease that prevents corrosion. Remove unwanted grease after lubrication.

## To lubricate the articulated steering joint

1. Lubricate the articulated steering bearing when the product has all wheels on the ground.

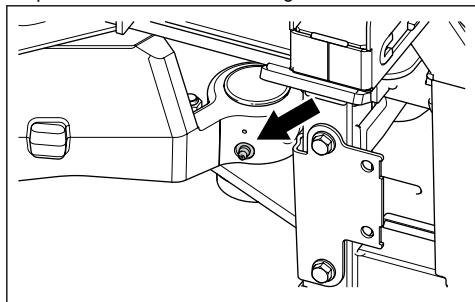

2. Lift the product to release the pressure in the articulated steering. The illustration shows where to put the supports.

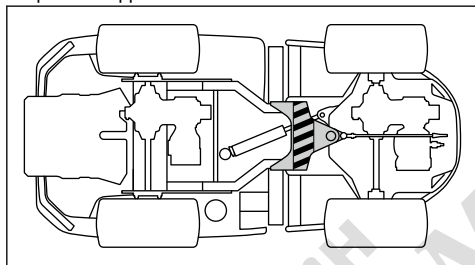

**CAUTION:** Make sure that the support does not cause damage to the

control stay or causes a blockage of the articulated steering.

3. Lubricate the articulated steering bearing again while the product is lifted.
4. Lower the product.

## To lubricate the drive shaft

1. Remove the service hatch. Refer to *To remove the service hatch on page 31*.
2. Lubricate the 4 grease nipples with a grease gun until grease comes out.

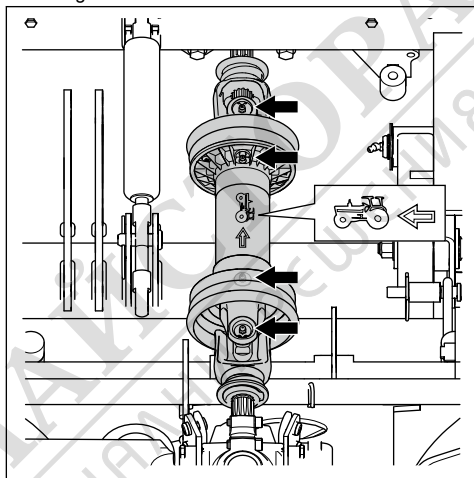

## Troubleshooting

### Troubleshooting

If you cannot find a solution to your problems in this manual, speak to your Husqvarna service agent.







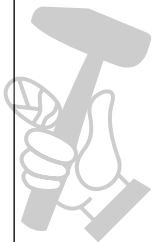

Problem	Cause
The starter motor does not turn the engine over	The PTO-button is activated.
	The parking brake is not applied. Refer to <i>To apply and release the parking brake on page 26</i> .
	The main fuse is blown. Refer to <i>To replace a fuse on page 38</i> .
	The ignition lock is defective.
	The connection between the cable and the battery is bad.
	The battery is too weak. Refer to <i>To charge the battery on page 39</i> .
	The starter motor is defective.

<b>Problem</b>	<b>Cause</b>
The engine does not start when the start motor turns the engine over	There is no fuel in the fuel tank. Refer to <i>To fill fuel on page 20.</i>
	There is air in the fuel system.
	Preheating is defective or too short
	The engine is defective.
	The fuel filter clogged. <i>To replace the fuel filters on page 35.</i> 
The engine does not run smoothly	The fuel filter is clogged. Refer to <i>To replace the fuel filters on page 35.</i>
	The air filter is clogged. Refer to <i>To clean and replace the air filter on page 36.</i>
	The fuel tank vent is blocked.
	The feed pressure is too low.
	The injector pipe is loose.
	The engine is defective.
	There is incorrect fuel type in the fuel tank.
	The relief valve is defective.
	The fuel injector is defective.
	The injection pump is defective.
	The feed pump is defective.
The engine overheats	The cold air intake or the cooling fins are blocked.
	The engine is overloaded.
	The coolant level is too low.
	The engine oil level is too low.
The product release black smoke	There is incorrect fuel type in the fuel tank.
	The air filter is clogged. Refer to <i>To clean and replace the air filter on page 36.</i>
	The injection pump is defective.
	The fuel injector is defective.
The product release blue smoke	The engine oil level is too high.
	The engine is defective.
The product release white smoke	The cylinder in the engine is defective.
	The engine oil level is too high.

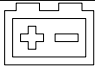
<b>Problem</b>	<b>Cause</b>
The engine apparently has no power	The air filter is clogged. Refer to <i>To clean and replace the air filter on page 36.</i>
	The fuel filter is clogged. Refer to <i>To replace the fuel filters on page 35.</i>
	There is air in the fuel system.
	The relief valve is defective.
	The feed pressure is too low.
	The feed pump is defective.
	The timing of the fuel injection pump is defective.
	The engine is defective.
The transmission does not have sufficient power	The bypass valves are not fully closed.
	There is no oil in the transmission or the oil level is too low. Refer to <i>To do a check of the transmission oil level on page 44.</i>
	The transmission oil is overheated.
The battery does not charge	The battery is defective. Speak to your Husqvarna service agent.
	The connection at the cable connectors on the battery terminals is bad.
There is vibration in the product	The blades are loose. Refer to <i>To examine the blades on page 42.</i>
	One or more of the blades are not balanced. Refer to <i>To examine the blades on page 42.</i>
	The engine is loose.
	The bevel gear is loose.
	The hydraulic pump is loose.
	The engine is defective.
	The drive shaft is defective.
	There is an object in the PTO belt pulleys.
	Rubber elements are hard or damaged.
The cutting result is unsatisfactory	The blades are blunt. Refer to <i>To examine the blades on page 42.</i>
	The grass is long or wet. Refer to <i>To get a good cutting result on page 26.</i>
	The cutting deck is skew.
	There is grass blockage in the cutting deck. Refer to <i>To put the cutting deck in servicing position on page 40.</i>
	The tire pressure is different on the right and left sides. Refer to <i>Tire pressure on page 40.</i>
	The product is operated at a too high speed. Refer to <i>To get a good cutting result on page 26.</i>
	The engine speed is too low. Refer to <i>Technical data on page 58.</i>
	The drive belt slips.



## Display - Troubleshooting

Symbol	Name	Shows on the display	Cause
	Indicator of engine water temperature	The symbol shows.	The engine temperature is too high.
		The symbol flashes quickly.	Speak to your Husqvarna servicing agent.
	Oil Pressure Sensor	The symbol shows.	Low oil pressure. Refer to <i>To do a check of the engine oil level on page 43.</i>
	Battery level indicator	The symbol shows.	Low voltage. Refer to <i>To charge the battery on page 39.</i>
	PTO button indicator	The symbol shows.	PTO button engaged. Refer to <i>To do a check of the operation conditions on page 12.</i>
		The symbol flashes.	Incorrect start procedure. Refer to <i>To do a check of the operation conditions on page 12.</i>
		The symbol flashes quickly.	Defective PTO button. Speak to your Husqvarna servicing agent.
	Parking brake indicator	The symbol shows.	The parking brake engaged. Refer to <i>To apply and release the parking brake on page 26.</i>
		The symbol flashes.	Incorrect start procedure. Refer to <i>To do a check of the operation conditions on page 12.</i>
		The symbol flashes quickly.	Defective parking brake. Speak to your Husqvarna servicing agent.
	OPC indicator	The symbol flashes.	Seat switch disengaged when you try to start the engine. Refer to <i>To do a check of the operation conditions on page 12.</i>
		The symbol flashes quickly.	Defective seat switch. Speak to your Husqvarna servicing agent.
	Servicing indicator	The symbol shows.	Servicing is necessary. Speak to your Husqvarna servicing agent.
	Fuel gauge	The symbol shows.	Low fuel level. Refer to <i>To fill fuel on page 20.</i>
	Bluetooth®	The symbol flashes.	The product is locked. Unlock your product with the Husqvarna Connect app.

Symbol	Name	Shows on the display	Cause
	Digital lock	The symbol shows.	The product is locked. Unlock your product with the Husqvarna Connect app.

**Note:** The symbols and the positions of the symbols on the display can be different between different models.

## Transportation, storage and disposal

### Transportation

- The product is heavy and can cause crush injuries. Be careful when you load it onto or off a vehicle or trailer.
- Use an approved trailer for transportation of the product.
- Make sure that you have knowledge of local road traffic regulations before transportation of the product in a trailer or on roads.

### To safely attach the product on a trailer for transport

Before you attach the product, you must read and understand the safety chapter. Refer to *Transport safety on page 14*.



**WARNING:** The parking brake is not sufficient to lock the product during transport. Attach the product tightly to the load area.

Equipment: 4 approved straps and 4 wheel chocks.

1. Park the product in the center of the load area.

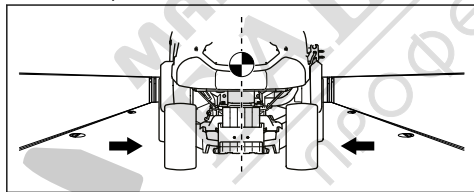

**WARNING:** For transport in transport vehicles with a cover. Make sure that the product is cool before you put the product in the transport vehicle.

2. Make sure that the center of gravity of the product is above the wheel axle of the transport vehicle. If a trailer is used for transport, make sure that the down force on the tow bar is correct.

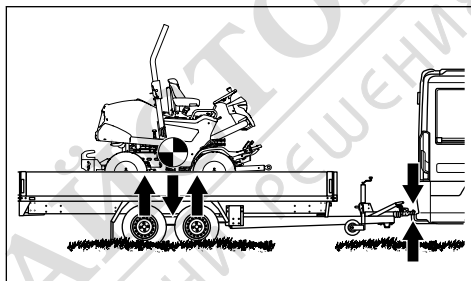

3. Apply the parking brake.
4. Lower the cutting deck to the float position.
5. Remove all loose objects.
6. Put the first strap through the rear transmission frame.

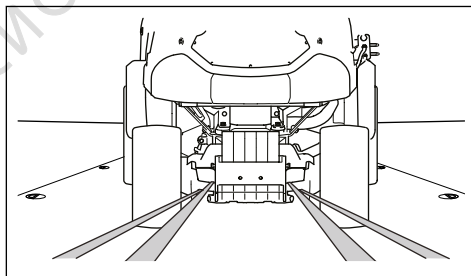

7. Put the second strap through the rear transmission frame.
8. Attach the straps to the load area.
9. Tighten the straps rearward to attach the product to the load area.

10. Attach the third strap to 1 of the transport eyelets.

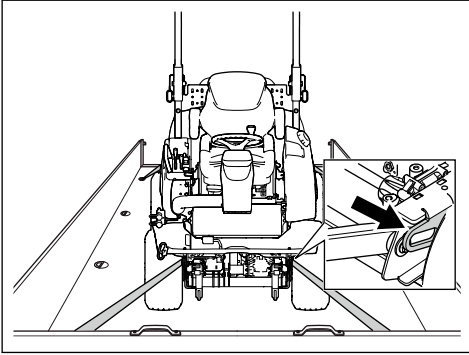

11. Attach the fourth strap to the other transport eyelet.

12. Attach the strap to the load area.

13. Tighten the strap forward to attach the product to the load area.

14. Put the wheel chocks in front of and behind the rear wheels.

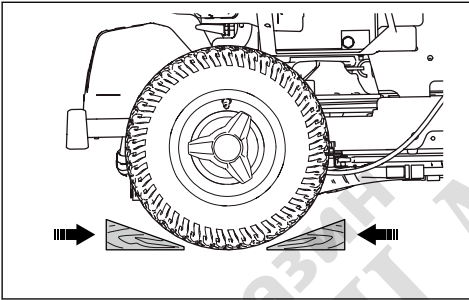

## To tow the product

The product has a hydrostatic transmission. To prevent damage to the transmission, tow the product short distances only and at low speed.

Disengage the transmission before you tow the product. Refer to *To disengage the hydrostatic transmission on page 27*.

## Storage

Prepare the product for storage at the end of the season, and before more than 30 days of storage.

To prevent tacky particles during storage, add a stabilizer. Always use the mixing ratios given by the manufacturer.

- Add stabilizer to the fuel in the tank or in the container used for storage, to prevent damage to the engine.
- Run the engine for a minimum of 10 minutes to let the stabilizer flow into the fuel injection.



**WARNING:** Do not keep the product with fuel in the tank in an indoor location or in locations with bad airflow. Risk of fire if fuel fumes come near open flames and sparks.

- Turn the main switch to the OFF position. Refer to *To stop the engine on page 25*.
- Clean the product, refer to *To clean the product on page 29*. Repair paint damages to prevent corrosion.



**WARNING:** Remove grass and other flammable materials from the product to decrease the risk of fire. Let the product become cool before you put it in storage.

- Examine the product for worn or damaged parts and tighten loose screws and nuts.
- Remove the battery. Clean it, charge it, and keep it cool during storage.
- Change the engine oil and discard the waste oil.
- Empty the fuel tank. Start the engine and run it until there is no remaining fuel in the fuel injection.

**Note:** Do not empty the fuel tank and fuel injection if a stabilizer is added.

- Remove the glow plugs and put about a tablespoon of engine oil into each cylinder. Manually turn the engine shaft to apply the oil. Attach the glow plugs.
- Lubricate all grease nipples, joints and axles.
- Keep the product in a clean and dry area and put a cover on it for more protection. A cover for protection of your product during storage or transport is available at your dealer.

## Storage of the cabin



**WARNING:** Move the cabin carefully. The cabin is heavy and can cause serious injuries. Make sure the cabin is stable during storage.

- Repair paint damages to prevent corrosion.
- Examine the product for worn or damaged parts and tighten loose screws and nuts.
- Keep the product in a clean and dry area and cover it for more protection.
- Keep the product in a locked area away from children and other not approved persons.
- Put the cabin on the cabin support during storage. Refer to *Cabin support dimensions on page 64*.

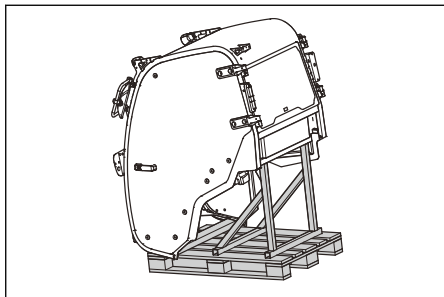

## Disposal

- Chemicals can be dangerous and must not be discarded on the ground. Always discard used chemicals at a service center or an applicable disposal location.
- When the product is worn out, send it to the dealer or to an applicable recycling location.
- Oil, oil filters, fuel and the battery can have negative effects on the environment. Obey the local recycling requirements and applicable regulations.
- Do not discard the battery as domestic waste.
- Send the battery to a Husqvarna service agent or discard it at a disposal location for used batteries.

МАГАЗИН  
БАШ МАЙСТОРА®  
ПРОФЕСИОНАЛНИ РЕШЕНИЯ



## Technical data

### Technical data

	P 520DX	P 525DX / P 525DX Cabin
<b>Dimensions</b>	Refer to <i>Product dimensions (P 520DX/P 525DX)</i> on page 62 and <i>Product dimensions (P 525DX Cabin)</i> on page 63.	
Weight without cutting deck, with empty tanks, kg	649	677 921 (P 525DX Cabin)
Tire dimensions	20 × 8 - 10	20 × 10 - 10
Tire pressure, rear – front, kPa/bar/PSI	150/1.5/22	150/1.5/22
Max. gradient, degrees	10	10
<b>Engine</b>		
Brand/Model	Kubota/D902	Kubota/D1105
Nominal engine output, kW @ 3000 rpm <sup>1</sup>	14.7	17.8
Displacement, cm <sup>3</sup>	898	1123
Max. engine speed, rpm	3300	3200
Max. speed forward, km/h / mph	17.6/10.9	19/11.8
Max. speed reverse, km/h / mph	13.4/8.3	15/9.3
Diesel fuel, min. octane grade <sup>2</sup>	45	45
Tank volume, l (at max. fuel level indication)	22	22
Oil, API class CF-4 or better	Class SAE10W-40	Class SAE10W-40
Oil volume with filter, l	3.3	3.3
Oil volume without filter, l	3	3
Start motor	Electric start 12 V, 40 Ah	Electric start 12 V, 40 Ah
<b>Cooling system</b>		
Cooling system capacity, l	3.7	3.7
Antifreeze	≥ 50% propylene glycol (MPG)	≥ 50% propylene glycol (MPG)
<b>Hydraulic system</b>		
Max. working pressure, bar/psi	120/1740	120/1740
Max. workflow l/min	12	12

<sup>1</sup> The power rating of the engine indicated is the average net output (at specified rpm) of a typical production engine for the engine model measured to SAE standard J1349/ISO1585. Mass production engines may differ from this value. Actual power output for the engine installed on the final product will depend on the operating speed, environmental conditions and other values.

<sup>2</sup> To meet the emission regulations, the fuel need to meet the standard EN590 or ASTM D975 and have a Sulphur content of less than 500ppm or 0.05% of weight. Please refer to the Kubota Operators Manual for further information regarding fuel quality

	<b>P 520DX</b>	<b>P 525DX / P 525DX Cabin</b>
Hydraulic tank capacity, l	8	8
Hydraulic system capacity, l	13	13
Hydraulic oil	Husqvarna transmission oil 10W-30  (Husqvarna 10W-30 4T AWD or STOU 10W-30)	Husqvarna transmission oil 10W-30  (Husqvarna 10W-30 4T AWD or STOU 10W-30)
<b>Transmission</b>		
Brand	Kanzaki	Kanzaki
Model	KTM23	KTM23
Transmission oil	Husqvarna transmission oil 10W-30  (Husqvarna 10W-30 4T AWD or STOU 10W-30)	Husqvarna transmission oil 10W-30  (Husqvarna 10W-30 4T AWD or STOU 10W-30)
Oil capacity front, total, l	0.9	0.9
Oil capacity rear, total, l	0.9	0.9
Max. hydraulic pressure, bar/psi	275/3989	275/3989
<b>Electrical system</b>		
Type	12 V, negative grounded	12 V, negative grounded
Battery	12 V, 62 Ah	12 V, 62 Ah
Main fuse, type Mega OTO	150 A	150 A
Fuse for power outlet, type Midi OTO	50	50
<b>Lamps</b>		
Headlight	LED, 2x12 V, 5 W	LED, 2x12 V, 5 W
<b>Lamps on the cabin</b>		
Low and high beam lamp	-	H7
Parking lamps	-	W5W
Turn signal lamp	-	PY21W
Front working lights	-	H9
Rear working lights	-	LED lights
Rear lights	-	LED lights
Warning lamp	-	LED lights
<b>Cutting deck</b>		

	P 520DX	P 525DX / P 525DX Cabin
Type	Combi 132	Combi 132
	Combi 155	Combi 155
	Combi 132 X	Combi 132 X
	Combi 155 X	Combi 155 X

Noise emissions <sup>3</sup>	P 520DX	P 525DX	P 525DX Cabin
<b>Sound power level, measured dB(A)</b>			
Combi 132	103	104	103
Combi 155	104	103	103
Combi 132 X	103	104	103
Combi 155 X	104	103	103
<b>Sound power level, guaranteed dB(A)</b>			
Combi 132	105	105	104
Combi 155	105	105	104
Combi 132 X	105	105	104
Combi 155 X	105	105	104

Sound levels <sup>4</sup>	P 520DX	P 525DX	P 525DX Cabin
<b>Sound pressure level at the operators ear, dB(A)</b>			
Combi 132	88	87	84
Combi 155	88	87	84
Combi 132 X	88	87	84
Combi 155 X	88	87	84

Vibration levels <sup>5</sup>	P 520DX	P 525DX	P 525DX Cabin
<b>Vibration level on the steering wheel, m/s<sup>2</sup></b>			
Combi 132	1.4	1.5	1.4

<sup>3</sup> Noise emissions in the environment measured as sound power ( $L_{WA}$ ) in conformity with EC directive 2000/14/EC.

<sup>4</sup> Noise pressure level according to EN ISO 5395. Reported data for noise pressure level has a typical statistical dispersion (standard deviation) of 1.2 dB(A).

<sup>5</sup> Vibration level according to EN ISO 5395. Reported data for vibration level has a typical statistical dispersion (standard deviation) of 0.2 m/s<sup>2</sup> (steering wheel) and 0.8 m/s<sup>2</sup> (seat).

Vibration levels <sup>5</sup>	P 520DX	P 525DX	P 525DX Cabin
Combi 155	1.3	1.7	1.3
Combi 132 X	1.4	1.5	1.4
Combi 155 X	1.3	1.7	1.3
Vibration level in the seat, m/s <sup>2</sup>			
Combi 132	0.3	0.4	0.3
Combi 155	0.3	0.4	0.3
Combi 132 X	0.3	0.4	0.3
Combi 155 X	0.3	0.4	0.3

Cutting deck	Combi 132	Combi 155	Combi 132 X	Combi 155 X
Cutting width, mm	1320	1550	1320	1550
Cutting height, 7 positions, mm/inch	30-112	30-112	30-112	30-112
Width, mm	1400	1631	1400	1631
Length, mm	490	563	490	563
Weight, kg	138	155	148	163
Blade				
Blade bolt tightening torque, Nm/kpm/lb-ft	80-84/8.15-8.56/59-62	80-84/8.15-8.56/59-62	80-84/8.15-8.56/59-62	80-84/8.15-8.56/59-62
Article number	5861988-10	5861989-10	5861988-10	5861989-10



**WARNING:** To use a cutting deck that is not approved for the product can cause objects to eject at high speed and cause

serious injury. Do not use other cutting deck types than specified in this owner's manual.

## Radio frequency data

	P 520DX	P 525DX	P 525DX Cabin
Frequency range, MHz	2402 – 2480	2402 – 2480	2402 – 2480
Output power <sup>6</sup> , dBm	0,0	0,0	0,0

<sup>5</sup> Vibration level according to EN ISO 5395. Reported data for vibration level has a typical statistical dispersion (standard deviation) of 0.2 m/s<sup>2</sup> (steering wheel) and 0.8 m/s<sup>2</sup> (seat).

<sup>6</sup> Measured at 2402 MHz.

## Product dimensions (P 520DX/P 525DX)

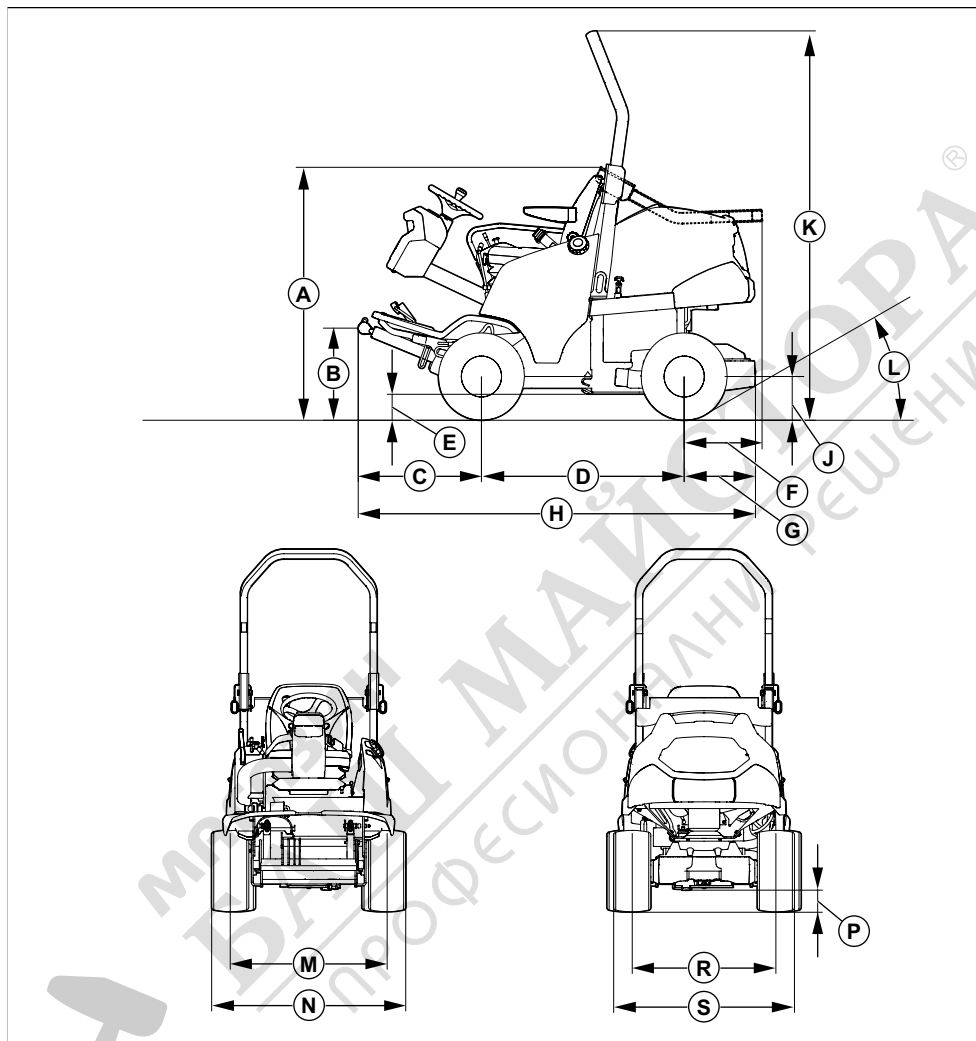

### Dimensions, mm

<b>A</b>	1330/1330	<b>E</b>	164/160	<b>J</b>	254/254	<b>N</b>	1132/1153
<b>B</b>	502/499	<b>F</b>	407/407	<b>K</b>	2033/2033	<b>P</b>	149/149
<b>C</b>	645/645	<b>G</b>	373/373	<b>L</b>	35.5°/35.5°	<b>R</b>	836/842
<b>D</b>	1060/1060	<b>H</b>	2078/2078	<b>M</b>	910/918	<b>S</b>	1056/1077

## Product dimensions (P 525DX Cabin)

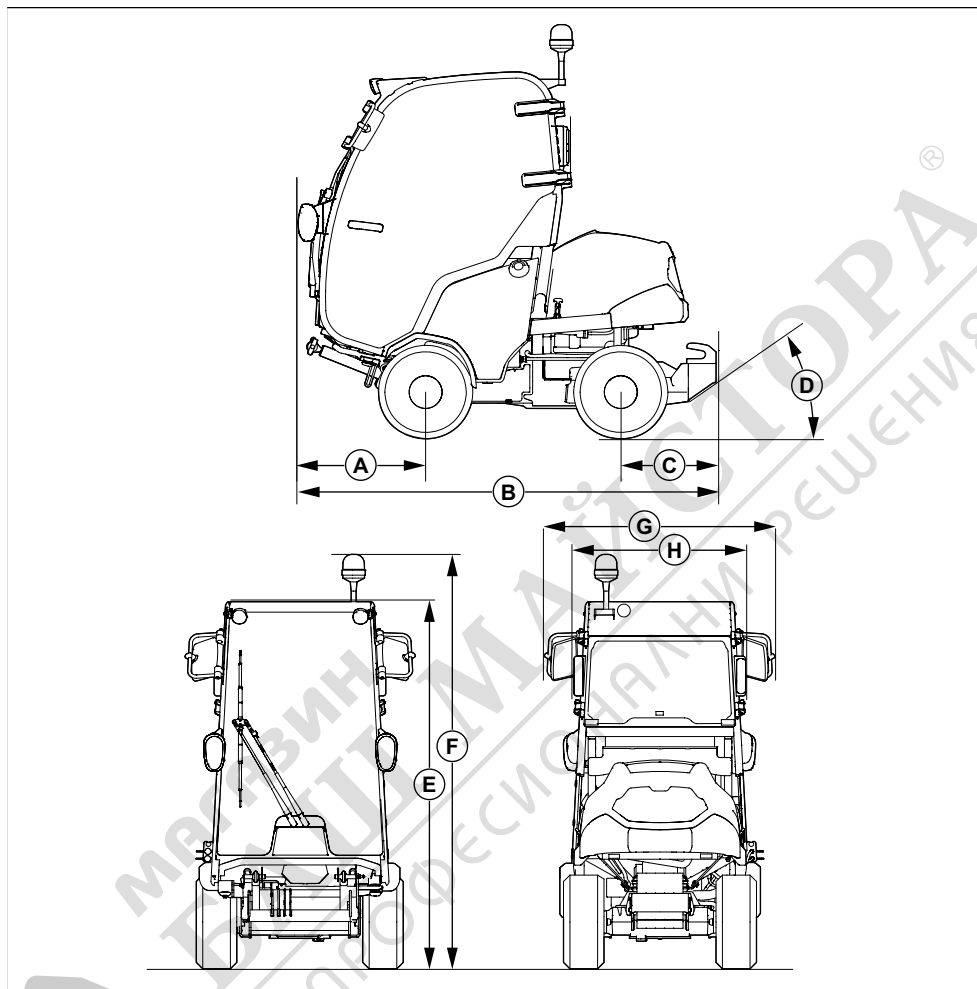

Dimensions, mm

<b>A</b>	692	<b>C</b>	518	<b>E</b>	2008	<b>G</b>	1251
<b>B</b>	2269	<b>D</b>	35°	<b>F</b>	2180	<b>H</b>	883

## Cabin support dimensions

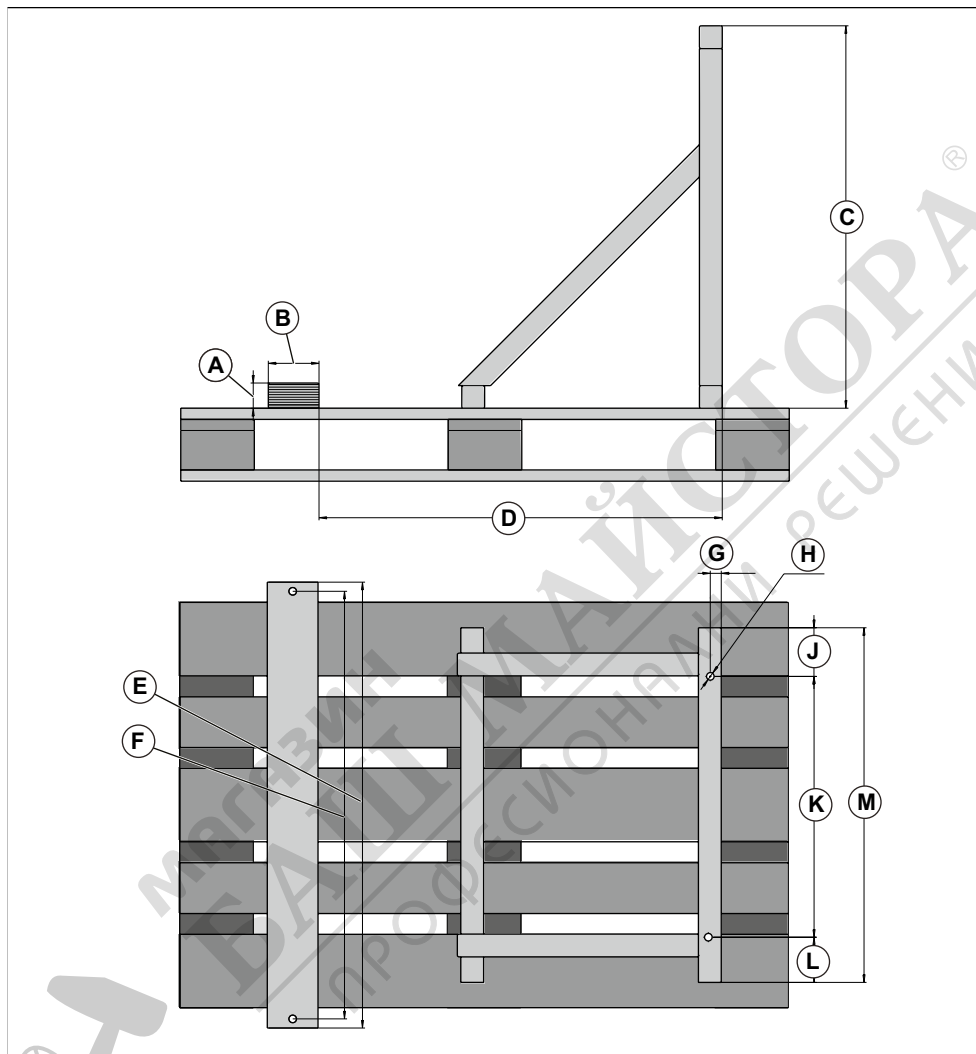

Dimensions for the cabin support, mm

<b>A</b>	50	<b>D</b>	800	<b>G</b>	22,5	<b>K</b>	515
<b>B</b>	100	<b>E</b>	880	<b>H</b>	15 Ø (x4)	<b>L</b>	89
<b>C</b>	755	<b>F</b>	844	<b>J</b>	96	<b>M</b>	700

---

## Accessories

---

Instructions for maintenance of optional equipment or accessories are not given in this operator's manual. See

the operator's manual for the accessory or equipment for instructions.

---

## Service

---

Do a yearly check at an authorized service center to make sure that the product functions safely and at its best during high season. The best time to do a servicing or overhaul of the product is low season.

When you send an order for the spare parts, give information about the purchase year, model, type, and serial number.

Always use original spare parts.

---

## Warranty

---

### Transmission warranty

The transmission warranty is only applicable if checks are done of the front and rear wheel speed as specified in the maintenance schedule. To prevent damage to the transmission system, let an approved service agent adjust it.



# Declaration of Conformity

## EU Declaration of Conformity

We, **Husqvarna AB**, SE-561 82 Huskvarna, Sweden, tel: +46-36-146500, declare on our sole responsibility that the product:

<b>Description</b>	Ride-on Lawn Mower
<b>Brand</b>	Husqvarna
<b>Type / Model</b>	P 520DX, P 525DX, P 525DX Cabin
<b>Identification</b>	Serial numbers dating from 2022 and onwards

complies fully with the following EU directives and regulations:

<b>Directive/Regulation</b>	<b>Description</b>
2011/65/EU	"on the restriction of the use of certain hazardous substances in electrical and electronic equipment"
2006/42/EC	"relating to machinery"
2014/30/EU	"relating to electromagnetic compatibility"
2000/14/EC	"relating to the noise emissions in the environment"
2014/53/EU	"relating to radio equipment"

and that the following standards and/or technical specifications are applied: EN ISO 5395-1:2013/ A1:2018, EN ISO 5395-3:2013/A1:2017/A2:2018, ISO 21299:2009, EN ISO 12100:2010, EN ISO 14982:2009, ETSI EN 300 328 v.2.2.2, ETSI EN 301 489-1 V2.2.3, ETSI EN 301 489-17 V3.2.4, EN IEC 61000-6-4:2019, EN IEC 61000-6-2:2019, EN IEC 63000:2018.

Claes Losdal, Development Manager/Garden Products, Husqvarna AB

Responsible for technical documentation



Notified Body: 0404, RISE SMP Svensk Maskinprovning AB, Box 4053, SE-904 03 Umeå, Sweden has certified conformity with the council's directive 2000/14/EC, conformity assessment procedure: Annex VI.

For information relating to noise emissions, refer to *Technical data on page 58*.

Huskvarna, 2022-10-12

## UK Declaration of Conformity

We, **Husqvarna AB**, SE-561 82 Huskvarna, Sweden, tel: +46-36-146500, declare on our sole responsibility that the product:

<b>Description</b>	Ride-on Lawn Mower
<b>Brand</b>	Husqvarna
<b>Type / Model</b>	P 520DX, P 525DX, P 525DX Cabin
<b>Identification</b>	Serial numbers dating from 2022 and onwards

complies fully with the following UK regulations:

<b>Description</b>
The Supply of Machinery (Safety) Regulations 2008
Electromagnetic Compatibility Regulations 2016
The Radio Equipment Regulations 2017
The Noise Emission in the Environment by Equipment for use Outdoors Regulations 2001, schedule 9
The Restriction of the Use of Certain Hazardous Substances in Electrical and Electronic Equipment Regulations 2012

and that the following standards and/or technical specifications are applied: EN ISO 5395-1:2013/A1:2018, EN ISO 5395-3:2013/A1:2017/A2:2018, ISO 21299:2009, EN ISO 12100:2010, EN ISO 14982:2009, ETSI EN 300 328 v.2.2.2, ETSI EN 301 489-1 V2.2.3, ETSI EN 301 489-17 V3.2.4, EN IEC 61000-6-4:2019, EN IEC 61000-6-2:2019, EN IEC 63000:2018.

UK Importer:  
Husqvarna UK Ltd  
Preston Road, Co. Durham  
DL5 6UP

Approved Body: 0888, HORIBA MIRA Certification Ltd. Watling Street, Nuneaton, Warwickshire, CV10 0TU, UK, has carried out certified conformity according to the Outdoor Noise Regulations of 2001, conformity assessment procedure: Schedule 9.

For information relating to noise emissions, refer to *Technical data on page 58*.

Husqvarna, 2022-10-14



Claes Losdal, Development Manager/Garden Products, Husqvarna AB

Responsible for technical documentation

**UK  
CA**