

3541G



DE (DEUTSCH) Gebrauchsanleitung	6
EN (ENGLISH) Instructions for Use	13
FR (FRANÇAIS) Mode d'emploi	20
NL (NEDERLANDS) Gebruiksaanwijzing	27
PL (POLSKI) Instrukcja użytkowania	34
PT (PORTUGUÊS) Manual de instruções	41



MESTO Spritzenfabrik
Ernst Stockburger GmbH
Ludwigsburger Straße 71
D-71691 Freiberg/Neckar
Tel.: +49 7141 272-0
Fax: +49 7141 272-100
info@mesto.de
www.mesto.de



МАГАЗИН
БАШ МАЙСТОРА
ПРОФЕССИОНАЛНИ РЕШЕНИЯ

Ersatzteile	Spare Parts	Pièces de Rechange
Reserve-onderdelen	Części zamienne	Peças sobressalentes

3541G

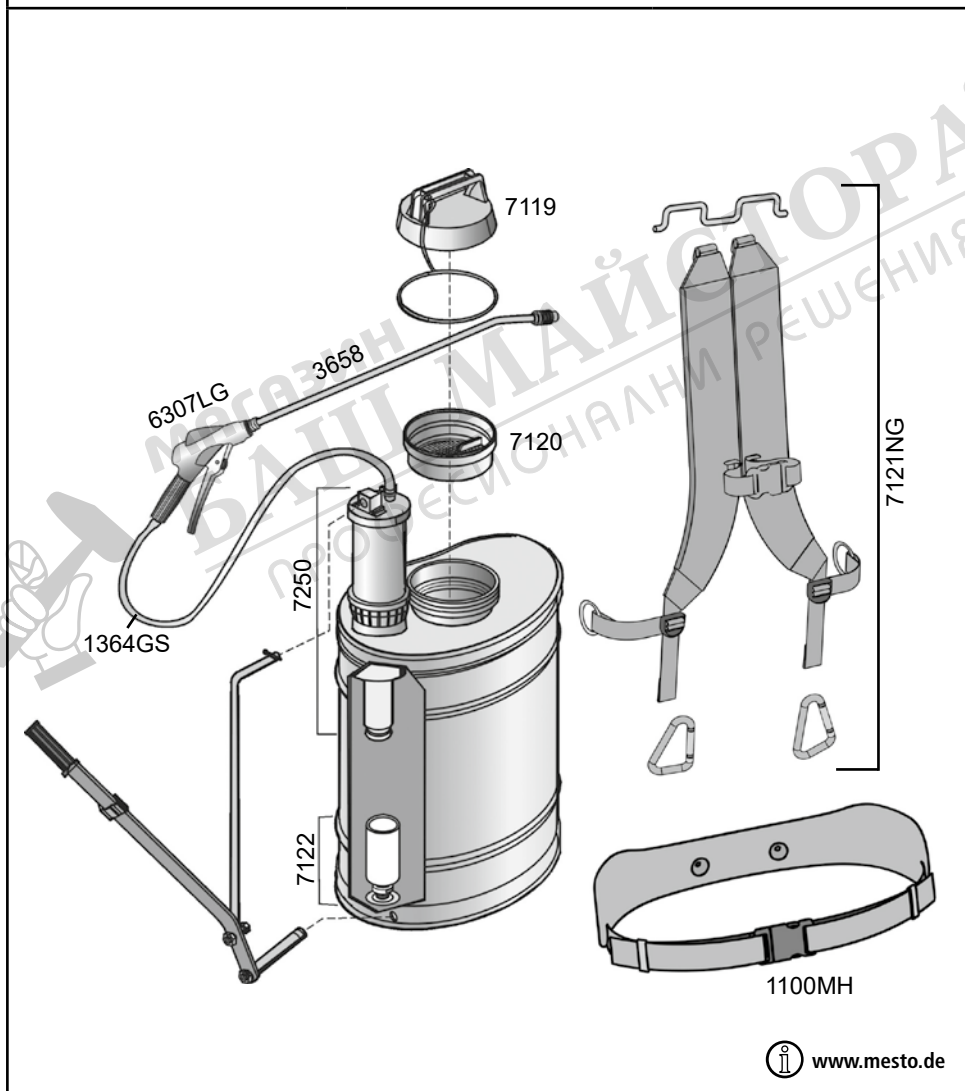

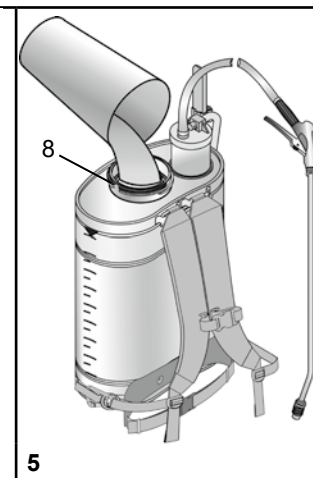
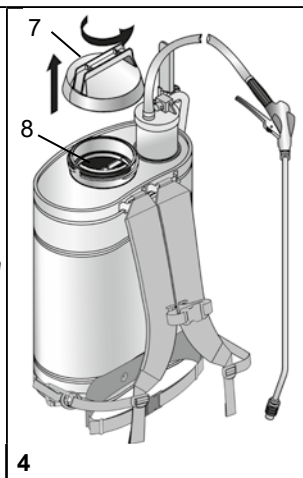
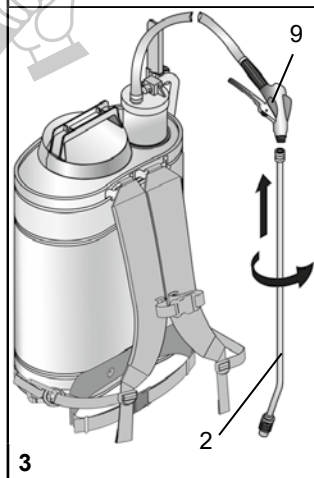
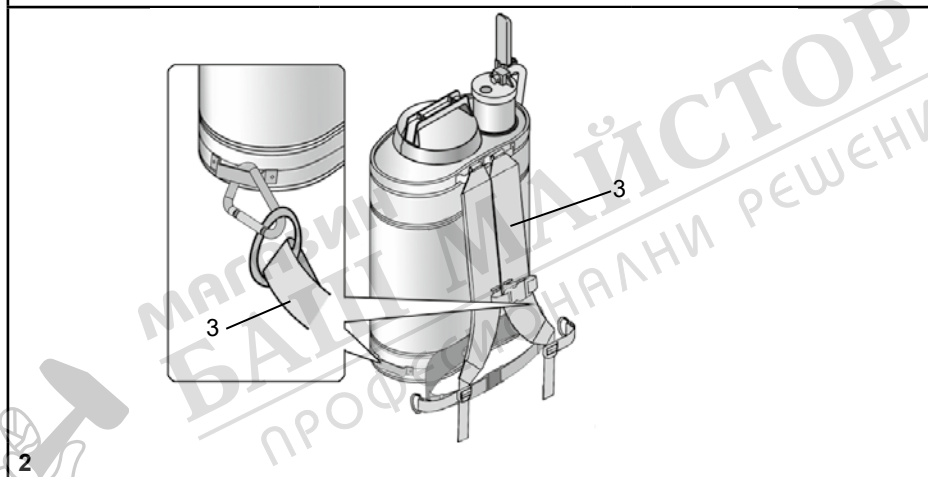
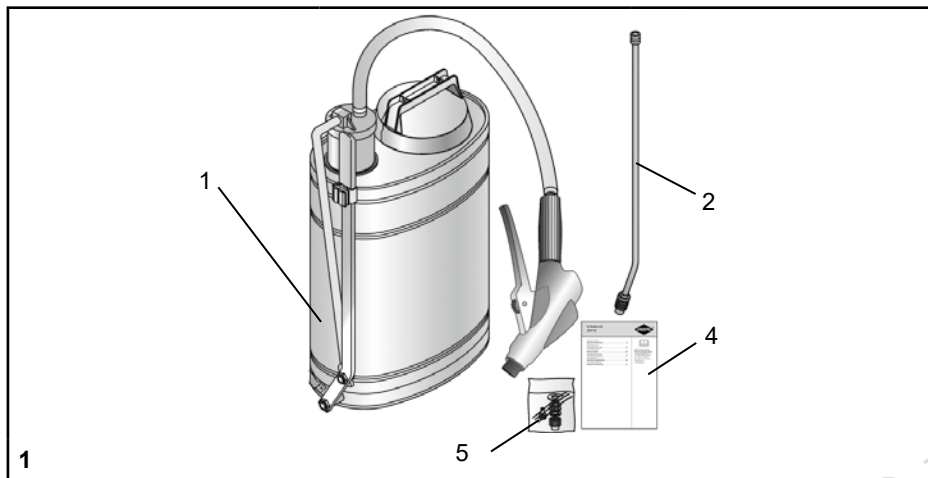

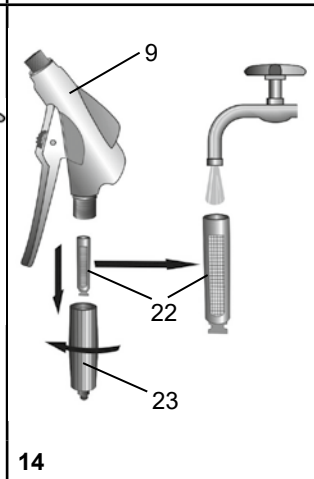
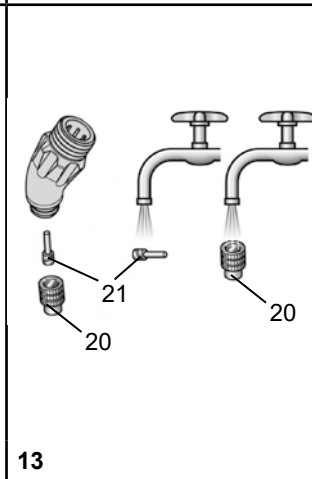
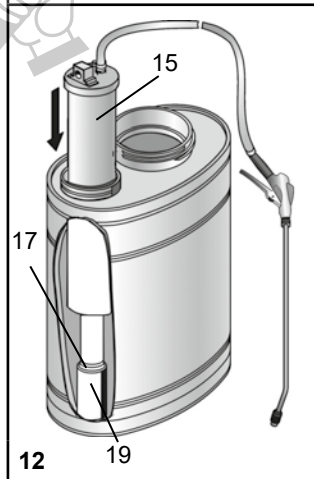
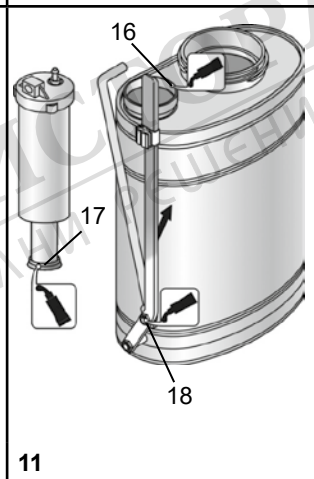
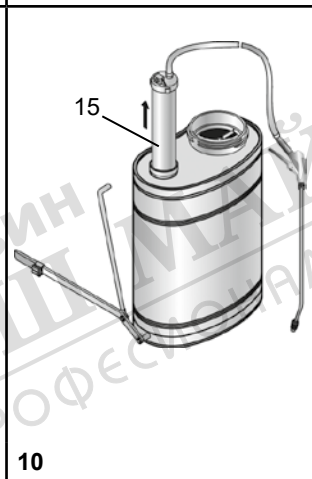
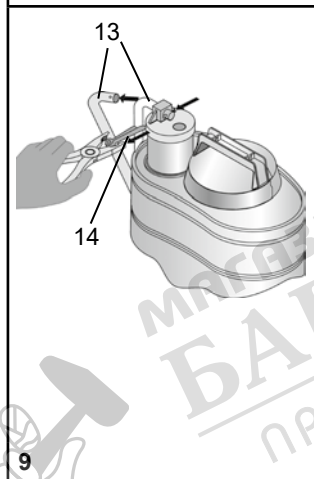
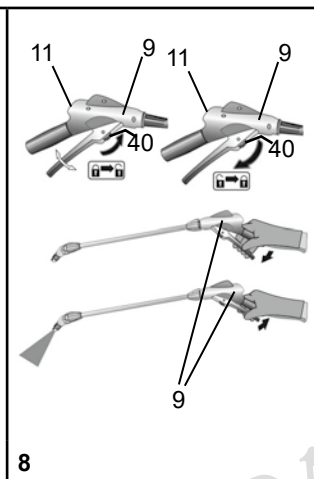
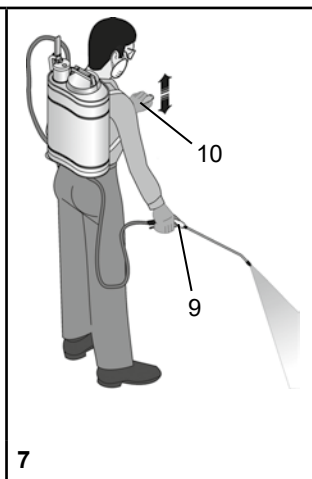
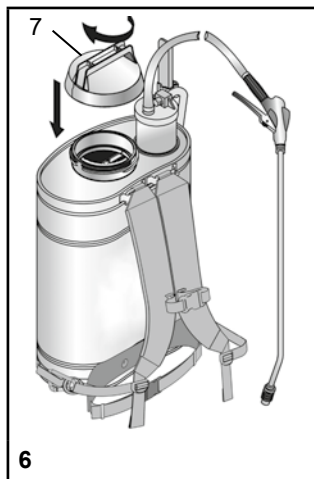

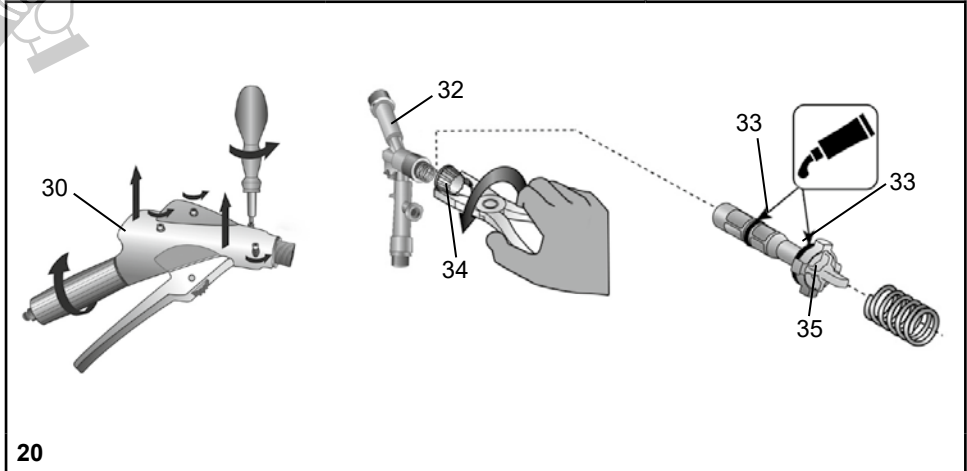
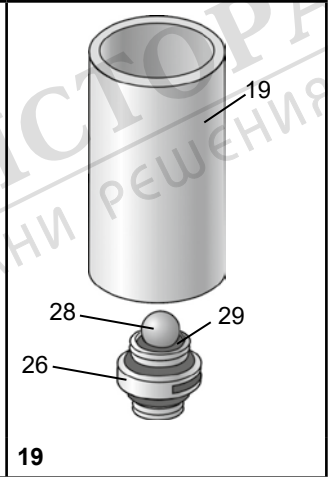
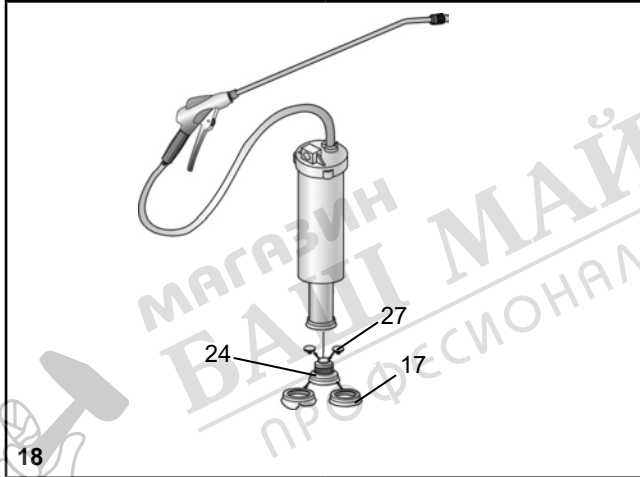
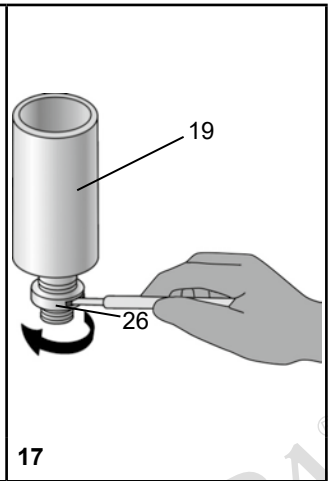
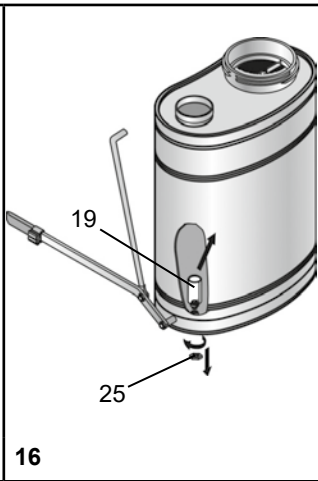
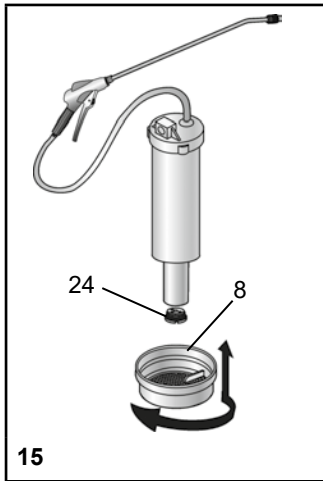

Welcome and congratulations

on purchasing your new quality product. Thank you for the trust you have shown in our brand. Your satisfaction with our product and services is very important to us. Please contact us if your expectations are not met. You will find our address on the title page of these instructions for use.



Make certain to read the instructions for use before using the device!

Keep the instructions for use in a safe place where they can be easily found.



The instructions for use are an integral part of the device and must be enclosed when the device is passed on. Particular safety measures are required when working with the device.

Usage

Backpack spraying device 3541G is designed for the spraying of plant protection products,[®] including weed killers in the stipulated concentrations.

At the time of manufacture, there are no known harmful effects to the device caused by plant protection products approved by the Federal Office of Consumer Protection and Food Safety.



Improper use may result in dangerous injuries and environmental damage.

Follow the safety notices and data sheets of the substance manufacturers before each application. Observe the specified maximum concentrations for chemical substances and preparations. We will be happy to advise you on what best suits your needs. Observe the legal and statutory regulations applicable in your country.

The device may be used outdoors or in well ventilated rooms only. Have the salesperson or an expert show you how to operate the device if you are working with it for the first time.

Not suitable for

- inflammable liquids
- corrosive substances (*certain disinfecting and impregnating agents, acids and bases*)
- liquids containing ammonia
- liquids at temperatures above 40 °C (104° F)
- wetting agents (*surfactants*), solvents, and liquids containing solvents which can cause or promote cracking in the applied plastics
- viscous or sticky liquids or liquids that form residues (*dyes, greases*)
- use in applications for foodstuffs

Under no circumstances should you use

- external sources of pressure without original compressed air filling valve
- for flaming
- for storing and holding liquids
- as an eyewash

Safety



Only trained, healthy and rested people may work with the device. You should not be under the influence of alcohol, drugs or medication.
 Children and adolescents must not use the device
 Keep the spraying devices safe from access to children.
 Take precautions to prevent hazardous substances from being misused.
 → **Accident risk!**

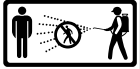

Keep bystanders away during spraying.
 Never spray on people, animals, electrical devices and lines, into the wind, or into bodies of water.
 → **Risk of injury!**



Wear appropriate protective clothing, goggles and respiratory protection in line with the applicable national regulations when working with hazardous substances.



Avoid ignition sources in the environment.



Do not allow the device to remain under pressure and/or exposed directly to sunlight. Make certain the device is not heated beyond the maximum operating temperature. (→ *Table 1*).
 Protect the device from frost and ammonia.



Never blow through the nozzles or valves with your mouth.
 → **Risk of poisoning!**



There is a risk of slipping or tripping on smooth or wet surfaces, snow, ice, on slopes and on uneven terrain.



Repairs and modifications to the device are not permitted.
 Have damaged parts or parts that do not work properly repaired immediately by our customer service department or by service partners authorized by us.

The effect of the safety valve must not be bypassed or made inoperative.
 → **Explosion hazard!**



Use only original spare and accessory parts.
 We cannot assume any liability resulting from the use of third-party parts.



When pumping, always observe the pressure gauge to ensure the maximum spraying pressure is not exceeded (→ *Table 1*).
 All excess pressure must be released from the device before filling, after use, before carrying out maintenance work, on work breaks, and before placing it in storage.



Points to note when transporting the device: Transport the device in such a way that it is protected against damage and tipping. All excess pressure must be released from the device.
 → **Explosion hazard!**

 You will find the illustrations referred to above in the pages 3 – 5 of these instructions for use.

Scope of delivery

Backpack spraying device with spray line [1] and carrying strap [3], spray lance [2], Instructions for Use [4], seal set [5]. (Fig. 1)

Technical data

Type of device	3541G
Max. filling amount	18 l
Max. spraying pressure	6 bar (88 psi)
Max. operating temperature	40 °C (104 °F)
Weight when empty / Gross weight max.	5.0 / 23.0 kg
Material of tank	Stainless steel
Where device is carried	Back
Technical residual quantity	0,13 l
Max. volume flow	2 l/min at 2 bar

Table 1

Assembly

1. Attach the carrying strap [3] to the tank. (Fig. 2)
2. Screw the spray lance [2] onto the shut-off valve [9]. (Fig. 3)

Checks

Visual inspection: Are the tank [1] with pressure vessel [15], as well as shut-off valve [9] with spray line, pressure gage [11] and spray lance [2] with nozzle undamaged?

 Pay special attention to the connections between the pressure vessel - spray line and the spray line – shut-off valve and to the condition of the spray lance.

Function: Activate the pump lever [10]. (Fig. 7)

- ▶ Increasing pressure is indicated on the pressure gage [11].

 Using the lock [40] the lever on the shut-off valve [9] can be locked and unlocked. Unintentional spraying is prevented after locking. (Fig. 8)

- ▶ If required, reset the lock [40] and activate the shut-off valve [9]. (Fig. 8)
- ▶ The shut-off valve must open and close.



Check the device regularly and after a longer period of non-use, e.g. a winter break. Have damaged parts or parts that do not work properly repaired immediately by our customer service department or by service partners authorized by us.

Preparation



Observe the instructions in the section entitled „Safety“.

The device must be in an upright position.

If filling the tank from a water line, ensure that the line or a hose does not project into the tank.

1. Screw the cover [7] off the tank. (Fig. 4)



We recommend you mix the spraying liquid in the device or premix it in an external tank: Fill to 1/3 with water, pour in the spraying agent, and then add more water until full.

2. Pour the spray liquid through the filling strainer [8] into the tank. (Fig. 5)

3. Screw the cover [7] onto the tank. (Fig. 6)

Spraying



Observe the instructions in the section entitled “Safety”.

Operate the device only while it is vertical or suspended upright and nearly vertical.

Avoid allowing drops of spray to drift onto areas that are not being treated.

Observe the instructions of the spray product manufacturer!

1. Place the device on its back. (Fig. 7)

2. Using the pump lever [10], pump slowly and regularly to maintain a continuous spraying pressure. (→ Table 2, Fig. 7)



The maximum pressure should not exceed 6 bar. If the max. pressure is exceeded, the function may be affected.



To prevent dripping, hold the spray wand up when first spraying and activate the shut-off valve until no more liquid mixed with air is emerging from the nozzle.

3. If required, reset the lock [40] and activate the shut-off valve [9]. (Fig. 8)

► Spraying may now begin.

4. Ensure that the optimum spraying pressure (→ Table 2) is set on the pressure gage [11] (Fig. 8).

Spraying pressure	Spraying rate with hollow cone nozzle (original equipment)
1,5 bar (21.8 psi)	0.56 l/min
2,0 bar (29.0 psi)	0.64 l/min
3,0 bar (43.5 psi)	0.78 l/min

Table 2. Dependence: Spraying rate – spraying pressure



If liquid mixed with air emerges from the nozzle, the tank is empty.

Pump the device completely empty after each fifth filling at the latest.

After Usage



Observe the instructions in the section entitled "Safety".
Never leave liquid in the device.

1. Activate the shut-off valve [9] until the spray line is depressurized.
2. Screw the cover [7] off the tank. (Fig. 4)
3. Dilute the remaining quantity twice in a row with 1/2 liter of water each time and spray the resulting liquid onto the treated area.



Collect and dispose of the residual liquid and the tank according to all applicable laws, requirements and regulations.
Follow the instructions of the spray product manufacturer!

4. Wipe off the device with a moist cloth.
5. For drying and storing the device, remove the cover and keep the device in a dry place[®] protected from sunlight and freezing temperatures.



Clean the protective equipment and yourself every time after usage.

Care and maintenance



Observe the instructions in the section entitled "Safety".

After using the device 50 times or if the device malfunctions, at least once a year, preferably after the winter break:

- Remove the pressure vessel [15]:
 - a) Open and remove the cotter pin [14]. (Fig. 9)
 - b) Pull the connecting rod [13] out of the bearings. (Fig. 9)
 - c) Pull the pressure vessel [15] out of the tank. (Fig. 10)
- Grease the diaphragm [17]. (Fig. 11)
- Grease the guide ring [16] and the bearing positions [18]. (Fig. 11)
- Re-assemble the pump in reverse sequence.
-  To prevent damage to the diaphragm [17], insert the pressure vessel [15] exactly axially into the cylinder [19]. (Fig. 12)
- Clean the nozzle [20] and insert [21] under flowing water. (Fig. 14)
- Unscrew the handgrip [23] from the shut-off valve [9]. (Fig. 14)
- Remove the filter [22] and clean it under running water. (Fig. 14)
- Disassemble the shut-off valve [9]. (Fig. 20)
 - a) Loosen the 4 screws and pull the half shells [30] apart.
 - b) Screw the sealing cap [34] from the valve body [32] and pull the pressure bolt [35] from the valve body [32]. (Fig. 20)
- Grease the O-ring [33]. (Fig. 20)
- Assemble the shut-off valve [9].



Observe the legal requirements of your country for accident prevention and check the device in regular intervals.

Unless otherwise specified, we recommend that an expert carries out an external test every 2 years and an internal test every 5 years as well as a strength test every 10 years.

Removing intake and pressure valve

- Remove the pressure vessel [15] (see “Care and maintenance”).

Pressure valve:

- Using the filling strainer [8], unscrew the pressure valve screw [24]. (Fig. 15)

Intake valve:

- Screw off the hexagon nut [25] and take the cylinder [19] out of the tank. (Fig. 16)
- Screw the valve screw [26] out of the cylinder [19]. (Fig. 17)

Faults



Use only original spare and accessory parts.

Fault	Cause	Remedy
No pressure builds up in the device. Lever [10] can be moved very easily	Diaphragm [17] is defective.	Replace the diaphragm. (Fig. 18)
	Foreign object prevents closure of the pressure valve [24] and / or intake valve [26].	Clean intake and / or pressure valve. (Figs. 18, 19)
	O-ring [29] incorrectly situated in the intake valve [26].	Insert O-ring correctly into the intake valve. (Fig. 19)
Lever [10] is pulled downwards.	Intake valve [26] dirty or valve ball [28] sticking.	Clean intake valve. (Fig. 19)
Lever [10] is pulled upwards.	Foreign object prevents closure of the pressure valve [24] or defective valve disc [27] in the pressure valve.	Clean pressure valve or replace valve disc. (Fig. 18)
Lever [10] locked or can be moved downwards with difficulty only.	Diaphragm [17] is defective.	Replace the diaphragm. (Fig. 18)
	Pressure valve [24] dirty.	Clean pressure valve. (Fig. 18)
	Nozzle [20] and / or Filter [22] blocked.	Clean nozzle (Fig. 13) and / or filter (Fig. 14).
Only a spray, emerges, there is no atomization.	Nozzle insert [21] is missing.	Position the insert in the nozzle. (Fig. 13)
Liquid dripping from the nozzle.	Foreign object in the nozzle [20] and / or the insert [21].	Clean nozzle and / or insert. (Fig. 13)
Device sprays only when pumped.	Pressure vessel [15] completely filled with liquid	Pump device empty. Repeat after 5 fillings at the latest.
The shut-off valve does not close. Liquid emerges without the lever being activated.	O-ring [33] of the pressure bolt [35] not greased	Grease the O-ring of the pressure bolt. (Fig. 20)
	O-ring [33] defective	Replace the pressure bolt or O-ring. (Fig. 20)

Contact address for additional information → see title page.

Warranty

We guarantee that from the time it is first purchased for a period of the legally valid required warranty period (maximum 3 years) this device will not exhibit any material or processing errors. If defects are discovered during the warranty period, the manufacturer or the distributor in your country will repair the device without charging for the labor or material or (at the discretion of the manufacturer) replace the device itself or its defective parts. If such defects are discovered, please contact us immediately. We require the invoice or cash register receipt for purchase of the device. The warranty does not include wearing parts (seals, O-rings, diaphragm, etc.) or defects, which have occurred due to improper use or unforeseeable circumstances.

Declaration of Conformity

according to EC Machinery Directive 2006/42/EC, Appendix II, No. 1A.

Applicable standards:

DIN EN ISO 19932-1: 2013

DIN EN ISO 19932-2: 2014

We, MESTO Spritzenfabrik Ernst Stockburger GmbH, Ludwigsburger Straße 71,
D-71691 Freiberg,

declare under our sole responsibility that the products backpack spraying devices of the series 3541 in the version supplied comply with all relevant provisions of the Directive 2006/42/EC.

Rolf Rehkugler is authorized to compile the technical documentation.

Freiberg, 01.12.2016



Bernd Stockburger – Managing Director –

The data and illustrations in these instructions for use are for orientation only and not binding in any way. The manufacturer reserves the right to make changes or improvements to the products if these are considered appropriate without having to notify customers owning a similar model about this fact.