

Model No.HR008G 30MM CRDLS COMBINATION HAMMER

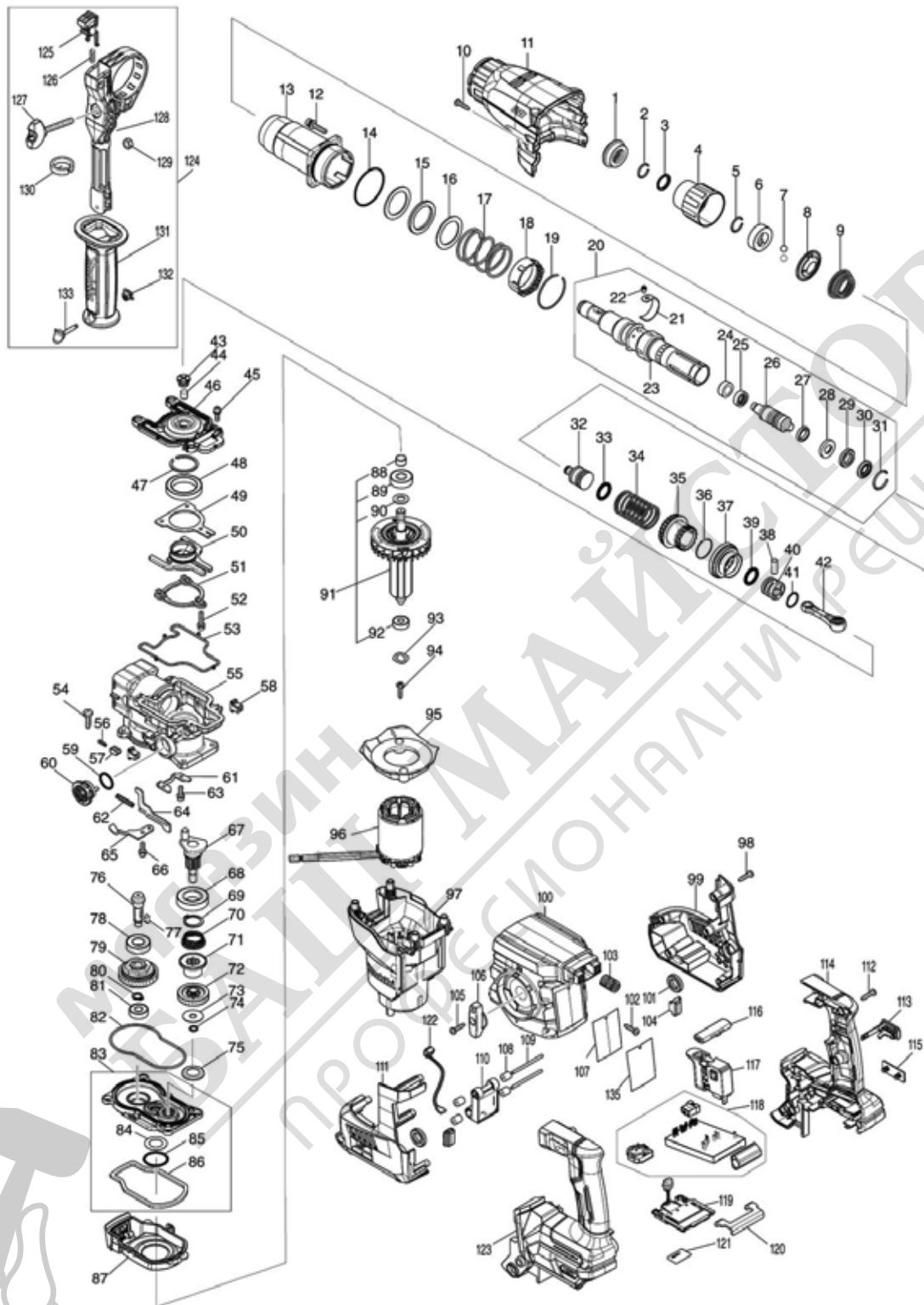

Nr.	Part nr.	Name
001	286288-8	Rubber Stofkap 35 Hr2300
002	233989-9	Veerring 14 Hr2300
003	346834-0	Sluitrevet 16Mm Hr2631F
004	459685-3	Boorkopkap HR3001/11C
005	233992-0	Borgveer 15 Hr2300
006	327269-4	Ring 17 HR3001/11
007	216022-2	Stalen Kogel 7.0 Hr2400
008	347944-6	Geleiderevet HR3011FC A
009	232503-8	Drukveer 21-34 HR3001/11
010	266326-2	Tap Schroef 4X18mm P
011	459167-5	Cilinderkap HR3011/12
012	266793-1	Inbusschr M5x25mm HR3011FC
013	140J35-0	Cilinderhuis HR3001/11C
013C10	213636-8	Keerring (Olie) 25 Hr2460
014	213620-3	O-Ring 46
015	422493-5	Rubber ring 31 HR3001/11C
016	267354-0	Revet 31 Hr2811C
017	232496-9	Drukveer 37 HR3001/11
018	419986-1	Blokkeerbus Hr2811
019	233952-2	Veerring 41 Hr2811
020	136312-6	Boor/beitelhouder HR3011/12
021	347501-0	Bladveer HR3011FC
022	256598-7	Kraagpin 4 HR3011FC
023	327277-5	Boor-beitelhouder HR3011FC
024	327515-5	Bus 11 HR3011FC
025	327516-3	Ring 11 HR3011FC
026	140S89-1	Slagbout A HR3011FC
027	213880-7	Pakkingring 12 HR3011FC
028	327268-6	Ring 11 HR3011FC
029	424267-0	Stootring 12 Hr2300
030	327271-7	Sluitring 11 HR3011FC
031	231987-7	Veerring 21 Hk0500
032	327266-0	Slagstuk HR3001/11
033	213881-5	O-ring 16 HR3001/11
034	232497-7	Drukveer 27 HR3001/11
035	327276-7	Geleidebus HR3001/11
036	232501-2	Borgveer 24 HR3001/11
037	226868-8	Tandwiel 31 A HR3001/11
038	268122-4	Pin 7 HR3001/11
039	213881-5	O-ring 16 HR3001/11
040	319807-6	Zuiger HR3001/11
041	213226-7	O-Ring 16 Bhr240
042	140J36-8	Drijfstang HR3001/11
043	459180-3	Filterkap HR3001/11
044	443153-6	Dempingsvilt Hr2300
045	922123-3	Zeskantbout Dcs230T

Nr.	Part nr.	Name
046	319802-6	Krukaskap HR3011/12
047	961140-8	Borgring Hr2811
048	211423-9	Kogellager 6806Ddw A
049	347500-2	Lagerborgring B HR3001/11
050	140J31-8	Balansgewicht HR3001/11
051	310927-9	Balanshouder HR3001/11
052	266948-8	Inbusbout M4X20Mm
053	459182-9	Pakkingring B HR3001/11
054	266021-4	Tapschroef 5X20 A
055	140J33-4	Krukashuis cpl HR3001/11
056	232499-3	Drukveer 2 HR3001/11
057	310929-5	Drukplaat HR3001/11
058	455165-7	Montagebus Mt860
059	213262-3	O-Ring 18
060	459175-6	Koppelplaat HR3001/11
061	347497-5	Lagerborgring A HR3001/11
062	234019-9	Drukveer 4 Hr2811
063	922123-3	Zeskantbout Dcs230T
064	345814-3	Verbindingsplaat Hr4510C
065	347498-3	Geleideplaat HR3001/11
066	922123-3	Zeskantbout Dcs230T
067	140M22-7	Krukas cpl HR3001/11
068	211323-3	Kogellager 6904
069	961060-6	Borgring S-20
070	232498-5	Drukveer 21-26 HR3001/11
071	327273-3	Koppeling HR3001/11
072	226869-6	Tandwiel 31 B HR3001/11
073	267353-2	Revet 29 Hr2811C
074	961034-7	Borgring Hr2811
075	345818-5	Schotelring 16 Hr2811
076	226867-0	Tandwiel 8 HR3001/11
077	254239-9	Inlegspie 4 Hr4013C
078	211131-2	Kogellager 6001Dw
079	125386-2	Koppelbegrenzer Hr2811
080	961006-2	Borgring S-10 EBH341L P
081	210005-4	Kogellager 608Ddw A
082	459181-1	Pakkingring A HR3001/11
083	136330-4	Tandwielhuis HR3011/12
084	253749-3	Sluistring 16 *
085	213445-5	O-Ring 26 P
086	459183-7	Sponsrubber HR3011FC
087	140J32-6	Luchtinlaat HR3001/12
088	331775-3	Bus 10 Hr2811
089	211097-6	Kogellager 6000Lib P
090	253828-7	Sluistring 10 2012Nb
091	519722-6	Anker assy HR008G

Nr.	Part nr.	Name
092	210022-4	KOGELLAGER 626DDW
093	253555-6	Veerring 12 HR008G
094	266326-2	Tap Schroef 4X18mm P
095	413F13-2	Tussenplaat HR008G
096	629A96-4	Veld HR008G
097	141H81-4	Motorhuis cpl HR008G
097C10	263027-3	Rubber Pen 4 Hm0860C
098	266326-2	Tap Schroef 4X18mm P
099	183V77-3	Huis cpl HR008G
100	413F12-4	Handgreepbasis HR008G
101	459184-5	Bufferring HR001G
102	266326-2	Tap Schroef 4X18mm P
103	232500-4	Drukveer 10 HR3001/11
104	422863-8	Batterijhouder HR008G
105	266326-2	Tap Schroef 4X18mm P
106	459174-8	Wisselhendel HR3001/11
107	8119V9-3	Naamplaat HR008G
108	422472-3	Demper HR001G
109	256886-2	As 3mm HR001G
110	620J19-9	Versnellingsmeter HR008G
111	183V77-3	Huis cpl HR008G
112	266326-2	Tap Schroef 4X18mm P
113	140G30-2	Afdekkap DSP601/DHR400 A
113C10	213A05-9	O-ring 16 SP001G
114	183V96-9	Handgreepset HR008G
114C10	263005-3	Rubber Pen 6 AC320H P
114C20	8005T5-8	Label XGT logo
115	459753-2	Kap HR007G
116	453124-5	L+R Schakelhendel Bhr242
117	651439-6	Schakelaar JR001G
118	620J18-1	Controller HR008G
119	632P65-6	Controleunit GA-40V serie
120	347885-6	Hulpplaat HR007G
121	8119W3-2	Label serienr. HR008G
122	620G34-5	Circuit led HR007G
123	183V96-9	Handgreepset HR008G
123C10	263005-3	Rubber Pen 6 AC320H P
123C20	8005T5-8	Label XGT logo
124	126882-3	Zijhandgreep boren/breken
125	144959-2	Blokkeerknop DHR281/283
126	233360-7	Drukveer 4 Hr23/2600
127	265625-9	Vleugelbout M6x50mm
128	458355-1	Handgreepbasis DHR281/283 P
129	931302-2	Zeskantmoer M6
130	422258-5	Sponsrubber DHR281
131	458357-7	Handgreep 36 DHR281/283 P

Nr.	Part nr.	Name
132	422255-1	Afdekkap handgrp DHR281/283
133	161838-9	Montagepin h-gr DHR281/283
135	8052T1-3	Label trp HR009G

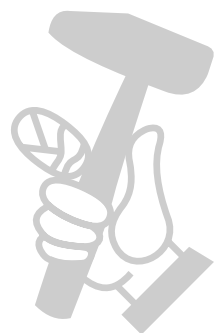

МАГАЗИН МАЙСТОРА®
БАШ МАЙСТОРА®
ПРОФЕСИОНАЛНИ РЕШЕНИЯ