

ROTHENBERGER

RODRUM S

RODRUM S



DE Bedienungsanleitung
EN Instructions for use
FR Instruction d'utilisation
ES Instrucciones de uso
IT Istruzioni d'uso
NL Gebruiksaanwijzing
PT Instruções de serviço
DA Brugsanvisning
SV Bruksanvisning
NO Bruksanvisning
FI Käyttöohje

PL Instrukcja obsługi
CZ Návod k používání
TR Kullanım kilavuzu
HU Kezelési útmutató
SL Navodilo za uporabo
SK Návod na obsluhu
BG Инструкция за експлоатация
EL Οδηγίες χρήσεως
RU Инструкция по использованию
CN 使用说明书



www.rothenberger.com

A Overview

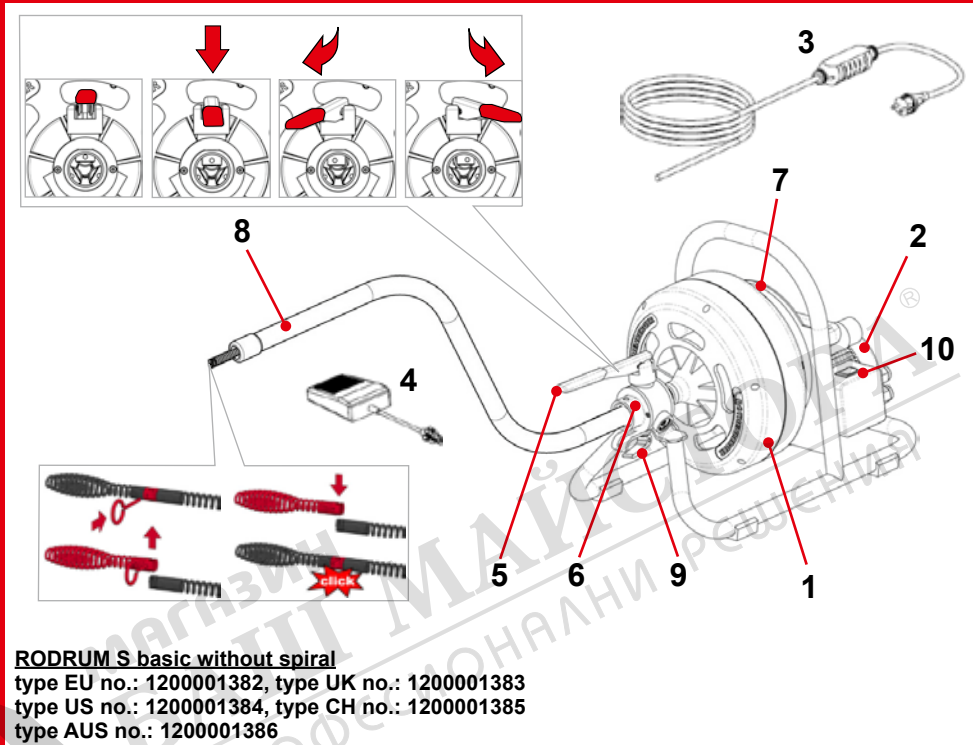

B Operating

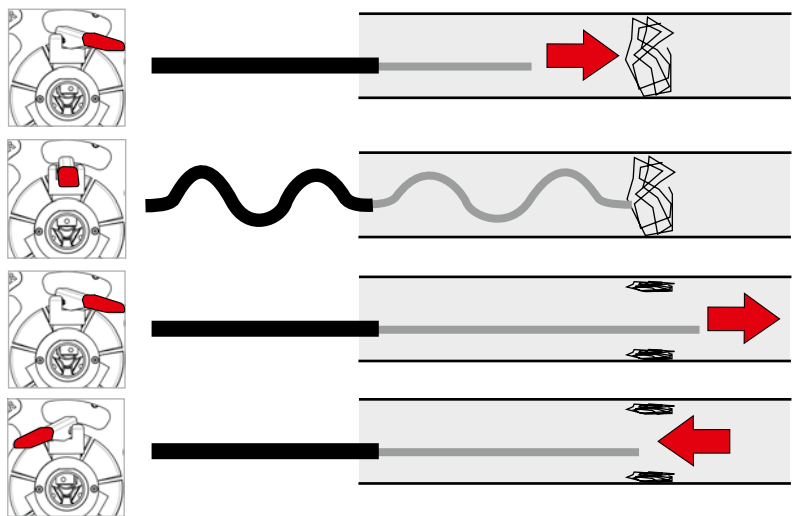

1	Safety Notes	12
1.1	General safety instructions.....	12
1.2	Special safety instructions.....	13
1.3	Residual risks.....	13
1.4	Intended use.....	14
2	Technical Data	14
3	Scope of delivery	14
4	Power connection	15
4.1	Putting the PRCD switch into operation.....	15
5	Function of the Unit	15
5.1	Overview (A).....	15
5.2	Commissioning.....	15
5.3	Coupling/decoupling the tools / spirals.....	16
5.4	Operation (B).....	16
5.5	Removing the pipe blockage.....	16
5.6	Pull the spiral back out of the pipe.....	16
5.7	Shut-down.....	17
5.8	Changing the spiral drum.....	17
6	Care and Maintenance	17
6.1	Inserting new spirals.....	17
7	Troubleshooting	18
8	Accessories	18
9	Customer service	18
10	Disposal	18

Markings in this document:



Danger!

This sign warns against the danger of personal injuries.



Caution!

This sign warns against the danger of property damage and damage to the environment.



Call for action

1.1 General safety instructions



ATTENTION! When using electric tools, the following fundamental safety measures must be taken to prevent electric shock, injury or fire.

Read all of these instructions before you use the electric tool, and store the safety instructions properly.

Service and maintenance:

- 1 Regular cleaning, maintenance and lubrication.** Always pull the electrical plug before any adjustment, maintenance or repair.
- 2 Have your device repaired only by qualified experts and only with original replacement parts.** This ensures the continued safety of the device.

Working safely:

- 1 Keep your work area orderly.** A messy work area can cause accidents.
- 2 Consider environmental influences.** Do not expose electric tools to rain. Do not use electric tools in damp or wet environments. Keep the work area well lit. Do not use electric tools where there is a risk of fire or explosion.
- 3 Protect yourself from electric shock.** Avoid physical contact with earthed parts (such as pipes, radiators, electric stoves or cooling devices).
- 4 Keep other people away.** Do not let other people — especially children — touch the electric tool or its cable. Keep them away from the work area.
- 5 Store electric tools safely when they are not in use.** Unused electric tools should be kept in a dry, high or closed area, out of reach of children.
- 6 Do not overload your electric tool.** Work is better and safer within the performance range indicated.
- 7 Use the right electric tool.** Don't use low-performance machines for heavy-duty jobs. Do not use the electric tool for purposes for which it was not intended. For example, do not use a portable circular saw for cutting tree branches or logs.
- 8 Wear proper clothing.** Do not wear loose clothing or jewellery, as they can get caught in moving parts. When working outdoors, wear slip-resistant shoes. Wear a hairnet over long hair.
- 9 Use protective gear.** Wear safety glasses. Wear a breathing mask during work that creates dust.
- 10 Connect the dust extraction equipment.** If there are connections to dust extraction and collection equipment, make sure that they are connected and properly used.
- 11 Do not use the cable for purposes for which it was not intended.** Never use the cable to pull the plug from the socket. Protect the cable from heat, oil and sharp edges.
- 12 Secure the work piece.** Use clamps or a vice to hold the work piece firmly. They will hold it more securely than your hand can.
- 13 Avoid abnormal postures.** Make sure to stand securely and always keep your balance.
- 14 Maintain your tools with care.** For better and safer work, keep cutting tools sharp and clean. Follow the instructions for lubrication and changing tools. Regularly inspect the electric tool's connection cable, and if it is damaged, have it replaced by an authorized expert. Regularly check extension cords and replace them if they are damaged. Keep the handles dry, clean and free of oil and grease.
- 15 Pull the plug from the socket.** When not using the electric tool, before maintenance or when changing tools, such as saw blades, drills and cutting bits.
- 16 Do not leave any tool keys inserted.** Before switching on, check to see that keys and adjustment tools have been removed.
- 17 Avoid unintentional activation.** When plugging the tool in, make sure that the switch is turned off.

- 18 **Use outdoor extension cords.** When outdoors, use only extension cords that are approved and appropriately marked.
- 19 **Be alert.** Pay attention to what you do. Approach your work sensibly. Do not use the electric tool when you are distracted.
- 20 **Check the electric tool for damage.** Before using the electric tool, you must inspect safety equipment or slightly damaged parts carefully to ensure that they work properly and as intended. Check to see that the moving parts operate freely and don't stick, and to make sure no parts are damaged. All parts must be mounted properly and meet all the conditions for ensuring trouble-free operation of the electric tool.
- Damaged safety equipment and parts must be properly repaired or replaced by a professional facility, unless otherwise indicated in the user manual. Damaged switches must be replaced by a customer service facility.
- Never use an electric tool whose switch cannot be turned on and off.
- 21 **Caution.** Using other insertion tools and accessories may cause injury.
- 22 **Have your tool repaired by an electrical expert.** This electric tool meets applicable safety requirements. Repairs must be made only by an electrical expert using original replacement parts. Otherwise accidents may occur.

1.2 Special safety instructions

Wear rubber boots (for insulation) when performing cleaning work.

Before inserting the plug into the electrical socket, make absolutely sure that the pipe cleaning machine is switched to 0 or OFF.

Whenever using electrical devices, always observe the specified voltage and generally work with a protective tube and safety gloves.

Choose the right tool for the clog and for the pipe diameter to be cleaned, in order to prevent the tool from hooking into the clog and the spiral from ejecting from the pipe.

To prevent damage, use this machine and its accessories only to clean waste water pipes — never chimneys, wells, etc.

To prevent damage to the pipes or pipe bends, do not modify tools by whetting them, etc..

Use a camera system to spot the cause of the pipe clog.

Only work on perfect lines installed according to the "VDE regulations".

The spirals must never run over the guide tube!

Mechanical pipe cleaning should always be undertaken from above in the direction of the stop plug.

Ensure that no water taps leading to the pipe to be processed are actuated during the pipe cleaning. Congestion can occur here!

During pipe cleaning never leave the machine unobserved!



Protective covers: All rotating parts are made safe through use of protective covers. Removal and/ or operation without these protective covers is strictly forbidden!

Secure the operation site (the road, the shaft) so that no uninvolved persons suffer injuries and always cover open shafts or gullies.

Check the area to be investigated with a gas warner for the presence of poisonous or explosive gases!

The machine and the accessories should be cleaned and disinfected after every use.

The recommended personal protective equipment should be worn whenever any work is done: Safety helmet, safety shoes, safety vest!

The hands should be cleaned and disinfected after every activity; there is increased risk of infection by pathogens!

1.3 Residual risks

Even when observing all of the safety instructions there are still some residual risks remaining, for example: spirals can overturn (create a loop if the operating arc is too large) thereby creating the risk of clamping. Spirals under tension can spring out of the pipe ~ a risk of injury!

1.4 Intended use

The pipe cleaning machines may only be used to clean pipes of the following diameters:

RODRUM S: 40-100mm

The pipe cleaning machines are only designed for short term operation and may therefore only be operated without interruption for a maximum of 15 minutes! Do not use this product in any other way as stated for normal use!

2 Technical Data

Voltage.....	230V / 110/120V – 50/60 Hz
Output P1.....	440 W
Dimensions (L x W x H).....	580 x 330 x 395 mm
Empty weight.....	about 15,5kg
Spiral type.....	Ø 10mm and Ø 13mm
Max. spiral length in the drum.....	15m
Max. working length.....	14,5m
Pipe diameter working range.....	Ø 40-100mm
Speed of the spiral.....	about 6-7 m/min (according to the pipe route)
Direction of rotation (switch position I).....	left (looking from the front onto the drum)
Protection type.....	IP X4
Operating mode.....	S2 15min.
Sound pressure level (L _{pA}).....	79 dB (A) † K _{pA} 3 dB (A)
Sound power level (L _{WA}).....	90 dB (A) † K _{WA} 3 dB (A)
The noise level during operation can exceed 85 dB (A). Wear hearing protection!	
Measured values determined in accordance with EN 61029-1:2010.	
Vibration total value.....	< 2,5 m/s ² † K= 1,5m/s ²

The vibration level given in this information sheet has been measured in accordance with a standardised test given in EN 61029 and may be used to compare one tool with another. It may be used for a preliminary assessment of exposure.



The declared vibration emission level represents the main applications of the tool. However if the tool is used for different applications, with different accessories or insertion tools or is poorly maintained, the vibration emission may differ. This may significantly increase the exposure level over the total working period.

An estimation of the level of exposure to vibration should also take into account the times when the tool is switched off or when it is running but not actually doing the job. This may significantly reduce the exposure level over the total working period.

Identify additional safety measures to protect the operator from the effects of vibration such as: maintain the tool and the accessories, keep the hands warm, organisation of work patterns.

3 Scope of delivery

- Pipe cleaning machine.RODRUM S
- Guide tube
- Operating manual
- tool case (only for RODRUM S13)

4 Power connection

Connect only to the single-phase alternating current indicated on the rating plate. Connect only to sockets with protective contacts. The machine must be operated only through a ground fault circuit with max. 30 mA rated leakage current.

Connection: Insert the device into an electrical socket and press the green "RESET" button.

Once the red function display has lit up, the device is ready to operate. Whenever it is unplugged, or the power fails, the device automatically shuts off.

Operational test: Press the blue "TEST" button: The device shuts off. Press the "RESET" button: Once the red operation display has lit up, the device is ready to operate.

Always perform the operational test before starting up the device. If there is a repeated failure, have the connected device inspected.

Please keep in mind that this device cannot replace fundamental safety precautions. To prevent life-threatening hazards, be sure to use electrical devices only as intended.

Reliable personal protection against electric shock. Fault currents are recognized in a fraction of a second, and the current supply is immediately interrupted. The risk to humans and animals is drastically reduced.

- Never use the electric tool without a PRCD.
- The plug or electrical cord should be replaced only by the manufacturer of the electric tool or by its repair service.
- Keep water away from electrical parts of the electric tool and from people in the work area.

4.1 Putting the PRCD switch into operation



Only suitable for AC current! Note the mains network voltage!

Perform the following test procedure on the PRCD switch before every putting into operation of the device:

1. Connect the PRCD plug connector with the socket.
2. Press on RESET. The indicator switches to RED (ON).
3. Pull the plug connector out of the socket. The display switches itself off.
4. Repeat 1. and 2.
5. Press on TEST. The red indicator switches itself off.
6. Press on RESET to switch the device on (RED).



These protective device protect against faults in the attached device, not against such faults in the preceding plant.

5 Function of the Unit

5.1 Overview

(A)

1	Drum	6	Feed unit
2	Motor	7	Drainage plug
3	Network cable with PRCD	8	Guide tube
4	Foot switch	9	Clamping grip
5	Feed unit handle	10	Motor switch

5.2 Commissioning



The pipe cleaning machine should exclusively be operated by instructed and authorised personnel!

- Check the electrical installation at the work place
- Place the foot switch in such a way that it can be easily reached and that all control elements are easy to operate.
- Connect the mains power plug to the appropriate power supply network.



Ensure that the motor switch is set to "OFF"!

5.3 Coupling/decoupling the tools / spirals

Coupling:

→ Push the tool / spiral until it engages with the coupling.

Decoupling:

→ Push the segregation key into the bore and push the tool / spiral to the side out of the coupling.

5.4 Operation

(B)



Operation of the pipe cleaning machine may only be performed while taking account of all notes concerning safety of people and the machine!

Moving the spiral into the pipe:

→ Place the machine at a distance of about 1 m to the opening of the pipe to be cleaned.

→ Push the guide tube (8) over the spiral up to the dead stop on the feed unit housing and fix in place with the catch.

→ Couple a suitable tool at the front (p. 6.3). Select the tool according to the type of dirt/fouling (being removed). Ensure correct seating!



Put on gloves before any further manual operations are performed!

→ At the motor switch, switch the machine to ready-to-operate (switch position I).

→ Hold the spiral with guide tube in the hand and switch on the motor at the foot switch (4).

→ The spiral feed is infinitely controlled (forwards, neutral and backwards) using the pressed feed unit handle.

5.5 Removing the pipe blockage



The spiral should bore its way into the blockage material; it should not be pressed in.

→ If there is a perceptible counterpressure (from the blockage) and the spiral is pretensioned in a bowed apparatus, put the feed unit handle in neutral (the spiral simply turns on the spot) and push the bowed apparatus against the blockage.

→ If the spiral has penetrated into the pipe so that the bowed apparatus is detensioned, set the hand lever to feed again.

→ Repeat these processes until the blockage has been removed.



If there are increased loads on the spiral (recognisable by rearing up of the guide tube (8)), release the feed unit handle immediately to release the pressure on the spiral!

5.6 Pull the spiral back out of the pipe

→ After successful removal of the blockage, put the feed unit handle into return travel in order to pull the spiral back into the drum.



Ensure that the spiral comes back without any great effort. If the return transport is difficult, run the spiral a short distance back into the pipe. Do not pull back the spiral by force.

→ During return travel of the spiral out of the pipe, place a water hose at the mouth of the pipe and flush off the dirty spiral with water. In this way the cleaned pipe is also flushed out.

→ If the coupled tool is visible again, release the feed unit handle, switch off the motor using the foot switch and the motor switch and remove the tool and the guide tube again.

→ Switch on the motor again and move back the spiral until it protrudes about 20cm out of the feed unit.



The spiral should never be fully moved back out of the drum!

5.7 Shut-down

- Switch off the machine through actuation of the motor switch and pull out the mains power plug.
- Remove the guide tube from the device.
- To empty water out of the spiral drum, remove the drum from the machine (p. 6.8) and remove the dewatering stop plug (7).
- Insert the dewatering stop plug again and fasten the spiral drum again.

5.8 Changing the spiral drum



Only change the spiral drum when the device is completely deenergized!

- Release the clamping grip (9) and push the feed unit to the front up to the dead stop.
- Pull the spiral drum to the front in the axial direction and remove.
- Push new spirals through the feed unit and push the spiral drum in an axial direction onto the axis in the frame.
- Push the feed unit back again and fix in place with the clamping grip.



Ensure that all parts are free of dirt and are adequately greased!

6 Care and Maintenance



Pull out the mains power plug before performing any servicing and maintenance!

The machine is maintenance-free except for the feed unit.

Clean and grease the feed unit regularly and check it for damage. The ball bearings can be replaced if necessary.

The device should be handled carefully and cleaned regularly.

The spirals and tools should be cleaned and preserved after every use. We recommend use of our special care product "ROWONAL".



All servicing, maintenance and repair work may only be performed by instructed specialist personnel!

6.1 Inserting new spirals

- Remove the spiral drum (p. 6.8).
- Pull the spirals out of the drum by hand completely.
- First introduce new spirals with the kinked end into the drum and push in the spiral up to about 30 cm.
- Re-insert the spiral drum (p. 6.8).

7 Troubleshooting

Symptom	Possible Reason	Solution
The machine does not start	No power supply	Check the power supply network
	Motor defective	Contact our Customer Service Department
	Switch off the PRCD	Press the RESET button (PRCD)
	The foot switch / compressed air hose is defective	Contact our Customer Service Department
No feed	Ball bearing in the feed unit is defective	Contact our Customer Service Department
	Spiral defective	Replace the spiral

8 Accessories

Accessory Name	ROTHENBERGER Part Number
Welder's glove, left	72120
Welder's glove, right	72121
ROWONAL rust remover (5 l)	72140
ROWONAL spiral combi-spray (0.2 l)	72142
Guide tube	1300002581
Segregation key	72100
10 mm spiral	1500002203
13 mm spiral	72016
www.rothenberger.com	

9 Customer service

The ROTHENBERGER service locations are available to help you (see listing in catalog or online) and replacement parts and service are also available through these same service locations. Order your accessories and spare parts from your specialist retailer or using RoService+ online:

Phone: + 49 (0) 61 95 / 800 – 8200

Fax: + 49 (0) 61 95 / 800 – 7491

Email: service@rothenberger.com

www.rothenberger.com

10 Disposal

Components of the unit are recyclable material and should be put to recycling. For this purpose registered and certified recycling companies are available. For an environmental friendly disposal of the non-recyclable parts (e.g. electronic waste) please contact your local waste disposal authority.

For EU countries only:



Do not dispose electric tools with domestic waste. In accordance with the European Directive 2012/19/EU the disposal of electrical and electronic equipment and its implementation as national law, electric tools that are no longer serviceable must be collected separately and utilised for environmentally compatible recycling.