

Denominazione:

ESPLOSO UNITA' MOTRICE

FX2000



LAE SRL

Data : **16/09/11**

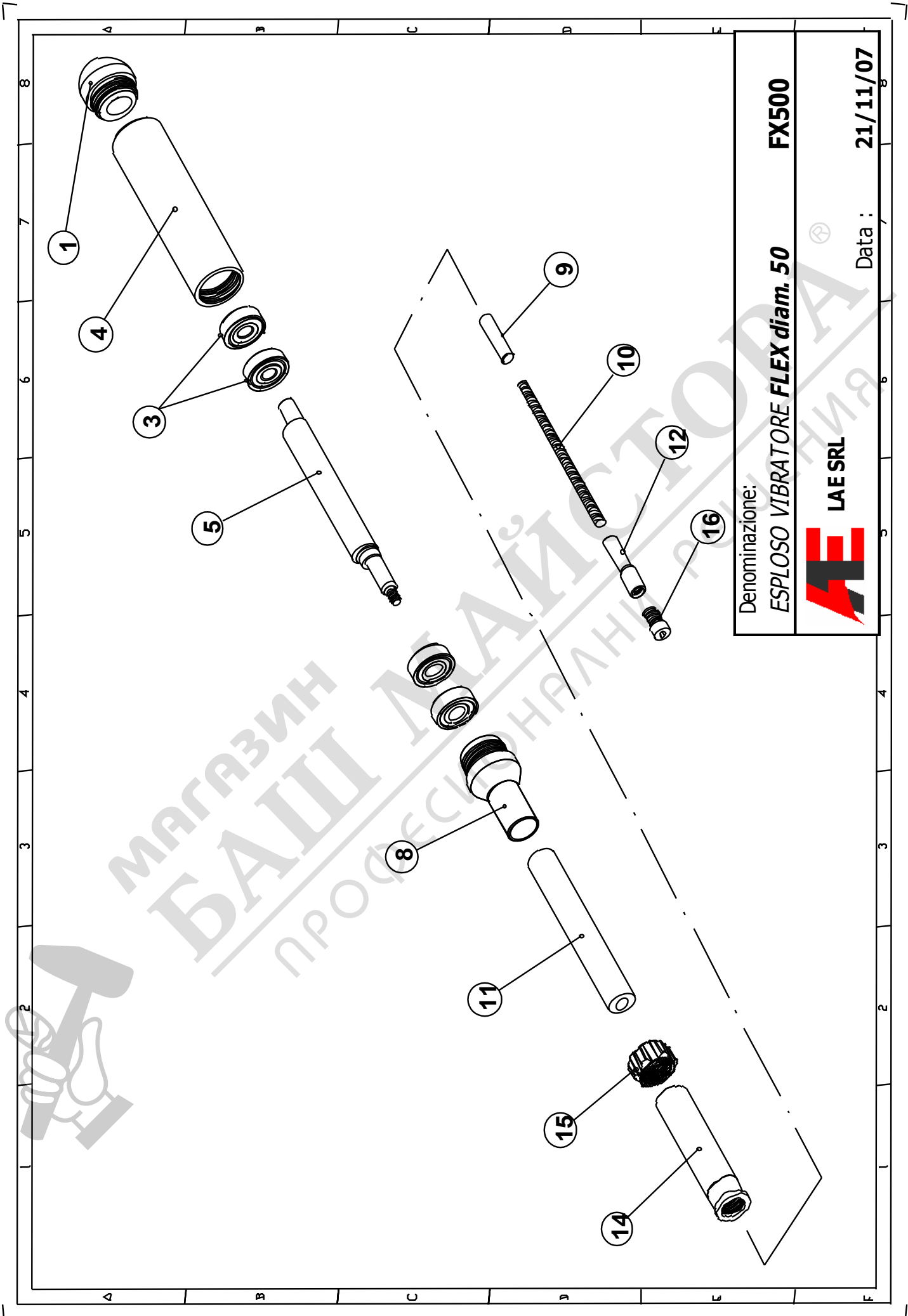

Denominazione: **ESPLOSO VIBRATORE FLEX diam. 50** **FX500**

LAES SRL  **®**

Data: **21/11/07**



Listino ricambi **VIBRATORI FLEX serie FX** -2014

Spare parts price list for **FLEXIBLE VIBRATOR - FX** - 2014

| Pos. | Cod. | Descrizione | description |
|------|--------|--|--|
| 16 | FX0100 | Giunto esagonale femmina | Female exagonal coupling |
| 12 | FX0200 | Manicotto di traino FX x tutti i Ø | sleeve driver Fx (for all Ø) |
| 10 | FX0300 | Corda flessibile / mt. | flexible shaft /mt |
| 9 | FX0400 | Giunto traino eccentrico x Ø 30-34-38-43-50-60 | coupling-eccentric-drive Ø 30-34-38-43-50-60 |
| 9 | FX0425 | Giunto traino eccentrico x Ø 25 | coupling-eccentric-drive Ø 25 |
| 14 | FX0500 | Manicotto innesto | coupling sleeve |
| 15 | FX0600 | Ghiera manicotto | sleeve ring nut |
| 11 | FX0700 | Tube flessibile / m. | flexible hose |
| 8 | FX0825 | Supporto posteriore diam. 25 | rear support Ø 25 |
| 8 | FX0830 | Supporto posteriore diam. 30 | rear support Ø 30 |
| 8 | FX0834 | Supporto posteriore diam. 34 | rear support Ø 34 |
| 8 | FX0838 | Supporto posteriore diam. 38 | rear support Ø 38 |
| 8 | FX0843 | Supporto posteriore diam. 43 | rear support Ø 43 |
| 8 | FX0850 | Supporto posteriore diam. 50 | rear support Ø 50 |
| 8 | FX0860 | Supporto posteriore diam. 60 | rear support Ø 60 |
| 3 | FX0925 | Cuscinetto diam. 25 - 607zz | bearing diam. 25 |
| 3 | FX0930 | Cuscinetto diam. 30 - 608zz | bearing diam. 30 |
| 3 | FX0934 | Cuscinetto diam. 34 - 6001zz | bearing diam. 34 |
| 3 | FX0938 | Cuscinetto diam. 38 - 6201zz | bearing diam. 38 |
| 3 | FX0943 | Cuscinetto diam. 43 - 6202zz | bearing diam. 43 |
| 3 | FX0950 | Cuscinetto diam. 50 - 6302zz | bearing diam. 50 |
| 3 | FX0960 | Cuscinetto diam. 60 - 6304zz | bearing diam. 60 |
| 5 | FX1125 | Eccentrico tondo diam. 25 | eccentric diam. 25 |
| 5 | FX1130 | Eccentrico tondo diam. 30 | eccentric diam. 30 |
| 5 | FX1134 | Eccentrico tondo diam. 34 | eccentric diam. 34 |
| 5 | FX1138 | Eccentrico tondo diam. 38 | eccentric diam. 38 |
| 5 | FX1143 | Eccentrico tondo diam. 43 | eccentric diam. 43 |
| 5 | FX1150 | Eccentrico tondo diam. 50 | eccentric diam. 50 |
| 5 | FX1160 | Eccentrico tondo diam. 60 | eccentric diam. 60 |
| 4 | FX1225 | Canna diam. 25 | steel tube diam. 25 |
| 4 | FX1230 | Canna diam. 30 | steel tube diam. 30 |
| 4 | FX1234 | Canna diam. 34 | steel tube diam. 34 |
| 4 | FX1238 | Canna diam. 38 | steel tube diam. 38 |
| 4 | FX1243 | Canna diam. 43 | steel tube diam. 43 |
| 4 | FX1250 | Canna diam. 50 | steel tube diam. 50 |
| 4 | FX1260 | Canna diam. 60 | steel tube diam. 60 |
| 1 | FX1325 | Testina + o.r diam.25 | head + o.r. diam.25 |
| 1 | FX1330 | Testina + o.r diam.30 | head + o.r. diam.30 |
| 1 | FX1334 | Testina + o.r diam.34 | head + o.r. diam.34 |
| 1 | FX1338 | Testina + o.r diam.38 | head + o.r. diam.38 |
| 1 | FX1343 | Testina + o.r diam.43 | head + o.r. diam.43 |
| 1 | FX1350 | Testina + o.r diam.50 | head + o.r. diam.50 |
| 1 | FX1360 | Testina + o.r diam.60 | head + o.r. diam.60 |



Listino ricambi **UNITA' MOTRICE serie FX** -2014

Spare parts price list for **DRIVE UNIT – FX-2014**

| Pos. | Cod. | Descrizione | description |
|------|--------|------------------------------------|----------------------|
| 1/2 | FX0001 | Carcassa fronte / retro | housing |
| 4 | FX0002 | Dado cieco M5 | blind nut |
| 5 | FX0003 | Porta cuscinetti (muso) | bearing holder |
| 6 | FX0004 | Ventola | fan |
| 7 | FX0005 | Tappo | plug |
| 8 | FX0006 | Tappo vite spazzola | cap-brush-screw |
| 9 | FX0007 | Spazzola | brush |
| 10 | FX0008 | Rotore | rotos assembly |
| 11 | FX0009 | Cuscinetto d. 28x12x8 - 6001 | bearing Ø 28x12x8 |
| 12 | FX0010 | Anello compensazione | compensation ring |
| 13 | FX0011 | Statore | stator assembly |
| 14 | FX0012 | Porta spazzole | brush holder |
| 15 | FX0013 | Cuscinetto d.35x17x10-6003 | bearing Ø 35x17x10 |
| 16 | FX0014 | Fissacavo in ferro 10/12 | iron cable clamp |
| 17 | FX0015 | Passacavo | cable entry fitting |
| 18 | FX0016 | Protezione interruttore | plastic cover switch |
| 18 | FX0017 | Interruttore | switch |
| 19 | FX0018 | Vite M5x90 | screw M5x90 |
| 20 | FX0019 | Vite M5x20 | screw M5x20 |
| 22 | FX0020 | Cavo 3G1,5 – prezzo al pezzo 1,5mt | cable 3G1,5 |
| 22 | FX0021 | Spina 220V | plug 220V |
| 25 | FX0024 | Boccola completa | complete bushing |
| 26 | FX0025 | Anello cuscinetto | ring bearing |
| 28 | FX0028 | cuscinetto 35x15x11 (6202zz) | bearing 35x15x11 |
| 29 | FX0029 | seeger/anello di tenuta | seeger |
| 30 | FX0030 | conghia con ganci | belt |



LISTINO RICAMBI VIBRATORI FLEX SERIE FX

