

# Nail Plug - ND

Nail plug, countersunk collar  
KEW ND S

Nail plug, cylindrical collar  
KEW ND Z

Nail plug, large cylindrical collar  
KEW ND ZG

Nail plug with connecting thread  
KEW ND M  
Nail plug, mushroom  
KEW ND P

shaped collar  
KEW ND P

pre-assembled with zinc plated nailscrew

## Characteristics

- time saving fixing system consisting of plug and nailscrew
- plug is pre-assembled: nailscrew is already pre-installed in plug
- Nailscrew is hammered in, no screw driver needed
- setting locks inside the plug prevent premature expansion during installation
- plug and fixture can easily be removed by turning out the screw

## Advice

Nail plugs may only be installed as through-fixings; the fixture may not be positioned between screw head and plug collar. If installed in hollow base material the plug should be long enough to at least allow for expansion in the second brick chamber.

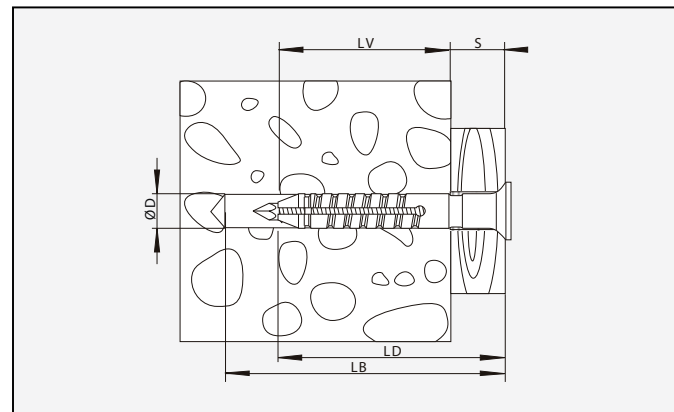

## Suitability

Base materials:

concrete, solid materials, limited suitability for aircrete, hollow blocks, perforated bricks

For fixing of:

tal sheets, battens, cable and pipe clamps, claddings, wooden and metal supporting constructions

## Pullout loads in kN\*

	concrete C20/25	solid bricks Mz 12	aircrete P2
ND 5 mm	0,9	0,8	0,2
ND 6 mm	1,3	1,1	0,3
ND 8 mm	1,8	1,7	0,4

\* the loads stated are failure loads valid for general fixings and confirmed strength of the base material indicated. Lower loads apply in case of render, insulating material, non load bearing areas of the base material or too small edge/joint distances. An adequate safety factor should be applied.

## Installation

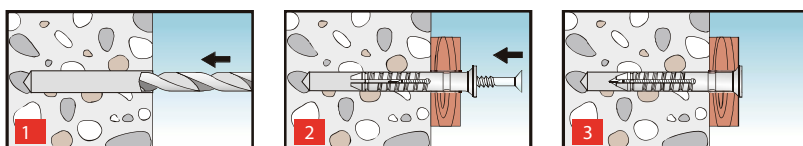

## Technical Data



**KEW ND S** - Nail plug with countersunk collar and pre-assembled nailscrew, zinc plated

type	ref.-no.	ØD Ø plug Ø bit [mm]	LD plug length [mm]	LB min. drill depth [m]	LV min. an- chorage depth [mm]	S max. fixt. thickn. [mm]	qty. per box pcs.	outer carton pcs.
ND 5x 30/ 5 S	32682	5	30	40	25	5	100	3600
ND 5x 36/ 11 S	32683	5	36	46	25	11	100	2700
ND 5x 40/ 15 S	32684	5	40	50	25	15	100	2700
ND 5x 50/ 25 S	32685	5	50	60	25	25	100	2700
ND 6x 35/ 5 S	32686	6	35	45	30	5	50	1800
ND 6x 40/ 10 S	32687	6	40	50	30	10	50	1800
ND 6x 50/ 20 S	32688	6	50	60	30	20	50	1800
ND 6x 60/ 30 S	32689	6	60	70	30	30	50	1800
ND 6x 75/ 45 S	32690	6	75	85	30	45	50	1350
ND 6x 80/ 50 S	32691	6	80	90	30	50	50	1350
ND 8x 40/ 5 S	36707	8	40	50	35	5	50	800
ND 8x 60/ 20 S	32692	8	60	70	40	20	50	800
ND 8x 80/ 40 S	32693	8	80	90	40	40	50	800
ND 8x 100/ 60 S	32694	8	100	110	40	60	50	800
ND 8x 120/ 80 S	32695	8	120	130	40	80	50	400
ND 8x 140/ 100 S	32696	8	140	150	40	100	50	400
ND 8x 160/ 120 S	32697	8	160	170	40	120	50	300



**KEW ND S A2** - Nail plug with countersunk collar and pre-assembled nailscrew of stainless steel A4/ 316

ND 6x 40/ 10 S A2	36710	6	40	50	30	10	50	1800
ND 6x 60/ 30 S A2	36711	6	60	70	30	30	50	1800
ND 8x 60/ 20 S A2	36712	8	60	70	40	20	50	800
ND 8x 80/ 40 S A2	36713	8	80	90	40	40	50	800

## Technical Data



**KEW ND Z** - Nail plug with cylindrical collar and pre-assembled nailscrew, zinc plated

type	ref.-no.	ØD Ø plug Ø bit [mm]	LD plug length [mm]	LB min. drill depth [m]	LV min. an- chorage depth [mm]	S max. fixt. thickn. [mm]	qty. per box pcs.	outer carton pcs.
ND 5x 30/ 3 Z	33171	5	30	40	25	3	100	3600
ND 5x 36/ 9 Z	33172	5	36	46	25	9	100	2700
ND 5x 40/ 13 Z	33173	5	40	50	25	13	100	2700
ND 5x 50/ 23 Z	33174	5	50	60	25	23	100	1600
ND 6x 35/ 3 Z	33175	6	35	45	30	3	50	1800
ND 6x 40/ 8 Z	33176	6	40	45	30	8	50	1800
ND 6x 50/ 18 Z	33177	6	50	60	30	18	50	1800
ND 6x 60/ 28 Z	33178	6	60	70	30	28	50	1800
ND 6x 75/ 43 Z	33179	6	75	85	30	43	50	1350
ND 6x 80/ 48 Z	33180	6	80	90	30	48	50	1350
ND 8x 40/ 3 Z	36708	8	40	50	35	3	50	800
ND 8x 60/ 18 Z	33181	8	60	70	40	18	50	800
ND 8x 80/ 38 Z	33182	8	80	90	40	38	50	800
ND 8x 100/ 58 Z	33183	8	100	110	40	58	50	800
ND 8x 120/ 78 Z	33184	8	120	130	40	78	50	800
ND 8x 140/ 98 Z	33185	8	140	150	40	98	50	800
ND 8x 160/ 118 Z	33186	8	160	170	40	118	50	300



**KEW ND ZG** - Nail plug with large cylindrical collar and pre-assembled nailscrew with large head, zinc plated, specially suited to fix skirting boards

ND 6x 35/ 3 ZG	36714	6	35	45	30	3	50	1800
ND 6x 50/ 18 ZG	36715	6	50	60	30	18	50	1800
ND 6x 60/ 28 ZG	36716	6	60	70	30	28	50	1800
ND 8x 80/ 38 ZG	36717	8	80	90	40	38	50	800
ND 8x 100/ 58 ZG	36718	8	100	110	40	58	50	800



**KEW ND M** - Nail plug with cylindrical collar and pre-assembled nailscrew, zinc plated, with metric connecting thread

ND 6x 40 M6	32016	6	40	50	30		100	1600
ND 8x 60 M8	32017	8	60	70	40		100	800



**KEW ND P** - Nail plug with mushroom shaped collar and pre-assembled nailscrew, zinc plated

ND 6x 35/ 3 P	32012	6	35	45	30	3	100	1600
ND 6x 40/ 8 P	32013	6	40	45	30	8	100	1600
ND 6x 50/ 18 P	32014	6	50	60	30	18	100	1600
ND 6x 60/ 28 P	32015	6	60	70	30	28	100	1600
ND 8x 40/ 3 P	36709	8	40	50	35	3	50	800