

# Part Diagram

Model No.HR3001C 30MM COMBINATION HAMMER

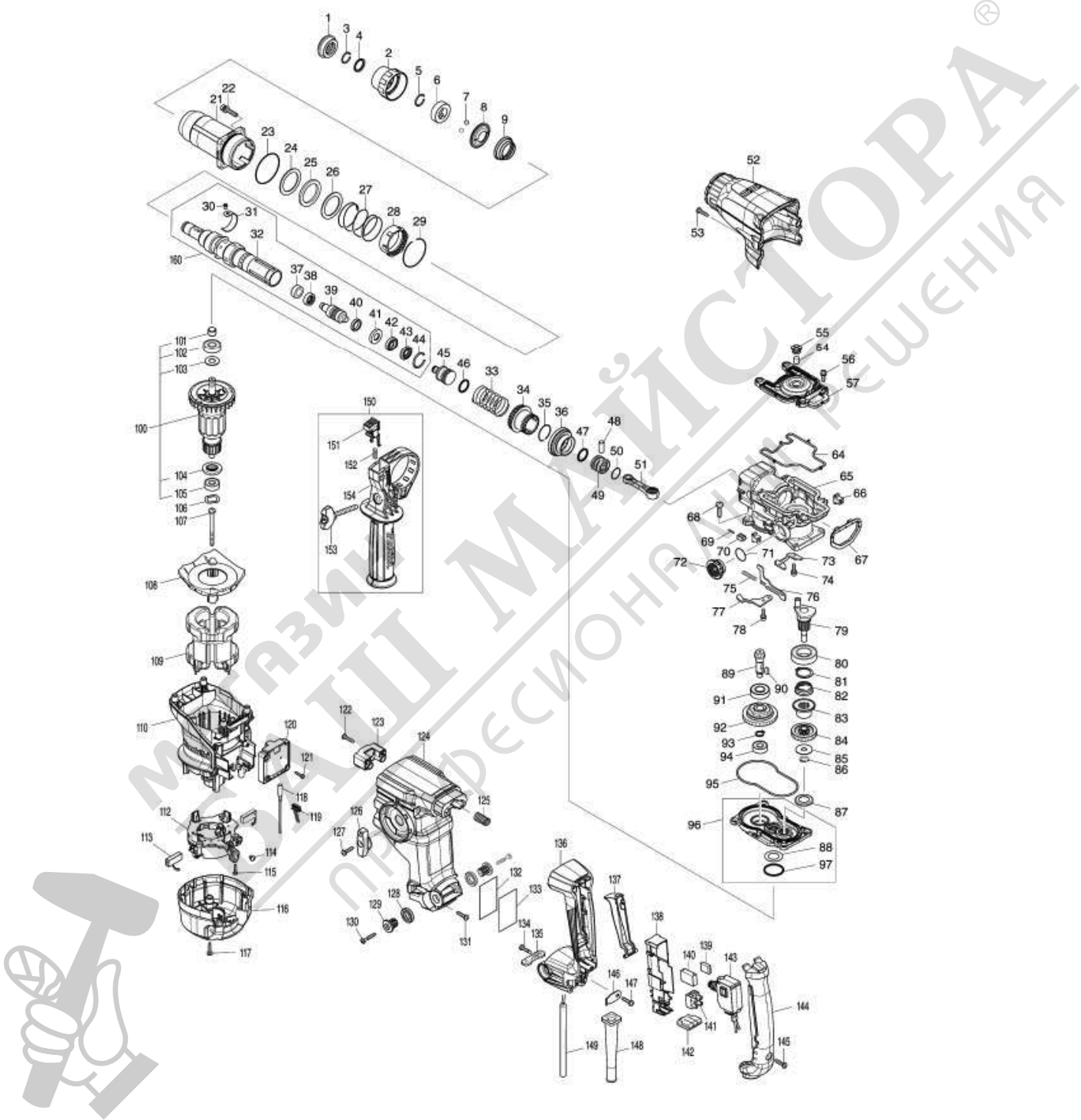

Item	Sub	Parts No.	Parts Description	Qty
1		286288-8	CAP 35	1
2		459685-3	CHUCK COVER	1
3		233989-9	RING SPRING 14	1
4		346834-0	WASHER 16	1
5		233992-0	RING SPRING 15	1
6		327269-4	RING 17	1
7		216022-2	STEEL BALL 7.0	2
8		347553-1	GUIDE WASHER	1
9		232503-8	CONICAL COMP. SPRING 21-34	1
21		140J35-0	BARREL COMPLETE	1
21	C10	213636-8	OIL SEAL 25	1
22		266793-1	HEX. S.H.B. M5X25 WITH WR	4
23		213620-3	O RING 46	1
24		267354-0	FLAT WASHER 31	1
25		422493-5	RUBBER RING 31	1
26		267354-0	FLAT WASHER 31	1
27		232496-9	COMPRESSION SPRING 37	1
28		419986-1	LOCK SLEEVE	1
29		233952-2	RING SPRING 41	1
30		256598-7	SHOULDER PIN 4	1
31		347501-0	LEAF SPRING	1
32		327277-5	TOOL HOLDER	1
33		232497-7	COMPRESSION SPRING 27	1
34		327276-7	DRIVING SLEEVE	1
35		232501-2	RING SPRING 24	1
36		226868-8	SPIRAL BEVEL GEAR 31	1
37		327515-5	SLEEVE 11	1
38		327516-3	RING 11	1
39		140S89-1	IMPACT BOLT A COMPLETE	1
40		213880-7	SEAL RING 12	1
41		327268-6	RING 11	1
42		424267-0	CUSHION RING 12	1
43		327271-7	WASHER 11	1
44		231987-7	RING SPRING 21	1
45		327266-0	STRIKER	1
045-1		327838-1	STRIKER	1
46		213881-5	O RING 16	1
47		213881-5	O RING 16	1
48		268122-4	PIN 7	1
49		319807-6	PISTON	1
50		213226-7	O RING 16	1
51		140J36-8	CONNECTING ROD COMPLETE	1
52		459165-9	BARREL COVER	1
53		266326-2	TAPPING SCREW 4X18	2
54		443153-6	FELT	1
55		459180-3	FILTER CAP	1
56		922123-3	HEX. SOCKET HEAD BOLT M4X14	4
57		319846-6	CRANK CAP	1
64		459182-9	SEAL RING B	1
65		140J33-4	CRANK HOUSING COMPLETE	1
66		455165-7	FIX GUIDE	2
67		422492-7	CUSHION	1
68		266420-0	TAPPING SCREW 5X20	4
068-1		266021-4	TAPPING SCREW 5X20	4
69		232499-3	COMPRESSION SPRING 2	1
70		310929-5	PUSH CORN	1
71		213262-3	O RING 18	1
72		459175-6	LINK LEVER	1
73		347497-5	BEARING RETAINER A	1

Item	Sub	Parts No.	Parts Description	Qty
74		922123-3	HEX. SOCKET HEAD BOLT M4X14	2
75		234019-9	COMPRESSION SPRING 4	1
76		345814-3	LINK PLATE	1
77		347498-3	GUIDE PLATE	1
78		922123-3	HEX. SOCKET HEAD BOLT M4X14	1
79		140M22-7	CRANK SHAFT COMPLETE	1
80		211323-3	BALL BEARING 6904LLU	1
81		961060-6	RETAINING RING S-20	1
82		232498-5	CONICAL COMP. SPRING 21-26	1
83		327273-3	CLUTCH	1
84		226869-6	HELICAL GEAR 31	1
85		267353-2	FLAT WASHER 8	1
86		961034-7	RETAINING RING	1
87		345818-5	CUP WASHER 16	1
88		253749-3	FLAT WASHER 16	1
89		226867-0	SPIRAL BEVEL GEAR 8	1
90		254239-9	KEY 4	1
91		211131-2	BALL BEARING 6001DDW	1
92		125386-2	TORQUE LIMITER ASS'Y	1
93		961006-2	RETAINING RING S-10	1
94		210005-4	BALL BEARING 608DDW	1
95		459181-1	SEAL RING A	1
96		136304-5	GEAR HOUSING ASS'Y	1
96	D10		INC. 88,97	
97		213445-5	O-RING 26	1
100		515528-0	ARMATURE ASS'Y 220-240V	1
100	D10		INC. 101-105	
101		331775-3	SLEEVE 10	1
102		211097-6	BALL BEARING 6000LLB	1
103		253171-4	FLAT WASHER 10	1
104		681644-1	INSULATION WASHER	1
105		210005-4	BALL BEARING 608DDW	1
106		267804-5	WAVE WASHER 15	1
107		266329-6	TAPPING SCREW 5X60	2
108		459172-2	BAFFLE PLATE	1
109		621899-6	FIELD	1
110		459160-9	MOTOR HOUSING	1
112		632N59-9	BRUSH HOLDER UNIT	1
113		197245-0	CARBON BRUSH CB-351	1
114		652044-2	+BIND SCREW M3.5X5.0	2
115		266404-8	TAPPING SCREW BIND 3X14	3
116		459168-3	REAR COVER	1
117		266326-2	TAPPING SCREW 4X18	4
118		632P88-4	LEAD UNIT	1
119		632P89-2	LEAD UNIT	1
120		620C42-2	CONTROLLER	1
121		266404-8	TAPPING SCREW BIND 3X14	2
122		266326-2	TAPPING SCREW 4X18	2
123		140M21-9	HANDLE STOPPER COMPLETE	1
123	C10	263005-3	RUBBER PIN 6	2
124		459163-3	HANDLE BASE	1
125		232500-4	COMPRESSION SPRING 10	1
126		459174-8	CHANGE LEVER	1
127		266326-2	TAPPING SCREW 4X18	1
128		459184-5	CUSHION RING 12	2
129		459176-4	SHOULDER SLEEVE 5	2
130		266459-3	TAPPING SCREW 5X25	2
130-1		266041-8	TAPPING SCREW 5X25	2
131		266326-2	TAPPING SCREW 4X18	4
132		856W05-4	HR3001C NAME PLATE	1

Item	Sub	Parts No.	Parts Description	Qty
133		818U61-0	CLEAR LABEL	1
134		266326-2	TAPPING SCREW 4X18	1
135		347502-8	LOCK PLATE	1
136		459164-1	HANDLE	1
137		459177-2	SWITCH LEVER	1
138		459178-0	SWITCH HOLDER	1
141		654531-7	TERMINAL BLOCK 2P	1
142		424031-9	SPONGE SHEET	1
143		651385-3	SWITCH C3JW-A1B-PA7	1
144		459166-7	HANDLE COVER	1
145		266326-2	TAPPING SCREW 4X18	1
146		687169-3	STRAIN RELIEF	1
147		266326-2	TAPPING SCREW 4X18	1
148		682573-1	CORD GUARD 10	1
149		692502-6	POWER SUPPLY CORD 1.0-2-4.0	1
150		127220-2	GRIP ASSEMBLY	1
150	D10		INC. 151-154	
151		144959-2	LOCK BUTTON COMPLETE	1
152		233360-7	COMPRESSION SPRING 4	1
153		265625-9	THUMB SCREW M6X50	1
154		459170-6	GRIP 36	1
160		136312-6	TOOL HOLDER ASSY	1
160	D10		INC. 30-32,39-44	
160-1		136312-6	TOOL HOLDER ASSY	1
160-1	D10		INC. 30-32,37-44	
A02		331886-4	DEPTH GAUGE	1
A03		8012F6-3	HR3001CJ INDICATION LABEL	1
A04		8012F7-1	HR3001CJ PLASTIC CASE LABEL	2
A05		821550-0	CONNECTOR PLASTIC CASE (TYPE2)	1
A05	C10	453974-8	LATCH	4
A06		835B26-3	INNER TRAY	1

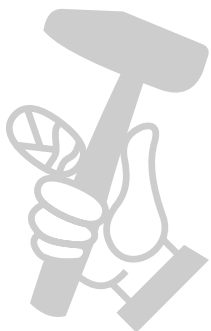

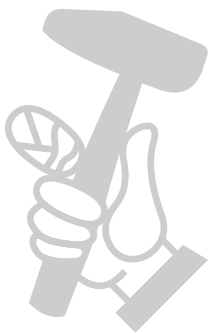

МАГАЗИН  
**БАШ МАЙСТОРА**<sup>®</sup>  
ПРОФЕСИОНАЛНИ РЕШЕНИЯ