

DWE7492 TABLE SAW 2

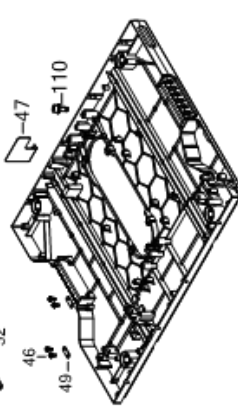

МАЙСТОРА®
ПРОФЕСІОНАЛНИ РЕШЕНИЯ

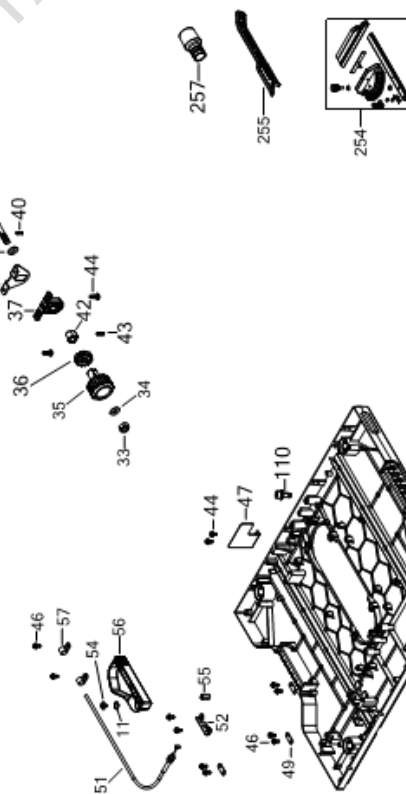
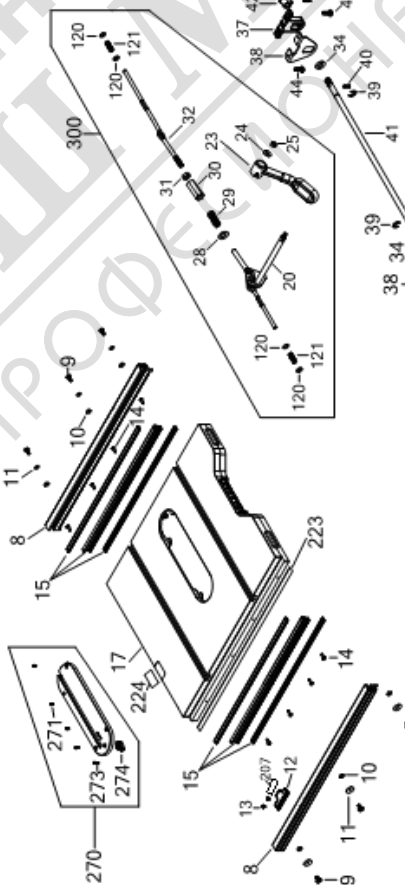
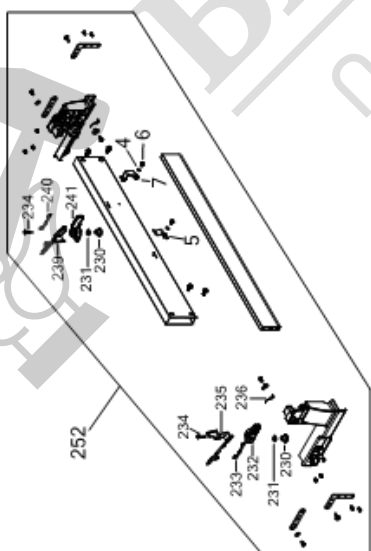
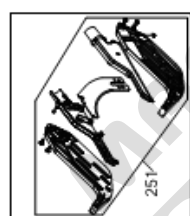
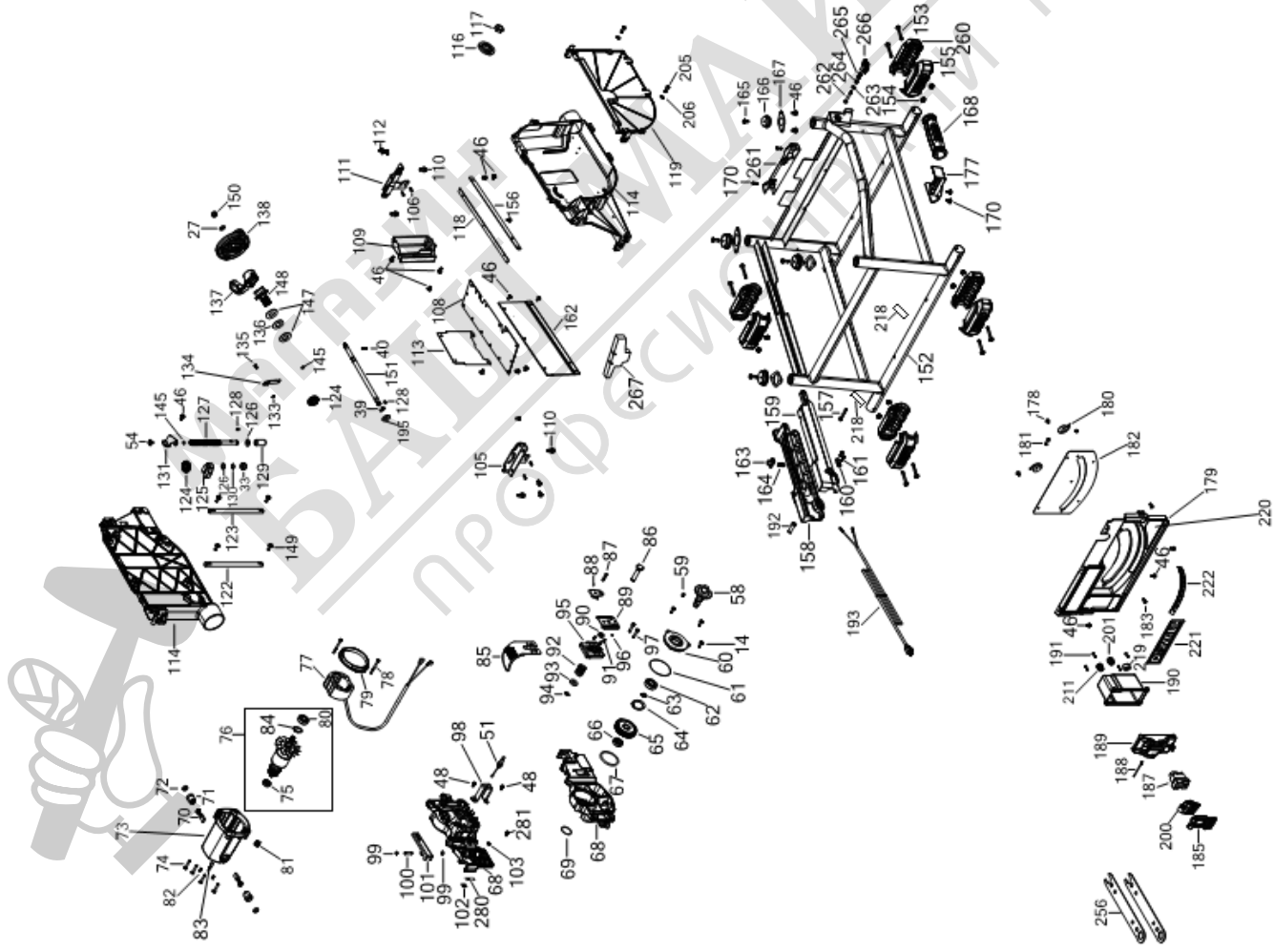

Parts List DWE7492 TABLE SAW 2

Item	Part Number	Qty	Part Description	General Description	Other Info	Repair Inst	Markets
4	N448947	2	WASHER			No	QS
5	N504104	1	HOLDER			No	QS
6	N615124	2	SCREW			No	QS
7	N506020	1	HOLDER			No	QS
8	N528992	2	RAIL			No	QS
9	N507933	6	SCREW			No	QS
10	N467547	6	NUT			No	QS
11	N507934	6	WASHER			No	QS
12	N506804	1	POINTER			No	QS
13	N530541	2	SCREW			No	QS
14	330045-14	3	SCREW			No	QS
14	N446317	11	SCREW.SPECIAL			No	QS
15	N530544	2	RAIL			No	QS
17	N517904	1	TABLE			No	QS
20	N544188	1	SHAFT SA			No	QS
23	N507950	1	LEVER			No	QS
24	N526192	1	WASHER			No	QS
25	330021-07	1	NUT			No	QS
27	N467556	1	WASHER			No	QS
28	N561042	1	WASHER			No	QS
29	N511376	1	SPRING			No	QS
30	N504755	1	ADJUSTER BLOCK			No	QS
31	N467555	1	NUT			No	QS
32	N544187	1	SHAFT SA			No	QS
33	N455283	3	NUT M10			No	QS
34	N455280	2	WASHER			No	QS
35	N506822	1	KNOB			No	QS
36	N504754	2	PINION			No	QS
37	N505867	2	BLOCK			No	QS
38	N503996	2	BRACKET			No	QS
39	N455281	3	RETAINER			No	QS
40	N455278	2	SPIROL PIN			No	QS

Parts List DWE7492 TABLE SAW 2

Item	Part Number	Qty	Part Description	General Description	Other Info	Repair Inst	Markets
41	N528996	1	ROD			No	QS
42	N505964	2	BLOCK			No	QS
43	N511377	2	SPRING			No	QS
44	330045-14	4	SCREW			No	QS
46	N526936	38	SCREW			No	QS
47	N524352	1	GUARD			No	QS
48	N506853	2	SCREW			No	QS
49	N503338	5	PLATE			No	QS
51	N506841	1	CABLE			No	QS
52	N506842	1	BRACKET			No	QS
54	N445370	3	SCREW.SPECIAL			No	QS
55	N506845	1	BUSHING			No	QS
56	N506849	1	HANDLE			No	QS
57	N506850	2	CORD CLAMP			No	QS
58	N506863	1	SPINDLE			No	QS
59	N506864	1	WOODRUFF KEY			No	QS
60	N506867	1	GEARCASE COVER			No	QS
61	N506868	1	O RING			No	QS
62	605040-41	1	BEARING			No	QS
63	N506869	1	LOCKING RING			No	QS
64	N506870	1	CIRCLIP			No	QS
65	N898894	1	GEAR			No	QS
66	605040-59	1	BEARING			No	QS
67	N506873	1	O RING			No	QS
68	N506202	1	GEARCASE			No	QS
69	N524651	1	O RING			No	QS
70	N563465	2	BRUSH 230V			No	QS
70	N638738	1	BRUSH PAIR 230V			No	QS
71	N615774	2	BRUSH HOLDER SA			No	QS
72	N539048	2	BRUSH CAP			No	QS
73	N498814	1	FIELD CASE			No	QS
74	N530916	4	SCREW.SPECIAL			No	QS

Parts List DWE7492 TABLE SAW 2

Item	Part Number	Qty	Part Description	General Description	Other Info	Repair Inst	Markets
75	N110359	1	BEARING			No	QS
76	NA145872	1	ARMATURE			No	QS
77	NA133866	1	FIELD			No	QS
78	330019-30	2	SCREW			No	QS
79	N528091	1	BAFFLE FAN			No	QS
80	605040-27	1	BEARING			No	QS
81	N600154	1	CORD PROTECTOR			No	QS
82	330022-18	2	SCREW			No	QS
83	631115-00	1	RUBBER			No	QS
84	398605-00	1	RETAINER			No	QS
85	N507601	1	RIVING KNIFE			No	QS
86	N506883	1	SHAFT			No	QS
87	N516284	1	SPIROL PIN			No	QS
88	N506885	1	SPRING			No	QS
89	N520202	1	HOLDER			No	QS
90	N516281	1	BUSHING			No	QS
91	N448944	3	SCREW			No	QS
92	N516282	1	SPRING			No	QS
93	N516283	1	WASHER			No	QS
94	N516286	1	RETAINER			No	QS
95	N521163	1	MOUNT			No	QS
96	N516285	1	SCREW			No	QS
97	N447220	2	SCREW			No	QS
98	N506895	1	BRACKET			No	QS
99	N455214	1	RETAINER			No	QS
100	N506898	1	PIN			No	QS
101	N506899	1	BRACKET			No	QS
102	N506900	1	BLOCK			No	QS
103	N506901	1	NUT			No	QS
105	N505336	1	BRACKET SA			No	QS
106	N446419	4	SPIROL PIN			No	QS
108	N520495	1	GUARD			No	QS

Parts List DWE7492 TABLE SAW 2

Item	Part Number	Qty	Part Description	General Description	Other Info	Repair Inst	Markets
109	N506909	1	GUARD REAR			No	QS
110	N461121	4	SCREW			No	QS
111	N505220	1	BRACKET SA			No	QS
112	N446418	4	SCREW			No	QS
113	N506912	1	GUARD			No	QS
114	N536538	1	CASTING			No	QS
116	N509218	1	WASHER CLAMP			No	QS
117	N506916	1	CLAMP NUT			No	QS
118	N506921	1	BAR			No	QS
119	N506922	1	COVER			No	QS
120	N435913	4	WASHER			No	QS
121	N511375	2	SPRING			No	QS
122	N506924	1	SHAFT			No	QS
123	N506925	1	SHAFT			No	QS
124	N504745	2	BEVEL GEAR			No	QS
125	N506929	1	BRACKET			No	QS
126	N506935	2	WASHER BOW			No	QS
127	N506932	1	CONTROL SCREW			No	QS
128	N471715	1	WOODRUFF KEY			No	QS
129	N506934	1	BUSHING			No	QS
130	N506930	1	WASHER			No	QS
131	N506936	1	BRACKET			No	QS
133	N454261	1	WASHER LOCK			No	QS
134	N506939	1	POINTER			No	QS
135	N454259	1	SCREW			No	QS
136	N506941	1	WASHER			No	QS
137	N508188	1	HANDLE SA			No	QS
138	N656850	1	WHEEL SA			No	QS
145	N506952	1	O RING			No	QS
147	N506954	2	WASHER			No	QS
148	N535078	1	LOCKING SCREW			No	QS
149	N455721	4	SCREW.SPECIAL			No	QS

Parts List DWE7492 TABLE SAW 2

Item	Part Number	Qty	Part Description	General Description	Other Info	Repair Inst	Markets
150	330021-02	1	NUT			No	QS
151	N536541	1	SHAFT			No	QS
152	N586455	1	CAGE			No	QS
153	N468863	8	SCREW.SPECIAL			No	QS
154	N468864	8	NUT			No	QS
155	N546986	4	FOOT			No	QS
156	N506918	1	BAR			No	QS
157	N506971	2	SCREW			No	QS
158	N562519	1	CLAMSHELL LH			No	QS
159	N559499	1	CLAMSHELL RH			No	QS
160	N506975	1	CORD CLAMP			No	QS
161	N506976	2	SCREW			No	QS
162	N520496	1	BAR			No	QS
163	N506978	1	BUTTON			No	QS
164	N506979	1	SPRING			No	QS
165	N474759	4	SCREW			No	QS
166	N506981	4	BUMPER			No	QS
167	N506982	4	BRACKET			No	QS
168	N506983	1	HANDLE			No	QS
170	N454227	4	SCREW			No	QS
177	N497063	1	BRACKET			No	QS
178	N442869	2	SCREW			No	QS
179	N507001	1	PANEL FRONT			No	QS
180	N441179	2	CAM			No	QS
181	N507005	3	SCREW			No	QS
182	N507006	1	PLATE			No	QS
183	N526936	2	SCREW			No	QS
185	N508200	1	PADDLE			No	QS
187	N603747	1	SWITCH 240V			No	QS
188	N508203	1	PIN			No	QS
189	N508204	1	SWITCH COVER			No	QS
190	N508209	1	SWITCHBOX			No	QS

Parts List DWE7492 TABLE SAW 2

Item	Part Number	Qty	Part Description	General Description	Other Info	Repair Inst	Markets
191	N508206	4	SCREW			No	QS
192	N507026	1	SLEEVE			No	QS
193	N778841	1	CORDSET (M/PLUG) QS			No	QS
195	N536542	1	WASHER			No	QS
200	N508201	1	INSERT			No	QS
201	N600154	1	CORD PROTECTOR			No	QS
205	N581422	2	SCREW			No	QS
206	750831	2	O RING			No	QS
207	N598018	1	WARNING LABEL			No	QS
211	N554952	1	CORD PROTECTOR			No	QS
218	N561998	2	PAD			No	QS
219	N563569	1	INSULATOR			No	QS
220	NA095012	1	RATING LABEL			No	QS
221	N586800	1	BRAND LABEL			No	QS
222	N196812	1	LABEL			No	QS
223	N196912	1	SCALE			No	QS
224	N196816	1	LABEL			No	QS
230	N507736	2	BUSHING			No	QS
231	N507735	2	WASHER BOW			No	QS
232	N507689	1	PADDLE			No	QS
233	N507733	1	LEVER			No	QS
234	N507731	2	SCREW			No	QS
235	N552157	1	PLATE			No	QS
236	N511951	2	SPRING			No	QS
239	N552906	1	PLATE			No	QS
240	N507741	1	LEVER			No	QS
241	N507992	1	PADDLE			No	QS
251	N629903	1	GUARD SA			No	QS
252	N638742	1	FENCE SA			No	QS
254	N629902	1	MITRE FENCE			No	QS
255	N506021	1	PUSHROD			No	QS
256	N506977	2	WRENCH SPECIAL	22mm		No	QS

Parts List DWE7492 TABLE SAW 2

Item	Part Number	Qty	Part Description	General Description	Other Info	Repair Inst	Markets
257	1004695-90	1	DUST PORT			No	QS
260	N546987	4	FOOT			No	QS
261	N557485	1	BRACKET			No	QS
262	N451161	1	BOLT			No	QS
263	N526185	1	WASHER			No	QS
264	N461154	1	NUT			No	QS
265	N511764	1	SPRING			No	QS
266	N538525	1	KNOB			No	QS
267	N524451	1	FOAM			No	QS
270	N629901	1	TABLE INSERT			No	QS
271	N455083	4	SCREW			No	QS
273	N459208	1	SCREW			No	QS
274	N508873	1	CAM			No	QS
280	N521898	1	PLATE			No	QS
281	N507731	1	SCREW			No	QS
300	N655983	1	LOCKING DEVICE			No	QS

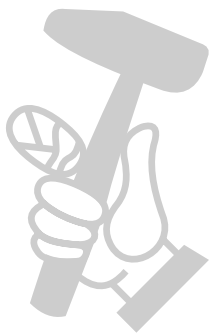

МАГАЗИН МАЙСТОРА
 БАШ МАЙСТОРА
 ПРОФЕСИОНАЛНИ РЕШЕНИЯ