

ELECTRIC TOOL PARTS LIST

CORDLESS CIRCULAR SAW

2017·11·15

Model C 3606DA

(E1)

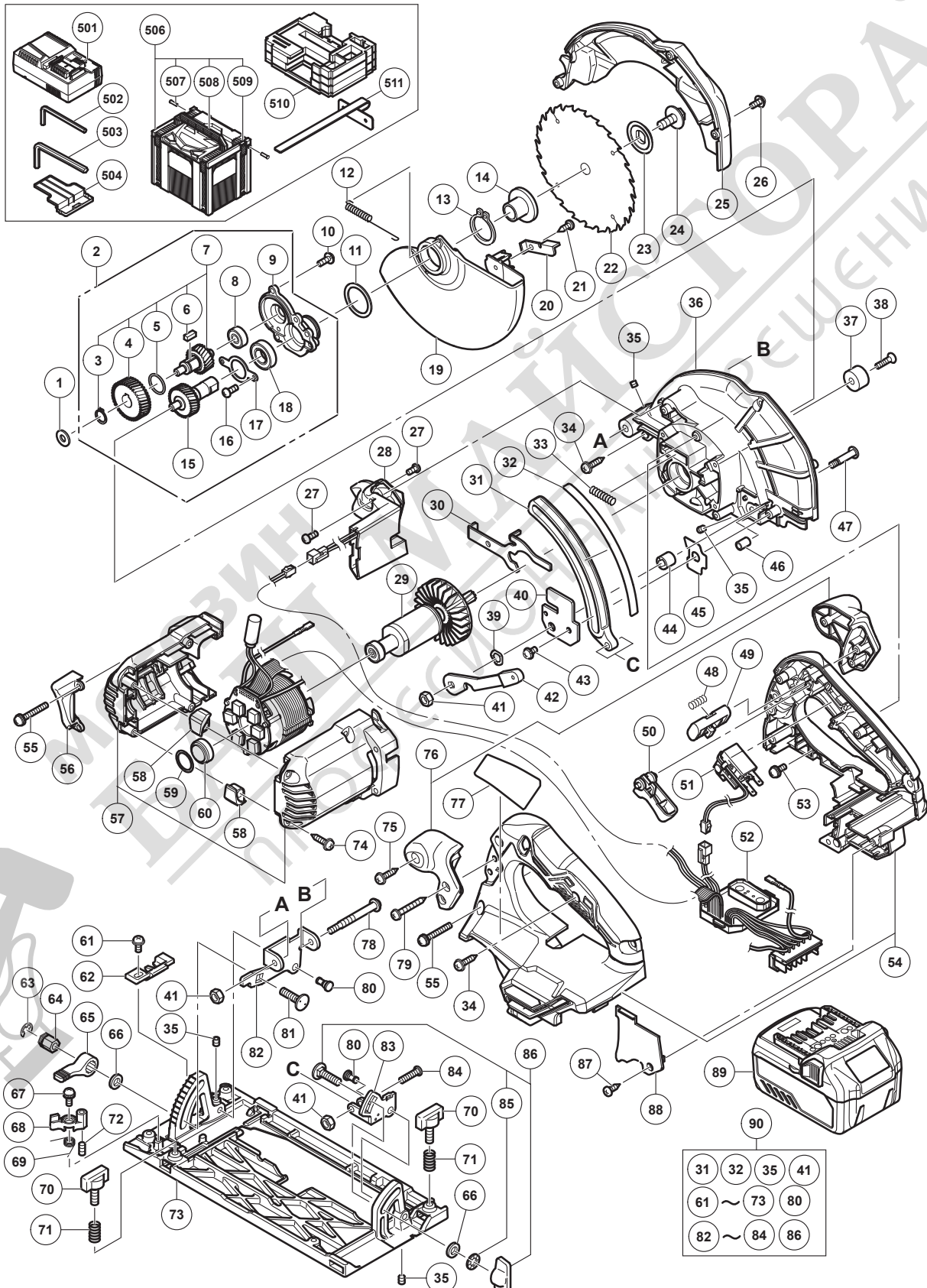

PARTS

C 3606DA

ITEM NO.	CODE NO.	DESCRIPTION	NO. USED	REMARKS
1	329975	WASHER (A)	1	
2	338920	BEARING HOLDER ASS'Y	1	INCLUD.7-9,15-18
3	316487	RETAINING RING FOR D11 SHAFT	1	
4	338925	FIRST GEAR	1	
5	319567	O-RING (S-15)	1	
6	930511	FEATHER KEY 4 X 4 X 10	1	
7	338924	SECOND SHAFT ASS'Y	1	INCLUD.3-6
8	606ZZM	BALL BEARING 606VV	1	
9	338921	BEARING HOLDER	1	
10	951039	MACHINE SCREW (W/SP. WASHER) M4 X 12	3	
11	339257	WASHER	1	
12	373078	RETURN SPRING	1	
13	939548	RETAINING RING FOR D22 SHAFT (10 PCS.)	1	
14	338915	WASHER (A)	1	
15	338923	SPINDLE GEAR SET	1	
16	949203	MACHINE SCREW M3 X 8 (10 PCS.)	2	
17	338922	BEARING COVER	1	
18	6901VV	BALL BEARING 6901VV	1	
19	338905	LOWER GUARD	1	
20	338927	KNOB	1	
21	302090	TAPPING SCREW D4 X 10 (BLACK)	1	
22	338935	TCT SAW BLADE 165MM-D20 HOLE-NT24	1	
23	338916	WASHER (B)	1	
24	338917	HEX FLANGE BOLT	1	
25	372880	SAW COVER (GREEN)	1	
26	333781	MACHINE SCREW (W/WASHER) M4 X 12 (BLACK)	1	
27	323211	MACHINE SCREW M4 X 8 (BLACK)	2	
28	339218	LED	1	
29	361078	ROTOR (C) ASS'Y	1	
30	338918	LOCK LEVER	1	
31	371943	LINK	1	
32	339258	GAUGE PLATE (A)	1	
33	334225	SPRING	1	
34	307811	TAPPING SCREW (W/FLANGE) D4 X 16 (BLACK)	5	
35	319541	SEAL LOCK HEX. SOCKET SET SCREW M5 X 6	4	
36	338907	GEAR COVER	1	
37	310842	CUSHION	1	
38	949793	FLAT HD. SCREW M5 X 20 (10 PCS.)	1	
39	334242	WAVE WASHER 8	1	
40	371946	COVER PLATE	1	
41	308387	U-NUT M5	3	
42	338930	LEVER (A)	1	
43	372219	SEAL LOCK SCREW (W/SP. WASHER) M4	1	
44	333681	CAM	1	
45	371947	PLATE	1	
46	338932	LOCK SLEEVE	1	
47	333680	CAM SHAFT	1	
48	336650	SPRING	1	
49	338901	KNOB	1	
50	338899	TRIGGER	1	

