

Makita

18V Brushless Band Saw

Makita



МАГАЗИН
БАШ МАЙСТОРА
ПРОФЕСИОНАЛНИ РЕШЕНИЯ

DPB183



Product Objectives

- To provide users with a band saw powered by a power Brushless Motor, designed to suit the needs of a range of metal-cutting tasks, ideal for any electrical, HVAC, installation, metal fabrication, plumbing or any professional tradesmen
- The aluminium blade case is both highly durable and lightweight making it comfortable in operation but also able to handle tough jobsite conditions



Product Overview



Product Specification Sheet



Cutting capacities	66mm x 66mm
Blade speed	0-192m/min
Blade size (LxWxH)	835 x 13 x 0.5mm
Overall length	392mm
Skin weight	3.3kg
Weight (with battery)	3.9kg
Voltage	18V

- **Aluminium housing** – durable but also lightweight aluminum housing ensures the bandsaw is able to withstand jobsite conditions, providing stable and secure cutting for the user
- **Tool-less blade change** – for quick and easy blade replacement there is a large tool-less tension lever
- **Blade tracking adjustment** – blade tracking can be adjusted by turning the screw located on the housing with the hex wrench provided
- **Optional grip** – users have the option of attaching a grip handle to the aluminium housing for greater control in varying applications
- **Twin LED Job light** – Twin LED job light with pre-glow function so the user can accurately position the blade on the cutting line
- **Ergonomic handle design** – angled specifically for comfortable use the handle design has been engineered to be comfortable in both conventional and overhead operation
- **Variable speed control by dial & trigger** – users can use the dial or trigger for variable speed control, allowing them to select the ideal cutting speed to suit the application
- **Constant speed control** – minimizes the reduction in blade speed under heavy load to provide stable and secure cutting
- **Catch Bracket** – prevents damage to the tool body from hitting against workpiece
- **Adjustable stopper plate** – can be adjusted for safe cutting of various sized material and can also be adjusted making it convenient for cutting close to walls and ceilings

Advantages

Durability



Aluminium housing for increased durability

Power



Brushless Motor providing up to 192m/min blade speed for fast and efficient cutting

Compact



Compact and lightweight, the band saw is only 392mm in length and 3.3kg in weight

Convenience

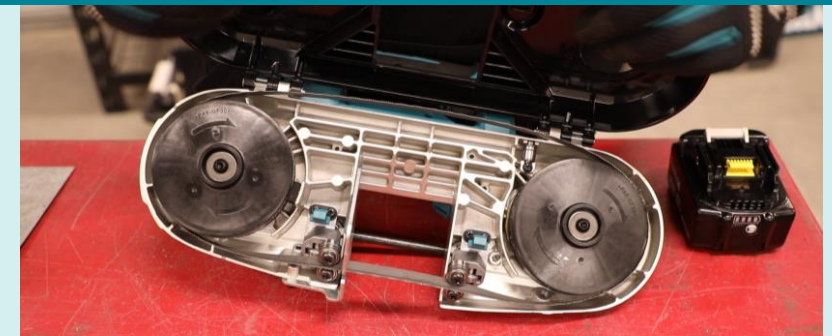

Tool-less blade change for easy removal and installation of blades

Our Range

	DPB180	DPB183	DPB182	DPB184
		 BRUSHLESS		 BRUSHLESS
Cutting capacities	120mm x 120mm	66mm x 66mm	64mm x 64mm	51mm x 51mm
Blade speed	84-162m/min	0-192m/min	192m/min	0-192m/min
Blade size (LxWxH)	1,140 x 13 x 0.5mm	835 x 13 x 0.5mm	835 x 13 x 0.5mm	730 x 13 x 0.5mm
Overall length	523mm	392mm	477mm	373mm
Skin weight	5.8kg	3.3kg	3.5kg	3.0kg
Weight (with battery)	6.4kg	3.9kg	4.1kg	3.6kg
Voltage	18V	18V	18V	18V
Housing material	Aluminium	Aluminium	Aluminium	Aluminum
Blade tracking adjustment	No	Yes	Yes	Yes
Variable speed	Yes -Dial	Yes- Trigger & Dial	No	Yes - Trigger
Constant speed control	No	Yes	No	Yes

FAQ – Adjusting Blade Track

To adjust, insert the hex wrench into the adjustment hole and make a quarter turn clockwise.

Check to see if the band saw blade slips out or not.

If it still slips out, make another quarter turn and keep checking until the band saw blade does not slip out.

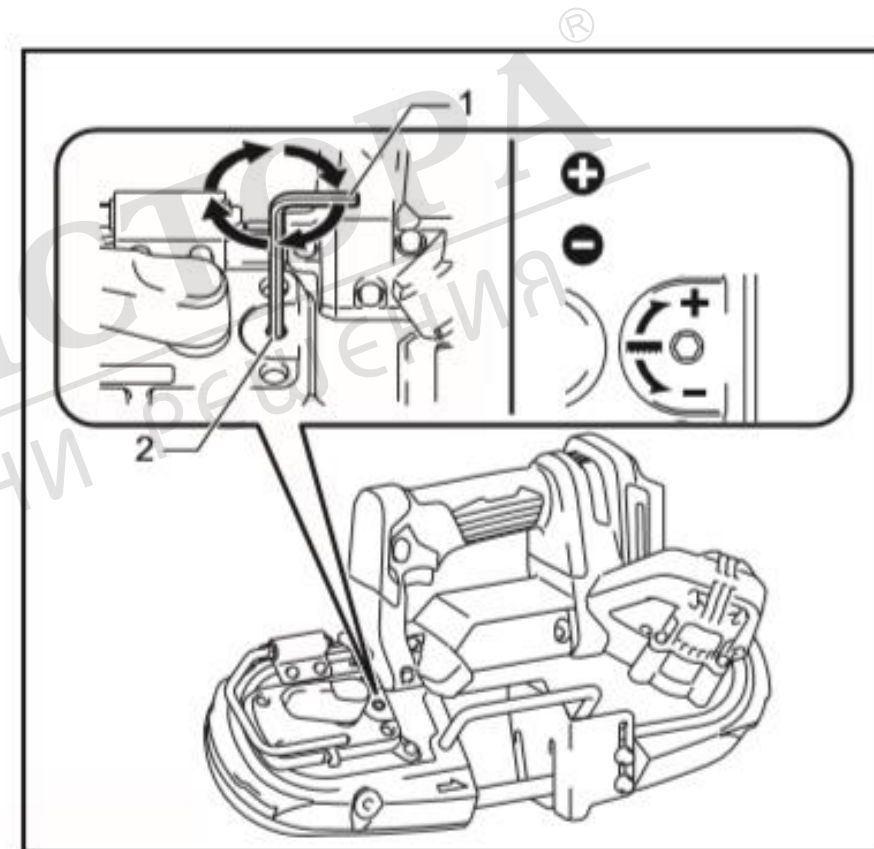

► 1. Hex wrench 2. Adjustment hole

FAQ – Installing Blades

1. Turn the blade tightening lever clockwise until it stops to loosen the wheel.

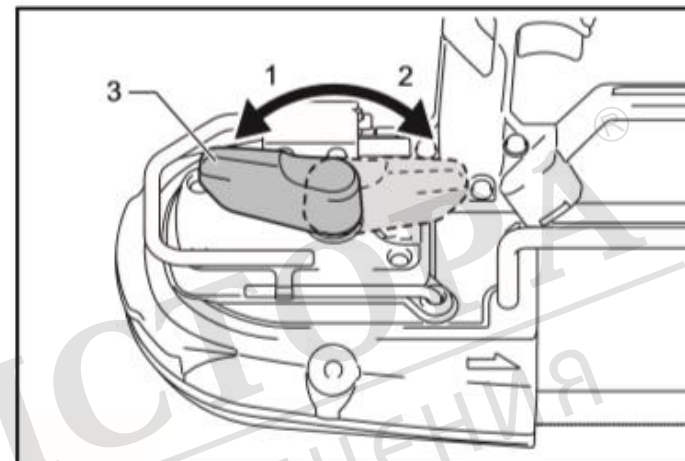

► 1. Tighten 2. Loosen 3. Blade tightening lever

2. Open the wheel cover.

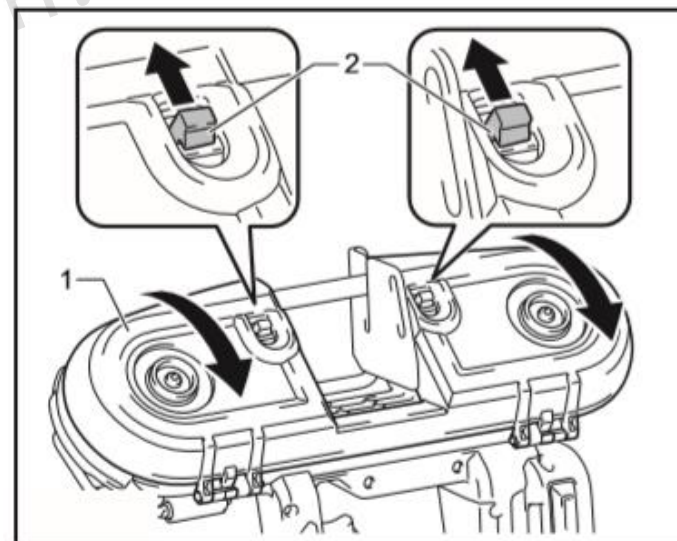

► 1. Wheel cover 2. Hook

FAQ – Installing Blades continued

3. Match the direction of the arrows on the band saw blade and on the wheels.
4. Insert the non-serrated side of the band saw blade into the upper holder and lower holder. Make sure the band saw blade in both upper and lower holder touches to the bottom bearings.

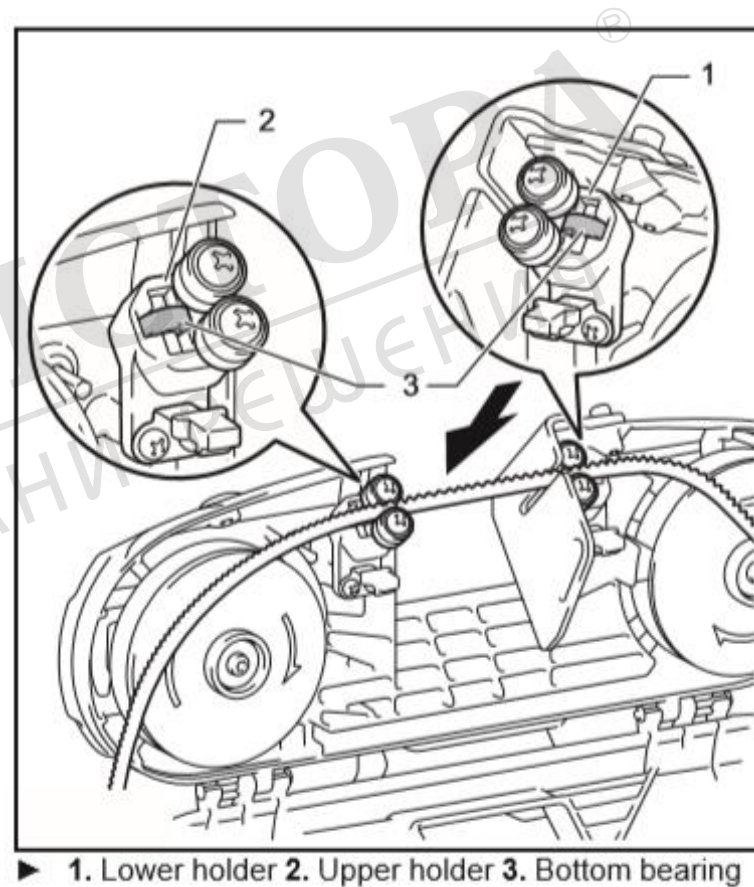

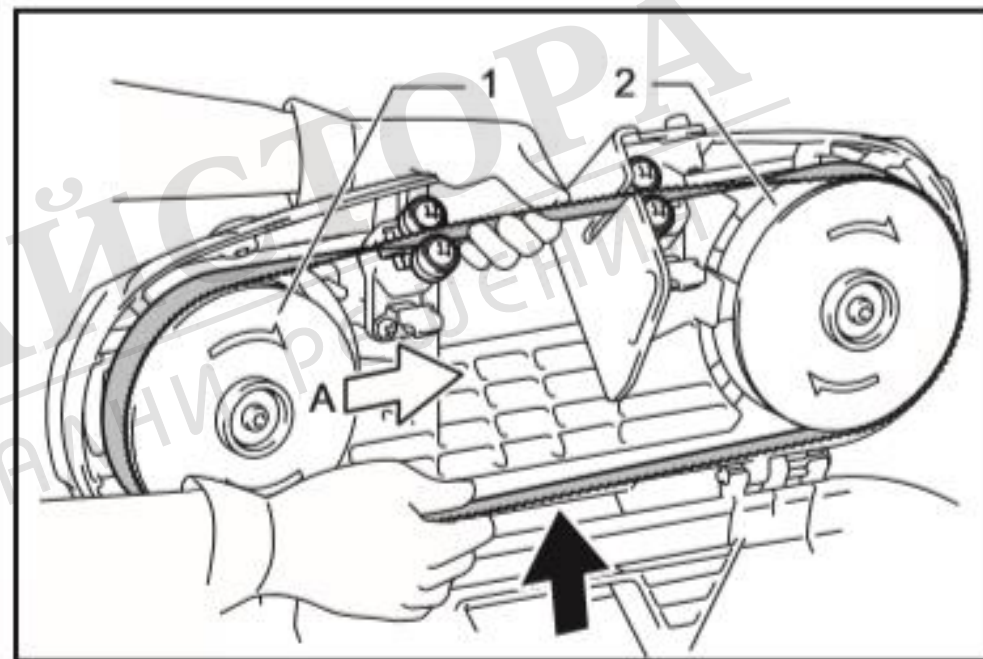

FAQ – Installing Blades continued

5. While pressing the middle part of the band saw blade, position the blade around one wheel.
6. Place the other side of the band saw blade on the other wheel.
7. Position the edge of the band saw blade on rubber tire.
8. Hold the band saw blade in place and turn the blade tightening lever counterclockwise until it stops.
9. Close the wheel cover.



► 1. Wheel 2. Rubber tire

Accessories

Standard Accessories		
	B-40559	Band Saw Blade (1 Piece)
	783202-0	Hex wrench

Optional Accessories		
	B-40543 B-40559 B-40565	<u>Band Saw Blades</u> 3-6mm thickness of work piece 2-3mm thickness of work piece Less then 2mm thickness of work piece
	191897-7	<u>Paraffin Cutting Wax</u>
	158237-4	<u>Side Handle</u> 