

CS1250L CIRCULAR SAW 1

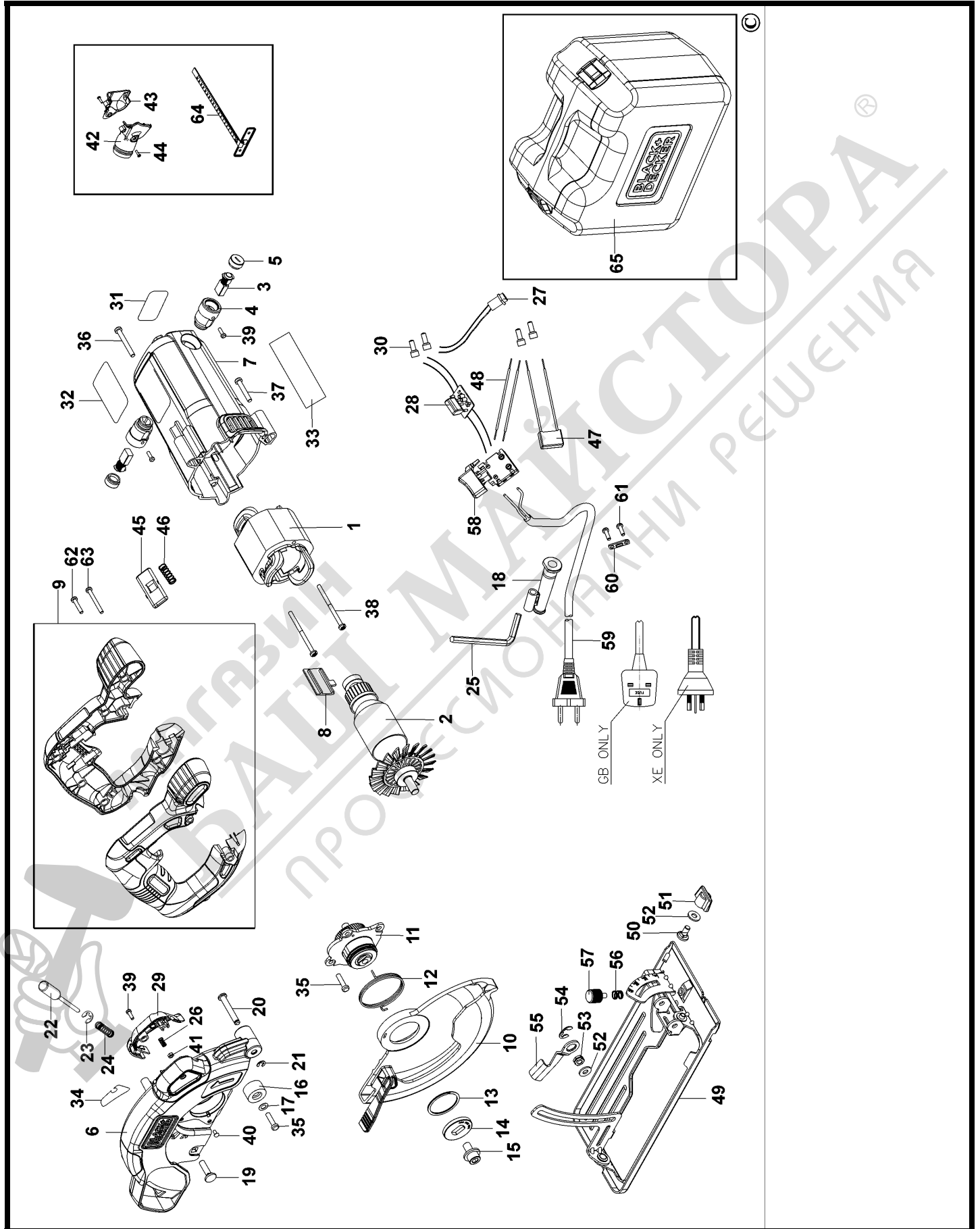

Parts List CS1250L CIRCULAR SAW 1

Item	Part Number	Qty	Part Description	General Description	Other Info	Repair Inst	Markets
1	90638912	1	FIELD SA			No	
2	90638913	1	ARMATURE 230V			No	
3	90640566	2	BRUSH 230V			No	
4	90641247	2	BRUSH HOLDER			No	
5	90641337	2	BRUSH CAP			No [Ⓜ]	
6	90636177	1	GUARD	W/ LASER		No	
7	90632258	1	HOUSING MOTOR			No	
8	90632311	1	RETAINER			No	
9	90632259	1	HANDLE SA	W/ LOCK		No	
10	90632263	1	GUARD			No	
11	90632264	1	SPINDLE SA			No	
12	90568897	1	SPRING			No	
13	90633041	1	SPRING CLIP			No	
14	90632707	1	OUTER FLANGE			No	
15	90578338	1	SCREW			No	
16	90642485	1	STOP			No	
17	330016-07	1	WASHER			No	
18	90568797	1	CORD PROTECTOR			No	
19	90632286	1	BOLT			No	
20	90635132	1	PIN			No	
21	90578384	1	RETAINER			No	
22	90632290	1	SHAFT			No	
23	90632292	1	CLIP			No	
24	90632291	1	SPRING			No	
25	90579371	1	HEX KEY			No	
26	90632277	1	SPRING			No	
27	90632252	1	LASER			No	
28	90632254	1	PCB			No	
29	90632276	1	COVER			No	
30	90640445	1	TERMINAL			No	
31	90632305	1	LABEL			No	
32	90640087	1	RATING LABEL			No	QS
33	90640088	1	WARNING LABEL			No	

Parts List CS1250L CIRCULAR SAW 1

Item	Part Number	Qty	Part Description	General Description	Other Info	Repair Inst	Markets
34	90640089	1	WARNING LABEL			No	
35	330019-13	5	SCREW	M4 x 19 - T20		No	
36	330019-16	2	SCREW.TEMP			No	
37	330019-45	1	SCREW	M4.55 x 29mm T20		No	
38	330019-82	2	SCREW			No [Ⓜ]	
39	330019-41	5	SCREW			No	
40	90640443	1	SCREW	M3x6		No	
41	330015-00	1	NUT			No	
42	90632294	1	DUST PORT	FRONT		No	
43	90632295	1	DUST PORT	BACK		No	
44	370748	2	SCREW	No 6 x 12.7mm		No	
45	90632250	1	ACTUATOR			No	
46	90632250	1	ACTUATOR			No	
47	90641951	1	CAPACITOR			No	
48	90641952	1	LEADWIRE			No	
49	90640442	1	SHOE SA			No	
50	90632296	1	BOLT			No	
51	90568910	1	WING NUT			No	
52	90580384	2	WASHER	6 X 14 X 1.5		No	
53	90569115	1	LOCK NUT			No	
54	90641175	1	CLIP			No	
55	90636210	1	LEVER SA			No	
56	90568918	1	SPRING			No	
57	90568917	1	SCREW			No	
58	90634449	1	SWITCH			No	
59	90578995-11	1	CORDSET (EURO)			No	QS
60	329301-00	2	CORD CLAMP			No	
61	370748	5	SCREW	No 6 x 12.7mm		No	
62	90611830	1	SCREW			No	
63	330019-06	1	SCREW			No	
64	90568785	1	FENCE			No	