

DWE4257

SMALL ANGLE GRINDER 1

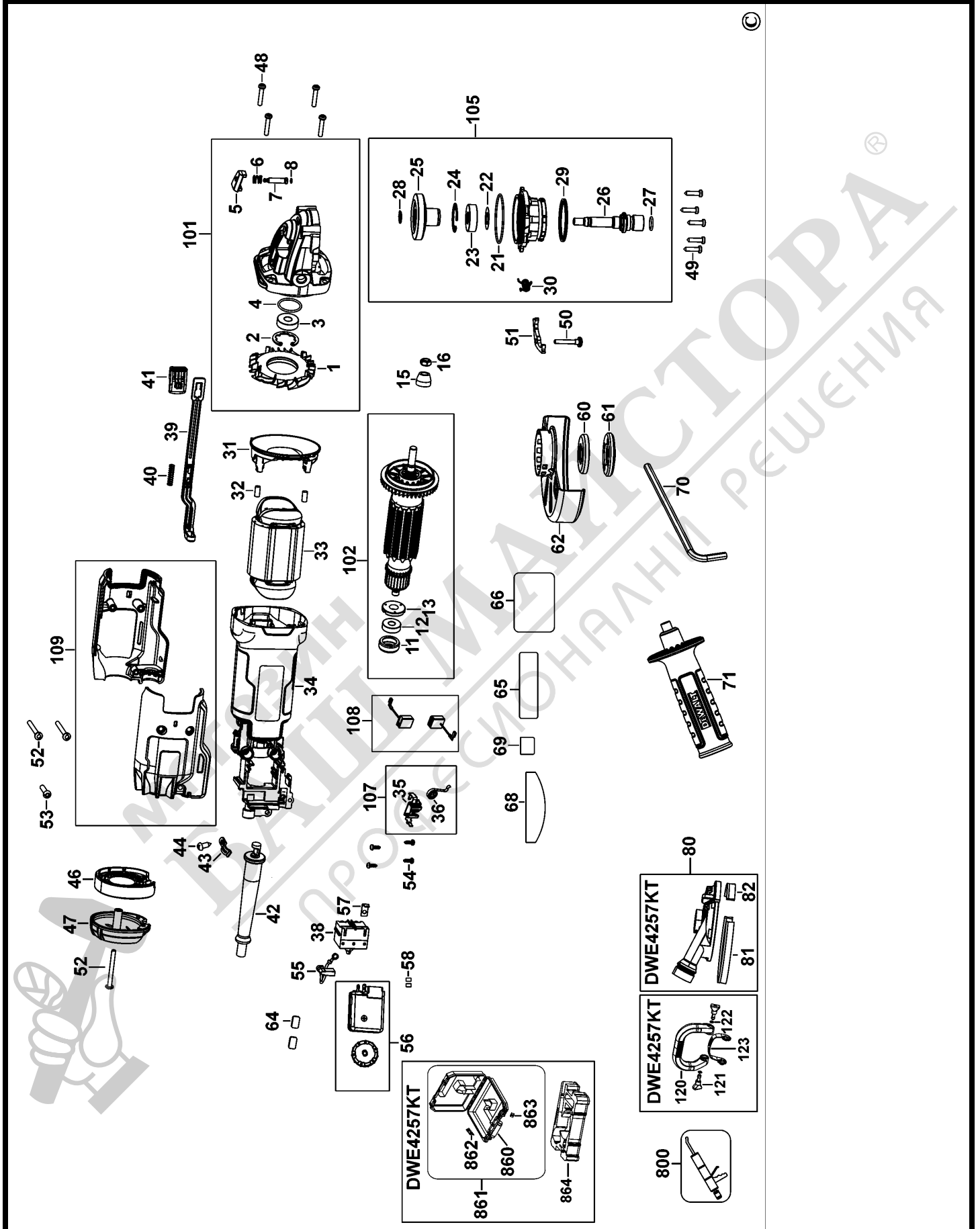

## Parts List DWE4257 SMALL ANGLE GRINDER 1

Item	Part Number	Qty	Part Description	General Description	Other Info	Repair Inst	Markets
1	N401958	1	DEFLECTOR			No	
2	N453031	1	RETAINER	25MM INT		No	
3	N175104	1	BEARING			No	
4	N119639	1	O RING			No	
5	N278899	1	BUTTON			No <sup>®</sup>	
6	N263579	1	SPRING			No	
7	N481683	1	LOCK PIN			No	
8	N263699	1	O RING	5MM OD		No	
11	641823-00	1	SLEEVE			No	
12	N130916	1	BEARING			No	
13	N449233	1	MAGNET			No	
15	N423537	1	PINION	38T-10T LONG		No	
16	N372039	1	NUT	M7		No	
21	N307625	1	O RING	1.5 X 40		No	
22	N400478	1	WASHER			No	
23	605040-24	1	BEARING	6001		No	
24	N481950	1	RETAINER	28 INTERNAL		No	
25	N409481	1	GEAR	38T/10T		No	
26	N461453	1	SPINDLE	M14		No	QS
27	N420261	1	O RING			No	
28	444793-00	1	CIRCLIP			No	
29	N135116	1	WASHER SPRING			No	
30	N465886	1	SPRING			No	
31	N399419	1	BAFFLE FAN			No	
32	949638-02	2	DAMPER			No	
33	N474974	1	FIELD 230V			No	QS
34	N444134	1	FIELD CASE			No	
35	N335560	2	BRUSH BOX			No	
36	N273780	2	SPRING			No	
38	N484918	1	SWITCH			No	
39	N447003	1	LINK			No	
40	N093410	1	SPRING			No	
41	N097844	1	BUTTON			No	

## Parts List DWE4257 SMALL ANGLE GRINDER 1

Item	Part Number	Qty	Part Description	General Description	Other Info	Repair Inst	Markets
42	N448814	1	CORDSET (EURO)	EMI		No	QS
43	619328-00	1	CORD CLAMP			No	
44	330065-06	1	SCREW	M4 X 12 T20		No	
46	N401579	1	DUST PORT			No	
47	N402946	1	END CAP			No <sup>®</sup>	
48	N371839	4	SCREW	M4 X 22 T20		No	
49	330045-06	5	SCREW	M4 X 0.7 THD FORM		No	
50	N297219	1	SCREW	M4		No	
51	N637725	1	LEVER			No	
52	N389438	3	SCREW	M4 X 40 X T20		No	
53	330065-09	1	SCREW	M4 x 25		No	
54	593478-00	4	SCREW	M3 X 8		No	
55	N474450	1	LEAD SA			No	QS
56	N488899	1	CONTROL MODULE SA	230V		No	QS
57	634599-00	1	TERMINAL			No	
58	633391-00	2	SEAL	TERMINAL		No	
60	391969-00	1	INNER FLANGE			No	
61	N457001	1	OUTER FLANGE	M14		No	
62	N487790	1	GUARD			No	QS
64	N482414	2	FOAM			No	
65	N403730	1	BRAND LABEL			No	
66	N451955	1	RATING PLATE	QS		No	QS
68	N196273	1	LABEL			No	
69	N465404	1	LABEL	V SPEED		No	
70	N107295	1	HEX KEY 6 MM			No	
71	N382311	1	SIDE HANDLE			No	
80	N504609	1	SHROUD SA		DWE4257K	No	
81	N178983	1	BUFFING BRUSH		T DWE4257K	No	
82	N559267	1	BUFFING BRUSH		T DWE4257K	No	
101	N483617	1	GEARCASE SA		T	No	
102	N474961	1	ARMATURE 230V			No	QS
105	N475908	1	GEARCASE COVER SA			No	QS
107	N413349	2	BRUSHBOX SA			No	

## Parts List DWE4257 SMALL ANGLE GRINDER 1

Item	Part Number	Qty	Part Description	General Description	Other Info	Repair Inst	Markets
108	N489059	1	BRUSH PAIR 230V			No	QS
109	N446402	1	CLAMSHELL SET			No	
120	N388962	1	LOOP HANDLE			No	
121	N409562	2	THUMBSCREW			No	
122	050056-00	2	O RING			No <sup>Ⓜ</sup>	
123	N393418	1	INSERT			No	
800	583534-00	1	GREASE 50 GMS	Rheolube 380G1		No	
860	H1400196008	1	HANDLE			No	
861	N279261	1	KITBOX	DWST1-17807 T-STAK11		No	
862	H1500082520	2	LATCH			No	
863	P910190	2	LATCH			No	
864	N422197	1	INSERT	KITBOX		No	

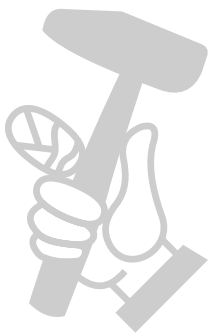

МАГАЗИН МАЙСТОРА  
 БАШ МАЙСТОРА  
 ПРОФЕСИОНАЛНИ РЕШЕНИЯ