

de	Originalbetriebsanleitung - Akku-Bohrschrauber	7
en	Original instructions - Cordless drill	12
fr	Notice d'utilisation d'origine - Perceuses-visseuses sans fil	17
es	Manual de instrucciones original - Taladro atornillador de baterías	22
it	Istruzioni per l'uso originali - Trapano avvitatore a batteria	27
nl	Originele gebruiksaanwijzing - Accuschroefboormachine	32
sv	Originalbruksanvisning - Batteri-borr/skruvdragare	37
fi	Alkuperäiset käyttöohjeet - Akkukäyttöinen porakone/ruuvinväänin	42
da	Original brugsanvisning - Akku bore-skruemaskine	47
nb	Originalbruksanvisning - Batteridrevet bor-/skrumaskin	52
pt	Manual de instruções original - Aparafusadora de acumulador	57
ru	Оригинальное руководство по эксплуатации - Аккумуляторная дрель-шуруповёрт	62
cs	Originální návod k použití - Vrtací akušroubovák	68
pl	Oryginalna instrukcja eksploatacji - Akumulatorowa wiertarko-wkrętarka	73

C 18 Li



Festool GmbH
Wertstraße 20
D-73240 Wendlingen
+49 (0)7024/804-0
www.festool.com



720790_A / 2019-06-26

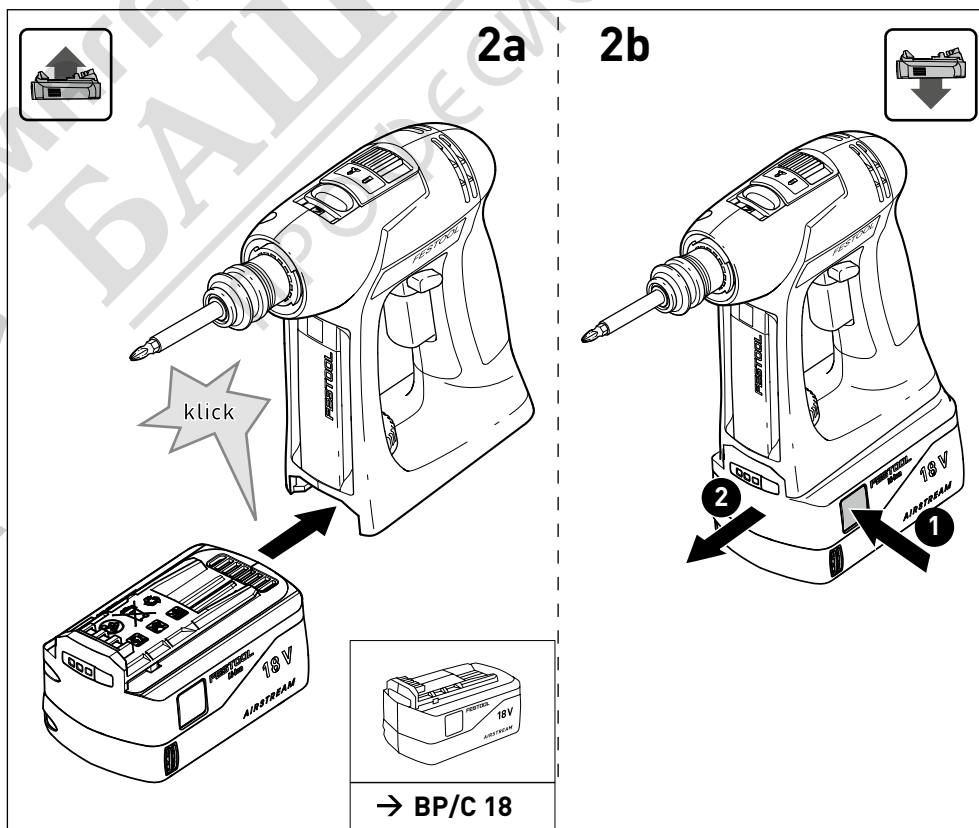
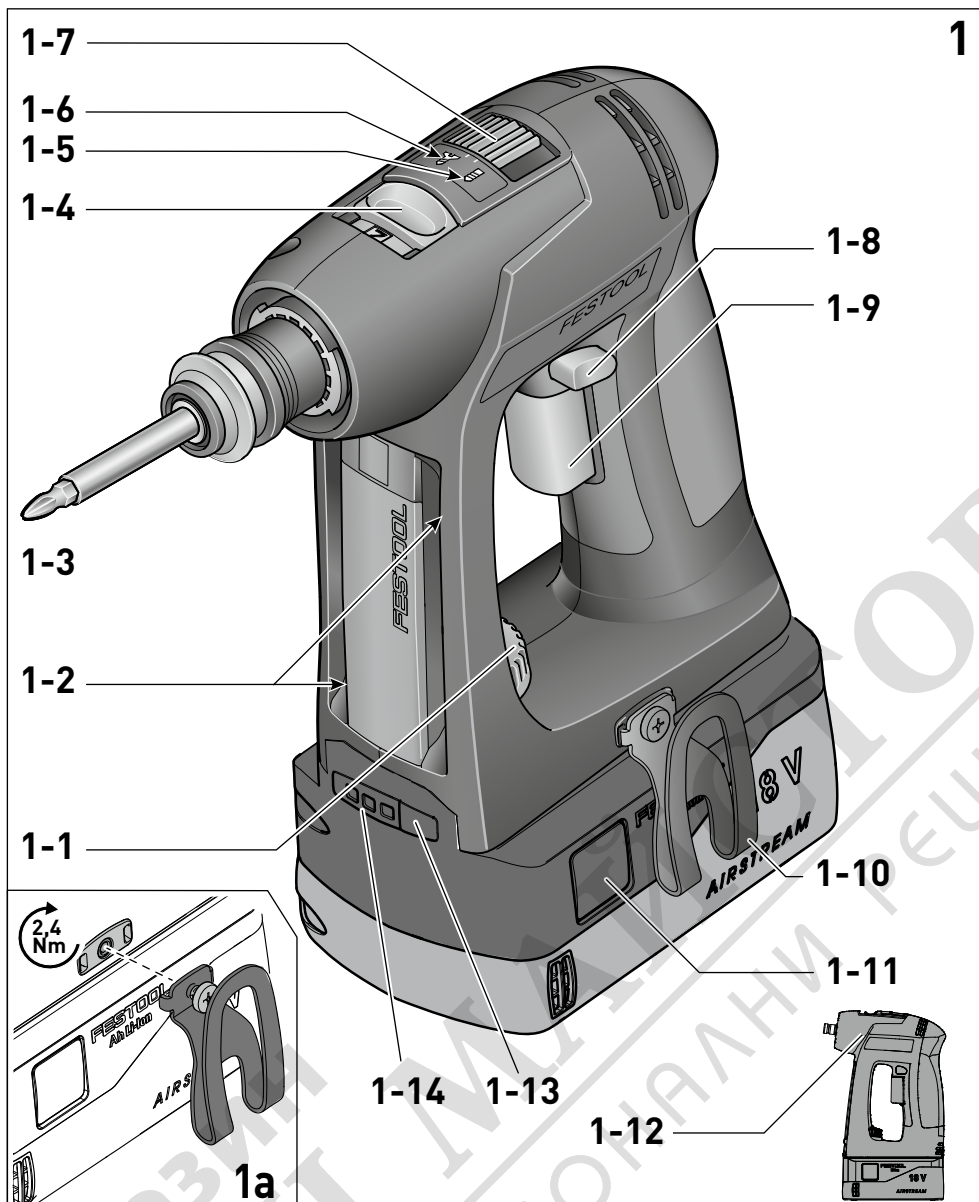

**WH-CE
CENTROTEC®**

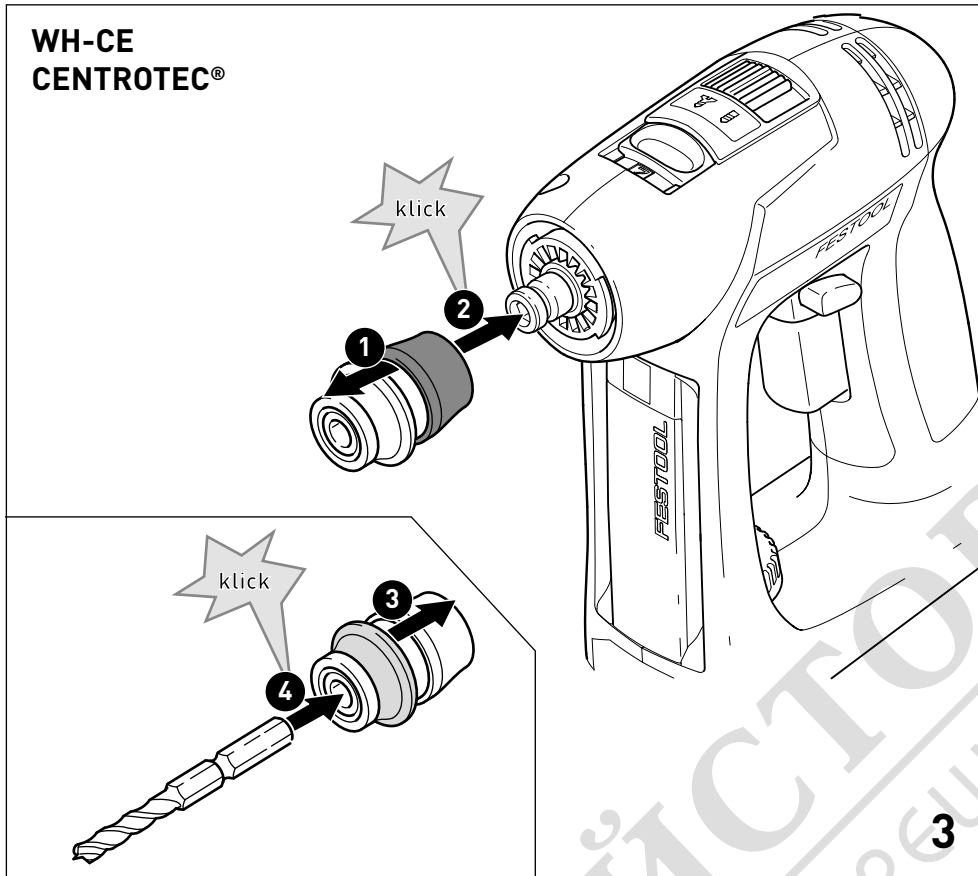

BF-FX

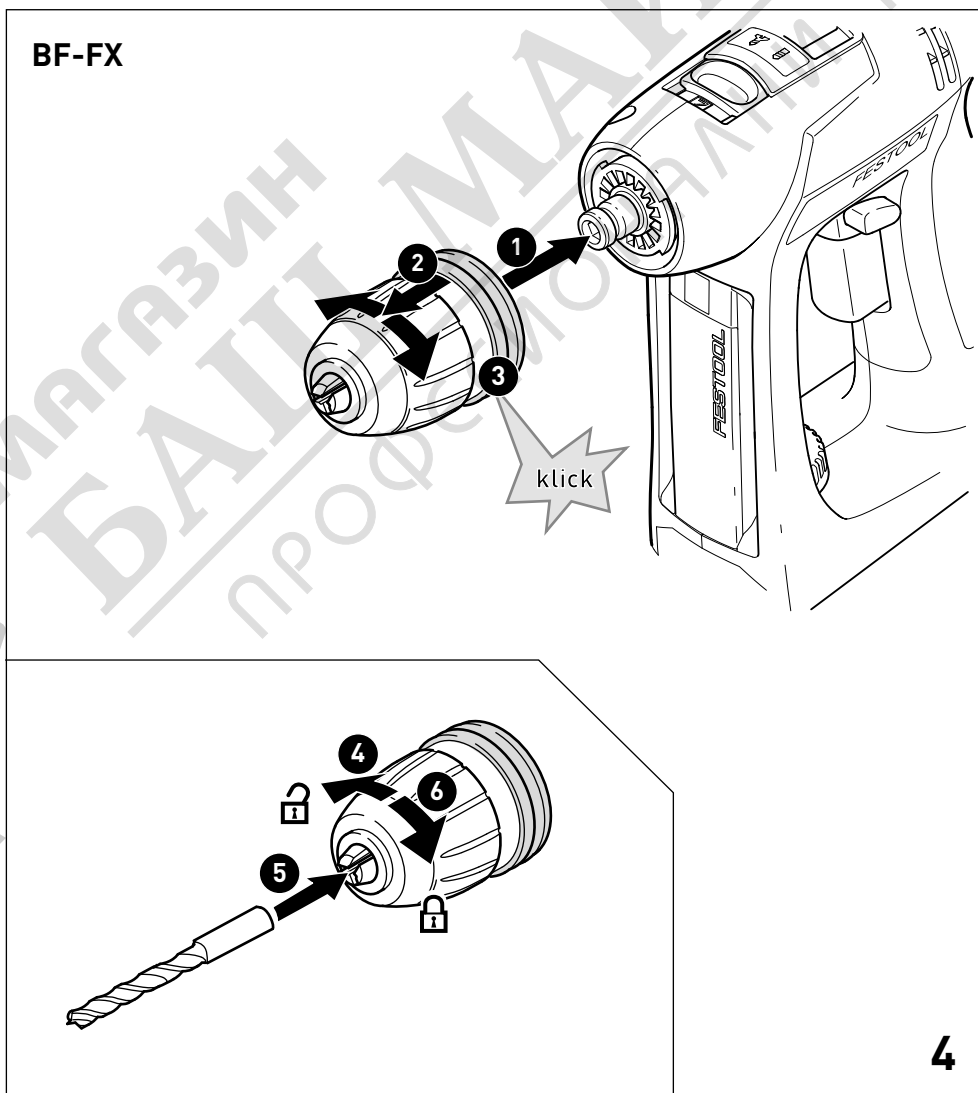

DD-AS + BF-FX
+ WH-CE

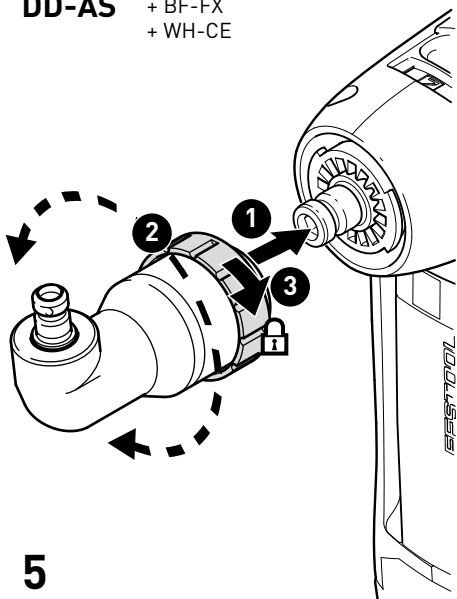

DD-ES

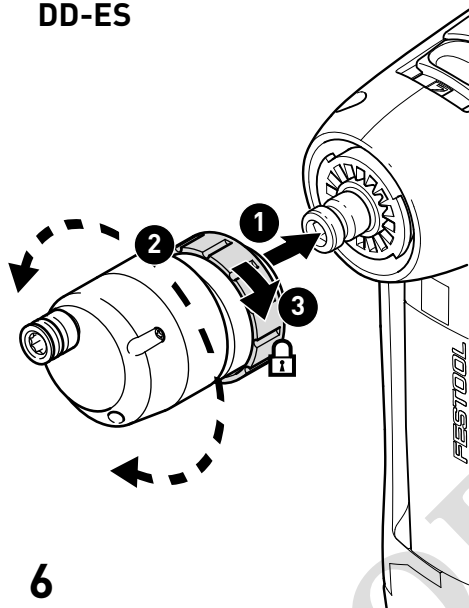

7

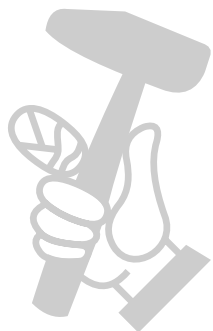
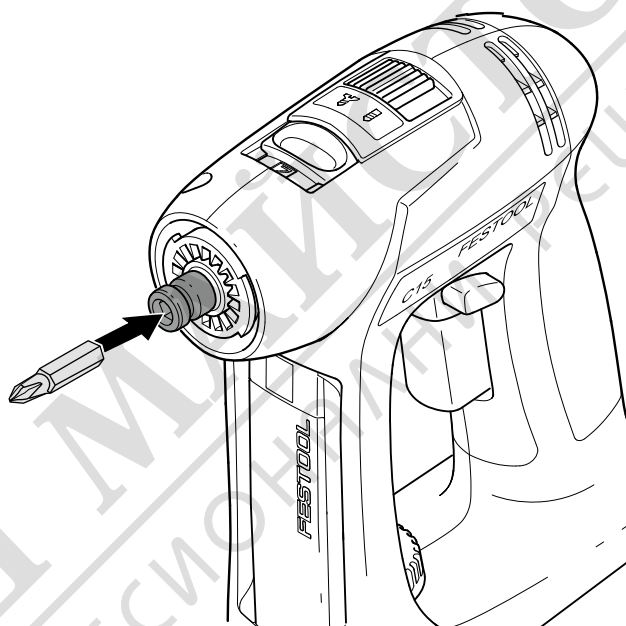

Contents

1	Symbols.....	12
2	Safety warnings.....	12
3	Intended use.....	13
4	Technical data.....	13
5	Functional description.....	14
6	Commissioning.....	14
7	Battery pack.....	14
8	Settings.....	15
9	Tool holder, attachments.....	15
10	Working with the machine.....	15
11	Service and maintenance.....	16
12	Environment.....	16
13	General information.....	16

1 Symbols



Warning of general danger



Warning of electric shock



Read the operating manual and safety instructions.



Wear ear protection.



Wear protective goggles.



Wear a dust mask.



Do not dispose of it with domestic waste.



CE marking: Confirms the conformity of the power tool with the European Community directives.



Tip or advice



Handling instruction



Inserting the battery pack



Removing the battery pack

2 Safety warnings

2.1 General power tool safety warnings



WARNING! Read all safety warnings, instructions, illustrations and specifications provided with this power tool. Failure to follow all instructions listed below may result in electric shock, fire and/or serious injury.

Save all warnings and instructions for future reference.

The term "power tool" in the warnings refers to your mains-operated (corded) power tool or battery-operated (cordless) power tool.

Follow the operating manual for the charger and the battery pack.

2.2 Machine-specific safety notices

- **Hold the power tool by insulated gripping surfaces, when performing an operation where the cutting accessory or fasteners may contact hidden wiring.** Cutting accessory contacting a "live" wire may make exposed metal parts of the power tool "live" and could give the operator an electric shock.

Safety instructions when using long drill bits

- **a) Never operate at higher speed than the maximum speed rating of the drill bit.** At higher speeds, the bit is likely to bend if allowed to rotate freely without contacting the workpiece, resulting in personal injury.
- **b) Always start drilling at low speed and with the bit tip in contact with the workpiece.** At higher speeds, the bit is likely to bend if allowed to rotate freely without contacting the workpiece, resulting in personal injury.
- **c) Apply pressure only in direct line with the bit and do not apply excessive pressure.** Bits can bend causing breakage or loss of control, resulting in personal injury.

2.3 Further safety instructions

- **Use appropriate detection devices to look for any hidden supply lines or consult your local utility company.** If the insertion tool makes contact with live cables, it can result in fire and electric shock. Damage to a gas pipe can lead to an explosion. Penetration of a water pipe can result in damage to property.



Wear suitable personal protective equipment: Ear protection and safety goggles.



CAUTION! Power tool can jam and cause sudden kickback! Switch off immediately!

- **Hold the power tool firmly in your hand. Make sure the speed is adjusted correctly when screwdriving. Be prepared for a high reaction torque**, which may cause the power tool to turn and possibly lead to injury.
- **Do not use the power tool in the rain or in damp surroundings.** Moisture in the power tool may cause a short circuit and fire.
- Do not lock the on/off switch in place permanently.
- **Do not use power supply units or third-party battery packs to operate cordless power tools. Do not use third-party chargers to charge the battery packs.** The use of accessories not expressly authorised by the manufacturer can result in electric shocks and/or serious accidents.
- **Only for AS/NZS:** The tool shall always be supplied via residual current device with a rated residual current of 30 mA or less.

2.4 Emission levels

The levels determined in accordance with EN 62841 are typically:

Drilling

Sound pressure level	$L_{PA} = 65 \text{ dB(A)}$
Sound power level	$L_{WA} = 76 \text{ dB(A)}$
Uncertainty	$K = 3 \text{ dB}$

Fastening

Sound pressure level	$L_{PA} = 64 \text{ dB(A)}$
Sound power level	$L_{WA} = 75 \text{ dB(A)}$
Uncertainty	$K = 3 \text{ dB}$



CAUTION

Noise generated when working

Risk of damage to hearing

- Use ear protection.

4 Technical data

Cordless drill	C 18 Li	
Motor voltage	18 V	
No-load speed*	1st gear	0 - 450 rpm
	1st gear	0 - 1500 rpm

Vibration emission level a_h (vector sum for three directions) and uncertainty K measured in accordance with EN 62841:

Drilling in metal	$a_h = 3.6 \text{ m/s}^2$
	$K = 1.5 \text{ m/s}^2$
Fastening	$a_h < 2.5 \text{ m/s}^2$
	$K = 1.5 \text{ m/s}^2$

The specified emission levels (vibration, noise)

- are used to compare machines.
- They are also used for making preliminary estimates regarding vibration and noise load during operation.
- They represent the primary applications of the power tool.



CAUTION

The emission values may deviate from the specified values. This is dependent on how the tool is used and the type of workpiece being machined.

- The actual load during the entire operating cycle must be evaluated.
- Depending on the actual load, suitable protective measures must be defined in order to protect the operator.

3 Intended use

Cordless drill suitable

- for drilling in metal, wood, plastics and similar materials,
- for screwing in and tightening screws.
- intended for use with BP Festool battery packs of the same voltage class.



The user is liable for damage and accidents caused by improper and non-intended use; this also includes damage and wear caused by continuous industrial operation.

Cordless drill	C 18 Li	
Max. torque	Soft material (wood)	27 Nm
	Hard material (metal)	45 Nm
Adjustable torque**	1st gear	0.8 - 8 Nm
	2nd gear	0.5 - 6 Nm
Chuck clamping range	1.5 - 13 mm	
Max. drill diameter	Wood	40 mm
	Metal	13 mm
Tool holder in drill spindle	1/4"	
Weight (incl. battery pack BP 18 Li 6,2 AS and chuck) as per EPTA procedure 01:2014	2 kg	
Weight with Centrotec, without battery pack.	1.0 kg	

* Speed specifications with fully charged battery pack.

** The maximum speed is reduced in the lower torque stages (values in clockwise rotation).

5 Functional description

- [1-1]** Torque thumbwheel
- [1-2]** Bit store
- [1-3]** LED light
- [1-4]** Gear switch
- [1-5]** Drilling symbol
- [1-6]** Screwdriving symbol
- [1-7]** Screwdriving/drilling selector switch
- [1-8]** Rotational direction switch
- [1-9]** On/off switch
- [1-10]** Belt clip
- [1-11]** Buttons for releasing the battery pack
- [1-12]** Insulated gripping surfaces (grey shaded area)
- [1-13]** Capacity display button on battery pack
- [1-14]** Capacity indicator

Accessories shown or described are not always included in the scope of delivery.

The specified illustrations appear at the beginning of the Operating Instructions.

6 Commissioning

6.1 Belt clip

The belt clip allows a short-term securing of the device in the work clothes. Insert the belt clip on the designated side, right or left, and fix it with the screw **[1a]**.

6.2 Switching on/off [1-9]

Press = ON, release = OFF

-  The speed can be infinitely adjusted, relative to the pressure applied to the on/off switch.

The LED light **[1-3]** lights up when the on/off switch **[1-9]** is pressed.

7 Battery pack

7.1 Changing the battery pack



Inserting the battery pack [2a]

Removing the battery pack [2b]

The battery pack is ready to use straight out of the box and can be charged at any time.

7.2 Capacity indicator

The capacity display **[1-14]** indicates the charge of the battery pack for approx. 2 seconds after the button **[1-13]** is pressed:

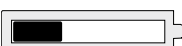
	70-100%
	40-70%
	15-40%

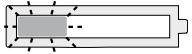

< 15%*

* **Recommendation:** Charge the battery pack before any further use.

- ① Further information about the battery pack and charger can be found in the corresponding operating manual.

8 Settings



CAUTION

Risk of injury

- Only adjust the settings when the power tool is switched off.

8.1 Changing direction of rotation [1-8]

- Switch to the left = clockwise rotation
- Switch to the right = counterclockwise rotation

8.2 Changing gear [1-4]

- ① Only actuate the gear switch with the tool switched off. Otherwise there is a risk of damaging the gear unit.

- Gear switch forwards (digit 1 visible) = 1st gear
- Gear switch to rear (digit 2 visible) = 2nd gear

8.3 Fastening

Adjust the switch so that its marking [1-7] faces the screw symbol [1-6].

Adjust the torque accordingly at the torque wheel [1-1].

Position 1 = low torque

Position 25 = high torque

An **acoustic signal** sounds when the preset torque is reached and the machine then switches off. You must release and press the ON/OFF switch [1-9] again to start the machine.

8.4 Drilling

Adjust the switch [1-7] so that its marking faces the drilling symbol [1-5]. Maximum torque is set in this position.

9 Tool holder, attachments



WARNING

Risk of injury

- Remove the battery pack from the power tool before performing any work on the power tool.



CAUTION

Risk of injury from hot and sharp tool

- Do not use any blunt or faulty tools.
- Wear protective gloves.

9.1 CENTROTEC tool chuck [4]

Quick change of tools with CENTROTEC shaft



Only clamp CENTROTEC tools in CENTROTEC tool chucks.

9.2 Chuck BF-FX

For clamping drill bits and bits with max. shaft diameter of 13 mm.



Clamp tool centrally in the chuck.

9.3 Angle attachment DD-AS [6]

Drilling and screwing at right angle to machine (partly as an accessory).

9.4 Eccentric attachment DD-ES [7]

Screwdriving near edges with bits according to ISO 1173 (partly as accessory).

9.5 Tool holder in the drill spindle [8]

Bits can be inserted directly into the hexagon socket holder of the drill spindle.

10 Working with the machine



WARNING

Risk of injury

- Always secure the workpiece in such a manner that it cannot move while being machined.

10.1 Bit depot [1-2]

Magnetic, for storing bits and bit holders.

10.2 Acoustic warning signals

Acoustic warning signals sound and the machine switches off in the following operating states:



Battery flat or machine overloaded.

- Change the battery.
- Place the machine under reduced stress.



Machine is overheating.

- You must allow the machine to cool before using again.



Lilon battery pack is faulty or has overheated.

- Once the battery pack has cooled, perform a functional check using the charger.

11 Service and maintenance



WARNING

Risk of injury, electric shock

- Always remove the battery pack from the power tool before performing any maintenance or service work.
- All maintenance and repair work which requires the motor housing to be opened should always be carried out by an authorised service workshop.



Customer service and repairs must only be carried out by the manufacturer or service workshops. Find the nearest address at:
www.festool.co.uk/service



Always use original Festool spare parts. Order no. at:
www.festool.com/service

To ensure constant air circulation, always keep the cooling air openings in the motor housing clean and free of blockages.

Keep the contacts on the power tool, charger and battery pack clean.

12 Environment



Do not dispose of the device in the household waste! Recycle devices, accessories and packaging. Observe applicable national regulations.

EU only: In accordance with the European Directive on waste electrical and electronic equipment and implementation in national law, used power tools must be collected separately

and handed in for environmentally friendly recycling.

Information on REACH: www.festool.com/reach

13 General information

13.1 Bluetooth®

The Bluetooth® word mark and the logos are registered trademarks of Bluetooth SIG, Inc.; they are used by TTS Tooltechnic Systems AG & Co. KG, and therefore by Festool, under licence.