

## Вложка 1/2", 12-ъгълна - 190/1 12р

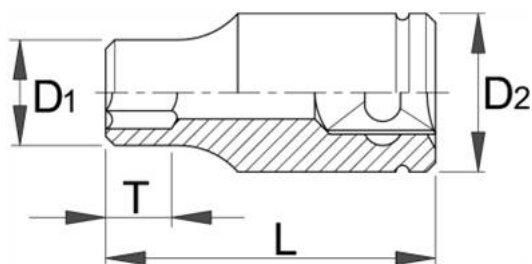

### Описание





- материал: хром-ванадий
- кована, изцяло закалена
- хромирана в съответствие със стандарт EN 12540
- полирана
- изработена в съответствие със стандарт ISO 2725-1 (само за метрични размери)

### Технически параметри

Barcode	Symbol	D1	D2	L	T	Weight	Material	Finish	Coating
603812	10	15	22.9	38	12	55	4B	10	-
603813	11	16.3	22.9	38	12	55	4B	10	-
603814	12	17.9	22.9	38	12	65	4B	10	-
603815	13	18.8	22.9	38	12	65	4B	10	-
603816	14	19.7	22.9	38	12	65	4B	10	-
603817	15	20.4	22.9	38	12	65	4B	10	-
603818	16	22.9	21.5	38	12	65	4B	10	-
603819	17	24.3	22	38	12	65	4B	10	-
603820	18	25.5	23	38	12	100	4B	10	-
603821	19	26.8	24	38	14	105	4B	10	-
603822	20	28.1	24	38	14	115	4B	10	-
603823	21	29.3	25	38	14	128	4B	10	-
603824	22	30.4	25	38	14	142	4B	10	-
603825	23	31.7	26	40	14	147	4B	10	-
603826	24	33.1	28	42	16	165	4B	10	-
603827	27	37	30	43	18	180	4B	10	-
603828	30	40.7	34	46	22	195	4B	10	-
603829	32	43.2	36	46	22	237	4B	10	-
621722	36	48	42	46	22	245	4B	10	-
609366	3/8"	15	22.9	38	12	55	4B	10	-
609367	7/16"	16.3	22.9	38	12	55	4B	10	-
609368	1/2"	18.8	22.9	38	12	65	4B	10	-
609369	9/16"	20.4	22.9	38	12	65	4B	10	-
609370	19/32"	20.4	20.7	38	12	65	4B	10	-
609371	5/8"	22.9	21.5	38	12	65	4B	10	-
609372	11/16"	25.5	23	38	12	65	4B	10	-
609373	3/4"	26.8	24	38	14	105	4B	10	-
609374	25/32"	27.9	24	38	14	115	4B	10	-
609375	13/16"	29.3	25	38	14	128	4B	10	-
609376	7/8"	31.7	26	40	14	142	4B	10	-
609377	15/16"	33.1	28	42	16	165	4B	10	-
609378	1"	35.3	30	42	16	170	4B	10	-
609379	1.1/16"	37	30	43	18	180	4B	10	-
609380	1.1/8"	39	32	43	20	190	4B	10	-
609381	1.3/16"	40.7	34	46	22	195	4B	10	-
609382	1.1/4"	43.2	36	46	22	237	4B	10	-

### Информация за опаковането

Barcode	Symbol	Опаковка за търговия на дребно					Транспортна опаковка			
		A	Б	Ц	Weight	Volume	A1	Б1	Ц1	Weight
603812	10	105	44	43	60	4	93	144	57	365
603813	11	105	44	43	60	4	93	144	57	365
603814	12	105	44	43	70	4	93	144	57	405
603815	13	105	44	43	70	4	93	144	57	405
603816	14	105	44	43	70	4	93	144	57	405
603817	15	105	44	43	70	4	93	144	57	405
603818	16	105	44	43	70	4	93	144	57	405
603819	17	105	44	43	70	4	93	144	57	405
603820	18	105	44	43	105	4	93	144	57	545
603821	19	105	44	43	110	4	93	144	57	565
603822	20	105	44	43	120	4	93	144	57	605
603823	21	105	44	43.4	133	4	93	144	57	657
603824	22	105	44	43	147	4	93	144	57	713
603825	23	105	44	44.6	152	4	93	144	57	733
603826	24	105	44	43	170	4	93	144	57	805
603827	27	105	44	44	185	4	93	144	57	865
603828	30	105	44	45	200	4	93	144	57	925

 	Опаковка за търговия на дребно						Транспортна опаковка			
	A	Б	Ц			A1	Б1	Ц1		
603829	32	110	44	49,5	242	4	93	144	57	1093
621722	36	110	44	50	250	4	65	238	59	1125
609366	3/8"	105	44	43	60	4	93	144	57	365
609367	7/16"	105	44	43	60	4	93	144	57	365
609368	1/2"	105	44	43	70	4	93	144	57	405
609369	9/16"	105	44	43	70	4	93	144	57	405
609370	19/32"	105	44	43	70	4	93	144	57	405
609371	5/8"	105	44	43	70	4	93	144	57	405
609372	11/16"	105	44	43	70	4	93	144	57	405
609373	3/4"	105	44	43	110	4	93	144	57	565
609374	25/32"	105	44	43	120	4	93	144	57	605
609375	13/16"	105	44	43	133	4	93	144	57	657
609376	7/8"	105	44	43	147	4	93	144	57	713
609377	15/16"	105	44	43	170	4	93	144	57	805
609378	1"	105	44	44	175	4	93	144	57	825
609379	1.1/16"	105	44	44	185	4	93	144	57	865
609380	1.1/8"	105	44	44	195	4	93	144	57	905
609381	1.3/16"	105	44	44	200	4	93	144	57	925
609382	1.1/4"	110	44	44	242	4	93	144	57	1093

