

Model No.SN001G CORDLESS SNOW BLOWER

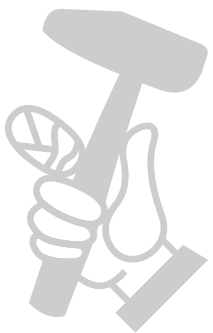

МАГАЗИН МАЙСТОРА
БАШІ МАЙСТОРА
ПРОФЕСІОНАЛНИ РЕШЕННЯ

Model No. SN001G CORDLESS SNOW BLOWER

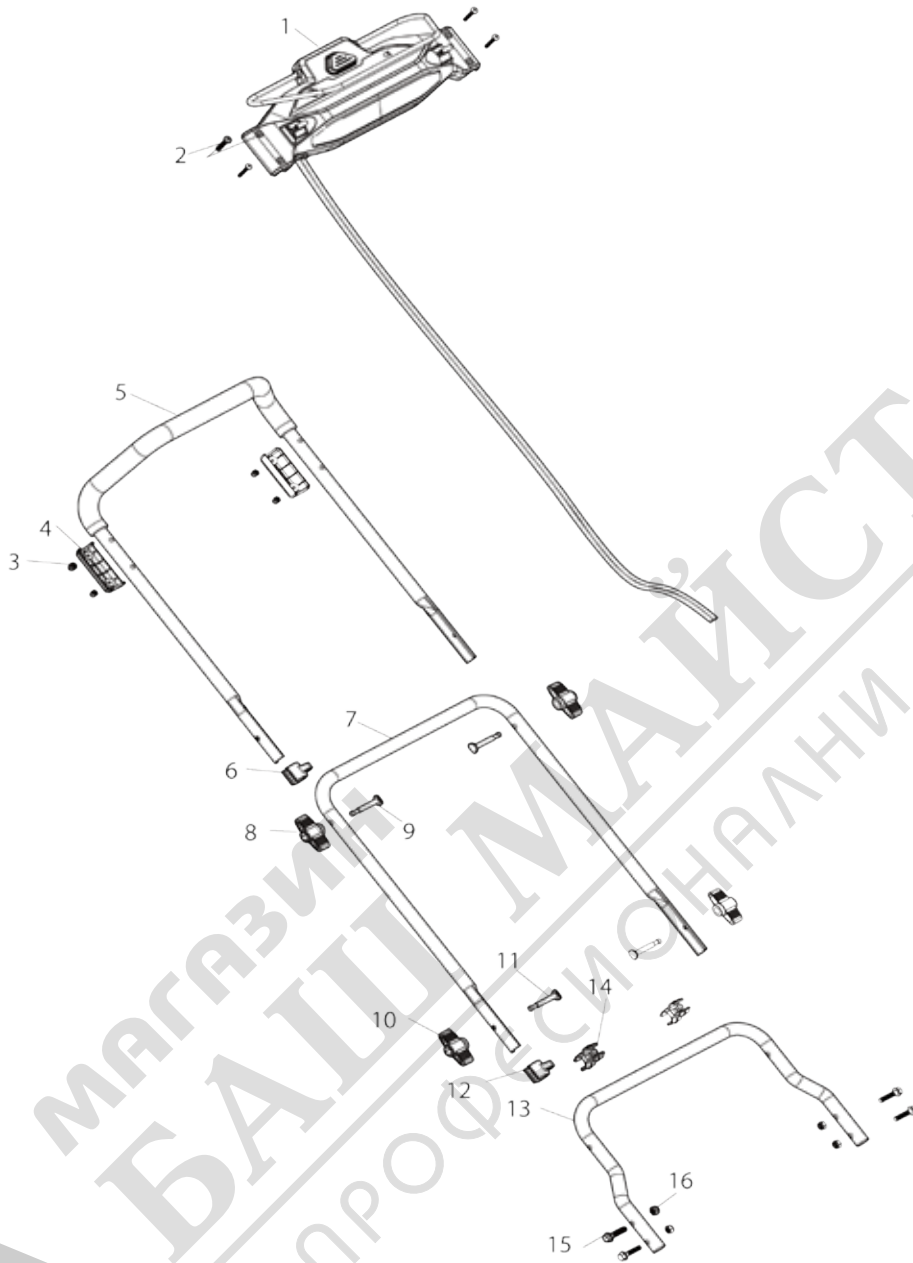
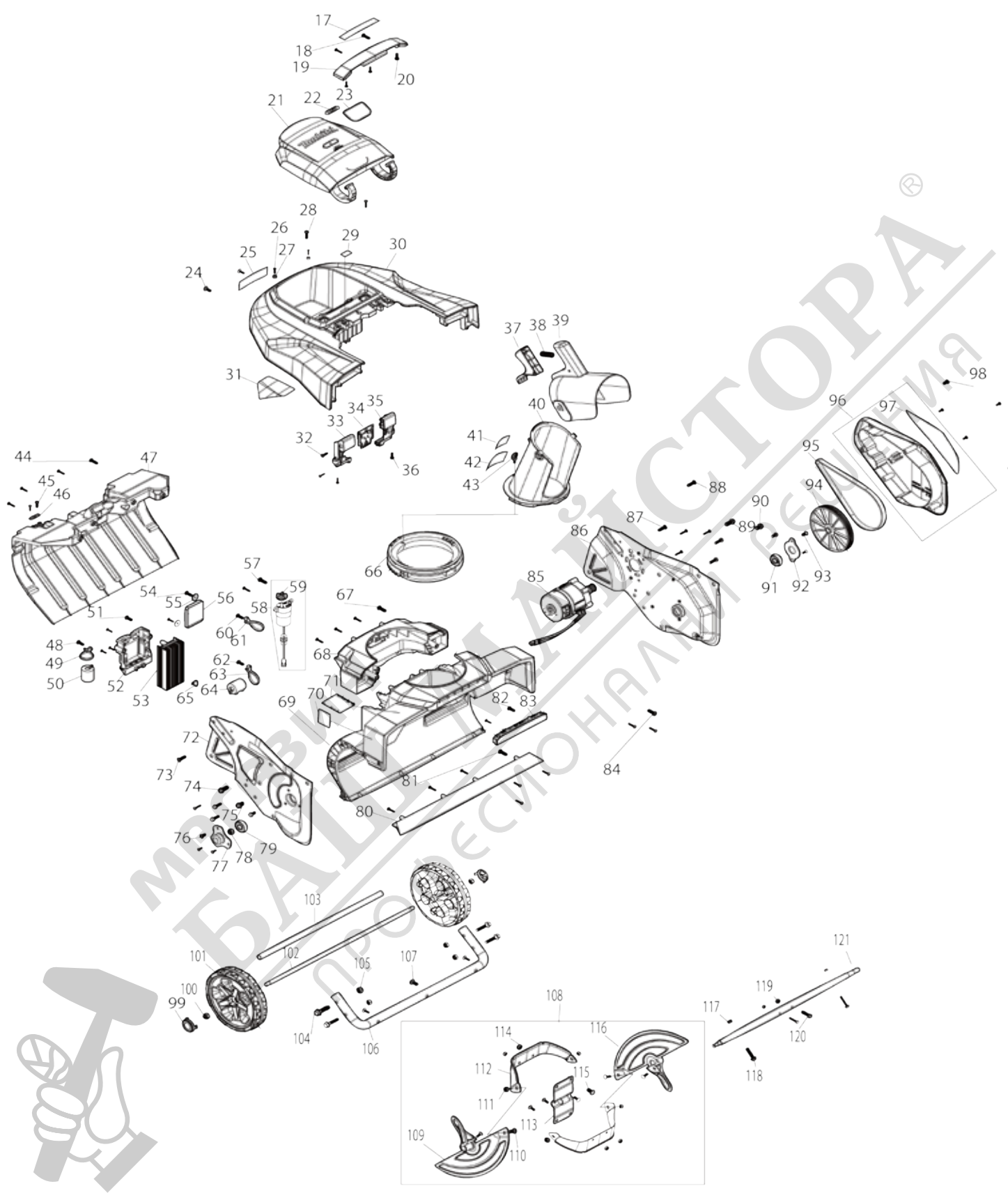

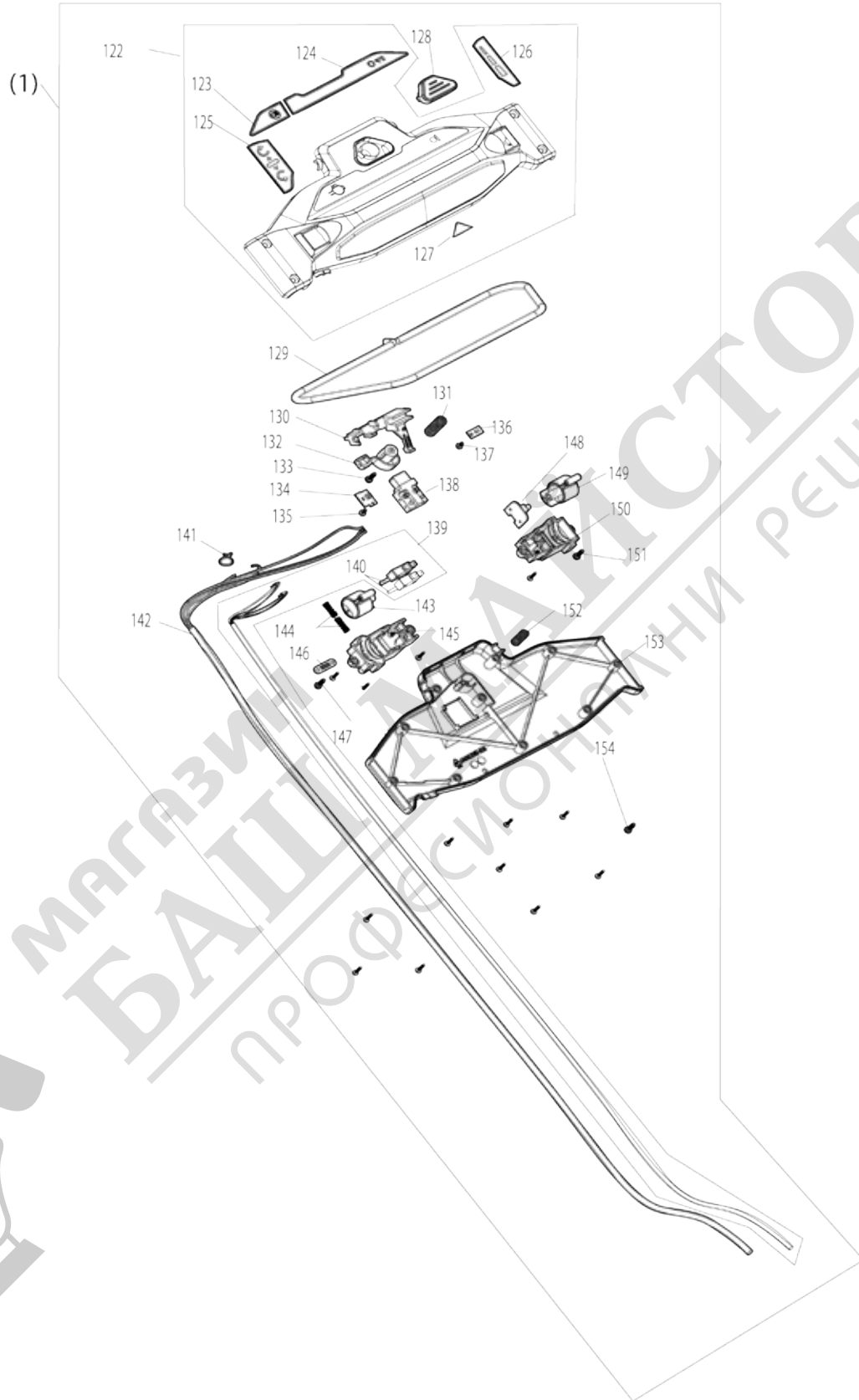

Model No.SN001G CORDLESS SNOW BLOWER

Item No.	Parts No.	Description	Interchangability	Q'ty	New/Old	Note1	Note2
001	YA00001562	CONTROLLER BOX ASSY EU		1			
001		INC. 122,128-139,141-154					
002	YA00001448	BINDING HEAD SCREW M6X35		4			
003	YA00001447	HEX CAP NUT M6		4			
004	YA00001531	CONTROLLER BOX FIX PANEL		2			
005	YA00001563	UPPER HANDLE ASSY		1			
006	YA00001450	CORD HOLDER		1			
007	YA00001557	CENTER HANDLE ASSY		1			
008	YA00001564	WING NUT ASSY M8		2			
009	YA00001558	SADDLE HEAD CAPTIVE BOLT M8 X60		2			
010	YA00001564	WING NUT ASSY M8		2			
011	YA00001558	SADDLE HEAD CAPTIVE BOLT M8 X60		2			
012	YA00001450	CORD HOLDER		1			
013	YA00001555	LOWER HANDLE		1			
014	YA00001559	SNOW REMOVAL SPEAR HOLDER		2			
015	YA00001449	HEX FLANGE BOLT M8X35		4			
016	YA00001446	HEX FLANGE LOCK NUT M8		4			
017	YA00001477	WARNING LABEL LOW-TEMP		1			
018	YA00001493	TAPPING SCREW 5X20		2			
019	YA00001509	HINGE COVER		1			
020	YA00000820	SELF TAPPING SCREW ST5X16		3			
021	YA00001565	BATTERY COVER ASSY		1			
022	YA00001462	XGT LABEL		1			
023	YA00001460	530MM LABEL JP		1			
024	YA00001445	TRUSS HEAD TAPPING SCREW 5X16		2			
025	YA00001454	NAME PLATE EU		1			
026	YA00001498	T10 COUNTERSUNK TAPPING 3X16		2			
027	YA00001538	BATTERY COVER MAGNET CATCH		2	*		
028	YA00001493	TAPPING SCREW 5X20		2			
029	YA00001463	SN001G SERIAL NUMBER LABEL		1			
030	YA00001542	REAR HOUSING UPPER		1	*		
030-1	YA00001588	REAR HOUSING UPPER ASSY	<	1			
030-1		INC. 026					
031	YA00001478	DANGER LABEL PENTAGON		1			
032	YA00001443	TAPPING SCREW 4X16		2			
033	YA00001543	TERMINAL BRACKET RIGHT		1			
034	YA00001553	BATTERY TERMINAL		1			
035	YA00001544	TERMINAL BRACKET left		1			
036	YA00001443	TAPPING SCREW 4X16		2			
037	YA00001523	SNOW OUTLET ANGLE ADJUST LEVER		1			
038	YA00001533	COMPRESSION SPRING		1			
039	YA00001525	SNOW OUTLET PIPE UPPER		1			
040	YA00001524	SNOW OUTLET PIPE LOWER		1			
041	YA00001584	CAUTION LABEL OUTLET PIPE		1			

042	YA00001479	DANGER LABEL	1		
043	YA00001534	WING BOLT M5X24	1		
044	YA00001493	TAPPING SCREW 5X20	4		
045	YA00001443	TAPPING SCREW 4X16	2		
046	YA00001483	CORD CLAMP	1		
047	YA00001517	REAR HOUSING LOWER	1		
048	YA00001444	TAPPING SCREW FLANGE 4X16	1		
049	YA00001497	CABLE TIE WITH SCREW HOLE	1		
050	YA00001485	FERRITE CORE	1		
051	YA00001444	TAPPING SCREW FLANGE 4X16	4		
052	YA00001539	FIX PLATE FOR CONTROLLER LARGE	1		
053	YA00001541	CONTROLLER LARGE	1		
054	YA00001444	TAPPING SCREW FLANGE 4X16	2		
055	YA00001442	FLAT WASHER 4	2		
056	YA00001540	CONTROLLER SMALL	1		
057	YA00001493	TAPPING SCREW 5X20	2		
058	YA00001567	OUTLET ANGLE ADJUST MOTOR ASSY	1		
058		INC. 59			
059	YA00001579	PINION GEAR 5	1		
060	YA00001444	TAPPING SCREW FLANGE 4X16	1		
061	YA00001497	CABLE TIE WITH SCREW HOLE	1		
062	YA00001444	TAPPING SCREW FLANGE 4X16	1		
063	YA00001497	CABLE TIE WITH SCREW HOLE	1		
064	YA00001485	FERRITE CORE	1		
065	687011-8	Band	1		
066	YA00001568	OUTLET ANGLE ADJUST RING ASSY	1		
067	YA00001493	TAPPING SCREW 5X20	4		
068	YA00001516	CENTER HOUSING	1		
069	YA00001518	FRONT HOUSING	1		
070	YA00001473	NOISE LEVEL LABEL EU	1		
071	YA00001480	DANGER LABEL	1		
072	YA00001504	SIDE FRAME PANEL RIGHT	1		
073	YA00001493	TAPPING SCREW 5X20	2		
074	YA00001503	HEX FLANGE TAPPING SCREW 6.5X2	3		
075	YA00001502	HEX FLANGE TAPPING SCREW 6.5X1	2		
076	YA00001512	TAPPING SCREW CT 5X12	3		
077	YA00001510	BEARING RETAINER COVER	1		
078	YA00001491	HEX LOCK NUT M10	1		
079	YA00001488	BALL BEARING 6201RS	1		
080	YA00001515	SNOW SCRAPER	1		
081	YA00001493	TAPPING SCREW 5X20	4		
082	YA00001443	TAPPING SCREW 4X16	2		
083	YA00001569	LED LIGHT ASSY	1		
084	YA00001493	TAPPING SCREW 5X20	6		
085	YA00001566	MOTOR ASSEMBLY	1		
086	YA00001505	SIDE FRAME PANEL LEFT	1		
087	YA00001493	TAPPING SCREW 5X20	3		
088	YA00001493	TAPPING SCREW 5X20	2		

089	YA00001503	HEX FLANGE TAPPING SCREW 6.5X2	3		
090	YA00001502	HEX FLANGE TAPPING SCREW 6.5X1	2		
091	YA00001488	BALL BEARING 6201RS	1		
092	YA00001482	BEARING RETAINER PLATE	1		
093	YA00001511	COUNTERSUNK HEAD SCREW CT 5X12	2		
094	YA00001453	PULLEY 132 M8 LH	1		
095	YA00001508	RIBBED BELT PJ597 235J 5REBS	1		
096	YA00001570	BELT COVER	1		
096		INC. 97			
097	YA00001459	MAKITA LOGO LABEL	1		
098	YA00001512	TAPPING SCREW CT 5X12	5		
099	YA00001496	WHEEL COVER CAP	2		
100	YA00001446	HEX FLANGE LOCK NUT M8	2		
101	YA00001571	WHEEL ASSY	2		
102	YA00001519	AXLE SHAFT 10X511	1		
103	YA00001532	AXLE PIPE 11.5X420	1		
104	YA00001449	HEX FLANGE BOLT M8X35	4		
105	YA00001446	HEX FLANGE LOCK NUT M8	4		
106	YA00001520	UNDER FRAME	1		
107	YA00001445	TRUSS HEAD TAPPING SCREW 5X16	3		
108	YA00001581	BLADE SET	1		
108		INC. 109-116			
109	YA00001506	ROYARY BLADE RIGHT	1		
110	YA00001536	CAP SQUARE NECK BOLT M6X12	4		
111	YA00001490	HEX LOCK NUT M6	4		
112	YA00001513	ROYARY BLADE CENTOR	2		
113	YA00001514	ROYARY BLADE SUPPORT	1		
114	YA00001490	HEX LOCK NUT M6	4		
115	YA00001536	CAP SQUARE NECK BOLT M6X12	4		
116	YA00001507	ROYARY BLADE LEFT	1		
117	YA00000622	HEX LOCK NUT M5	2		
118	YA00001495	HEX FLANGE BOLT M5x30	2		
119	YA00000622	HEX LOCK NUT M5	2		
120	YA00001492	HEX BOLT M5x25	2		
121	YA00001521	BLADE SHAFT 16X505	1		
122	YA00001572	CONT. HOUSING UPPER ASSY EU	1		
122		INC. 123-127			
123	YA00001458	LIGHT SWITCH LABEL	1		
124	YA00001455	OPERATION INSTRUCTION LABEL	1		
125	YA00001457	OUTLET ANGLE ADJUST OP. LABEL	1		
126	YA00001456	SPEED CONTROL LABEL	1		
127	YA00001472	LIGHT WARNING LABEL	1		
128	YA00001527	SWITCH LINK BUTTON	1		
129	YA00001554	SWITCH LEVER	1		
130	YA00001500	SWITCH LEVER LINK ROD	1		
131	YA00001501	SWITCH LEVER RETURN SPRING	1		
132	YA00001499	SWITCH LEVER LINK	1		

133	YA00001443	TAPPING SCREW 4X16		1		
134	YA00001535	SWITCH PCB FOR LIGHT		1		
135	YA00001494	TAPPING SCREW FLANGE 3X8		1		
136	YA00001549	INDICATOR LED PCB		1		
137	YA00001494	TAPPING SCREW FLANGE 3X8		1		
138	YA00001452	MAIN SWITCH		1		
139	YA00001574	CORD WITH MICRO SWITCHES		1		
139		INC. 140				
140	YA00001451	MICRO SWITCH		2		
141	687011-8	Band		1		
142	YA00001548	CORD FOR MAIN SWITCH		1		
143	YA00001528	SWITCH KNOB		1		
144	YA00001537	COMPRESSION SPRING		2		
145	YA00001530	MICRO SWITCH MOUNT		1		
146	YA00001483	CORD CLAMP		1		
147	YA00001443	TAPPING SCREW 4X16		4		
148	YA00001522	SPEED CONT. POTENTIOMETER PCB		1		
149	YA00001528	SWITCH KNOB		1		
150	YA00001529	SPEED CONT. PCB MOUNT		1		
151	YA00001443	TAPPING SCREW 4X16		2		
152	YA00001484	SW LINK BUTTON RETURN SPRING		1		
153	YA00001526	CONTROLLER HOUSING LOWER		1		
154	YA00001443	TAPPING SCREW 4X16		10		
A01	YA00001556	SNOW REMOVAL SPEAR		1		
A02	YA00001547	PACKABLE COVER		1		

Please state Parts No. when your order.

Print Date 12/22/2025

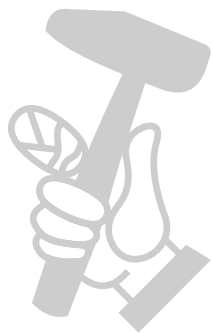

МАГАЗИН МАЙСТОР
БАШ МАЙСТОР
ПРОФЕСИОНАЛНИ РЕШЕНИЯ