

Model No.DDF490 CORDLESS DRIVER DRILL

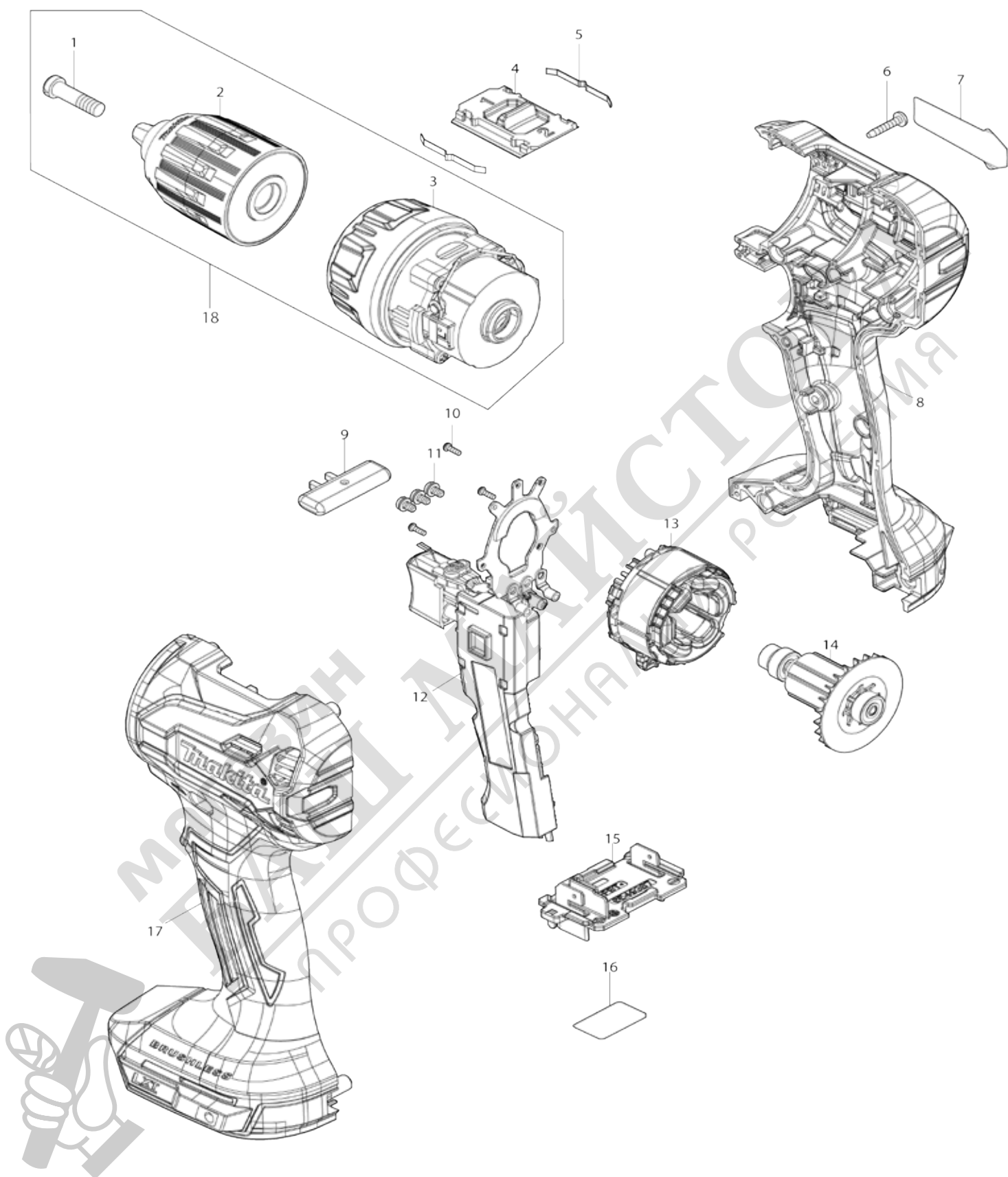

Model No.DDF490 CORDLESS DRIVER DRILL

| Item No. | Parts No. | Description | Interchangability | Q'ty | New/Old | Note1 | Note2 |
|----------|-----------|--------------------------------|-------------------|------|---------|-------|-------|
| 001 | 251468-5 | - FLAT HEAD SCREW M6X22 | | 1 | | | |
| 002 | 763260-2 | KEYLESS DRILL CHUCK 13 | | 1 | | | |
| 003 | 122H75-8 | Gear assembly | | 1 | | | |
| 004 | 4132C1-6 | Speed change lever | | 1 | | | |
| 005 | 232220-0 | LEAF SPRING | | 2 | | | |
| 006 | 266429-2 | TAPPING SCREW 3X16 | | 9 | | | |
| 007 | 8150A2-8 | DDF490 NAME PLATE | | 1 | | | |
| 008 | 1831H5-8 | HOUSING SET | | 1 | | | |
| C10 | 263005-3 | RUBBER PIN 6 | | 2 | | | |
| C20 | 252126-6 | HEX. LOCK NUT M4-7 | | 2 | | | |
| 008 | | INC. 17 | | | | | |
| 009 | 4132C2-4 | F/R change lever | | 1 | | | |
| 010 | 266490-9 | TAPPING SCREW PT 2X6 | | 3 | | | |
| 011 | 652069-6 | FLAT HEAD SCREW M3X6 | | 3 | | | |
| 012 | 620R84-6 | Control module | | 1 | | | |
| 013 | 629372-0 | STATOR | | 1 | | | |
| 014 | 619899-8 | Rotor | | 1 | * | | |
| 014-1 | 619899-8 | Rotor | O | 1 | | | |
| 015 | 654938-7 | Terminal | | 1 | | | |
| 016 | 8150A4-4 | DDF490 SERIAL NO. LABEL | | 1 | | | |
| 017 | 1831H5-8 | HOUSING SET | | 1 | | | |
| C10 | 263005-3 | RUBBER PIN 6 | | 2 | | | |
| C20 | 252126-6 | HEX. LOCK NUT M4-7 | | 2 | | | |
| 017 | | INC. 8 | | | | | |
| 018 | 122H73-2 | Gear chuck assembly | | 1 | | | |
| 018 | | INC. 1-3 | | | | | |
| A01 | 821550-0 | CONNECTOR PLASTIC CASE (TYPE2) | | 1 | | | |
| C10 | 453974-8 | LATCH | | 4 | | | |
| A02 | ***DC18RC | DC18RC FAST CHARGER | | 1 | | | |
| A02 | | COMPO-PARTS | | | | | |
| A03B | 197600-6 | BATTERY BL1830B SET | | 2 | | | |
| A03C | 197280-8 | BATTERY BL1850B SET | | 2 | | | |
| A04 | 450128-8 | BATTERY COVER | | 1 | | | |
| A05 | 837916-4 | INNER TRAY | | 1 | | | |

Please state Parts No. when your order.

Print Date 05/30/2025

