

DWE7800 DRYWALL SANDER 1

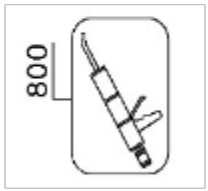
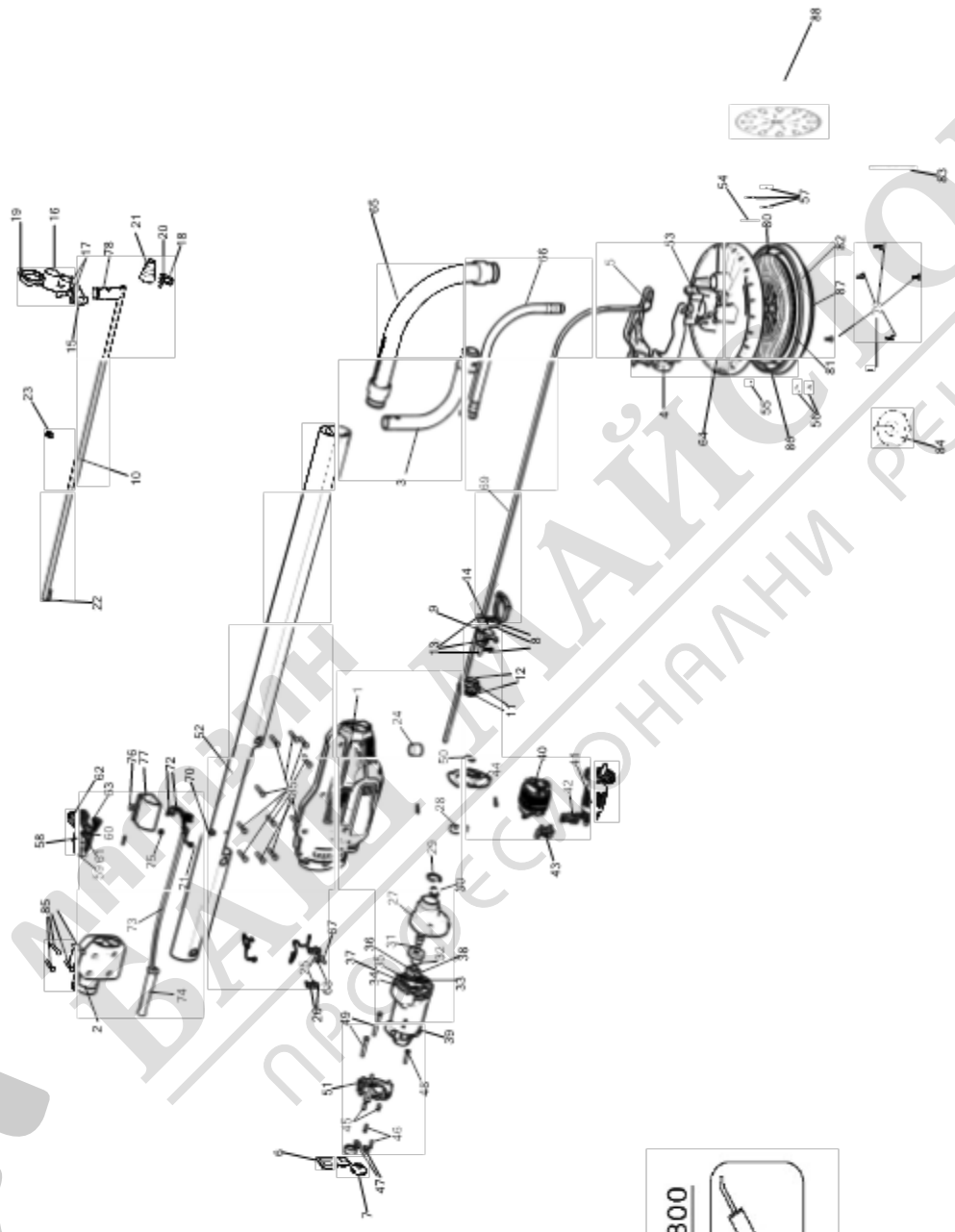

МАЙСТОР  
ПРОФЕСІОНАЛНИ РЕШЕННЯ

## Parts List DWE7800 DRYWALL SANDER 1

Item	Part Number	Qty	Part Description	General Description	Other Info	Repair Inst	Markets
1	N793310	1	HOUSING SA			No	QS
2	N793345	1	HOUSING SA			No	QS
3	645825-00	1	TUBE SUPPORT			No	QS
4	877725	1	HEAD			No	QS
5	879688	1	HEAD			No	QS
6	N734932	1	CONTROL MODULE SA			No	QS
7	N734932	1	CONTROL MODULE SA			No	QS
8	877755	4	SPRING			No	QS
9	877778	1	PIVOT BLOCK			No	QS
10	877774	1	TUBE GUIDE			No	QS
11	878389	1	SCREW			No	QS
12	N097916	2	BEARING			No	QS
13	879685	3	PIN			No	QS
14	N928278	1	STUD			No	QS
15	877733	1	CLAMP			No	QS
16	889303	1	HOUSING			No	QS
17	848565	2	SCREW			No	QS
18	879737	1	PLATE			No	QS
19	884843	2	CLAMP			No	QS
20	882187	2	SCREW			No	QS
21	879772	1	BELLOWS			No	QS
22	695620	1	SEAL			No	QS
23	879769	1	O RING			No	QS
24	879770	1	PLUG			No	QS
25	861434	2	CORD CLAMP			No	QS
26	330019-11	4	SCREW	M4.55x13 T20		No	QS
27	NA021871	1	GEARCASE SA			No	QS
28	605040-20	1	BEARING	12 x 28 x 8mm		No	QS
29	859382	1	RING			No	QS
30	330004-00	1	BEARING			No	QS
31	NA021873	1	SPINDLE			No	QS
32	NA021873	1	SPINDLE			No	QS

## Parts List DWE7800 DRYWALL SANDER 1

Item	Part Number	Qty	Part Description	General Description	Other Info	Repair Inst	Markets
33	023813-00	1	WASHER FIBRE			No	QS
34	176655-00	1	GASKET			No	QS
35	NA021874	1	GEAR & PINION			No	QS
36	NA021874	1	GEAR & PINION			No	QS
37	143079-00	1	BEARING THRUST			No	QS
38	176732-00	3	WASHER			No	QS
39	N655784	1	FIELD CASE			No	QS
40	NA170923	1	FIELD SA	230v		No	QS
41	NA174057	1	ARMATURE & FAN	220-230v		No	QS
42	N440278	1	BRUSH HOLDER	Right		No	QS
43	N440279	1	BRUSH HOLDER	Left		No	QS
44	NA219005	1	GEARCASE COVER SA			No	QS
45	949638-02	2	DAMPER			No	QS
46	176951-00	2	SCREW			No	QS
47	176846-04	2	BRUSH	120V & 230V		No	QS
48	330019-14	1	SCREW			No	QS
49	330019-16	2	SCREW			No	QS
50	089210-00	1	RETAINER			No	QS
51	176811-00	1	BAFFLE			No	QS
52	NA086870	1	VACUUM TUBE SA			No	QS
53	N725018	1	SUPPORT			No	QS
54	NA021877	1	SPINDLE SA		INC. 55-56	No	QS
54	N690875	1	SPINDLE			No	QS
55	684179	1	RING			No	QS
56	605040-72	2	BEARING			No	QS
57	N118088	3	SCREW			No	QS
58	N753929	1	SLIDER			No	QS
59	N768963	1	TRIGGER			No	QS
60	330016-25	1	WASHER			No	QS
61	593387-00	1	SCREW			No	QS
62	N327459	1	SWITCH			No	QS
63	N760899	1	SPRING			No	QS

## Parts List DWE7800 DRYWALL SANDER 1

Item	Part Number	Qty	Part Description	General Description	Other Info	Repair Inst	Markets
64	NA028367	1	HOUSING			No	QS
65	A01929	1	HOSE SA			No	QS
66	659373-00	1	CASING			No	QS
67	389007-00	1	SCREW			No	QS
68	389031-00	1	NUT			No	QS
69	659372-00	1	DRIVE SHAFT			No	QS
70	146929-00	1	SCREW			No	QS
71	697861	3	TERMINAL	GROUND		No	QS
72	683784	2	TERMINAL			No	QS
73	N779415	1	CORDSET			No	QS
74	N918736	1	CORD PROTECTOR			No	QS
75	802429	1	WASHER LOCK	INTERNAL		No	QS
76	913139	1	CLIP			No	QS
77	N792249	1	INSULATOR			No	QS
78	N835652	1	PLASTIC INSERT			No	QS
79	882703	6	SCREW			No	QS
80	N859471	1	PAD			No	QS
81	882685	1	DISC	FRICTION		No	QS
82	N862100	2	FOAM			No	QS
83	877738	1	WASHER			No	QS
84	N862773	1	NUT			No	QS
85	330019-45	15	SCREW			No	QS
86	N736672	1	BRUSH			No	QS
87	877702	1	SKIRT			No	QS
88	N855826	1	PAD SA		INCLUDES	No	QS
100	N786864	1	RATING LABEL		#80	No	QS
101	N168439	1	LABEL			No	QS