

Bedienungsanleitung
Instruction manual
Mode d'emploi
Manual de instrucciones
Istruzioni per l'uso
Gebruiksaanwijzing
Brugsanvisning

Bruksanvisning
Návod k obsluze
Instrukcja obsługi
Руководство по эксплуатации
Manual de instruções
Kezelési útmutató
Kullanım Kılavuzu

取扱説明書
사용 설명서

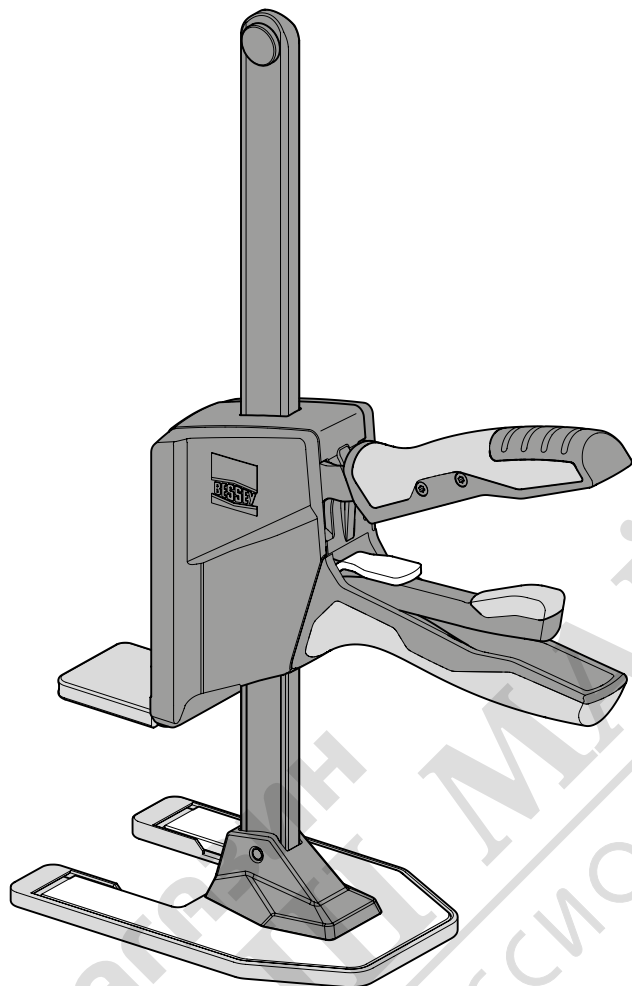

Einhand-Montagewerkzeug BEYCEPS

BEYCEPS single-handed assembly tool

Outil de montage à une main BEYCEPS

Herramienta de montaje monomano BEYCEPS

Atrezzo di montaggio a una mano BEYCEPS

Enkelhands-montagegereedschap BEYCEPS

Enhånds-monteringsværktøj BEYCEPS

Enhands monteringsverktøy BEYCEPS

Jednoruční montážní nástroj BEYCEPS

Jednoręczne narzędzie montażowe BEYCEPS

**Монтажный инструмент BEYCEPS
для эксплуатации одной рукой**

Ferramenta de montagem de mão BEYCEPS

Egykezes szorítószerszám BEYCEPS

BEYCEPS Tek El Montaj Aleti

片手組立工具 BEYCEPS

원핸드 조립 공구 BEYCEPS



 **A-C**

- DE
- GB
- FR
- ES
- IT
- NL
- DK
- SE
- CZ
- PL
- RU
- PT
- HU
- TR
- JP
- KR

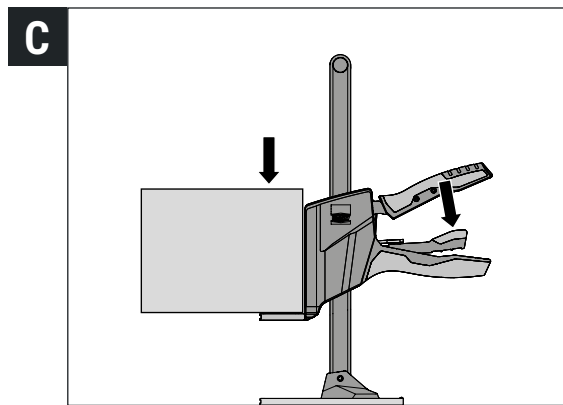
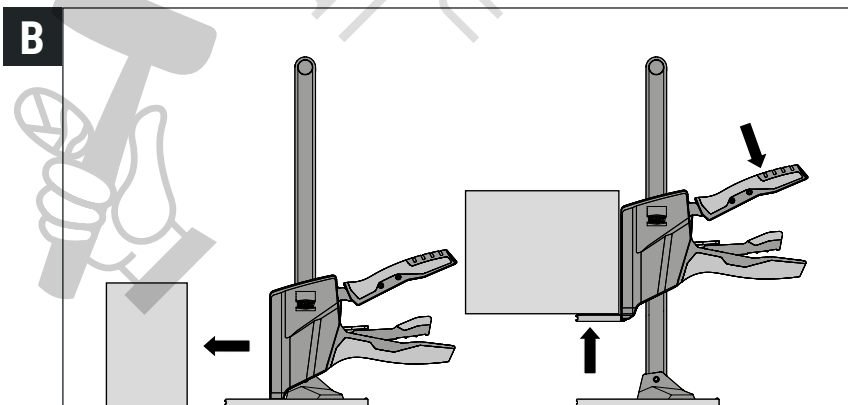
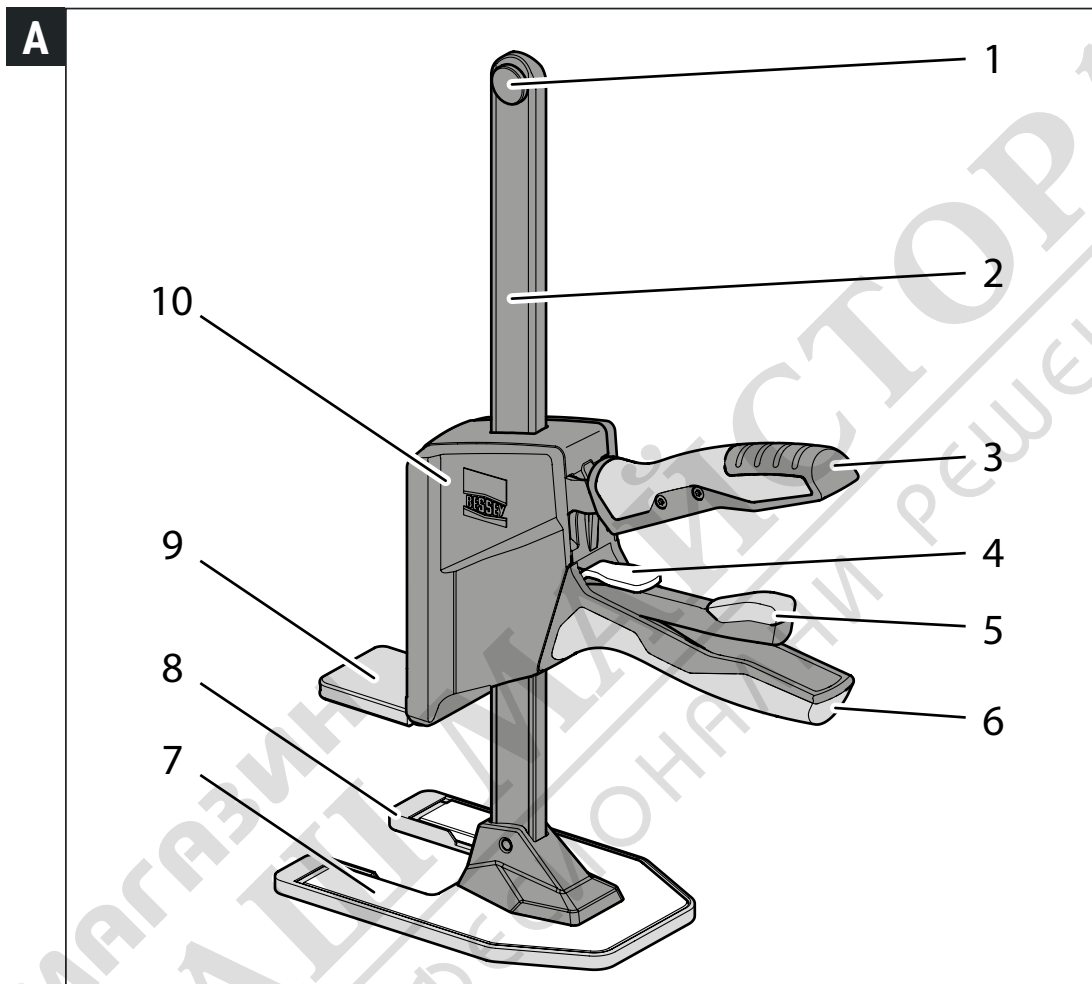



Bilder / Images / Imágenes / Figure / Afbeeldingen / Billeder / Bilder / Obrázky /
Ilustracje / Изображения / Imagens / Ábrák / Görseller / 그림

 **D-F**

DE
GB
FR
ES
IT
NL
DK
SE
CZ
PL
RU
PT
HU
TR
JP
KR

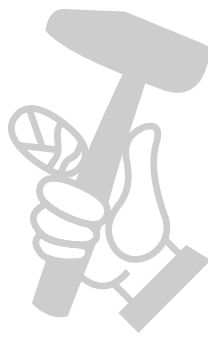
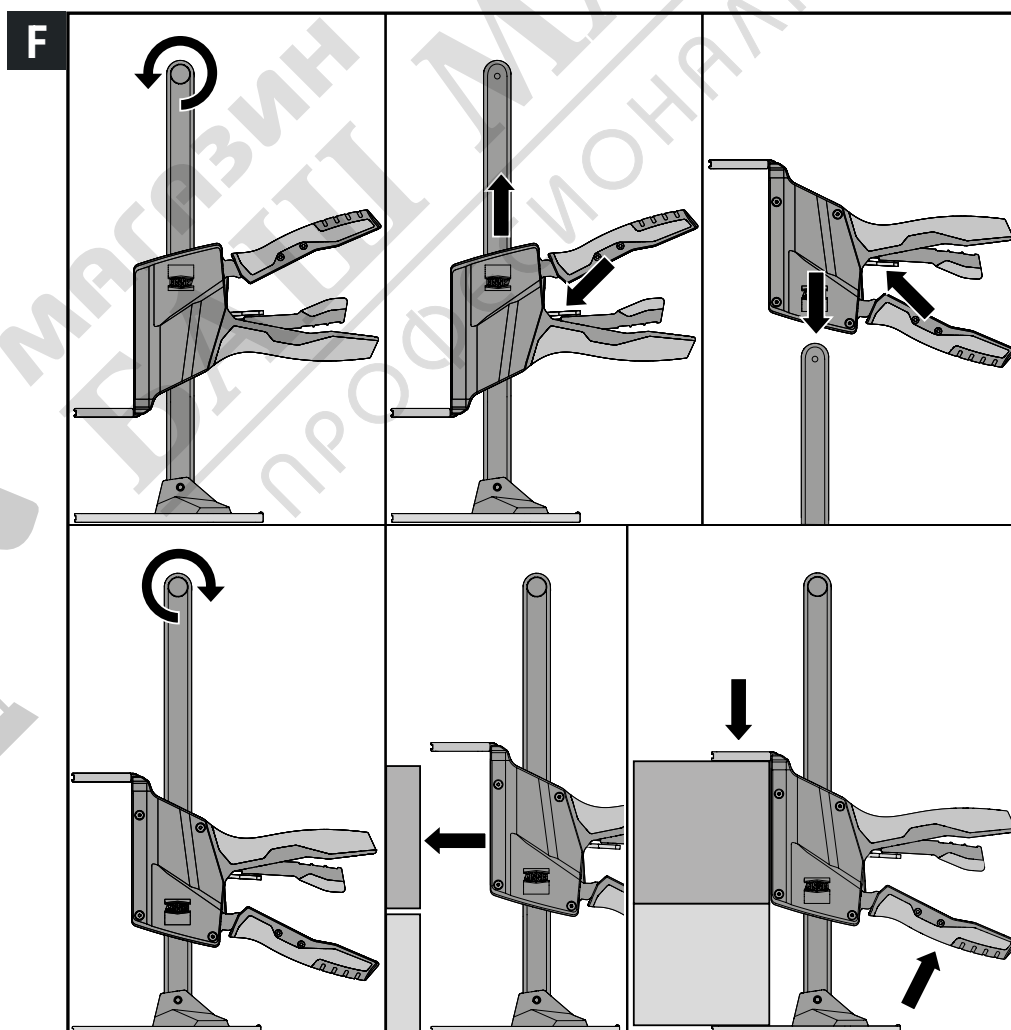
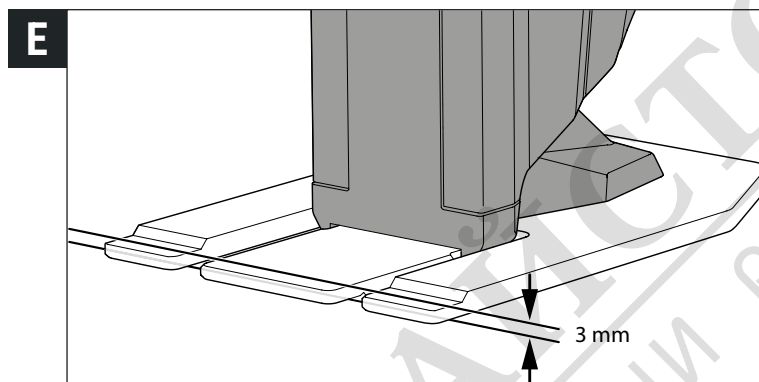
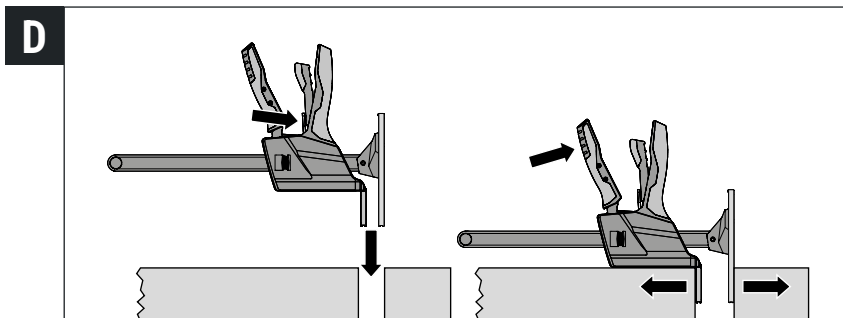



G-I

- DE
- GB
- FR
- ES
- IT
- NL
- DK
- SE
- CZ
- PL
- RU
- PT
- HU
- TR
- JP
- KR

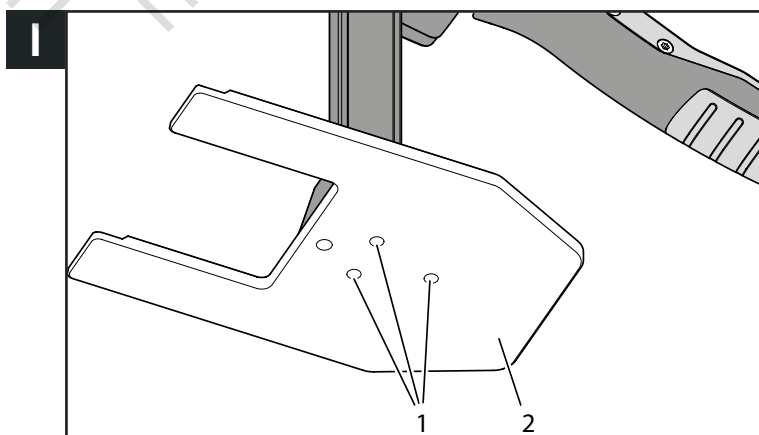
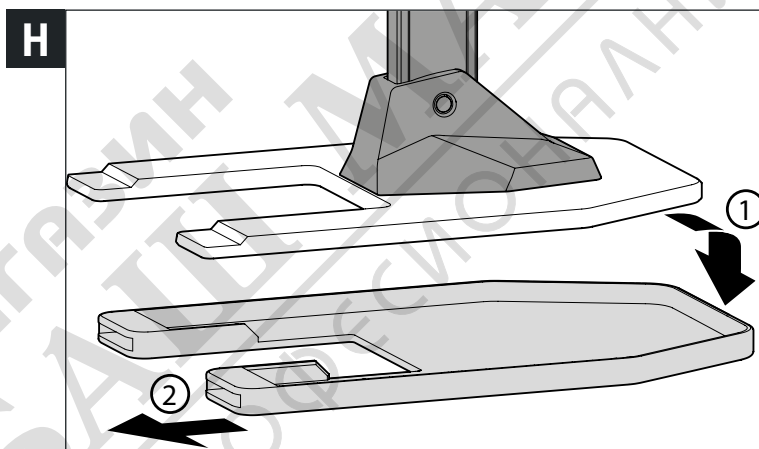
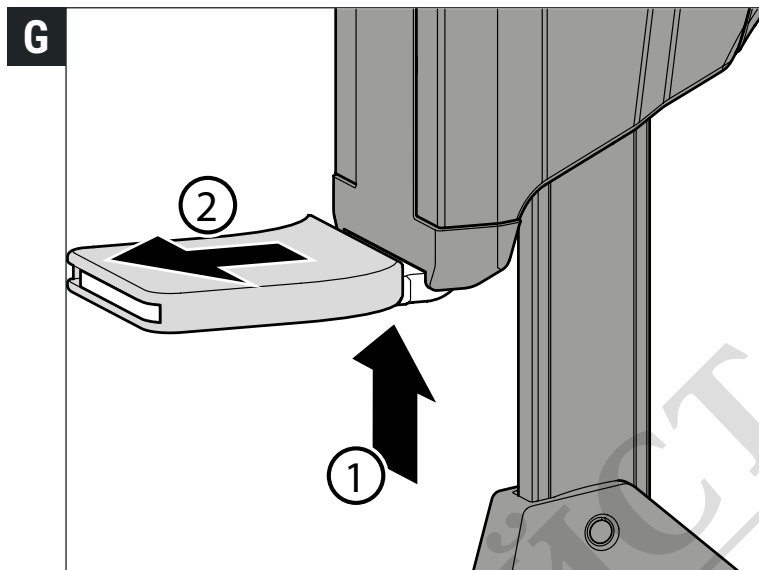



 J-K

- DE
- GB
- FR
- ES
- IT
- NL
- DK
- SE
- CZ
- PL
- RU
- PT
- HU
- TR
- JP
- KR

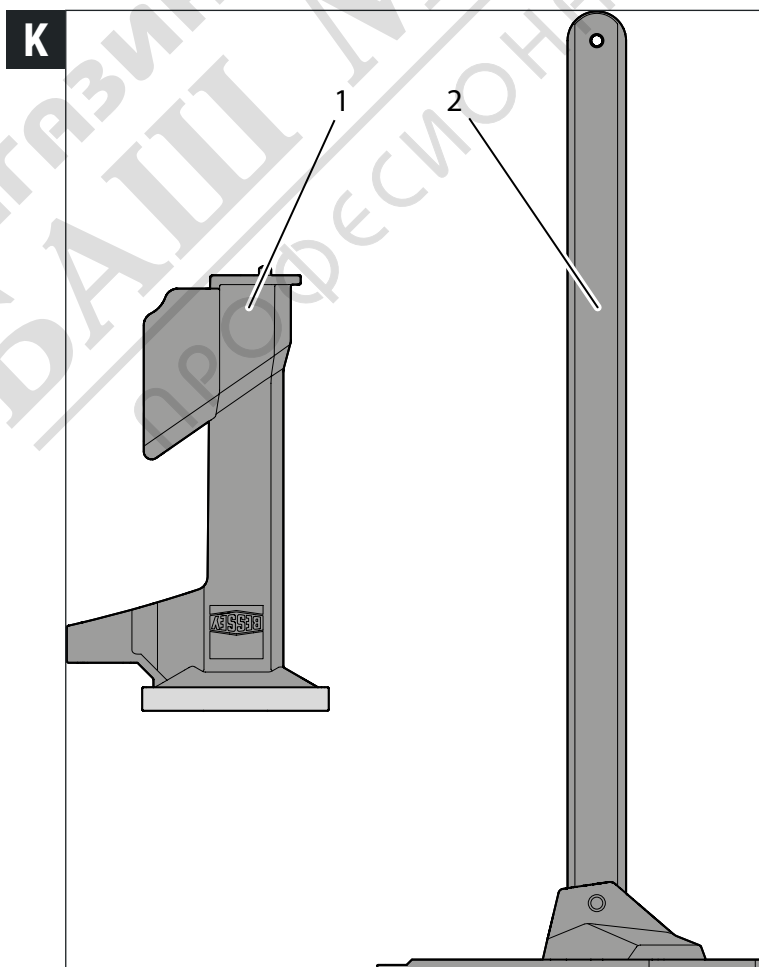
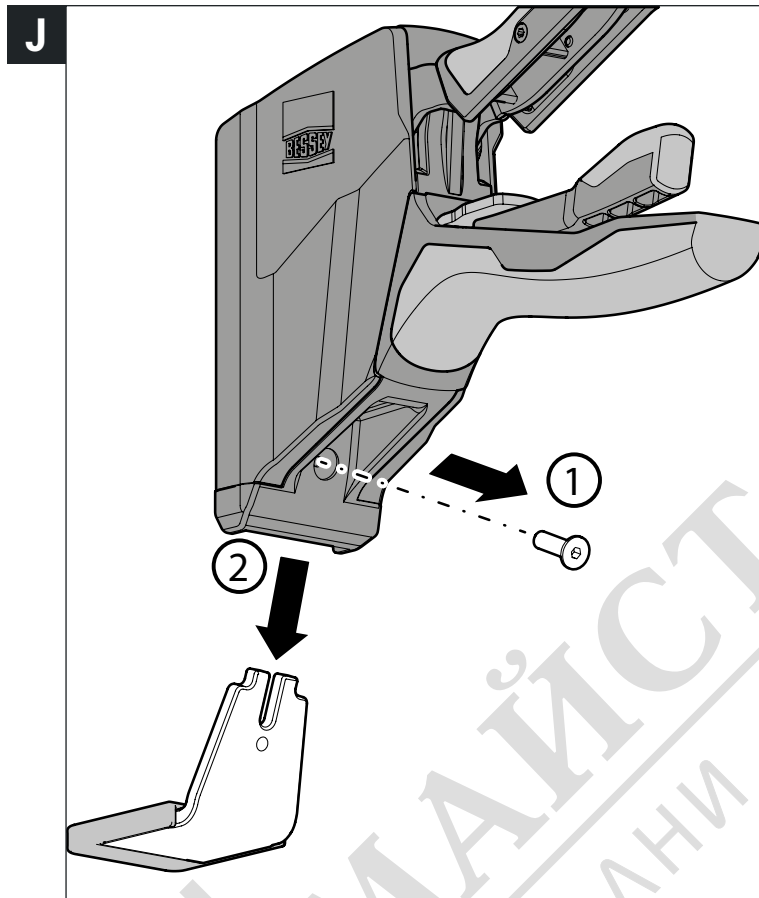



Bilder / Images / Images / Imágenes / Figure / Afbeeldingen / Billeder / Bilder / Obrázky /
Ilustracje / Изображения / Imagens / Ábrák / Görseller / 그림

 L-M



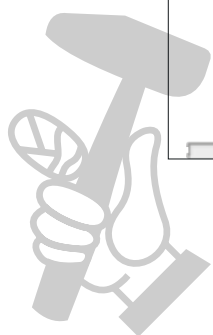
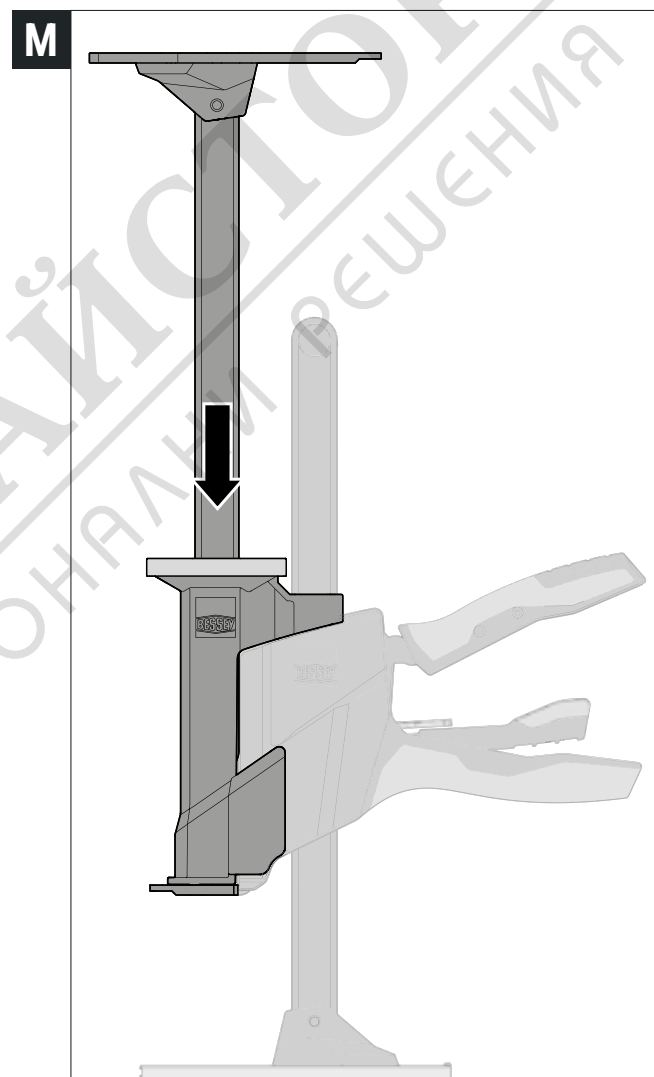
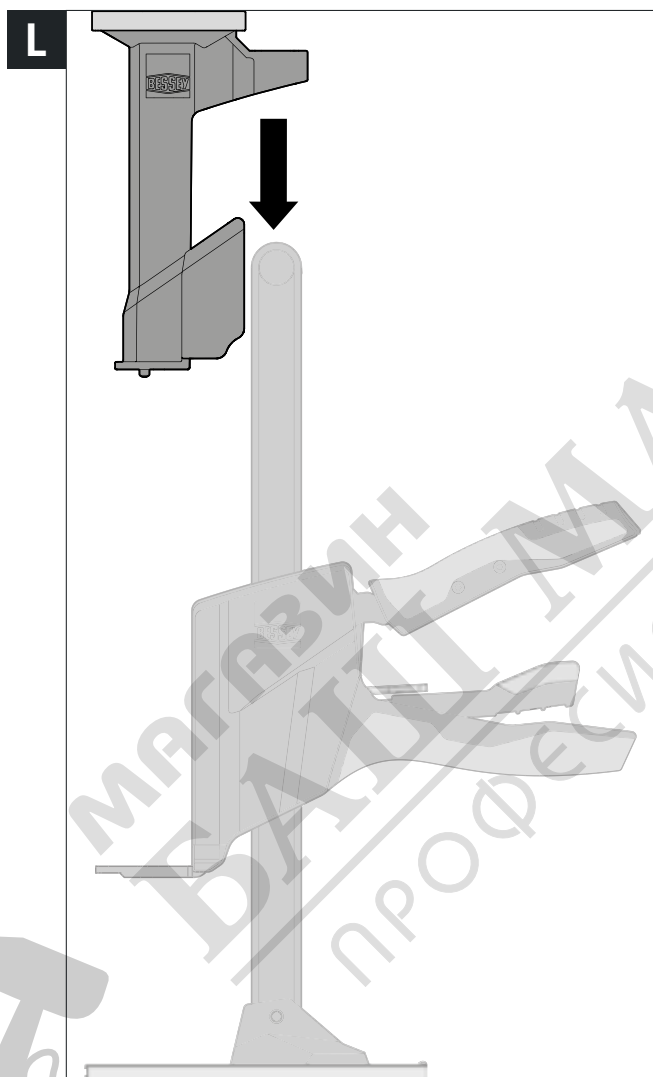

DE
GB
FR
ES
IT
NL
DK
SE
CZ
PL
RU
PT
HU
TR
JP
KR



BEYCEPS single-handed assembly tool

In this instruction manual, the BEYCEPS single-handed assembly tool is referred to as 'product' or 'products'.

Explanation of symbols

	Read and follow the instruction manual.
	Risk of tipping over – The product may tip over if the components are unstable or too heavy.
	Risk of crushing – A lifted component can injure parts of your body if it slips. Parts of your body can be injured when the component is lowered.
	Risk of crushing – A lifted component can injure parts of your body if it slips. Parts of your body can be injured when the component is lowered.

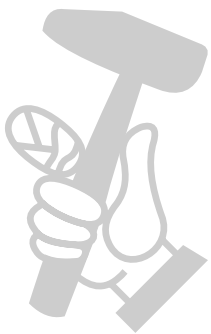

МАГАЗИН МАЙСТОРА
БАШ МАЙСТОРА®
ПРОФЕСИОНАЛНИ РЕШЕНИЯ

BEYCEPS single-handed assembly tool

In this instruction manual, the BEYCEPS single-handed assembly tool is referred to as 'product' or 'products'.

Components shown – see image A

1 End locking screw	5 Fine lowering lever	9 Lifting plate with protective cap
2 Rail bar unit	6 Fixed handle	10 Lifting unit
3 Pump lever	7 Base plate	
4 Release lever	8 Protective cap	

Intended use

- The product enables the lifting, spreading and clamping of components within the load limits specified in the technical data.
- The product must not be used for permanent installation.
- The product must not be used to secure cargo during transport.
- The product must not be used to lift people.

Information for safe use

- Read and follow the instruction manual.
 - The specified load limits must not be exceeded.
 - The product may only be used on level and clean surfaces.
 - Wear safety footwear to protect your feet.
 - Wear work or assembly gloves to protect your hands.
 - The handle must always be free of oil and grease to prevent slipping.
 - Do not stand on the pump lever or the lifting plate.
 - However, you may operate the pump lever with your foot or by hand without additional aids for lifting.
 - For spreading and clamping, you may only operate the product manually without any additional aids.
 - Pay attention to the component's centre of gravity when lifting it. If there is an imbalance, use several products and support the component if necessary.
 - The component to be lifted must always be in full contact with the lifting plate on the lifting unit.
 - Always use the product with the end locking screw to prevent the lifting unit from accidentally being moved beyond the end of the rail bar. Only unscrew the end locking screw if you want to turn the lifting unit upside down for the clamping function.
 - Regularly check that the end stop is working properly.
 - Do not work under the lifted component.
 - Do not open the lifting unit.
 - Use the product only in its original condition or with the accessories provided by BESSEY.
 - Use the two protective caps included in the scope of delivery to protect sensitive surfaces.
 - Use only original BESSEY spare parts.
 - Keep the product out of reach of children.
- Small parts must not be swallowed or inserted into body openings.

Preparing

- Always check the product for proper working order and damage before use.
- Check that the base plate is level. If the base plate is visibly bent, you must replace the base plate.
- Check whether the lifting plate is deformed. If there is no longer an angle of 90° to the entire lifting unit, you must replace the lifting plate.
- Check the pump handle, release lever and fine lowering lever for ease of movement.
- Check that all screwed elements are firmly in place.

Lifting – proceed as follows – see image B



Caution

Risk of crushing

- A lifted component can injure parts of your body if it slips.
- Support the lifted component.



Caution

Risk of tipping over

- The product may tip over if the components are unstable or too heavy.
- Do not exceed the specified load limits.
- Check the dimensions and weight of the component.
- Support the lifted component.
- Use several products if necessary.

1. To position: Press the release lever and lower the lifting plate to the height of the base plate. Slide the overlapping plates under the component until the component makes contact with the lifting unit.
2. To lift: Press the pump lever to lift the component.
To secure: Support the component as required.

Lowering – proceed as follows – see image C



Caution

Risk of crushing

- Parts of your body can be injured when the component is lowered.
- To lower the component, only press the fine lowering lever; never the release lever.

Press only the fine lowering lever several times to gradually lower the component to the desired height.

Spreading – proceed as follows – see image D

1. To position: Press the release lever to move the plates together to the approximate gap width between two components. Insert both plates in the gap.
 2. To spread: Press the pump lever to spread the components apart.
- See image E – For particularly narrow gaps, pump the lifting plate down to the base plate. The flattened areas of the plates must be aligned. If you only use this flattened area for spreading, the spreading force is limited to 80 kg.

Clamping – proceed as follows – see image F

To use the clamping function, mount the lifting unit turned 180°.

1. To remove the end locking screw: Remove the end locking screw.
2. To remove the lifting unit: Hold down the release lever and pull the lifting unit off the rail bar unit.
3. To turn the lifting unit upside down: Turn the lifting unit upside down and slide it back onto the rail bar unit. Hold the release lever down while doing so.
4. To fit the end locking screw: Fit the end locking screw.
5. To position: Place the lifting plate against a component.
6. To clamp: Press the pump lever to clamp the lifting unit against the component.

Removing and fitting the protective caps – proceed as follows

See image G – Remove the protective caps for the lifting plate and the base plate by pulling them off the plates.

See image H – Fit the protective caps by sliding them onto the plates until they click into place.

Servicing and maintenance

- Check the product at regular intervals – at least after ten uses – for damage and the proper function of all moving parts.
- A damaged product must no longer be used.
- Protect the product from prolonged exposure to sunlight, water and frost.
- Clean components before and after use.
- If necessary, thoroughly clean the rail bar unit using only additive-free penetrating oil (e.g. WD40®) and a paper towel. Wipe off any excess penetrating oil.

Replacing the base plate – see image

Replace the base plate if it is deformed or damaged. You will need a new base plate and a Torx TX20 screwdriver.

1. Remove the protective cap from the base plate.
2. Remove the three fastening screws (1) on the bottom of the base plate (2).
3. Replace the base plate.
4. Retighten the three fastening screws (4 Nm).

Replacing the lifting plate – see image

Replace the lifting plate if it is deformed or damaged. You will need a new lifting plate and a Torx TX25 screwdriver. Remove the lifting unit from the rail bar unit to access the fastening screw.



1. Remove the end locking screw on the rail bar unit.
2. Hold down the release lever and pull the lifting unit off the rail bar unit.
3. Remove the fastening screw on the rear side of the lifting unit.
4. Replace the lifting plate.
5. Retighten the fastening screw (4 Nm).
6. Slide the lifting unit back onto the rail bar unit. Hold the release lever down while doing so.
7. Refit the end locking screw.

BEYCEPS Installation Kit BEY-IK accessory

Replace the lifting plate if it is deformed or damaged. You will need a new lifting plate and a Torx TX25 screwdriver. Remove the lifting unit from the rail bar unit to access the fastening screw.

Components shown – SEE IMAGE

- 1 Extension adapter 2 Extension rail bar

1. See image  – Remove the protective cap for the lifting plate by pulling it off the plate.
2. See image  – Slide the extension adapter onto the rail bar unit and over the product lifting unit. Make sure that the extension adapter is securely in place. No other fastening is necessary.
3. See image  – If necessary, slide the extension rail bar into the extension adapter. Ensure that the extension rail bar is aligned correctly.

Technical data and load limits

Lifting capacity	Maximum 180 kg With accessory part: maximum 60 kg
Spreading force with full-surface use	Maximum 180 kg
Clamping force with full-surface use	Maximum 180 kg
Clamping force and spreading force when using the flattened 3-millimeter area	Maximum 80 kg
Operating force on pump lever	Maximum 40 kg
Lever height with accessory part	400 mm, 620 mm with second rail bar

Spare parts

Base plate with three fastening screws
Lifting plate with one fastening screw
End locking screw
Protective cap for the base plate
Protective cap for the lifting plate

Disposal

Old products must not be disposed of in normal household waste. Dispose of the product in accordance with applicable local regulations. Check with your local authority to find out how to recycle the individual materials.

Further product information

The following QR code will take you to the product page, where all relevant information is clearly listed:



Use the following QR code to access our spare parts search. If spare parts are available for your product, you can find them there:

