

ROTHENBERGER

ROSCRAPER 75

ROSCRAPER 75



DE Bedienungsanleitung
EN Instructions for use
FR Instruction d'utilisation
ES Instrucciones de uso
IT Istruzioni d'uso
NL Gebruiksaanwijzing
PT Instruções de serviço
DA Brugsanvisning
SV Bruksanvisning
PL Instrukcja obsługi

CS Návod k používání
TR Kullanım kilavuzu
HU Kezelési útmutató
SL Navodilo za uporabo
SK Návod na obsluhu
HR Upute za uporabu
BG Инструкция за експлоатация
LT Naudojimo instrukcija
EL Οδηγίες χρήσεως



rothenberger.com

A Übersicht / Overview

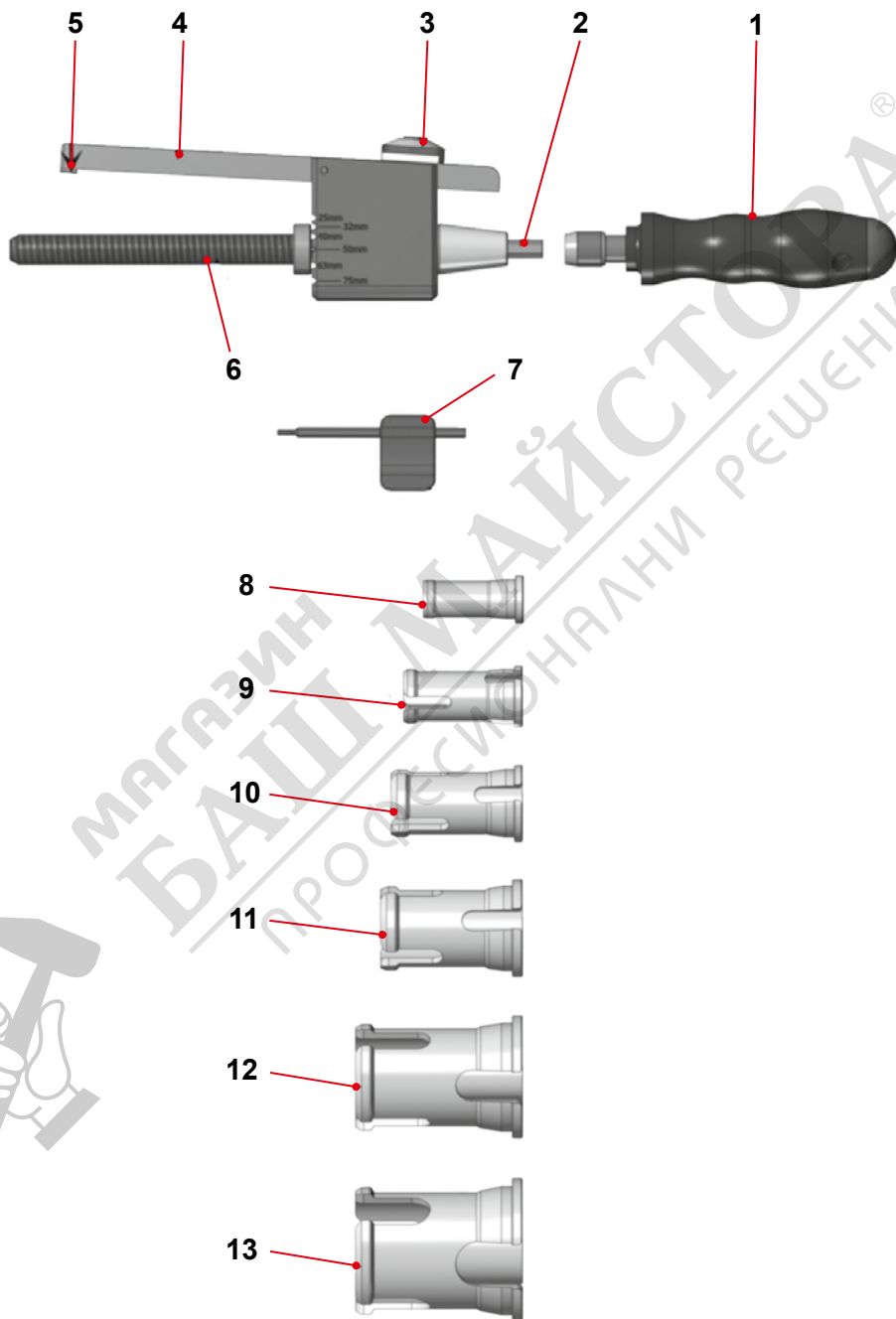

Intro

DEUTSCH - Originalbetriebsanleitung! Bedienungsanleitung bitte lesen und aufbewahren! Nicht wegwerfen! Bei Schäden durch Bedienungsfehler erlischt die Garantie! Technische Änderungen vorbehalten!	Seite 2
ENGLISH Please read and retain these directions for use. Do not throw them away! The warranty does not cover damage caused by incorrect use of the equipment! Subject to technical modifications!	Page 10
FRANÇAIS Lire attentivement le mode d'emploi et le ranger à un endroit sûr! Ne pas le jeter! La garantie est annulée lors de dommages dus à une manipulation erronée! Sous réserve de modifications techniques!	Page 17
ESPAÑOL ¡Por favor, lea y conserve el manual de instrucciones! ¡No lo tire! ¡En caso de daños por errores de uso, la garantía queda sin validez! Modificaciones técnicas reservadas!	Página 25
ITALIANO Per favore leggere e conservare le istruzioni per l'uso! Non gettarle via! In caso di danni dovuti ad errori nell'uso, la garanzia si estingue! Ci si riservano modifiche tecniche!	Pagina 33
NEDERLANDS Lees de handleiding zorgvuldig door en bewaar haar goed! Niet weggooien! Bij schade door bedieningsfouten komt de garantieverlening te vervallen! Technische wijzigingen voorbehouden!	Bladzijde 41
PORTUGUES Queiram ler e guardar o manual de instruções! Não deitar fora! Em caso de avarias por utilização incorrecta, extingue-se a garantia! Reservado o direito de alterações técnicas!	Página 49
DANSK Læs betjeningsvejledningen, og gem den til senere brug! Smid den ikke ud! Skader, som måtte opstå som følge af betjeningsfejl, medfører, at garantien mister sin gyldighed! Ret til tekniske ændringer forbeholdes!	Side 57
SVENSKA Läs igenom bruksanvisningen och förvara den väl! Kasta inte bort den! Garantin upphör om apparaten har använts eller betjänats på ett felaktigt sätt! Med reservation för tekniska ändringar!	Sida 64
POLSKI Instrukcję obsługi proszę przeczytać i zachować! Nie wyrzucać! Przy uszkodzeniach wynikających z błędów obsługi wygasa gwarancja! Zmiany techniczne zastrzeżone!	Strony 71
ČESKY Navod k obsluze si prosím přečtěte a uschovejte jej! Nevyhazujte jej! V případě poškození způsobenem chybou obsluhou zanika záruka! Technické změny jsou vyhrazeny!	Stránky 79
TÜRKÇE Kullanım açıklamalarını lütfen dikkatlice okuyunuz ve bir yerde muhafaza ediniz! Çöpe atmayınız! Kullanımında yapılan hatalar, garantinin silinmesine neden olur! Teknik deðişiklikler yapma hakkımız saklıdır!	Sayfa 87
MAGYAR Kérjük, olvassa el és őrizze meg a kezelési utasítást! Ne dobja el! A helytelen kezelésből származó károsodások esetén megszűnik a jótállás! Műszaki változtatások fenntartva!	Oldaltól 94
SLOVENSKO Preberite navodila za uporabo in jih shranite! Ne odvrzite jih! Ob poškodbah zaradi napak v uporabi preneha veljati garancija! Pridržujemo si pravico do tehničnih sprememb!	Stran 101
SLOVENSKY Prečítajte si prosím návod na obsluhu a uschovejte ho! Návod nezahadzujte! Pri poškodeníach v dôsledku chýb pri obsluhu zaniká záruka! Technické zmeny vyhradené!	Strana 108
HRVATSKI Molimo da pročitate i spremite upute za uporabu! Nemojte ih baciti! Kod kvarova zbog pogrešne uporabe odbacuje se jamstvo! Zadržavamo pravo tehničkih izmjena!	Stranica 115
БЪЛГАРСКИ Прочетете внимателно и запазете инструкцията за експлоатация! Не я захвърляйте или унищожавайте! При настъпили дефекти вследствие на неправилно обслужване гаранцията отпада! Технически изменения по уреда са изключително в компетентията на фирмата производител!	Страница 122
LIETUVOS Perskaitykite naudojimo instrukciją ir pasilikite ją! Neišmeskite! Garantija nebus taikoma gedimams, atsiradusiems dėl netinkamo naudojimo! Pasilikama teisė daryti techninius pakeitimus!	Pusla-pis 130
ΕΛΛΗΝΙΚΑ Οδηγίες χειρισμού παρακαλείσθε να τις διαβάσετε και να τις φυλάσσετε! Μην τις πετάξετε! Σε ζημιές από σφάλματα χειρισμού παύει να ισχύει η εγγύηση! Με επιφύλαξη για τεχνικές αλλαγές!	Σελίδα 137

1	Safety Notes	11
1.1	Intended use	11
1.2	General safety guidelines for tools	11
1.3	Special safety instructions	11
2	Technical Data	12
3	Function of the Unit	12
3.1	Overview (A)	12
4	Peeling	12
4.1	Preparation	12
4.2	Preparation and adjustment.....	13
4.3	Screwing on the mandrels and inserting into pipe end.....	14
4.4	Lowering the peeling arm and connection of the handle	14
4.5	Beginning the peeling procedure	15
4.6	Additional notes	15
5	Changing the peeler blade	16
6	Care and Maintenance	16
7	Accessories	16
8	Customer service	16
9	Disposal	16

Markings in this document:



Danger!

This sign warns against the danger of personal injuries.



Caution!

This sign warns against the danger of property damage and damage to the environment.



Call for action



1 Safety Notes

1.1 Intended use

The Pipe End Peelers are meant exclusively for the removal of the oxide layer on polyethylene pipes as preparation for electrofusion (EF). The peeling tool can be used for pipe end and spigot fittings and outlets. Additionally it is approved for usage on polypropylene (PP) and cross-linked polyethylene (PE-X) pipes.



The product may not be used for any purposes other than those mentioned. Modifying the tool without consulting the manufacturer is forbidden and shall be considered as improper use!

The manufacturer is not liable for the use of the Pipe End Peeler outside of the intended use.

1.2 General safety guidelines for tools

a) Read and make sure you understand all safety guidelines and instructions. Failure to follow the safety guidelines and instructions can lead to electric shock, fire and/or serious injury.

b) Keep these safety guidelines and instructions for future use.

1) Safety in the work area

a) Keep your work area clean and well lit. Working in cluttered or dark areas can easily lead to accidents. Prevent the tool from unintentional movement or dropping and assume a secure foothold.

2) Personal safety

a) Stay alert! Watch what you are doing and use common sense when operating a tool.

b) Use personal protective equipment and always wear eye protection. The use of protective equipment such as a dust mask, non-skid safety shoes, a hard hat or hearing protection, depending on the tool and its use will reduce personal injuries.

c) Wear appropriate clothing. Do not wear loose clothing or jewellery. Keep your hair, clothing and gloves away from moving parts. Loose clothes, jewellery or long hair can get caught by moving parts.

3) Tool usage and care

a) Keep cutting tools sharp and clean. Properly maintained cutting tools with sharp and clean blades do not get stuck as easily and are easier to handle during operation.

b) The blade is subject to wear. Keep the Pipe End Peeler clean and dry in the suitcase.

c) Keep your tools clean. Follow the servicing instructions and the instructions for changing the tools. Keep oil and grease away from the handles.

d) Care for your tools. Check for misalignment or binding of moving parts, breakage of parts and any other condition that may affect the operation of the tools. If damaged, have the tool repaired before use. Many accidents are caused by poorly maintained tools.

e) Use the tool, accessories etc. in accordance with these instructions. Take the working conditions and the work to be performed into account. The use of the tool for applications differing from the application scope could result in a hazardous situation.

f) The thickness of the peeling must be checked with a suitable measuring instrument on a regular basis.

4) Service

a) Have your tool repaired only by a qualified technician with identical replacement parts. This will ensure that the safety of the tool is maintained.

1.3 Special safety instructions

1) Personal safety

a) The operator must have a safe foothold. Working overhead in areas not completely visible (e.g. under a pipe) is prohibited.

b) Pipes and other workpieces must be firmly clamped or fixed. Poorly clamped or fixed workpieces may hurt you or affect your safe foothold.

c) The blade is very sharp. This poses a risk of injury. Do not touch the blade.

2 Technical Data

Code.....	1500004346
For pipe dimensions (mm)	20-75 (SDR11)
Suitable for pipes made of	PE, PE-X, PP
Peeling depth (mm).....	0,2 (0,15 to 0,25)

Dimensions, weights and packaging:

Product dimensions L×W×H (mm).....	400 x 200 x 130
Product weight (kg)	0,5
Packaging dimensions L×W×H (mm).....	330×265×80
Packaging material.....	Plastic
Packaging type.....	Case
Packaging weight (kg).....	0,9
Transport weight (kg)	2,6

Scope of delivery: Instruction manual, Base frame, Mandrel 20/ 25/ 32/ 40/ 50/ 63/ 75mm, 1x spare cutting blade, hexagon socket wrench 1 mm, ROCASE 4212 with foam insert.

3 Function of the Unit

3.1 Overview

(A)

Pos.	Description	Code
1	Bit holder with handle	1500004483
2	Drive bit	1500004484
3	Knurled locking disc	1500004486
4	Scraper arm	1500004489
5	Peeler blade incl. screw	1500004490
6	Spindle	1500004491
7	Torx key M8 ROSCRAPER 75	1500004492
-	Mandrel 20 mm ROSCRAPER 75	1500004493
8	Mandrel 25 mm ROSCRAPER 75	1500004494
9	Mandrel 32 mm ROSCRAPER 75	1500004495
10	Mandrel 40 mm ROSCRAPER 75	1500004496
11	Mandrel 50 mm ROSCRAPER 75	1500004497
12	Mandrel 63 mm ROSCRAPER 75	1500004498
13	Mandrel 75 mm ROSCRAPER 75	1500004499

4 Peeling

The following description of the peeling process with the Pipe End Peeler is exemplary for all variants of the products. But in any use-case the correct mandrel must be used and the peeling tool must be adjusted to the correct pipe dimension.

4.1 Preparation

Cleaning the pipe:

→ Use a clean cloth free of dirt and grease to remove mud from the surface you want to peel. If necessary additionally use certified pipe cleaner.

Mark the area you want to peel:

→ Mark the insertion depth of the fitting according to the processing guidelines of the fitting manufacturer with a certified marker. The area to be peeled should be marked with wave-like markings.

Bring the peeling arm in the upper position:

- ➔ Should the scraper arm not be in the upper position it must be brought up. Press on the short end of the scraper arm and turn the knurled locking disc, so that it holds the scraper arm in its upper position.

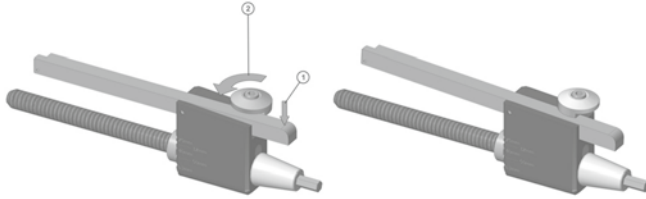

4.2 Preparation and adjustment

The Pipe End Peeler must be adjusted to the pipe dimension prior to use.

Checking the current setting:

- ➔ Check if the current setting is the correct one for the pipe resp. fitting to be scraped.

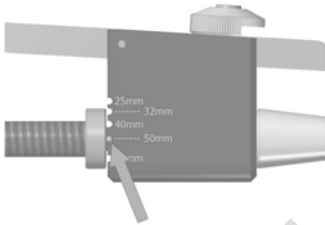

If the current setting is not correct, it must be adjusted.

Adjusting the setting: Loosen the Spindle:

- ➔ Install the handle on the bit and turn it counterclockwise to loosen the spindle and to change the adjustment.

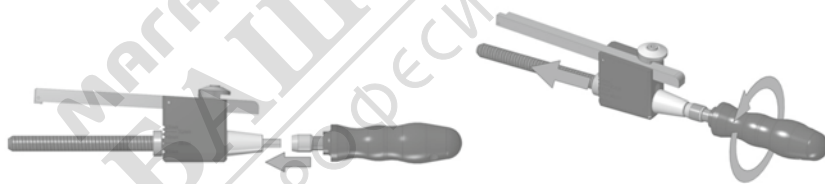

Adjusting the setting: Move the spindle:

- ➔ Move the spindle to the correct dimensional setting.

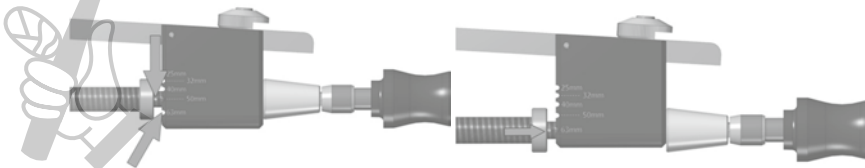

Adjusting the setting: Tighten the spindle:

- ➔ Move the stud to the recess and screw the spindle tight again.

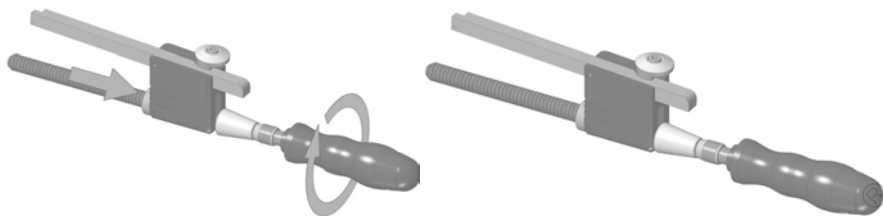

→ Then remove the handle.

4.3 Screwing on the mandrels and inserting into pipe end

Screwing on the mandrels:

→ Use the correct mandrel for the pipe size and screw it onto the spindle approximately to the shown position.

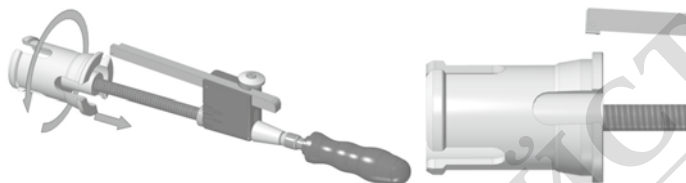

Inserting the mandrel into the pipe end:

→ Insert the Pipe end Scraper with the mandrel into the pipe until the pipe face hits the stop on the mandrel. Then turn the body of the scraper tool clockwise or counterclockwise until the scraper blade reaches the position that is shown in the picture.

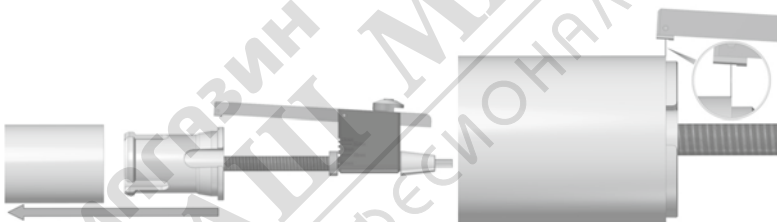

! The peeling procedure begins at the pipe end and continues in a clockwise direction away from the pipe end!

4.4 Lowering the peeling arm and connection of the handle

→ Press on the short end of the scraper arm and turn the knurled locking disc, so that it does not hold the scraper arm in its upper position anymore. Carefully lower the scraper blade so that it does not abruptly hit the pipe surface.

→ Then connect the handle to the bit.

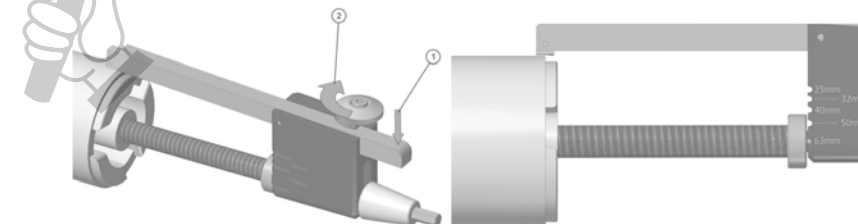

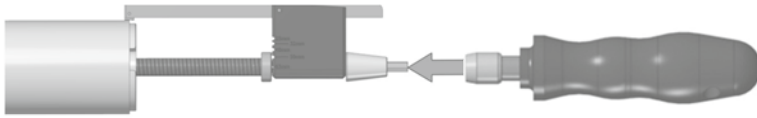

- !** Attention: The scraper blade must rest on the pipe end in such a way that during the first rotation no section of the pipe end remains unscraped. It is helpful to position the scraper blade in such a way that it rests with its dull section on the pipe edge. This ensures that the whole pipe end will be scraped successfully.

Carefully lower the scraper blade so that it does not abruptly hit the pipe surface!

4.5 Beginning the peeling procedure



Slow and continuous peeling will deliver better results. If the peeling is carried out too quickly, the pipe surface may not be sufficiently peeled!

Clamping and fixing the pipe:

- Fix or clamp the pipe before you begin peeling it to improve the peeling result and prevent accidents.
- The peeling procedure must be done in a clockwise direction.

Beginning the peeling procedure:

- Begin the peeling procedure slowly at first and watch the result.

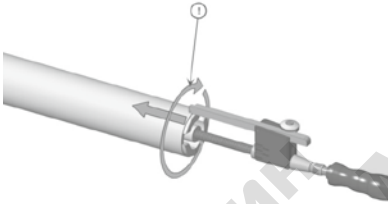

- Continue to peel until you have reached the end of the marked pipe section.

Bringing the peeling arm in the upper position and removing the tool from the pipe:

- Bring the scraper arm in the upper position and pull the tool from the pipe.

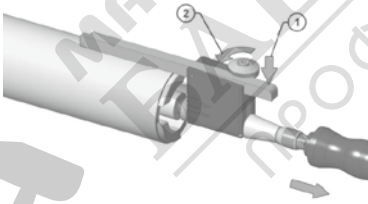

- !** Note: After removing the tool from the pipe always make sure that you have completely peeled the desired area!

4.6 Additional notes

In case of an insufficient peeling result the blade has to be replaced.

In consideration of the processing guidelines of the fitting manufacturer and the tolerances specified therein (max. gap between pipe and fitting) the pipe may be peeled a second time.

The peeler blades are subject to wear.

Use only on cleaned pipe surfaces.

Keep the Pipe End Peeler clean and dry in the suitcase!

The thickness of the peeling must be checked with a suitable measuring instrument on a regular basis.

5 Changing the peeler blade



Attention! The blade is very sharp! Handling the spare blades involves a high risk of injury. Always wear cut-proof gloves as soon as you handle the peeling blades!

Loosening the screw and taking off the peeling blade.

- Loosen and take out the hexagon socket head screw (Torx), that holds the blade in place, using the supplied key, then turn the blade 180 degrees (reversible blade).

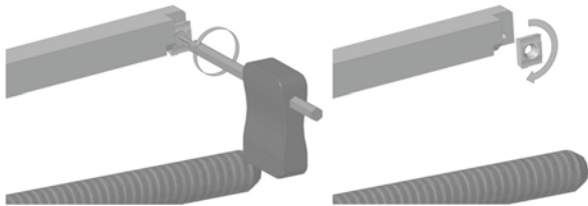

Installing the peeling blade

- Make sure that the scraper blade rests flat on the surface and that it touches the stop on the side of the scraper arm before screwing it tight.

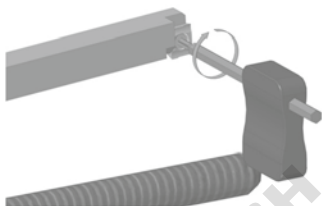

Only genuine spare blades from ROTHENBERGER Werkzeuge GmbH are compatible with the tool!

6 Care and Maintenance

To achieve an optimum work results the tool has to be handled with care and maintained frequently. Pollution has to be avoided or, if necessary, removed with a soft cloth or a Q-tip.

7 Accessories

You can find suitable accessories in the main catalog or at www.rothenberger.com

8 Customer service

The ROTHENBERGER service locations are available to help you (see listing in catalog or online) and replacement parts and service are also available through these same service locations. Order your accessories and spare parts from your specialist retailer or using RO SERVICE+ online: ☎ + 49 (0) 61 95/ 800 8200 📠 + 49 (0) 61 95/ 800 7491 ✉ service@rothenberger.com - www.rothenberger.com

9 Disposal

Components of the unit are recyclable material and should be put to recycling. For this purpose registered and certified recycling companies are available. For an environmental friendly disposal of the non-recyclable parts (e.g. electronic waste) please contact your local waste disposal authority.

www.rothenberger.com