

# ROTHENBERGER

## RODIADRILL 1800 DRY

RODIADRILL 1800 DRY



DE Bedienungsanleitung  
EN Instructions for use  
FR Instruction d'utilisation  
ES Instrucciones de uso  
IT Istruzioni d'uso  
NL Gebruiksaanwijzing  
PT Instruções de serviço  
DA Brugsanvisning  
SV Bruksanvisning

NO Bruksanvisning  
FI Käyttöohje  
PL Instrukcja obsługi  
CS Návod k používání  
TR Kullanım kılavuzu  
HU Kezelési útmutató  
EL Οδηγίες χρήσεως  
RU Инструкция по использованию



[www.rothenberger.com](http://www.rothenberger.com)

# Overview

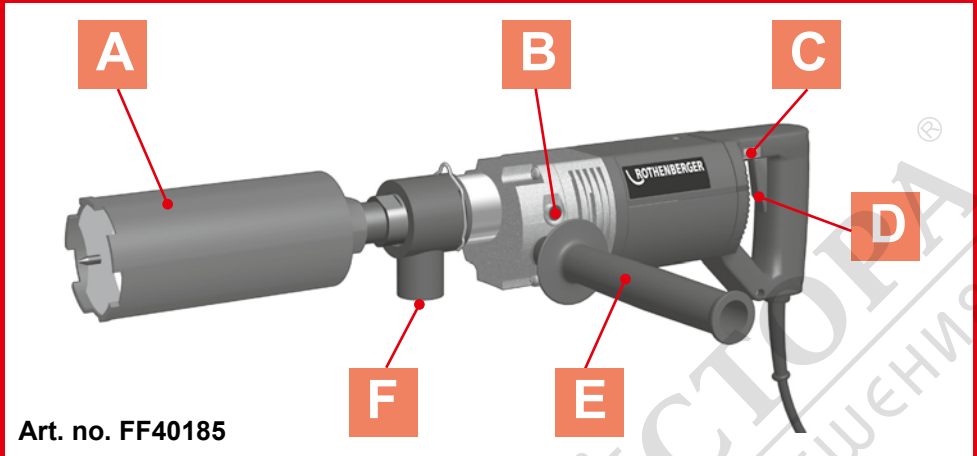

## A Fitting the drill bit

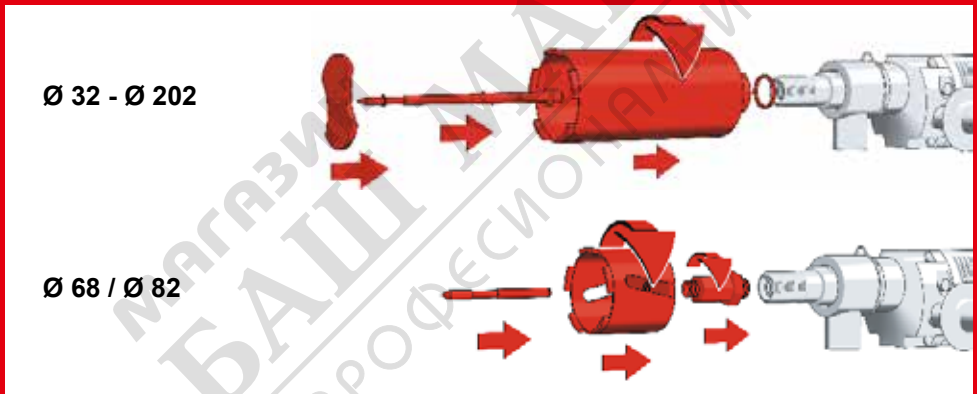

## B Power Puls change over

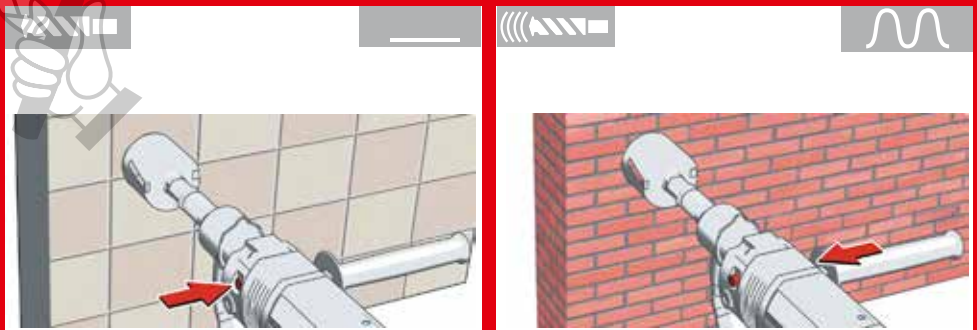

## Overload protection C

green

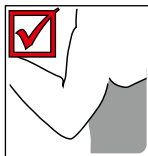

red

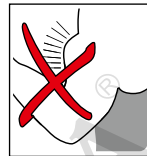

## Switching ON / OFF D

START



STOP

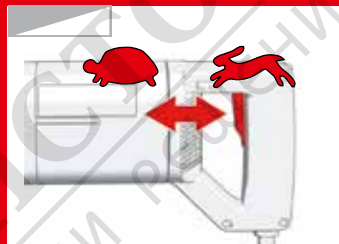

## Handle attachment E

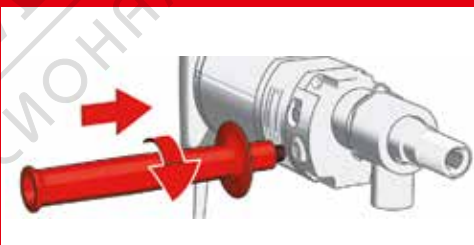
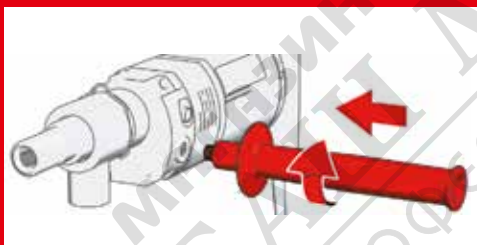

## Dust extraction F

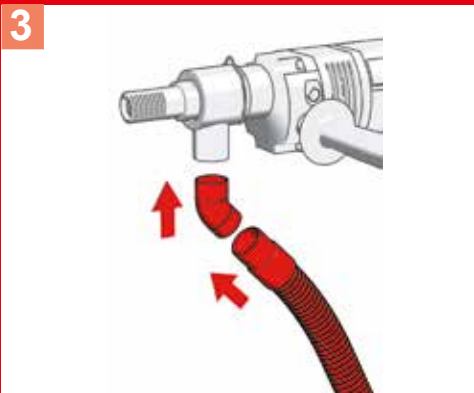

# G Operating Instructions

1

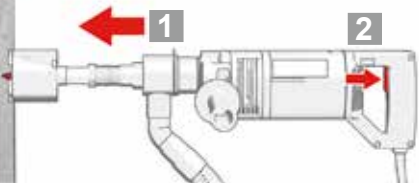

2



3

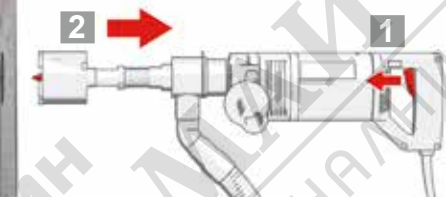

4

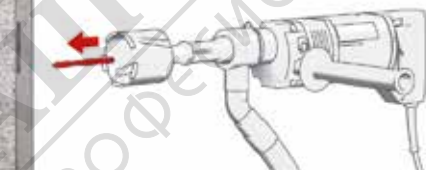

5

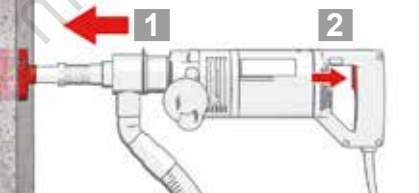

6

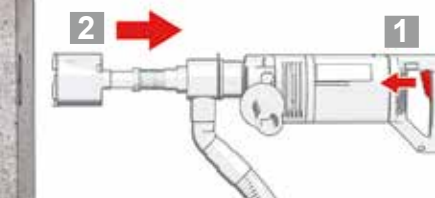

# Intro

<b>DEUTSCH - Originalbetriebsanleitung!</b> Bedienungsanleitung bitte lesen und aufbewahren! Nicht wegwerfen! Bei Schäden durch Bedienungsfehler erlischt die Garantie! Technische Änderungen vorbehalten!	<b>Seite 2</b>
<b>ENGLISH</b> Please read and retain these directions for use. Do not throw them away! The warranty does not cover damage caused by incorrect use of the equipment! Subject to technical modifications!	<b>page 9</b>
<b>FRANÇAIS</b> Lire attentivement le mode d'emploi et le ranger à un endroit sûr! Ne pas le jeter! La garantie est annulée lors de dommages dus à une manipulation erronée! Sous réserve de modifications techniques!	<b>page 15</b>
<b>ESPAÑOL</b> ¡Por favor, lea y conserve el manual de instrucciones! ¡No lo tire! ¡En caso de daños por errores de manejo, la garantía queda sin validez! Modificaciones técnicas reservadas!	<b>página 22</b>
<b>ITALIANO</b> Per favore leggere e conservare le istruzioni per l'uso! Non gettarle via! In caso di danni dovuti ad errori nell'uso, la garanzia si estingue! Ci si riservano modifiche tecniche!	<b>Pagina 29</b>
<b>NEDERLANDS</b> Lees de handleiding zorgvuldig door en bewaar haar goed! Niet weggooien! Bij schade door bedieningsfouten komt de garantieverlening te vervallen! Technische wijzigingen voorbehouden!	<b>bladzijde 36</b>
<b>PORTUGUES</b> Queiram ler e guardar o manual de instruções! Não deitar fora! Em caso de avarias por utilização incorrecta, extingue-se a garantia! Reservado o direito de alterações técnicas!	<b>pagina 43</b>
<b>DANSK</b> Læs betjeningsvejledningen, og gem den til senere brug! Smid den ikke ud! Skader, som måtte opstå som følge af betjeningsfejl, medfører, at garantien mister sin gyldighed! Ret til tekniske ændringer forbeholdes!	<b>side 50</b>
<b>SVENSKA</b> Läs igenom bruksanvisningen och förvara den väl! Kasta inte bort den! Garantin upphör om apparaten har använts eller betjänats på ett felaktigt sätt! Med reservation för tekniska ändringar!	<b>sida 57</b>
<b>NORSK</b> Les bruksanvisningen og oppbevar den vel! Ikke kast den! Oppstår skader på grunn av betjeningsfeil opphører garantiens gyldighet! Tekniske forandringer forbeholdes!	<b>side 63</b>
<b>SUOMI</b> Lue ja säilytä tämä käyttöohje! Älä heitä pois! Takuu ei kata käyttövirheistä aiheutuvia vahinkoja! Oikeudet teknisiin muutoksiin pidätetään!	<b>sivulta 69</b>
<b>POLSKI</b> Instrukcję obsługi proszę przeczytać i przechować! Nie wyrzucac! Przy uszkodzeniach wynikających z błędów obsługi wygasa gwarancja! Zmiany techniczne zastrzeżone!	<b>strony 76</b>
<b>ČESKY</b> Navod k obsluze si prosím přečtěte a uschovejte je! Nevyhazujte je! V případě poškození způsobenem chybnou obsluhou zanika záruka! Technické změny jsou vyhrazeny!	<b>Stránky 83</b>
<b>TÜRKÇE</b> Kullanım açıklmalarını lütfen dikkatlice okuyunuz ve bir yerde muhafaza ediniz! Çöpe atmayınız! Kullanımında yapılan hatalar, garantinin silinmesine neden olur! Teknik deöiöiklikler yapma hakkımız saklıdır!	<b>sayfa 90</b>
<b>MAGYAR</b> Kérjük, olvassa el és őrizze meg a kezelési utasítást! Ne dobja el! A helytelen kezelésből származó károsodások esetén megszűnik a jótállás! Műszaki változtatások fenntartva!	<b>oldaltól 97</b>
<b>ΕΛΛΗΝΙΚΑ</b> Οδηγίες χειρισμού παρακαλείσθε να τις διαβάσετε και να τις φυλάσσετε! Μην τις πετάξετε! Σε ζημιές από σφάλματα χειρισμού παύει να ισχύει η εγγύηση! Με επιφύλαξη για τεχνικές αλλαγές!	<b>Σελίδα 104</b>
<b>РУССКИЙ</b> Прочтите инструкцию по эксплуатации и сохраняйте её для дальнейшего использования! В случае поломки инструмента из-за несоблюдения инструкции клиент теряет право на обслуживание по гарантии! Возможны технические изменения!	<b>Страница 111</b>

<b>1</b>	<b>Safety Notes</b> .....	<b>10</b>
1.1	Intended use .....	10
1.2	General Power Tool Safety Warnings .....	10
1.3	Special Safety Instructions .....	11
<b>2</b>	<b>Technical Data</b> .....	<b>12</b>
<b>3</b>	<b>Electric supply</b> .....	<b>12</b>
<b>4</b>	<b>Function of the Unit</b> .....	<b>12</b>
4.1	Fitting the drill bit (A) .....	12
4.2	Power Puls changeover (B) .....	13
4.3	Overload protection (C) .....	13
4.4	Switching On / Off (D) .....	13
4.5	Handle attachment (E) .....	13
4.6	Dust extraction (F) .....	13
4.7	Operating instructions (G) .....	13
<b>5</b>	<b>Accessories</b> .....	<b>14</b>
<b>6</b>	<b>Customer service</b> .....	<b>14</b>
<b>7</b>	<b>Disposal</b> .....	<b>14</b>

**Markings in this document:**



**Danger!**

This sign warns against the danger of personal injuries.



**Caution!**

This sign warns against the danger of property damage and damage to the environment.



**Call for action**



## 1.1 Intended use

The diamond core drill can be used for dry drilling using diamond core bits in brick, masonry, bricks with holes, sand-lime brick and cellular concrete (not stone and concrete).

The machine is not suitable for wet drilling.

Do not use this product in any other way as stated for normal use. It may only be used when guided by two hands or when mounted on a diamond drill stand.

## 1.2 General Power Tool Safety Warnings



### WARNING!

**Read all safety warnings and all instructions.**

Failure to follow the warnings and instructions may result in electric shock, fire and/or serious injury.

**Save all warnings and instructions for future reference.**

The term "power tool" in the warnings refers to your mains-operated (corded) power tool or battery-operated (cordless) power tool.

### 1) Work area safety

- a) **Keep work area clean and well lit.** Cluttered and dark areas invite accidents.
- b) **Do not operate power tools in explosive atmospheres, such as in the presence of flammable liquids, gases or dust.** Power tools create sparks which may ignite the dust or fumes.
- c) **Keep children and bystanders away while operating a power tool.** Distractions can cause you to lose control.

### 2) Electrical safety

- a) **Power tool plugs must match the outlet. Never modify the plug in any way. Do not use any adapter plugs with earthed (grounded) power tools.** Unmodified plugs and matching outlets will reduce risk of electric shock.
- b) **Avoid body contact with earthed or grounded surfaces such as pipes, radiators, ranges and refrigerators.** There is an increased risk of electric shock if your body is earthed or grounded.
- c) **Do not expose power tools to rain or wet conditions.** Water entering a power tool will increase the risk of electric shock.
- d) **Do not abuse the cord. Never use the cord for carrying, pulling or unplugging the power tool. Keep cord away from heat, oil, sharp edges or moving parts.** Damaged or entangled cords increase the risk of electric shock.
- e) **When operating a power tool outdoors, use an extension cord suitable for outdoor use.** Use of a cord suitable for outdoor use reduces the risk of electric shock.
- f) **If operating a power tool in a damp location is unavoidable, use a residual current device (RCD) protected supply.** Use of an RCD reduces the risk of electric shock.

### 3) Personal safety

- a) **Stay alert, watch what you are doing and use common sense when operating a power tool. Do not use a power tool while you are tired or under the influence of drugs, alcohol or medication.** A moment of inattention while operating power tools may result in serious personal injury.
- b) **Use personal protective equipment. Always wear eye protection.** Protective equipment such as dust mask, non-skid safety shoes, hard hat, or hearing protection used for appropriate conditions will reduce personal injuries.
- c) **Prevent unintentional starting. Ensure the switch is in the off-position before connecting to power source and/or battery pack, picking up or carrying the tool.** Carrying power tools with your finger on the switch or energising power tools that have the switch on invites accidents.

- d) **Remove any adjusting key or wrench before turning the power tool on.** A wrench or a key left attached to a rotating part of the power tool may result in personal injury.
  - e) **Do not overreach. Keep proper footing and balance at all times.** This enables better control of the power tool in unexpected situations.
  - f) **Dress properly. Do not wear loose clothing or jewellery. Keep your hair, clothing and gloves away from moving parts.** Loose clothes, jewellery or long hair can be caught in moving parts.
  - g) **If devices are provided for the connection of dust extraction and collection facilities, ensure these are connected and properly used.** Use of these devices can reduce dust related hazards.
- 4) Power tool use and care**
- a) **Do not force the power tool. Use the correct power tool for your application.** The correct power tool will do the job better and safer at the rate for which it was designed.
  - b) **Do not use the power tool if the switch does not turn it on and off.** Any power tool that cannot be controlled with the switch is dangerous and must be repaired.
  - c) **Disconnect the plug from the power source and/or the battery pack from the power tool before making any adjustments, changing accessories, or storing power tools.** Such preventive safety measures reduce the risk of starting the power tool accidentally.
  - d) **Store idle power tools out of the reach of children and do not allow persons unfamiliar with the power tool or these instructions to operate the power tool.** Power tools are dangerous in the hands of untrained users.
  - e) **Maintain power tools. Check for misalignment or binding of moving parts, breakage of parts and any other condition that may affect the power tools operation. If damaged, have the power tool repaired before use.** Many accidents are caused by poorly maintained power tools.
  - f) **Keep cutting tools sharp and clean.** Properly maintained cutting tools with sharp cutting edges are less likely to bind and are easier to control.
  - g) **Use the power tool, accessories and tool bits etc., in accordance with these instructions, taking into account the working conditions and the work to be performed.** Use of the power tool for operations different from those intended could result in a hazardous situation.
- 5) Service**
- Have your power tool serviced by a qualified repair person using only identical replacement parts.** This will ensure that the safety of the power tool is maintained.

### 1.3 Special Safety instructions

Wear ear protectors. Exposure to noise can cause hearing loss.

Use auxiliary handles supplied with the tool. Always keep it dry, clean and free of oil and grease.

Loss of control can cause personal injury.

Appliances used at many different locations including open air must be connected via a current surge preventing switch.

Always wear goggles when using the machine. It is recommended to wear gloves, sturdy non slipping shoes and apron.

Sawdust and splinters must not be removed while the machine is running.

The dust that arises when working with this tool can be detrimental to health and therefore not reach the body. Wear a suitable dust protection mask.

Always disconnect the plug from the socket before carrying out any work on the machine.

Only plug-in when machine is switched off.

Keep mains lead clear from working range of the machine. Always lead the cable away behind you.

When working in walls ceiling, or floor, take care to avoid electric cables and gas or water pipes.

Do not touch a damaged or severed power supply cord when working; pull the plug out of the power socket immediately instead. Never operate the device with a damaged power supply cord.

Before beginning your work consult the responsible structural designer to establish the exact position of the hole to be drilled.

When drilling through a ceiling secure the area from below because the diamond core bit can fall out.

## 2 Technical Data

Nominal power output .....	1800 W
No-load speed .....	1700 min <sup>-1</sup>
Speed under load .....	1150 min <sup>-1</sup>
Oscillation .....	23000 min <sup>-1</sup>
Drilling capacity in concrete .....	32 – 202 mm
Tool reception .....	1.1/4" UNC + G 1/2"
Weight without cable .....	5,8 kg
Protection class .....	II
Type of protection .....	IP 20
Method of operation .....	S3
Operator safety coupling .....	yes, electronic limit
Noise pressure level (L <sub>pA</sub> ) .....	92 dB (A)   K <sub>pA</sub> 3 dB (A)
Sound power level (L <sub>WA</sub> ) .....	103 dB (A)   K <sub>WA</sub> 3 dB (A)
The noise level during operation can exceed 85 dB (A). Wear hearing protection!	
Measured values determined in accordance with EN 60745-1:2010.	
Vibration total value .....	5,5 m/s <sup>2</sup>   K= 1,5m/s <sup>2</sup>

The vibration level given in this information sheet has been measured in accordance with a standardised test given in EN 60745 and may be used to compare one tool with another. It may be used for a preliminary assessment of exposure.



The declared vibration emission level represents the main applications of the tool. However if the tool is used for different applications, with different accessories or insertion tools or is poorly maintained, the vibration emission may differ. This may significantly increase the exposure level over the total working period.

An estimation of the level of exposure to vibration should also take into account the times when the tool is switched off or when it is running but not actually doing the job. This may significantly reduce the exposure level over the total working period.

Identify additional safety measures to protect the operator from the effects of vibration such as: maintain the tool and the accessories, keep the hands warm, organisation of work patterns.

## 3 Electric supply

Connect only to single-phase a.c. current and only to the system voltage indicated on the rating plate.

It is also possible to connect to sockets without an earthing contact as the design conforms to safety class II.

## 4 Function of the Unit

### 4.1 Fitting the drill bit

(A)

Ø 32 - 202 mm (Hollow drill core bits):

→ Screw the drill core bit in position.

- Insert the centralizing mandrel.
- Slide the centralizing disc into position.
- Ø 68 mm / Ø 82 mm (Recess cutter):**
- Screw the adapter (No. FF35097) into position.
- Screw the recess cutter into position.
- Insert the centralizing mandrel (No. FF35096).

To dismantle, use the open-ended spanner to unscrew the drill bits.

#### 4.2 Power Puls changeover

(B)

For hard rock, changeover to soft hammer action.

Do not use the hammer action at the start of drilling and for brittle stone (e.g. tiles).

#### 4.3 Overload protection

(C)

The green warning lamp is on during normal operation.

If too much pressure is exerted on the drill bit the red warning lamp will come on. Reduce the pressure and the green lamp will come on again.

In the event of continuous overloading, the electronic system of the machine will switch the machine off. To continue working, switch the machine off and then on again.

In the case of jerking overload (e.g. drill bit catches) the electronically controlled slipping clutch will interrupt the power supply.

#### 4.4 Switching On / Off

(D)

Switch the machine on or off at the switch button.

The speed can be altered at the switch button.

#### 4.5 Handle attachment

(E)

The handle attachment can be fitted on the left or right side.



Extensive torque is created when drilling with core drills; never work without the handle attachment!

#### 4.6 Dust extraction

(F)



Always work with dust extraction switched on. The machine is fitted with an efficient dust extraction system. We recommend the ROTHENBERGER RODIA DRY CLEANER 1200 extractor.

- 1 Slide the extractor adapter on to the spindle.
- 2 Secure the extractor adapter with springs.
- 3 Plug in the hose adapter and extractor hose.

#### 4.7 Operating instructions

(G)

Depending on the material, select either POWER PULS on or off at the hammer action switch.

- 1 Position the machine with the centralizing mandrel and switch on.
- 2 Drill approx. 2 cm using the centralizing mandrel.
- 3 Switch the machine off and pull it out of the drilled hole.
- 4 Remove the centralizing mandrel.
- 5 Insert the core drill into the already cut groove, switch the machine on and drill down to the required depth.

Pull the machine back slightly from time to time to remove any dust.

- 6 Switch the machine off and pull it out of the drilled hole. Remove the drilling core.

Bore-holes which don't have to be applied exactly can be drilled without a centre bit. For that purpose apply the core cutter slantingly and put the machine slowly straight when a depth of about 1 cm has been reached.

If drill cores should come loose, take core cutter from the material and remove drill cores.

## 5 Accessories

Accessory Name	ROTHENBERGER Part Number
Transport case RODIADRILL	FF60185
Centering Pin for extraction rotor, 300 mm	FF03300
Centering Pin for extraction rotor, 400 mm	FF03301
Centering tip "Quick-Out" ICW. FF35097	FF35096
Adaptor for RODIADRILL 1800 DWS/DRY	FF35097
Socket drill bit $\varnothing$ 68 mm / $\varnothing$ 82 mm	FF03168 / FF03182
RODIA DRY CLEANER 1200	FF35148
RODIA CLEANER 1400	FF35210
Copper Ring 1.1/4"	FF35190
Sharpening stick (285 x 152 x 40 mm)	FF35135
<u>Extensions G 1/2":</u>	
Nominal length 100 mm	FF35040
Nominal length 200 mm	FF35045
Nominal length 300 mm	FF35050
Nominal length 500 mm	FF35055
<u>Extensions 1.1/4" UNC:</u>	
Nominal length 100 mm	FF35060
Nominal length 200 mm	FF35065
Nominal length 300 mm	FF35070
Nominal length 500 mm	FF35075

## 6 Customer service

The ROTHENBERGER service locations are available to help you (see listing in catalog or on-line) and replacement parts and service are also available through these same service locations. Order your accessories and spare parts from your specialist retailer or using our service-after-sales hotline:

**Phone:** + 49 (0) 61 95 / 800 – 8200

**Fax:** + 49 (0) 61 95 / 800 – 7491

**Email:** [service@rothenberger.com](mailto:service@rothenberger.com)

[www.rothenberger.com](http://www.rothenberger.com)

## 7 Disposal

Components of the unit are recyclable material and should be put to recycling. For this purpose registered and certified recycling companies are available. For an environmental friendly disposal of the non-recyclable parts (e.g. electronic waste) please contact your local waste disposal authority.

### For EU countries only:



Do not dispose electric tools with domestic waste. In accordance with the European Directive 2012/19/EC the disposal of electrical and electronic equipment and its implementation as national law, electric tools that are no longer serviceable must be collected separately and utilised for environmentally compatible recycling.