

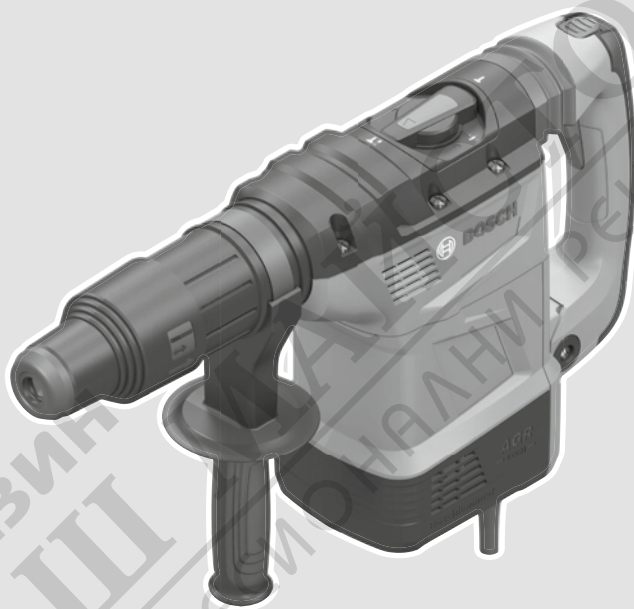

GBH 6-42 C Professional

HEAVY
DUTY



- en Original instructions
- fr Notice originale
- pt Manual original
- zh 正本使用说明书
- zh 原始使用說明書
- th หนังสือคู่มือการใช้งานแบบ
ต้นแบบ
- id Petunjuk-Petunjuk untuk
Penggunaan Orisinal
- vi Bản gốc hướng dẫn sử dụng
- ar دليل التشغيل الأصلي
- fa دفترچه راهنمای اصلی



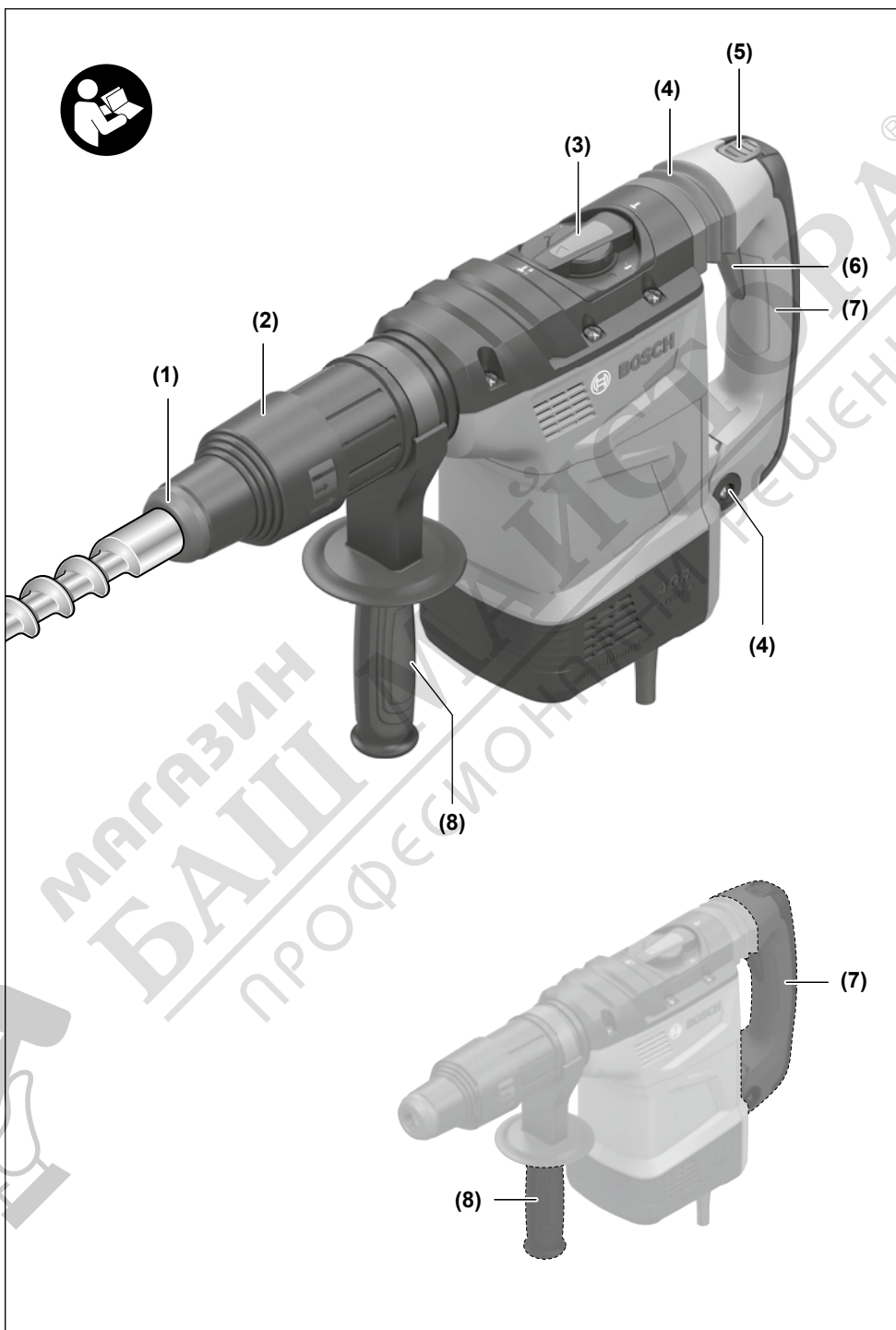



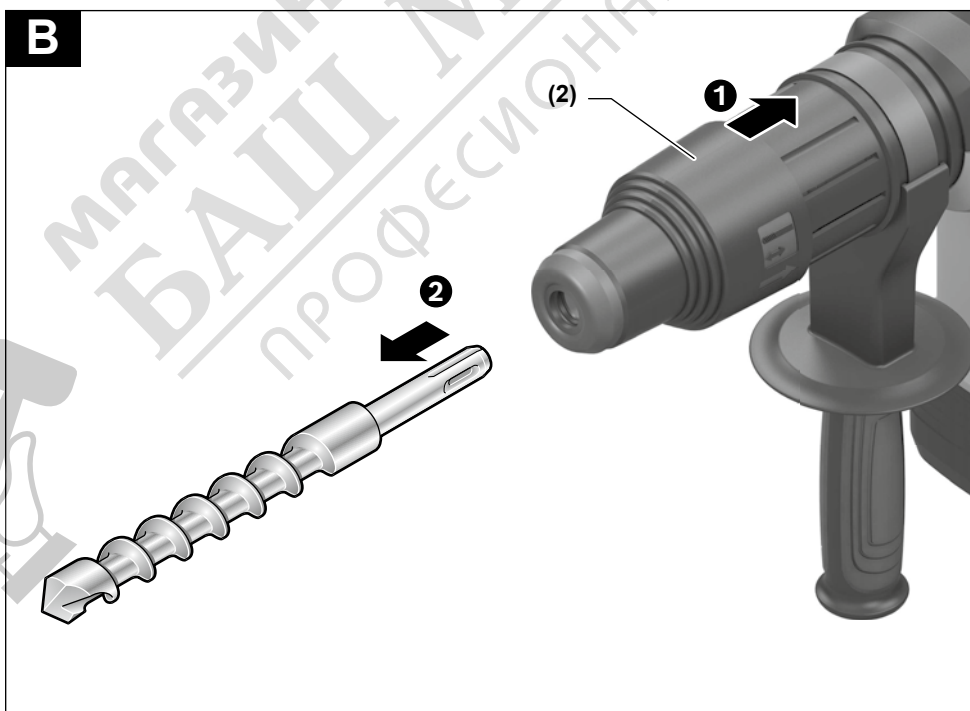
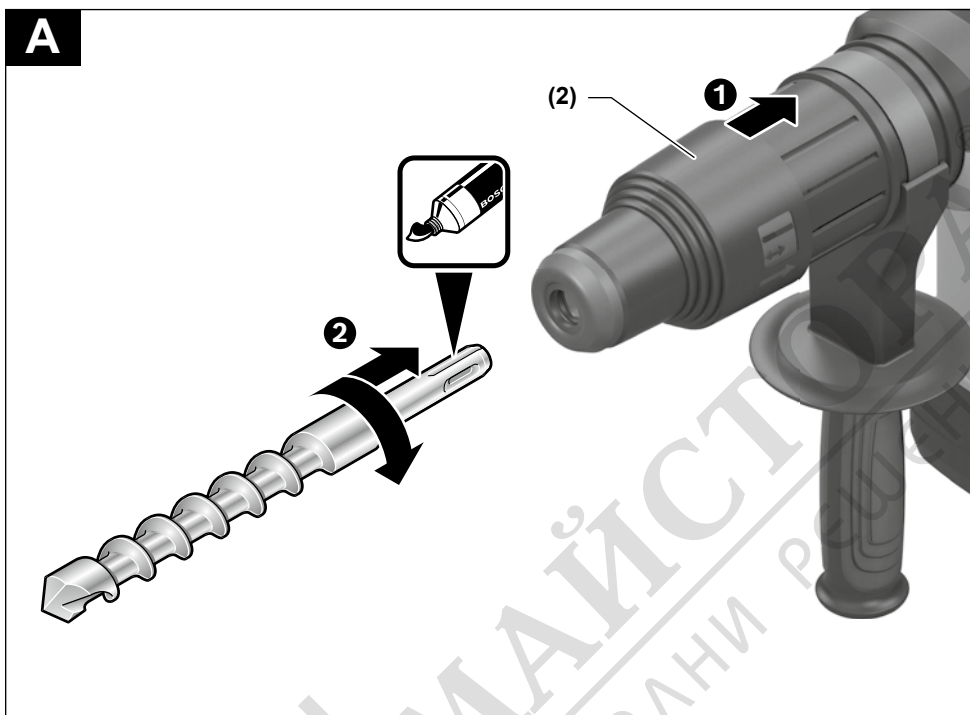

English

Safety instructions

General Power Tool Safety Warnings

⚠ WARNING Read all safety warnings, instructions, illustrations and specifications provided with this power tool. Failure to follow all instructions listed below may result in electric shock, fire and/or serious injury.

Save all warnings and instructions for future reference.

The term "power tool" in the warnings refers to your mains-operated (corded) power tool or battery-operated (cordless) power tool.

Work area safety

- ▶ **Keep work area clean and well lit.** Cluttered or dark areas invite accidents.
- ▶ **Do not operate power tools in explosive atmospheres, such as in the presence of flammable liquids, gases or dust.** Power tools create sparks which may ignite the dust or fumes.
- ▶ **Keep children and bystanders away while operating a power tool.** Distractions can cause you to lose control.

Electrical safety

- ▶ **Power tool plugs must match the outlet. Never modify the plug in any way. Do not use any adapter plugs with earthed (grounded) power tools.** Unmodified plugs and matching outlets will reduce risk of electric shock.
- ▶ **Avoid body contact with earthed or grounded surfaces, such as pipes, radiators, ranges and refrigerators.** There is an increased risk of electric shock if your body is earthed or grounded.
- ▶ **Do not expose power tools to rain or wet conditions.** Water entering a power tool will increase the risk of electric shock.
- ▶ **Do not abuse the cord. Never use the cord for carrying, pulling or unplugging the power tool. Keep cord away from heat, oil, sharp edges or moving parts.** Damaged or entangled cords increase the risk of electric shock.
- ▶ **When operating a power tool outdoors, use an extension cord suitable for outdoor use.** Use of a cord suitable for outdoor use reduces the risk of electric shock.
- ▶ **If operating a power tool in a damp location is unavoidable, use a residual current device (RCD) protected supply.** Use of an RCD reduces the risk of electric shock.

Personal safety

- ▶ **Stay alert, watch what you are doing and use common sense when operating a power tool. Do not use a power tool while you are tired or under the influence of drugs, alcohol or medication.** A moment of inatten-

tion while operating power tools may result in serious personal injury.

- ▶ **Use personal protective equipment. Always wear eye protection.** Protective equipment such as a dust mask, non-skid safety shoes, hard hat or hearing protection used for appropriate conditions will reduce personal injuries.
- ▶ **Prevent unintentional starting. Ensure the switch is in the off-position before connecting to power source and/or battery pack, picking up or carrying the tool.** Carrying power tools with your finger on the switch or energising power tools that have the switch on invites accidents.
- ▶ **Remove any adjusting key or wrench before turning the power tool on.** A wrench or a key left attached to a rotating part of the power tool may result in personal injury.
- ▶ **Do not overreach. Keep proper footing and balance at all times.** This enables better control of the power tool in unexpected situations.
- ▶ **Dress properly. Do not wear loose clothing or jewellery. Keep your hair and clothing away from moving parts.** Loose clothes, jewellery or long hair can be caught in moving parts.
- ▶ **If devices are provided for the connection of dust extraction and collection facilities, ensure these are connected and properly used.** Use of dust collection can reduce dust-related hazards.
- ▶ **Do not let familiarity gained from frequent use of tools allow you to become complacent and ignore tool safety principles.** A careless action can cause severe injury within a fraction of a second.

Power tool use and care

- ▶ **Do not force the power tool. Use the correct power tool for your application.** The correct power tool will do the job better and safer at the rate for which it was designed.
- ▶ **Do not use the power tool if the switch does not turn it on and off.** Any power tool that cannot be controlled with the switch is dangerous and must be repaired.
- ▶ **Disconnect the plug from the power source and/or remove the battery pack, if detachable, from the power tool before making any adjustments, changing accessories, or storing power tools.** Such preventive safety measures reduce the risk of starting the power tool accidentally.
- ▶ **Store idle power tools out of the reach of children and do not allow persons unfamiliar with the power tool or these instructions to operate the power tool.** Power tools are dangerous in the hands of untrained users.
- ▶ **Maintain power tools and accessories. Check for misalignment or binding of moving parts, breakage of parts and any other condition that may affect the power tool's operation. If damaged, have the power tool repaired before use.** Many accidents are caused by poorly maintained power tools.

- ▶ **Keep cutting tools sharp and clean.** Properly maintained cutting tools with sharp cutting edges are less likely to bind and are easier to control.
- ▶ **Use the power tool, accessories and tool bits etc. in accordance with these instructions, taking into account the working conditions and the work to be performed.** Use of the power tool for operations different from those intended could result in a hazardous situation.
- ▶ **Keep handles and grasping surfaces dry, clean and free from oil and grease.** Slippery handles and grasping surfaces do not allow for safe handling and control of the tool in unexpected situations.

Service

- ▶ **Have your power tool serviced by a qualified repair person using only identical replacement parts.** This will ensure that the safety of the power tool is maintained.

Hammer Safety Warnings

Safety instructions for all operations

- ▶ **Wear ear protectors.** Exposure to noise can cause hearing loss.
- ▶ **Use auxiliary handle(s), if supplied with the tool.** Loss of control can cause personal injury.
- ▶ **Hold the power tool by insulated gripping surfaces, when performing an operation where the cutting accessory may contact hidden wiring or its own cord.** Cutting accessory contacting a "live" wire may make exposed metal parts of the power tool "live" and could give the operator an electric shock.

Safety instructions when using long drill bits with rotary hammers

- ▶ **Always start drilling at low speed and with the bit tip in contact with the workpiece.** At higher speeds, the bit is likely to bend if allowed to rotate freely without contacting the workpiece, resulting in personal injury.
- ▶ **Apply pressure only in direct line with the bit and do not apply excessive pressure.** Bits can bend, causing breakage or loss of control, resulting in personal injury.

Additional safety information

- ▶ **Use suitable detectors to determine if utility lines are hidden in the work area or call the local utility company for assistance.** Contact with electric lines can lead to fire and electric shock. Damaging a gas line can lead to explosion. Penetrating a water line causes property damage or may cause an electric shock.
- ▶ **Always wait until the power tool has come to a complete stop before placing it down.** The application tool can jam and cause you to lose control of the power tool.
- ▶ **Secure the workpiece.** A workpiece clamped with clamping devices or in a vice is held more secure than by hand.
- ▶ **Do not touch any application tools or adjacent housing components shortly after operation.** These can become very hot during operation and cause burns.

- ▶ **The application tool may jam during drilling. Make sure you have a stable footing and hold the power tool firmly with both hands.** Otherwise you could lose control of the power tool.
- ▶ **Take care when carrying out demolition work using the chisel.** Falling fragments of the demolition material could injure you or any bystanders.
- ▶ **Hold the power tool firmly with both hands and make sure you have a stable footing.** The power tool can be more securely guided with both hands.
- ▶ **Caution! When using the power tool with Bluetooth®, a fault may occur in other devices and systems, aeroplanes and medical devices (e.g. pacemakers, hearing aids). Also, damage to people and animals in the immediate vicinity cannot be completely excluded. Do not use the power tool with Bluetooth® in the vicinity of medical devices, petrol stations, chemical plants, areas with a potentially explosive atmosphere or in blasting areas. Do not use the power tool with Bluetooth® in aircraft. Avoid using the product near your body for extended periods.**

The Bluetooth® word mark and logos are registered trademarks owned by Bluetooth SIG, Inc. Any use of such marks by Robert Bosch Power Tools GmbH is under license.

Symbols

The following symbols may be important for the operation of your power tool. Please take note of these symbols and their meaning. Correctly interpreting the symbols will help you to operate the power tool more effectively and safely.

Symbols and their meaning



To change the application tool, pull back the locking sleeve.



Tool data logging is enabled in this tool.



Wireless connectivity tool with built-in Bluetooth® technology



Product Description and Specifications



Read all the safety and general instructions.

Failure to observe the safety and general instructions may result in electric shock, fire and/or serious injury.

Please observe the illustrations at the beginning of this operating manual.

Intended Use

The power tool is intended for hammer drilling in concrete, masonry and stone, as well as for chiselling work.

With the *Bluetooth*® Low Energy Module **GCY 301-42** inserted, power tool data and settings can be transferred between the power tool and a mobile device by means of *Bluetooth*® wireless technology.

Product Features

The numbering of the product features refers to the diagram of the power tool on the graphics page.

- (1) Dust protection cap
- (2) Locking sleeve
- (3) Mode selector switch
- (4) Vibration damping
- (5) Lock-on button for on/off switch
- (6) On/off switch
- (7) Handle (insulated gripping surface)
- (8) Auxiliary handle (insulated gripping surface)
- (9) User interface
- (10) "Favourite" working mode indicator (user interface):
Individual configuration via smartphone app
- (11) "Soft" working mode indicator (user interface):
Reduced power for processing sensitive materials
- (12) Rapid shut-off indicator (user interface)
- (13) Maintenance indicator (user interface)
- (14) Rest reminder indicator (user interface)
- (15) Power tool status indicator (user interface)
- (16) Reset button (user interface)
- (17) Vibration warning indicator (user interface)
- (18) Working mode button (user interface)

Technical Data

Rotary hammer	GBH 6-42 C	
Article number		3 611 B78 0..
Rated power input	W	1300
Rated speed	min ⁻¹	0-360
Impact rate	min ⁻¹	0-3100

Rotary hammer	GBH 6-42 C	
Impact energy per stroke according to EPTA-Procedure 05:2016	J	9
Tool holder		SDS max
Lubrication		Central permanent lubrication
Max. drilling diameter		
- Concrete (with hammer drill bit)	mm	42
- Concrete (with break-through drill bit)	mm	55
- Concrete (with hollow core bit)	mm	100
Weight according to EPTA-Procedure 01:2014	kg	7.7
Protection class		□ / II
Data transfer		
<i>Bluetooth</i> ®		<i>Bluetooth</i> ® 4.2 (Low Energy) ^{A)}
Signal interval	s	1
Max. signal range ^{B)}	m	30

A) The mobile devices must be compatible with *Bluetooth*® Low Energy devices (version 4.2) and support the Generic Access Profile (GAP).

B) The signal range may vary greatly depending on external conditions, including the receiving device used. The *Bluetooth*® range may be significantly weaker inside closed rooms and through metallic barriers (e.g. walls, shelving units, cases, etc.).

The specifications apply to a rated voltage [U] of 230 V. These specifications may vary at different voltages and in country-specific models.

Values can vary depending upon the product and are subject to application and environmental conditions. For further information www.bosch-professional.com/wac.

Assembly

- ▶ **Pull the plug out of the socket before carrying out any work on the power tool.**

Activating the *Bluetooth*® Low Energy Module GCY 301-42

Read the corresponding operating instructions for information about the *Bluetooth*® Low Energy Module **GCY 301-42**.

Auxiliary handle

- ▶ **Do not operate your power tool without the auxiliary handle (8).**
- ▶ **Make sure that the auxiliary handle is always tightened.** Otherwise you could lose control of the power tool when working.

Swivelling the Auxiliary Handle

You can swivel the auxiliary handle (8) to any angle for a safe work posture that minimises fatigue.

- Turn the lower gripping end of the auxiliary handle (8) anticlockwise and swivel the auxiliary handle (8) into the required position. Then turn the lower gripping end of the auxiliary handle (8) clockwise to retighten it. Make sure that the retaining strap of the auxiliary handle slots into the corresponding groove of the housing.

Changing the Tool

The dust protection cap (1) largely prevents the penetration of drilling dust into the tool holder during operation. When inserting the tool, make sure that the dust protection cap (1) does not become damaged.

- ▶ **Replace a damaged dust protection cap immediately. It is recommended that you have use an after-sales service for this.**

Inserting the Application Tool (see figure A)

With the SDS-max tool holder, you can change the application tool simply and easily without additional aids.

- Clean and lightly grease the shank of the application tool.
- Push the locking sleeve (2) back and insert the application tool by turning it into the tool holder. Release the locking sleeve (2) to lock the application tool.
- Check that it is locked by pulling on the tool.

Removing the application tool (see figure B)

- Push the locking sleeve (2) back and remove the application tool.

Dust/Chip Extraction

Dust from materials such as lead-containing coatings, some wood types, minerals and metal can be harmful to one's health. Touching or breathing-in the dust can cause allergic reactions and/or lead to respiratory infections of the user or bystanders.

Certain dust, such as oak or beech dust, is considered carcinogenic, especially in connection with wood-treatment additives (chromate, wood preservative). Materials containing asbestos may only be worked by specialists.

- Provide for good ventilation of the working place.
- It is recommended to wear a P2 filter-class respirator.

Observe the relevant regulations in your country for the materials to be worked.

- ▶ **Avoid dust accumulation at the workplace.** Dust can easily ignite.

Operation

- ▶ **Products that are only sold in AUS and NZ:** Use a residual current device (RCD) with a nominal residual current of 30 mA or less.
- ▶ **The power tool with built-in Bluetooth® Low Energy Module GCY 301-42 is equipped with a radio interface. Local operating restrictions, e.g. in aircraft or hospitals, must be observed.**

Start-up

- ▶ **Pay attention to the mains voltage.** The voltage of the power source must match the voltage specified on the rating plate of the power tool.

Setting the Operating Mode

The operating mode of the power tool is selected using the mode selector switch (3).

- To change the operating mode, turn the mode selector switch (3) to the required position.



Position for **hammer drilling**

If the application tool does not start rotating straight away, run the power tool slowly until the application tool starts rotating.

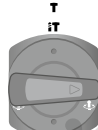

Vario-Lock position for changing the chiselling position



Position for **chiselling**

Note: Only change the operating mode when the power tool is switched off. The power tool is automatically switched off if you change the operating mode during ongoing operation.

Switching On/Off

- To **switch on** the power tool, press the on/off switch (6). For low temperatures, the power tool reaches the full hammer/impact capacity only after a certain time.
- To **lock** the on/off switch (6), press and hold it while also pushing the lock-on button (5).
- To **switch off** the power tool, release the on/off switch (6). If the on/off switch (6) is locked, press the lock-off button (5) first and then release it.

Adjusting the Speed/Impact Rate

You can adjust the speed/impact rate of the power tool when it is on by pressing in the on/off switch (6) to varying extents.

Applying light pressure to the on/off switch (6) results in a low rotational speed/impact rate. Applying increasing pressure to the switch increases the speed/impact rate.

You can also control the speed on the user interface and/or via a smartphone app: .

Changing the chiselling position (Vario-Lock)

You can lock the chisel in **12** different positions, allowing you to select the optimum working position for each task.

- Insert the chisel into the tool holder.
- Turn the mode selector switch **(3)** to the "Vario-Lock" position.
- Turn the application tool to the required chisel position.
- Turn the mode selector switch **(3)** to the "chiselling" position. With this, the tool holder is locked.

User interface

The user interface **(9)** is used to select the working mode and to indicate the status of the power tool.

Status indicators

Power tool status indicator (15)	Meaning/cause ^{A)}	Solution
-	Power tool is switched off	-
Green	Power tool is switched on and ready to use	-
Yellow	Critical temperature of electronics reached. The power of the power tool is throttled in order to prevent damage.	Run the power tool at no load and allow it to cool down until the indicator (15) lights up green again
Yellow - In combination with lit maintenance indicator (13)	Regular power tool maintenance due soon	Send the power tool to the after-sales service
Yellow - In combination with flashing maintenance indicator (13)	Regular power tool maintenance due	Switch off the power tool immediately and send it to the after-sales service
Flashing blue	Power tool is connected to a mobile device or settings are being transferred.	-
Red	Power tool has overheated. The power tool is switched off in order to prevent damage to the electronics.	Leave the power tool to cool down. Only when the indicator (15) lights up green upon switching on is the power tool ready for use again.
	Restart protection is triggered. The power tool is prevented from starting up again following a power outage (e.g. if the mains plug is removed during operation) in order to prevent injuries.	Switch off the power tool and restore the power supply. Then switch the power tool on again.
	Lock-on button pressed in "hammer drilling" operating mode	Press the lock-on button again
	Rotation stop switch activated during operation	Switch the power tool off and on again
	General error	- Switch the power tool off and on again - Disconnect the power tool from the power supply and reconnect it If the error persists: - Send the power tool to the after-sales service

Rapid shut-off (KickBack Control)



The rapid shut-off function (KickBack Control) gives the user greater control over the power tool and offers them better protection than power tools that do not have KickBack Control. If the power tool suddenly and unforeseeably rotates around the drilling axis, it will switch off, the rapid shut-off indicator **(12)** will light up red and the status indicator **(15)** will flash red.

- To **switch the tool back on**, release the on/off switch **(6)** and then press it again.

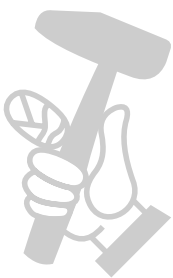

Power tool status indicator (15)	Meaning/cause ^{A)}	Solution
Flashing red – In combination with the lit rapid shut-off indicator (12)	Rapid shut-off is triggered.	Press the lock-on button and release the on/off switch

A) Read the notifications in the smartphone app.

Selecting the working mode

Press the (18) button for selecting the working mode repeatedly until the working mode you require lights up.

Note: The functions are preset in **Auto** and **Soft** work modes. In **Favourite** working mode, the preset functions can be configured via a smartphone app.

	Working mode		
	Auto	Soft	Favourite
Indicator on the user interface	–	Indicator (11) lights up white	Indicator (10) lights up white
Performance	100 %	Reduced power (80 %) for processing sensitive materials	Individual configuration via smartphone app Default setting: 90 %
Electronic Precision Control soft start	Fast, controlled run-up up to maximum power	Controlled run-up up to a reduced, low power	Individual configuration via smartphone app Default setting: Fast run-up
Sensitivity of the rapid shut-off (KickBack control)	Standard	Standard	Individual configuration via smartphone app Default setting: standard
High Altitude Mode (Atmospheric pressure compensation if the power tool does not start in Auto mode at great height)	Off	Off	Individual configuration via smartphone app Default setting: Off

Note: Press and hold the button (16) for longer than 6 seconds in order to reset the **Favourite** working mode to the factory settings (reset).

face. Local operating restrictions, e.g. in aircraft or hospitals, must be observed.

Connectivity functions

In conjunction with the *Bluetooth*® Low Energy Module **GCY 301-42**, the following connectivity functions are available for the power tool:

- Registration and personalisation
- Status check, output of warning messages
- General information and settings
- Management

Read the corresponding operating instructions for information about the *Bluetooth*® Low Energy Module **GCY 301-42**.

Practical Advice

- ▶ **The power tool with built-in *Bluetooth*® Low Energy Module GCY 301-42 is equipped with a radio inter-**

Rest Reminder Function

The **rest reminder** function (indicator (14)) helps you prevent bodily fatigue during daily work.

You can configure and reset the function via a smartphone app (default setting: Function deactivated).

Overload clutch

- ▶ **If the application tool jams or snags, the power transmission to the drill spindle will be interrupted. Always hold the power tool firmly with both hands to withstand the forces this may create and adopt a position with stable footing.**
- ▶ **Switch the power tool off immediately and remove the application tool if the power tool becomes blocked. Switching on when the drilling tool is blocked may cause high torque reactions.**

Vibration damping



The integrated vibration damping function reduces the generated vibration.

- ▶ **Do not continue to use the power tool if the damping element is damaged.**

Note: The **rest reminder** function can be reset with the button **(16)** if the set working time has expired and the rest reminder indicator **(14)** lights up red.

Rest reminder indicator (14)	Meaning/cause
Green	Rest reminder function is activated. Setting options for working time via smartphone app: <ul style="list-style-type: none"> – 30 minutes – 1 hour
Red	Set working time expired. If the set working time has expired, the power tool stays in operation until the motor stops or the power tool is switched off. The power tool can be switched on again after a pause of 10 minutes.
– In combination with power tool status indicator (15) lit up in red	

Daily Vibration Warning Function

The daily vibration warning function (indicator **(17)**) helps you comply with the legally determined exposure limit value (ELV) during work. This prevents hand-arm vibration syndrome.

You can activate and deactivate the function via a smartphone app (default setting: Function deactivated).

Note: If the daily vibration warning function is activated, the timer for the daily operating time can be restarted by pressing the button **(16)**.

Vibration warning indicator (17)	Meaning/cause
Green	Daily vibration warning function is activated.
Red	Daily operating time has reached the exposure limit value (ELV). The power tool switches off automatically.
– In combination with power tool status indicator (15) lit up in red	– Finish work or ask another person to continue the work.

Sharpening Chisels

Only sharp chiselling tools will produce good results, therefore sharpen your chiselling tools in good time before use. This will ensure a long service life for the tools and good work results.

Re-sharpening

Grind chiselling tools against sanding discs, e.g. aluminium oxide, under a steady stream of water. Make sure that the cutting edges show no annealing colours; this will impair the hardness of the chiselling tools.

To **forge** a chisel, heat it to 850–1050 °C (pale red to yellow).

To **harden** a chisel, heat it to approx. 900 °C and quench in oil. Then, leave it in an oven for approx. one hour at 320 °C (annealing colour: pale blue).

Maintenance and Service

Maintenance and Cleaning

- ▶ **Pull the plug out of the socket before carrying out any work on the power tool.**
- ▶ **To ensure safe and efficient operation, always keep the power tool and the ventilation slots clean.**

In order to avoid safety hazards, if the power supply cord needs to be replaced, this must be done by **Bosch** or by an after-sales service centre that is authorised to repair **Bosch** power tools.

- ▶ **Replace a damaged dust protection cap immediately. It is recommended that you have use an after-sales service for this.**

- Clean the tool holder after each use.

Lubrication

The power tool is lubricated with grease and is ready for immediate use.

The lubricating grease should only be changed during maintenance or commissioning carried out by an after-sales service centre authorised to work with Bosch power tools. It is crucial that only lubricating grease provided by Bosch is used.

After-Sales Service and Application Service

Our after-sales service responds to your questions concerning maintenance and repair of your product as well as spare parts. You can find explosion drawings and information on spare parts at: www.bosch-pt.com

The Bosch product use advice team will be happy to help you with any questions about our products and their accessories.

In all correspondence and spare parts orders, please always include the 10-digit article number given on the nameplate of the product.

Malaysia

Robert Bosch Sdn. Bhd.(220975-V) PT/SMY
No. 8A, Jalan 13/6

46200 Petaling Jaya
Selangor
Tel.: (03) 79663194
Toll-Free: 1800 880188
Fax: (03) 79583838
E-Mail: kiathoe.chong@my.bosch.com
www.bosch-pt.com.my

You can find further service addresses at:

www.bosch-pt.com/serviceaddresses

Disposal

The power tool, accessories and packaging should be recycled in an environmentally friendly manner.



Do not dispose of power tools along with household waste.

Français

Consignes de sécurité

Avertissements de sécurité généraux pour l'outil électrique

AVERTISSEMENT

Lire tous les avertissements de sécurité, les instructions, les illustrations et les spécifications fournis

avec cet outil électrique. Ne pas suivre les instructions énumérées ci-dessous peut provoquer un choc électrique, un incendie et/ou une blessure sérieuse.

Conserver tous les avertissements et toutes les instructions pour pouvoir s'y reporter ultérieurement.

Le terme "outil électrique" dans les avertissements fait référence à votre outil électrique alimenté par le secteur (avec cordon d'alimentation) ou votre outil électrique fonctionnant sur batterie (sans cordon d'alimentation).

Sécurité de la zone de travail

- ▶ **Conserver la zone de travail propre et bien éclairée.** Les zones en désordre ou sombres sont propices aux accidents.
- ▶ **Ne pas faire fonctionner les outils électriques en atmosphère explosive, par exemple en présence de liquides inflammables, de gaz ou de poussières.** Les outils électriques produisent des étincelles qui peuvent enflammer les poussières ou les fumées.
- ▶ **Maintenir les enfants et les personnes présentes à l'écart pendant l'utilisation de l'outil électrique.** Les distractions peuvent vous faire perdre le contrôle de l'outil.

Sécurité électrique

- ▶ **Il faut que les fiches de l'outil électrique soient adaptées au socle. Ne jamais modifier la fiche de quelque façon que ce soit. Ne pas utiliser d'adaptateurs avec des outils électriques à branchement de terre.** Des fiches non modifiées et des socles adaptés réduisent le risque de choc électrique.
- ▶ **Éviter tout contact du corps avec des surfaces reliées à la terre telles que les tuyaux, les radiateurs, les cuisinières et les réfrigérateurs.** Il existe un risque accru de choc électrique si votre corps est relié à la terre.
- ▶ **Ne pas exposer les outils électriques à la pluie ou à des conditions humides.** La pénétration d'eau à l'intérieur d'un outil électrique augmente le risque de choc électrique.
- ▶ **Ne pas maltraiter le cordon. Ne jamais utiliser le cordon pour porter, tirer ou débrancher l'outil électrique. Maintenir le cordon à l'écart de la chaleur, du lubrifiant, des arêtes vives ou des parties en mouvement.** Des cordons endommagés ou emmêlés augmentent le risque de choc électrique.
- ▶ **Lorsqu'on utilise un outil électrique à l'extérieur, utiliser un prolongateur adapté à l'utilisation extérieure.** L'utilisation d'un cordon adapté à l'utilisation extérieure réduit le risque de choc électrique.
- ▶ **Si l'usage d'un outil électrique dans un emplacement humide est inévitable, utiliser une alimentation protégée par un dispositif à courant différentiel résiduel (RCD).** L'usage d'un RCD réduit le risque de choc électrique.

Sécurité des personnes

- ▶ **Rester vigilant, regarder ce que vous êtes en train de faire et faire preuve de bon sens dans votre utilisation de l'outil électrique. Ne pas utiliser un outil électrique lorsque vous êtes fatigué ou sous l'emprise de drogues, de l'alcool ou de médicaments.** Un moment d'inattention en cours d'utilisation d'un outil électrique peut entraîner des blessures graves.
- ▶ **Utiliser un équipement de protection individuelle. Toujours porter une protection pour les yeux.** Les équipements de protection individuelle tels que les masques contre les poussières, les chaussures de sécurité antidérapantes, les casques ou les protections auditives utilisés pour les conditions appropriées réduisent les blessures.
- ▶ **Éviter tout démarrage intempestif. S'assurer que l'interrupteur est en position arrêté avant de brancher l'outil au secteur et/ou au bloc de batteries, de le ramasser ou de le porter.** Porter les outils électriques en ayant le doigt sur l'interrupteur ou brancher des outils électriques dont l'interrupteur est en position marche est source d'accidents.
- ▶ **Retirer toute clé de réglage avant de mettre l'outil électrique en marche.** Une clé laissée fixée sur une partie tournante de l'outil électrique peut donner lieu à des blessures.